

(SUBMIT IN TRIPLICATE)

UNITED STATES  
DEPARTMENT OF THE INTERIOR  
GEOLOGICAL SURVEYLand Office Santa Fe  
Lease No. NM 081310  
Unit 1961

## SUNDRY NOTICES AND REPORTS ON WELLS

NOTICE OF INTENTION TO DRILL.....	<input checked="" type="checkbox"/>	SUBSEQUENT REPORT OF WATER SHUT-OFF.....	
NOTICE OF INTENTION TO CHANGE PLANS.....		SUBSEQUENT REPORT OF SHOOTING OR ACIDIZING.....	
NOTICE OF INTENTION TO TEST WATER SHUT-OFF.....		SUBSEQUENT REPORT OF ALTERING CASING.....	
NOTICE OF INTENTION TO RE-DRILL OR REPAIR WELL.....		SUBSEQUENT REPORT OF RE-DRILLING OR REPAIR.....	
NOTICE OF INTENTION TO SHOOT OR ACIDIZE.....		SUBSEQUENT REPORT OF ABANDONMENT.....	
NOTICE OF INTENTION TO PULL OR ALTER CASING.....		SUPPLEMENTARY WELL HISTORY.....	
NOTICE OF INTENTION TO ABANDON WELL.....			

(INDICATE ABOVE BY CHECK MARK NATURE OF REPORT, NOTICE, OR OTHER DATA)

November 1, 1961

Well No. 3-Federal A is located 660 ft. from N line and 660 ft. from E line of sec. 21  
SW SW 21 16S 31E NMPM  
( $\frac{1}{4}$  Sec. and Sec. No.) (Twp.) (Range) (Meridian)  
Square Lake Eddy New Mexico  
(Field) (County or Subdivision) (State or Territory)

The elevation of the derrick floor above sea level is \_\_\_\_\_ ft.

## DETAILS OF WORK

(State names of and expected depths to objective sands; show sizes, weights, and lengths of proposed casings; indicate mudlogging jobs, cementing points, and all other important proposed work)

We propose to drill to a total depth of approximately 3600 feet with rotary tools and complete in the Grayburg and/or San Andres formation. The casing program will be as follows: 8-5/8 inch 24#, J55 surface casing to be set @ 300 feet and cemented with 200 sacks. Cement will be circulated to surface. Salt section will be isolated from fluids above & below by spotting cement plug @ 600 feet. 5-1/2 inch 15.5#, J55 casing set @ 3600 feet & cemented with 250 sacks cement.

I understand that this plan of work must receive approval in writing by the Geological Survey before operations may be commenced.

Company Dob Oil Properties, Inc.Address Box 953Midland, Texas

**RECEIVED**  
NOV 3 1961  
U. S. GEOLOGICAL SURVEY  
ARTESIA, NEW MEXICO  
By orig. sgd. Everett L. Smith  
Title Agent

NUMBER OF COPIES RECEIVED	
DISTRIBUTION	
SANTA FE	
FILE	
U.S.G.S.	
LAND OFFICE	
TRANSPORTER	OIL GAS
PRODUCTION OFFICE	
OPERATOR	

**NEW MEXICO OIL CONSERVATION COMMISSION**  
**WELL LOCATION AND ACREAGE DEDICATION PLAT**  
 SEE INSTRUCTIONS FOR COMPLETING THIS FORM ON THE REVERSE SIDE

FORM C-128  
Revised 5/1/57

**SECTION A**

Operator <b>DOB Oil Properties, Inc.</b>			Lease <b>Federal A</b>			Well No. <b>3</b>		
Unit Letter <b>M</b>	Section <b>21</b>	Township <b>16S</b>	Range <b>31E</b>	County <b>Eddy</b>				
Actual Footage Location of Well: <b>660</b> feet from the <b>South</b> line and <b>660</b> feet from the <b>West</b> line								
Ground Level Elev.		Producing Formation <b>Grayburg and/or San Andres</b>		Pool <b>Square Lake</b>			Dedicated Acreage: <b>40</b> Acres	

1. Is the Operator the only owner in the dedicated acreage outlined on the plat below? YES ☒ NO \_\_\_\_ . ("Owner" means the person who has the right to drill into and to produce from any pool and to appropriate the production either for himself or for himself and another. (65-3-29 (e) NMSA 1935 Comp.)
2. If the answer to question one is "no," have the interests of all the owners been consolidated by communitization agreement or otherwise? YES \_\_\_\_ NO \_\_\_\_ . If answer is "yes," Type of Consolidation \_\_\_\_
3. If the answer to question two is "no," list all the owners and their respective interests below:

Owner	Land Description

**SECTION B**

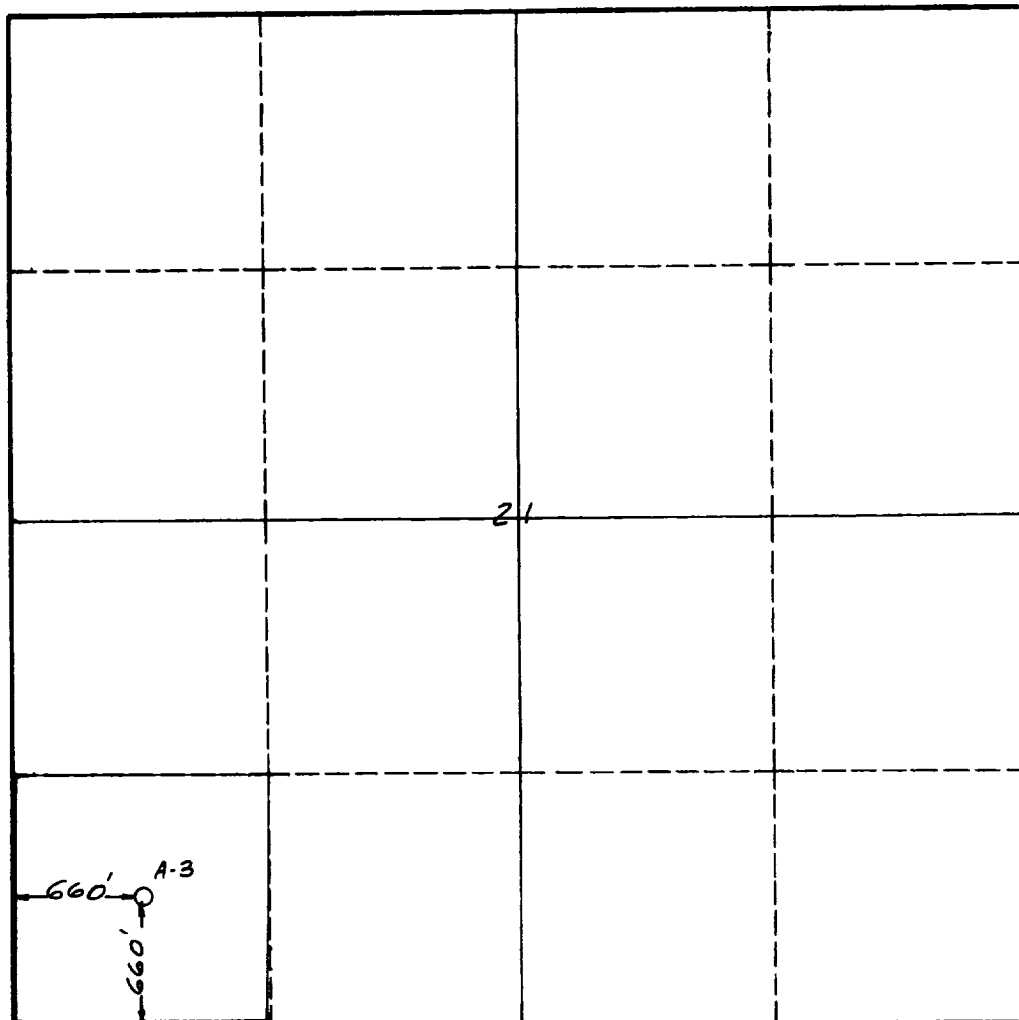

**CERTIFICATION**

I hereby certify that the information in SECTION A above is true and complete to the best of my knowledge and belief.

Name <i>[Signature]</i>
Position <b>Agent</b>
Company <b>DOB Oil Properties, Inc.</b>
Date <b>October 25, 1961</b>

I hereby certify that the well location shown on the plat in SECTION B was plotted from field notes of actual surveys made by me or under my supervision, and that the same is true and correct to the best of my knowledge and belief.

Date Surveyed <b>Oct. 25, 1961</b>
Registered Professional Engineer and/or Land Surveyor <i>[Signature]</i>
Certificate No. <b>2189</b>

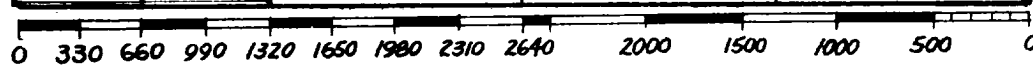

### INSTRUCTIONS FOR COMPLETION OF FORM C-128

1. Operator shall furnish and certify to the information called for in Section A.
2. Operator shall outline the dedicated acreage for *both* oil and gas wells on the plat in Section B.
3. A registered professional engineer or land surveyor registered in the State of New Mexico or approved by the Commission shall show on the plat the location of the well and certify this information in the space provided.
4. All distances shown on the plat must be from the outer boundaries of the Section.
5. If additional space is needed for listing owners and their respective interests as required in question 3 of Section A, please use space below.