

NEW MEXICO OIL CONSERVATION COMMISSION
WELL LOCATION AND ACREAGE DEDICATION PLAT

FORM C-128
Revised 5/1/57

SEE INSTRUCTIONS FOR COMPLETING THIS FORM ON THE REVERSE SIDE

SECTION A

Operator John H. Trigg		Lease Federal "O"		Well No. 1-27
Unit Letter C	Section 27	Township 16 South	Range 31 East	County Eddy County
Actual Footage Location of Well: 1980 feet from the West line and 990 feet from the North line				
Ground Level Elev. 4071.2	Producing Formation Lovington Sand		Pool Square Lake	Dedicated Acreage: 40 Acres

1. Is the Operator the only owner in the dedicated acreage outlined on the plat below? YES ☒ NO ____ ("Owner" means the person who has the right to drill into and to produce from any pool and to appropriate the production either for himself or for himself and another. (65-3-29 (e) NMSA 1935 Comp.)
2. If the answer to question one is "no," have the interests of all the owners been consolidated by communitization agreement or otherwise? YES ____ NO ____ . If answer is "yes," Type of Consolidation _____
3. If the answer to question two is "no," list all the owners and their respective interests below:

Owner	Land Description
	JAN 15 1962 U. S. GEOLOGICAL SURVEY ARTESIA, NEW MEXICO

SECTION B

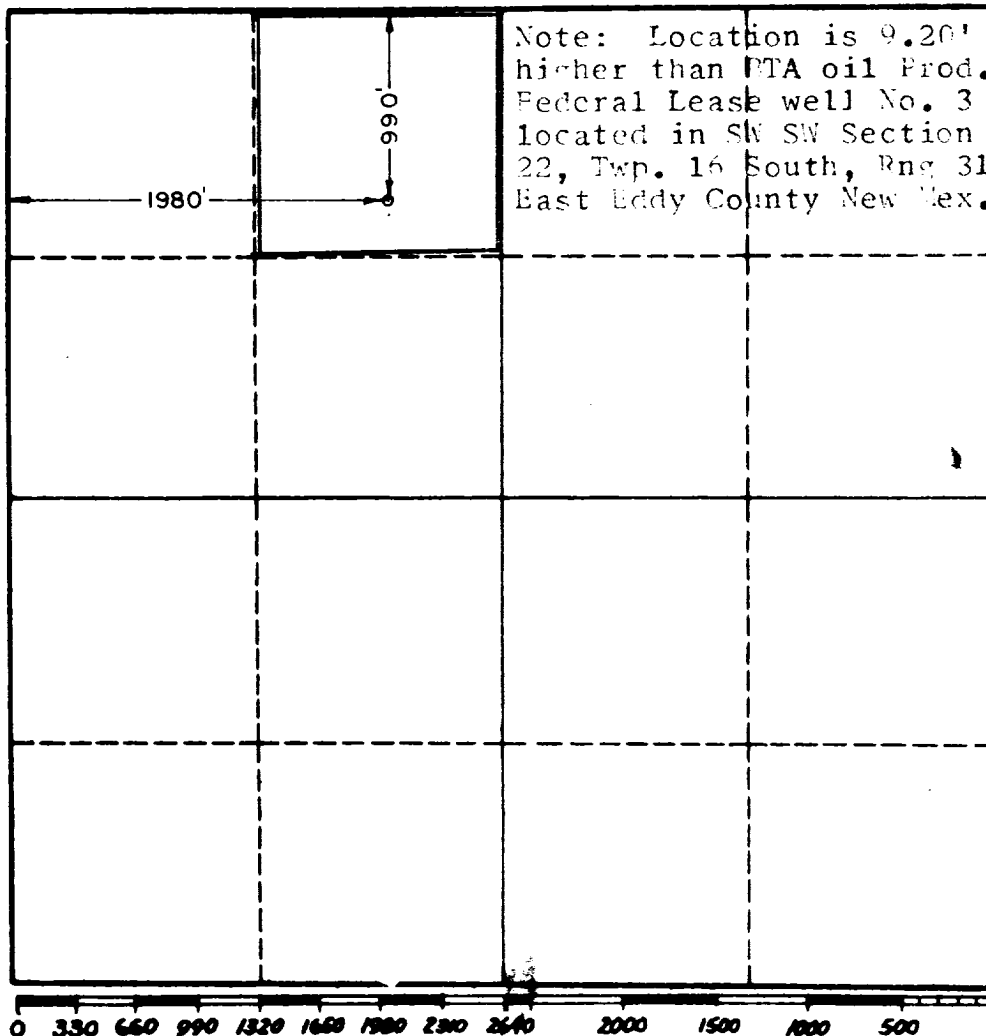

CERTIFICATION

I hereby certify that the information in SECTION A above is true and complete to the best of my knowledge and belief.

Name
John H. Trigg
Position
Owner
Company
John H. Trigg
Date
January 11, 1962

I hereby certify that the well location shown on the plat in SECTION B was plotted from field notes of actual surveys made by me or under my supervision, and that the same is true and correct to the best of my knowledge and belief.

Date Surveyed
Jan. 4, 1962
Registered Professional Engineer
and/or Land Surveyor, JOHN W. WEST
Certificate No.
N. M. - P. E. & L. S. NO. 676