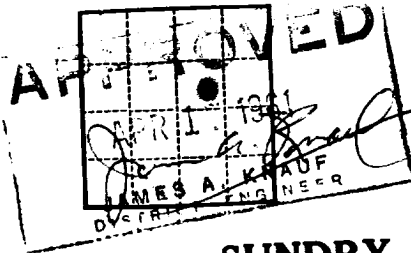

Form 9-221a
(Feb. 1961)RECEIVED
(SUBMIT IN TRIPPLICATE)Land Office Las Cruces
Lease No. LC 063105
Unit Federal-IndianUNITED STATES
DEPARTMENT OF THE INTERIOR
GEOLOGICAL SURVEY
ARTESIA, OFFICE

SUNDRY NOTICES AND REPORTS ON WELLS

NOTICE OF INTENTION TO DRILL	<input checked="" type="checkbox"/>	SUBSEQUENT REPORT OF WATER SHUT-OFF	
NOTICE OF INTENTION TO CHANGE PLANS		SUBSEQUENT REPORT OF SHOOTING OR ACIDIZING	
NOTICE OF INTENTION TO TEST WATER SHUT-OFF		SUBSEQUENT REPORT OF ALTERING CASING	
NOTICE OF INTENTION TO RE-DRILL OR REPAIR WELL		SUBSEQUENT REPORT OF RE-DRILLING OR REPAIR	
NOTICE OF INTENTION TO SHOOT OR ACIDIZE		SUBSEQUENT REPORT OF ABANDONMENT	
NOTICE OF INTENTION TO PULL OR ALTER CASING		SUPPLEMENTARY WELL HISTORY	
NOTICE OF INTENTION TO ABANDON WELL			

(INDICATE ABOVE BY CHECK MARK NATURE OF REPORT, NOTICE, OR OTHER DATA)

Well No. 1 is located 1920 ft. from N line and 1650 ft. from E line of sec. 26
26 1/4 26 1/4 26 16 S 31 E S.M.P.M.
 (1/4 Sec. and Sec. No.) (Twp.) (Range) (Meridian)
Agua Fria El Paso El Paso
 (Field) (County or Subdivision) (State or Territory)

The elevation of the derrick floor above sea level is _____ ft.

DETAILS OF WORK

(State names of and expected depths to objective sands; show sizes, weights, and lengths of proposed casings; indicate mudding jobs, cementing points, and all other important proposed work)

Will drill with rotary to the top of salt, expected at 700'. Will set approximately 700' of 8 5/8" casing. This will be J-55 24 pound seamless steel. The 8 5/8" casing will be cemented w/ 200 sacks and circulated. Will drill 7 7/8" hole to approximately 3600' and cement 14 lb. ST & C new API 5 1/2" J 55 20 seamless steel casing on bottom w/ 150 sacks. Then plug 30 sacks lower later w/ 1/2 galena later. This should fill back 1200' which will cover the Red Sand water zone. Will perforate and free in accordance with plan to be submitted at a later date.

RECEIVED

APR 14 1961

U. S. GEOLOGICAL SURVEY
ARTESIA, NEW MEXICO

I understand that this plan of work must receive approval in writing by the Geological Survey before operations may be commenced.

Company J. J. TravisAddress Box 873Midland, TexasBy J. J. TravisTitle Operator

NEW MEXICO OIL CONSERVATION COMMISSION
WELL LOCATION AND ACREAGE DEDICATION PLAT

RECEIVED

FORM C-128
Revised 5/1/57

APR 18 1961

SEE INSTRUCTIONS FOR COMPLETING THIS FORM ON THE REVERSE SIDE

SECTION A

Operator J. J. Swain		Lease Federal - Shiloh		ARTESIA, OFFICE Well No. 1	
Unit Letter 0	Section 20	Township 16 N	Range 31 E	County El Paso	
Actual Footage Location of Well: 1980 feet from the North line and 1650 feet from the East line					
Ground Level Elev. 5275	Producing Formation Organic		Pool Shiloh		Dedicated Acreage: 40 Acres

1. Is the Operator the only owner in the dedicated acreage outlined on the plat below? YES ☒ NO ☐ . ("Owner" means the person who has the right to drill into and to produce from any pool and to appropriate the production either for himself or for himself and another. (65-3-29 (e) NMSA 1935 Comp.)
2. If the answer to question one is "no," have the interests of all the owners been consolidated by communitization agreement or otherwise? YES ☐ NO ☐ . If answer is "yes," Type of Consolidation _____
3. If the answer to question two is "no," list all the owners and their respective interests below:

Owner	Land Description

RECEIVED

APR 14 1961

U. S. GEOLOGICAL SURVEY

ARTESIA, NEW MEXICO
CERTIFICATION

SECTION B

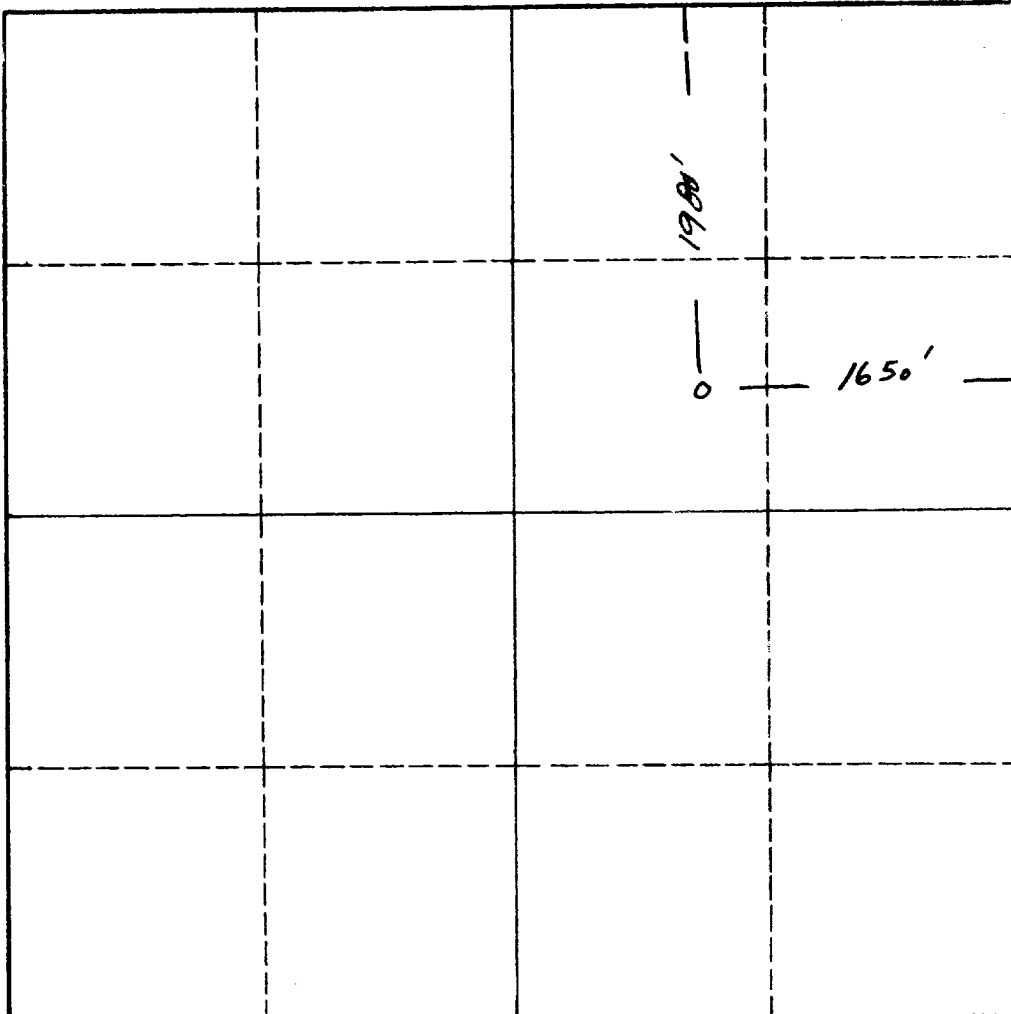

I hereby certify that the information in SECTION A above is true and complete to the best of my knowledge and belief.

Name <i>J. J. Swain</i>
Position <i>Operator</i>
Company J. J. Swain
Date April 11, 1961

I hereby certify that the well location shown on the plat in SECTION B was plotted from field notes of actual surveys made by me or under my supervision, and that the same is true and correct to the best of my knowledge and belief.

Date Surveyed April 11, 1961
Registered Professional Engineer and/or Land Surveyor <i>John H. McGowan</i>
Certificate No. 963

0 330 660 990 1320 1650 1980 2310 2640 2000 1500 1000 500 0

INSTRUCTIONS FOR COMPLETION OF FORM C-128

1. Operator shall furnish and certify to the information called for in Section A.
2. Operator shall outline the dedicated acreage for *both* oil and gas wells on the plat in Section B.
3. A registered professional engineer or land surveyor registered in the State of New Mexico or approved by the Commission shall show on the plat the location of the well and certify this information in the space provided.
4. All distances shown on the plat must be from the outer boundaries of the Section.
5. If additional space is needed for listing owners and their respective interests as required in question 3 of Section A, please use space below.