

JAN 4 1960

## NOTICE OF INTENTION TO DRILL

Notice must be given to the District Office of the Oil Conservation Commission and approval obtained before drilling or recompletion begins. If changes in the proposed plan are considered advisable, a copy of this notice showing such changes will be returned to the sender. Submit this notice in QUINTUPPLICATE. One copy will be returned following approval. See additional instructions in Rules and Regulations of the Commission. If State Land submit 6 Copies Attach Form C-128 in triplicate to first 3 copies of form C-101

O. C. C.

Midland, Texas (Place) January 1, 1960 (Date)

OIL CONSERVATION COMMISSION  
SANTA FE, NEW MEXICO

Gentlemen:

You are hereby notified that it is our intention to commence the Drilling of a well to be known as

Beal, Trobaugh & Associates

(Company or Operator)

Doolin

(Lease)

Well No. #1, in N (Unit) The well is

located 660 feet from the South line and 1980 feet from the West line of Section 32, T-16-S, R-31-E, NMPM.

(GIVE LOCATION FROM SECTION LINE) Square Lake Pool, Eddy County

If State Land the Oil and Gas Lease is No. B-2721

If patented land the owner is

Address

We propose to drill well with drilling equipment as follows: Rotary

The status of plugging bond is On file

Drilling Contractor Forster Drilling Co.  
Odessa, Texas

We intend to complete this well in the Grayburg formation at an approximate depth of 3750 feet.

### CASING PROGRAM

We propose to use the following strings of Casing and to cement them as indicated:

Size of Hole	Size of Casing	Weight per Foot	New or Second Hand	Depth	Sacks Cement
12-1/4	9-5/8	32	New	375	200
7-7/8	5-1/2	15.5	New	3750	200

If changes in the above plans become advisable we will notify you immediately.

ADDITIONAL INFORMATION (If recompletion give full details of proposed plan of work.)

JAN 4 1960

Approved, 19  
Except as follows:

OIL CONSERVATION COMMISSION

By M. L. Armstrong

Sincerely yours,

BEAL, TROBAUGH & ASSOCIATES

(Company or Operator)

By Allen H. Trobaugh

Position Partner

Send Communications regarding well to

Name Beal, Trobaugh & Associates

Address 122 Allen Bldg. Midland, Texas

NEW MEXICO OIL CONSERVATION COMMISSION  
Well Location and Acreage Dedication Plat

Section A.

Date January 1, 1960

Operator Beal, Trebaugh & Associates Lease Doelin  
Well No. 1 Unit Letter N Section 32 Township -16-S Range -31-E NMPM  
Located 660 Feet From South Line, 1980 Feet From West Line  
County Eddy G. L. Elevation 3900 Dedicated Acreage 40 Acres  
Name of Producing Formation Grayburg Pool Square Lake

1. Is the Operator the only owner\* in the dedicated acreage outlined on the plat below?  
Yes X No       .
2. If the answer to question one is "no," have the interests of all the owners been consolidated by communitization agreement or otherwise? Yes        No       . If answer is "yes," Type of Consolidation
3. If the answer to question two is "no," list all the owners and their respective interests below:

Owner

Land Description

Section B

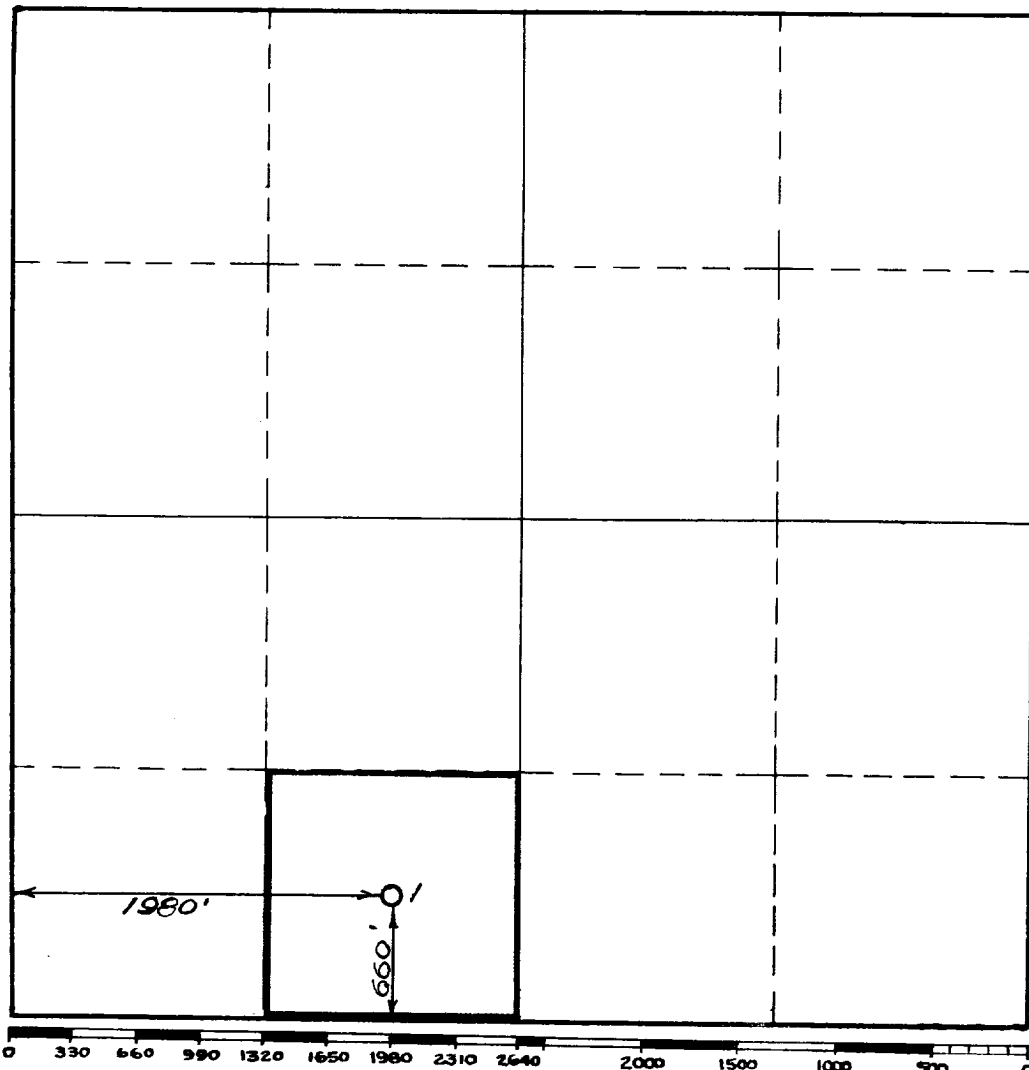

This is to certify that the information in Section A above is true and complete to the best of my knowledge and belief.

Beal, Trebaugh & Associates  
(Operator)  
*Allen K. Trebaugh*  
Allen K. Trebaugh  
(Representative)

122 Allen Building  
Midland, Texas

This is to certify that the well location shown on the plat in Section B was plotted from field notes of actual surveys made by me or under my supervision and that the same is true and correct to the best of my knowledge and belief.

Date Surveyed Jan. 1, 1960

*D. H. Jenkins*  
Registered Professional  
Engineer and/or Land Surveyor.

Certificate No. 10666

(See instructions for completing this form on the reverse side)

INSTRUCTIONS FOR COMPLETION :

1. Operator shall furnish and certify to the information called for in Section A.
2. Operator shall outline the dedicated acreage for both oil and gas wells on the plat in Section B.
3. A registered professional engineer or land surveyor registered in the State of New Mexico or approved by the Commission shall show on the plat the location of the well and certify this information in the space provided.
4. All distances shown on the plat must be from the outer boundaries of Section.
5. If additional space is needed for listing owners and their respective interests as required in question 3, Section A, please use space below

OIL CONSERVATION COMMISSION		
ARTESIA DISTRICT OFFICE		
No. Copies Received <u>6</u>		
DISTRIBUTION		
	NO. FURNISHED	
OPERATOR	<u>1</u>	
SANTA FE	<u>1</u>	
PRORATION OFFICE		
STATE LAND OFFICE	<u>1</u>	
U. S. G. S.	<u>2</u>	
TRANSPORTER		
FILE	<u>1</u>	<u>✓</u>
BUREAU OF MINES		

\* "Owner" means the person who has the right to drill into and to produce from any pool and to appropriate the production either for himself or for himself and another. (65-3-29 (e) NMSA 1953 Comp.)