

NUMBER OF COPIES RECEIVED	
DISTRIBUTION	
SANTA FE	
FILE	
U.S.G.S.	
LAND OFFICE	
TRANSPORTER	OIL GAS
PRORATION OFFICE	
OPERATOR	

NEW MEXICO OIL CONSERVATION COMMISSION
Santa Fe, New Mexico

Form C-101
Revised (12/1/55)

NOTICE OF INTENTION TO DRILL

Notice must be given to the District Office of the Oil Conservation Commission and approval obtained before drilling or recompletion begins. If changes in the proposed plan are considered advisable, a copy of this notice showing such changes will be returned to the sender. Submit this notice in **QUINTUPLICATE**. One copy will be returned following approval. See additional instructions in Rules and Regulations of the Commission. **If State Land submit 6 Copies Attach Form C-128 in triplicate to first 3 copies of form C-101**

(Place)

(Date)

OIL CONSERVATION COMMISSION
SANTA FE, NEW MEXICO

RECEIVED

Gentlemen:

You are hereby notified that it is our intention to commence the Drilling of a well to be known as

FEB 12 1962

(Company, or Operator)

O. C. C.

, Well No. _____, in _____, **ARTESIA, OFFICE** The well is
(Lease) (Unit)

located _____ feet from the _____ line and _____ feet from the _____ line of Section _____, T _____, R _____, NMPM.

(GIVE LOCATION FROM SECTION LINE) _____ Pool, _____ County

If State Land the Oil and Gas Lease is No. _____

If patented land the owner is _____

Address _____

We propose to drill well with drilling equipment as follows: _____

The status of plugging bond is _____

Drilling Contractor _____

We intend to complete this well in the _____ formation at an approximate depth of _____ feet.

CASING PROGRAM

We propose to use the following strings of Casing and to cement them as indicated:

Size of Hole	Size of Casing	Weight per Foot	New or Second Hand	Depth	Sacks Cement

If changes in the above plans become advisable we will notify you immediately.

ADDITIONAL INFORMATION (If recompletion give full details of proposed plan of work.)

Approved _____ FEB 12 1962 _____, 19_____
Except as follows:

Sincerely yours,

By _____
(Company or Operator)

Position _____

Send Communications regarding well to

Name _____

Address _____

OIL CONSERVATION COMMISSION

By _____

NUMBER OF COPIES RECEIVED	
DISTRIBUTION	
SANTA FE	
FILE	
U.S.G.S.	
LAND OFFICE	
TRANSPORTER	OIL
	GAS
PRODUCTION OFFICE	
OPERATOR	

NEW MEXICO OIL CONSERVATION COMMISSION
WELL LOCATION AND ACREAGE DEDICATION PLAT
 SEE INSTRUCTIONS FOR COMPLETING THIS FORM ON THE REVERSE SIDE

FORM C-128
 Revised 5/1/57

SECTION A

Operator DOB Oil Properties, Inc.		Lease Tidewater State		Well No. 1
Unit Letter I	Section 32	Township 16S	Range 31E	County Eddy
Actual Footage Location of Well: 1980 feet from the South line and 660 feet from the East line				
Ground Level Elev. 3923	Producing Formation Grayburg & San Andres	Pool Square Lake	Dedicated Acreage: 40 Acres	

1. Is the Operator the only owner in the dedicated acreage outlined on the plat below? YES ☒ NO ☐ . ("Owner" means the person who has the right to drill into and to produce from any pool and to appropriate the production either for himself or for himself and another. (65-3-29 (e) NMSA 1935 Comp.)
2. If the answer to question one is "no," have the interests of all the owners been consolidated by communitization agreement or otherwise? YES ☐ NO ☐ . If answer is "yes," Type of Consolidation _____
3. If the answer to question two is "no," list all the owners and their respective interests below:

Owner	Land Description

SECTION B

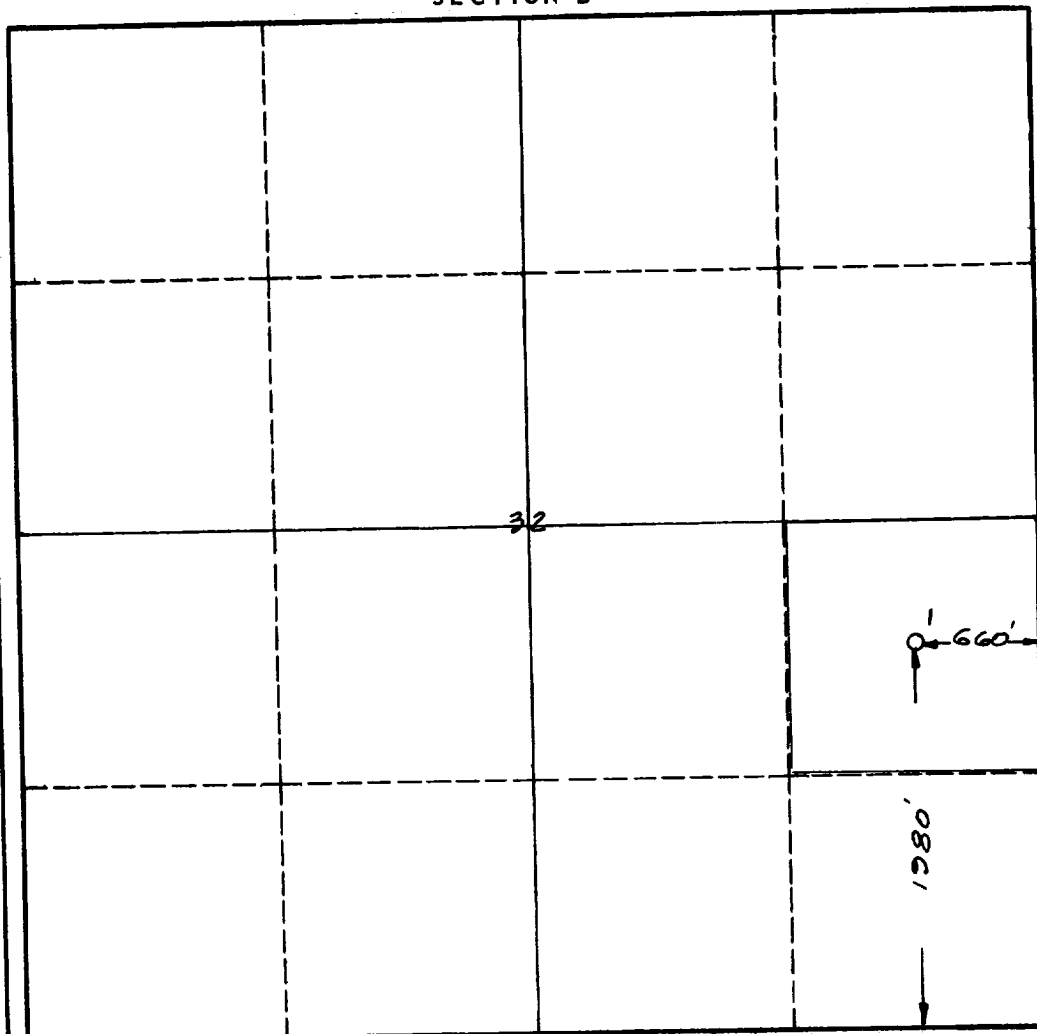

CERTIFICATION

I hereby certify that the information in SECTION A above is true and complete to the best of my knowledge and belief.

Name <i>Ernest Smith</i>
Position Agent
Company DOB Oil Properties, Inc.
Date February 8, 1962

I hereby certify that the well location shown on the plat in SECTION B was plotted from field notes of actual surveys made by me or under my supervision, and that the same is true and correct to the best of my knowledge and belief.

Date Surveyed JAN. 27, 1962
Registered Professional Engineer and/or Land Surveyor <i>Mark E. Shown</i>
Certificate No. 2189

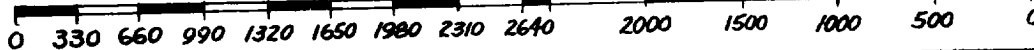

INSTRUCTIONS FOR COMPLETION OF FORM C-128

1. Operator shall furnish and certify to the information called for in Section A.
2. Operator shall outline the dedicated acreage for *both* oil and gas wells on the plat in Section B.
3. A registered professional engineer or land surveyor registered in the State of New Mexico or approved by the Commission shall show on the plat the location of the well and certify this information in the space provided.
4. All distances shown on the plat must be from the outer boundaries of the Section.
5. If additional space is needed for listing owners and their respective interests as required in question 3 of Section A, please use space below.