

(SUBMIT IN TRIPLICATE)

UNITED STATES  
DEPARTMENT OF THE INTERIOR  
GEOLOGICAL SURVEY

Land Office **Santa Fe, N.M.**  
File No. **GC. 062618-A**  
Unit **JUL 22 1957**

Oil Cons. Comm.  
ARTESIA OFFICE

## SUNDRY NOTICES AND REPORTS ON WELLS

NOTICE OF INTENTION TO DRILL		SUBSEQUENT REPORT OF WATER SHUT-OFF	
NOTICE OF INTENTION TO CHANGE PLANS		SUBSEQUENT REPORT OF SHOOTING OR ACIDIZING	
NOTICE OF INTENTION TO TEST WATER SHUT-OFF	<input checked="" type="checkbox"/>	SUBSEQUENT REPORT OF ALTERING CASING	
NOTICE OF INTENTION TO RE-DRILL OR REPAIR WELL		SUBSEQUENT REPORT OF RE-DRILLING OR REPAIR	
NOTICE OF INTENTION TO SHOOT OR ACIDIZE		SUBSEQUENT REPORT OF ABANDONMENT	
NOTICE OF INTENTION TO PULL OR ALTER CASING		SUPPLEMENTARY WELL HISTORY	
NOTICE OF INTENTION TO ABANDON WELL			

(INDICATE ABOVE BY CHECK MARK NATURE OF REPORT, NOTICE, OR OTHER DATA)

July 18, 1957

**Federal-Hitchcock**  
Well No. **"C" #1** is located **1980** ft. from **N** line and **675** ft. from **E** line of sec. **23**  
**SE 1/4 NE 1/4 Sec. 23** **T. 16 S. R. 27 E. N.M.P.M.**  
(1/4 Sec. and Sec. No.) (Twp.) (Range) (Meridian)  
**Wildcat** **Eddy** **New Mexico**  
(Field) (County or Subdivision) (State or Territory)

The elevation of the derrick floor above sea level is **3607** ft.

### DETAILS OF WORK

(State names of and expected depths to objective sands; show sizes, weights, and lengths of proposed casings; indicate mudding jobs, cementing points, and all other important proposed work)

It is planned to re-enter the **TOM BOYD - #1-X Hitchcock** with cable tools and clean out the old hole to total depth for testing. The casing program will be dependent on the discovery and amount of any water present. From previous records on the old well, 10-5/8" casing was run to 452' and set without cement and later pulled. Present planning would indicate that we will run 8-5/8" casing to the same approximate depth and cement under the direction of the State Engineers Office. Should in our opinion commercial quantities of oil be present, 5-1/2" casing will be run to total depth and cemented under the direction of the State Engineers Office.

I understand that this plan of work must receive approval in writing by the Geological Survey before operations may be commenced.

Company **ERNEST A. HANSON**

Address **P. O. Box 852**

**Roswell, New Mexico**

By *Ray F. Schram*

Title **Geologist, Ernest A. Hanson**

**APPROVED**

NEW MEXICO OIL CONSERVATION COMMISSION

JUL 18 1957

Well Location and Acreage Dedication Plat

Section A.

JOHN A. FROST  
DISTRICT ENGINEER

Date July 18, 1957

Operator ERNEST A. HANSON Lease Federal Hitchcock "C"  
Well No. 1 Unit Letter \_\_\_\_\_ Section 23 Township 14 South Range 27 East NMPM  
Located 1980 Feet From North Line, 675 Feet From East Line  
County Sully G. L. Elevation 3407 Dedicated Acreage 40 Acres  
Name of Producing Formation \_\_\_\_\_ Pool Wildcat

1. Is the Operator the only owner\* in the dedicated acreage outlined on the plat below?  
Yes \_\_\_\_\_ No X.
2. If the answer to question one is "no," have the interests of all the owners been consolidated by communitization agreement or otherwise? Yes X No \_\_\_\_\_. If answer is "yes," Type of Consolidation Formal agreement
3. If the answer to question two is "no," list all the owners and their respective interests below:

Owner

Land Description

Section B

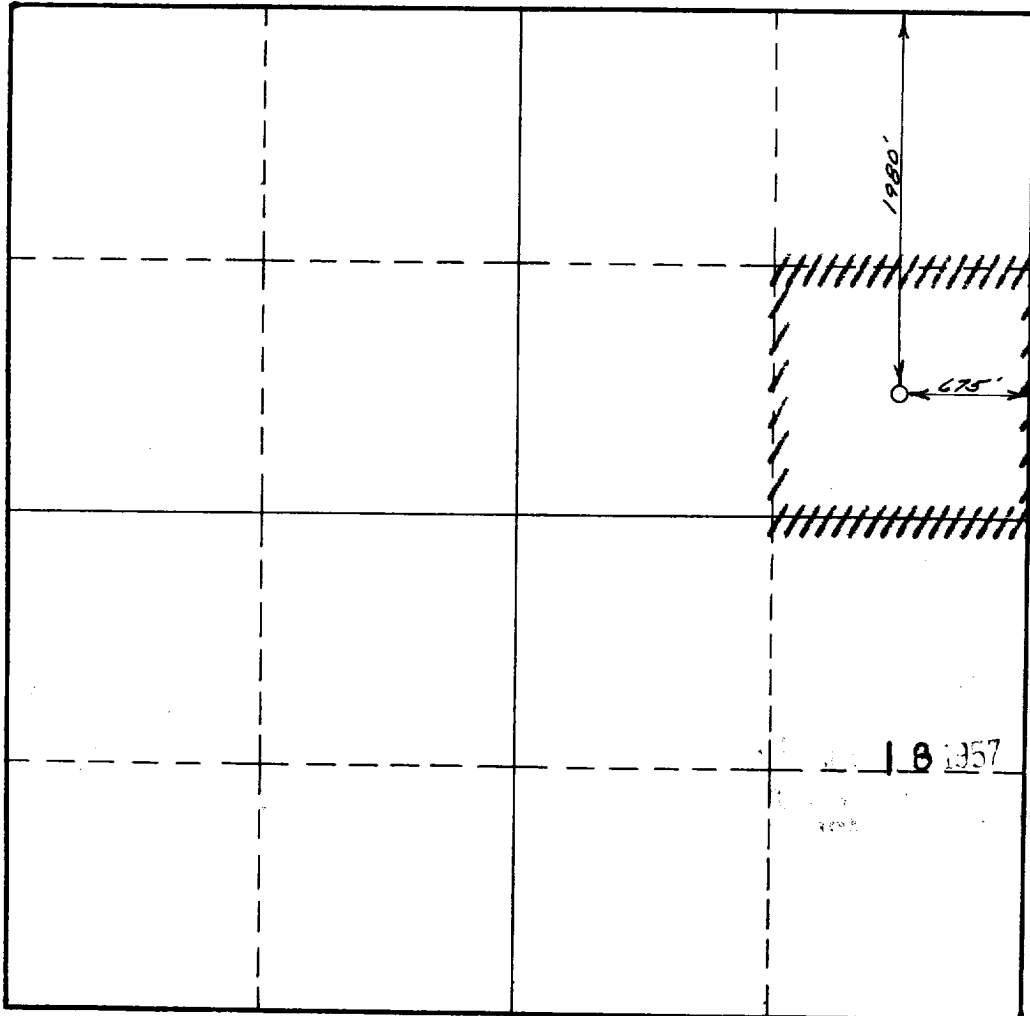

This is to certify that the information in Section A above is true and complete to the best of my knowledge and belief.

ERNEST A. HANSON  
(Operator)

Harry F. Johnson  
(Representative)

P. O. Box 832, Roswell, New Mex.  
Address

This is to certify that the well location shown on the plat in Section B was plotted from field notes of actual surveys made by me or under my supervision and that the same is true and correct to the best of my knowledge and belief. Re-entry of old PRA  
Date Surveyed 7-17-57

Ernest A. Hanson  
Registered Professional  
Engineer and/or Land Survey

Certificate No. 751

### INSTRUCTIONS FOR COMPLETION

1. Operator shall furnish and certify to the information called for in Section A.
2. Operator shall outline the dedicated acreage for both oil and gas wells on the plat in Section B.
3. A registered professional engineer or land surveyor registered in the State of New Mexico or approved by the Commission shall show on the plat the location of the well and certify this information in the space provided.
4. All distances shown on the plat must be from the outer boundaries of Section.
5. If additional space is needed for listing owners and their respective interests as required in question 3, Section A, please use space below

\* "Owner" means the person who has the right to drill into and to produce from any pool and to appropriate the production either for himself or for himself and another. (65-3-29 (e) NMSA 1953 Comp.)