

|                           |     |   |
|---------------------------|-----|---|
| NUMBER OF COPIES RECEIVED |     | 6 |
| DISTRIBUTION              |     |   |
| SANTA FE                  |     |   |
| FILE                      |     |   |
| U.S.G.S.                  |     |   |
| LAND OFFICE               |     |   |
| TRANSPORTER               | OIL |   |
|                           | GAS |   |
| PRORATOR OFFICE           |     |   |
| OPERATOR                  |     |   |

NEW MEXICO OIL CONSERVATION COMMISSION  
Santa Fe, New Mexico

Form C-101  
Revised (12/1/55)

# NOTICE OF INTENTION TO DRILL

Notice must be given to the District Office of the Oil Conservation Commission and approval obtained before drilling or recompletion begins. If changes in the proposed plan are considered advisable, a copy of this notice showing such changes will be returned to the sender. Submit this notice in QUINTUPPLICATE. One copy will be returned following approval. See additional instructions in Rules and Regulations of the Commission. If State Land submit 6 Copies Attach Form C- 128 in triplicate to first 3 copies of form C-101

Midland, Texas  
(Place)

April 25, 1963  
(Date)

OIL CONSERVATION COMMISSION  
SANTA FE, NEW MEXICO

Gentlemen:

You are hereby notified that it is our intention to commence the Drilling of a well to be known as

Barlow 4 Haff

(Company or Operator)

Barlow-Santa

(Lease)

, Well No. 4, in (Unit) The well is

located 1800 feet from the North line and 180 feet from the

East line of Section 3, T. 22S, R. 22E, NMPM.

(GIVE LOCATION FROM SECTION LINE) Pool, Santa County

If State Land the Oil and Gas Lease is No. B-2376-A

If patented land the owner is

Address

We propose to drill well with drilling equipment as follows: Cable Tools

The status of plugging bond is Barlow 4 Haff

Drilling Contractor Ray Smith Drilling Company

200 S. 1st Building

Dallas, Texas

We intend to complete this well in the Sandstone

formation at an approximate depth of 1000 feet.

## CASING PROGRAM

We propose to use the following strings of Casing and to cement them as indicated:

| Size of Hole | Size of Casing | Weight per Foot | New or Second Hand | Depth | Sacks Cement |
|--------------|----------------|-----------------|--------------------|-------|--------------|
| 10           | 3 5/8          | 21              | New                | 335   | 75           |
| 8            | 2 7/8          | 17.5            | New                | 1000  | 100          |
|              |                |                 |                    |       |              |
|              |                |                 |                    |       |              |

If changes in the above plans become advisable we will notify you immediately.

ADDITIONAL INFORMATION (If recompletion give full details of proposed plan of work.)

Approved APR 29 1963, 19

Except as follows:

OIL CONSERVATION COMMISSION

M. Armstrong

Sincerely yours,

Barlow 4 Haff

(Company or Operator)

By

Position

Send Communications regarding well to

Name Barlow 4 Haff

Address Box 553, Midland, Texas

NEW MEXICO OIL CONSERVATION COMMISSION  
WELL LOCATION AND ACREAGE DEDICATION PLAT

FORM C-128  
Revised 5/1/57

SEE INSTRUCTIONS FOR COMPLETING THIS FORM ON THE REVERSE SIDE

SECTION A

|   |  |                             |                                   |  |                      |
|---|--|-----------------------------|-----------------------------------|--|----------------------|
| Operator<br><b>BURLESON &amp; HUFF</b>  |  |                             | Lease<br><b>DELHI-TAMER STATE</b> |  | Well No.<br><b>3</b> |
| Unit Letter<br><b>H</b>   | Section<br><b>8</b>                    | Township<br><b>17 SOUTH</b> | Range<br><b>28 EAST</b>           | County<br><b>EDDY</b>                  |                      |
| Actual Footage Location of Well:<br><b>1980</b> feet from the <b>NORTH</b> line and <b>660</b> feet from the <b>EAST</b> line |  |                             |                                   |  |                      |
| Ground Level Elev.  | Producing Formation<br><b>Grayburg</b> |                             | Pool<br><b>Red Lake</b>           | Dedicated Acreage:<br><b>240</b> Acres |                      |

1. Is the Operator the only owner in the dedicated acreage outlined on the plat below? YES ☒ NO \_\_\_\_ . ("Owner" means the person who has the right to drill into and to produce from any pool and to appropriate the production either for himself or for himself and another. (65-3-29 (a) NMSA 1955 Comp.)
2. If the answer to question one is "no," have the interests of all the owners been consolidated by communitization agreement or otherwise? YES \_\_\_\_ NO \_\_\_\_ . If answer is "yes," Type of Consolidation \_\_\_\_
3. If the answer to question two is "no," list all the owners and their respective interests below:

| Owner | Land Description |
|-------|------------------|
|       |                  |

SECTION B

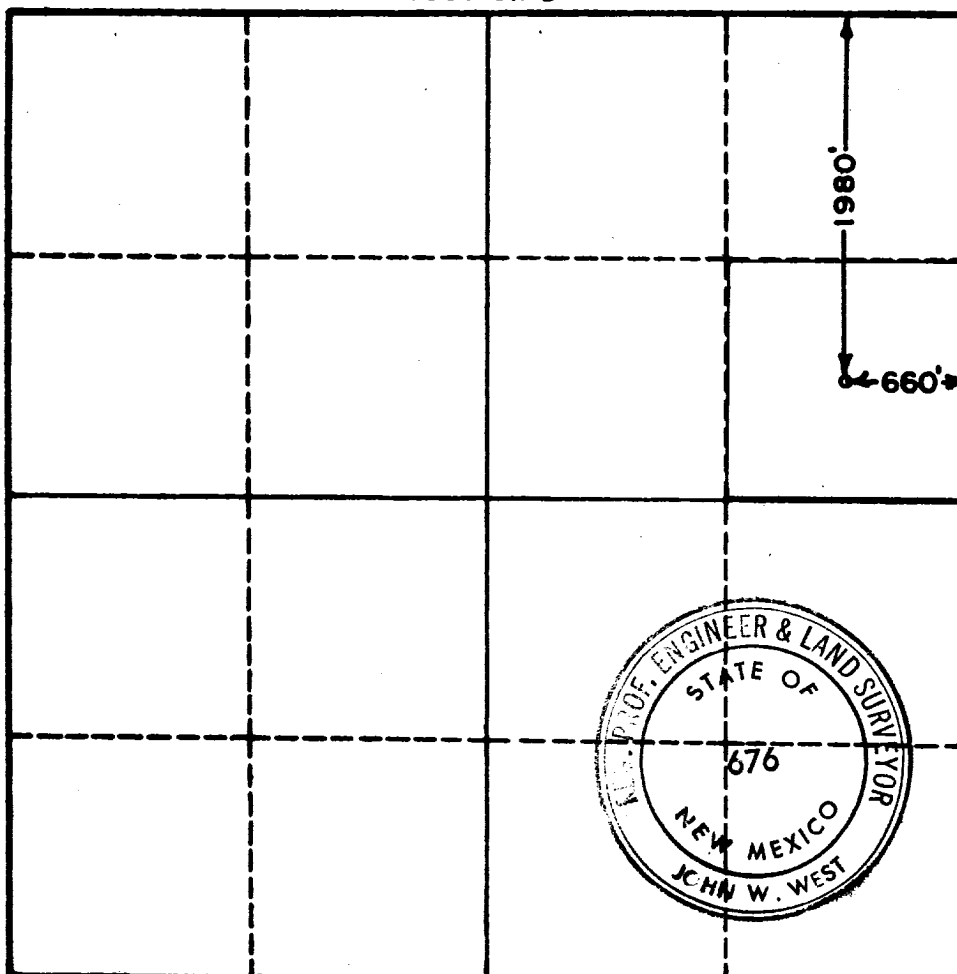

CERTIFICATION

I hereby certify that the information in SECTION A above is true and complete to the best of my knowledge and belief.

|                                       |
|---------------------------------------|
| Name<br><i>[Signature]</i>            |
| Position<br><b>Agent</b>              |
| Company<br><b>Burleson &amp; Huff</b> |
| Date<br><b>April 25, 1963</b>         |

I hereby certify that the well location shown on the plat in SECTION B was plotted from field notes of actual surveys made by me or under my supervision, and that the same is true and correct to the best of my knowledge and belief.

|  |
|--|
| Date Surveyed<br><b>4-25-63</b>  |
| Registered Professional Engineer and/or Land Surveyor, <b>JOHN W. WEST</b> |
| <i>[Signature]</i>   |
| Certificate No.<br><b>N.M. - P.E. &amp; L.S. NO. 676</b>                   |

0 320 640 960 1280 1600 1920 2240 2560 2880 3200 3520 3840 4160 4480 4800