

APPROVED
JUL 23 1964
DATE

DISTRICT ENGINEER
(SUBMIT IN TRIPLICATE)
MAY SECTION MUST BE ISOLATED FROM
FLUIDS ABOVE AND BELOW BY CEMENT

UNITED STATES
DEPARTMENT OF THE INTERIOR
GEOLOGICAL SURVEY

RECEIVED

JUL 27 1964

SUNDRY NOTICES AND REPORTS ON WELLS.

ARTESIA, OFFICE

NOTICE OF INTENTION TO DRILL.....	***	SUBSEQUENT REPORT OF WATER SHUT-OFF.....
NOTICE OF INTENTION TO CHANGE PLANS.....		SUBSEQUENT REPORT OF SHOOTING OR ACIDIZING.....
NOTICE OF INTENTION TO TEST WATER SHUT-OFF.....		SUBSEQUENT REPORT OF ALTERING CASING.....
NOTICE OF INTENTION TO RE-DRILL OR REPAIR WELL.....		SUBSEQUENT REPORT OF RE-DRILLING OR REPAIR.....
NOTICE OF INTENTION TO SHOOT OR ACIDIZE.....		SUBSEQUENT REPORT OF ABANDONMENT.....
NOTICE OF INTENTION TO PULL OR ALTER CASING.....		SUPPLEMENTARY WELL HISTORY.....
NOTICE OF INTENTION TO ABANDON WELL.....		

(INDICATE ABOVE BY CHECK MARK NATURE OF REPORT, NOTICE, OR OTHER DATA)

July 20, 1964

Well No. 2 is located 1650 ft. from XXXX line and 990 ft. from XXXX line of sec. 27
NW/4SW/4 27 T-16S, R-31E N.M.P.
(34 Sec. and 200 No.) (Twp.) (Range) (Meridian)
Square Lake Eddy New Mexico
(Field) (County or Subdivision) (State or Territory)

The elevation of the derrick floor above sea level is 4045 ft. est. (Ground Elev. is 4035')

DETAILS OF WORK

(State names of and expected depths to objective sands; show sizes, weights, and lengths of proposed casings; indicate mudding jobs, cementing points, and all other important proposed work)

Well Name: OLEN F. FEATHERSTONE #2 Valentine
 Objective: Square Lake Field Pay Zone: Premier Sand @ approx. 3545'
to 3590' and Lovington Sand @ approx. 3700' to 3725'. Est. TD 3775'

Drilling Program: Drill w/rotary tools, 10-1/2" Hole to 350', set 8-5/8" OD 8rd 24.0# J-55 ST&C Csg. w/125 sx cement, circulate cnt. WOC 24 hrs & test csg. @ 600# for 30 mins. Drill 7-7/8" Hole to approx. 3775' and run logs. Set 5-1/2" OD 8rd 17# ST&C Csg. @ TD and cnt w/200 sx. WOC 24 hrs & test @ 600# for 30 mins. Perforate, Treat and Complete.

Bond: Olen F. Featherstone maintains nationwide Bond covering New Mexico (Maryland Casualty Co. Bond #90-527146)

I understand that this plan of work must receive approval in writing by the Geological Survey before operations may be commenced.

Company OLEN F. FEATHERSTONE

Address 236 Petroleum Building

Roanoke, New Mexico 88201

By Rex Alcorn

Rex Alcorn

Title Geologist

NUMBER OF COPIES RECEIVED	
DISTRIBUTION	
SANTA FE	
FILE	
U.S.G.S.	
LAND OFFICE	
TRANSPORTER	OIL
	GAS
PRODUCTION OFFICE	
OPERATOR	

NEW MEXICO OIL CONSERVATION COMMISSION
WELL LOCATION AND ACREAGE DEDICATION PLAT
 SEE INSTRUCTIONS FOR COMPLETING THIS FORM ON THE REVERSE SIDE

FORM C-128
 Revised 5/1/57

SECTION A

Operator Olen F. Featherstone			Lease Valentine		Well No. 2
Unit Letter L	Section 27	Township T-16-S	Range R-31-E	County Eddy	
Actual Footage Location of Well: 1650 feet from the South line and 990 feet from the West line					
Ground Level Elev. 4035	Producing Formation Grayburg-San Andres		Pool Square Lake		Dedicated Acreage: 40 Acres

1. Is the Operator the only owner in the dedicated acreage outlined on the plat below? YES _____ NO _____. ("Owner" means the person who has the right to drill into and to produce from any pool and to appropriate the production either for himself or for himself and another. (65-3-29 (e) NMSA 1935 Comp.)
2. If the answer to question one is "no," have the interests of all the owners been consolidated by communitization agreement or otherwise? YES _____ NO _____. If answer is "yes," Type of Consolidation _____
3. If the answer to question two is "no," list all the owners and their respective interests below:

Owner	Land Description
	JUL 27 1964
	O. C. C.

SECTION B

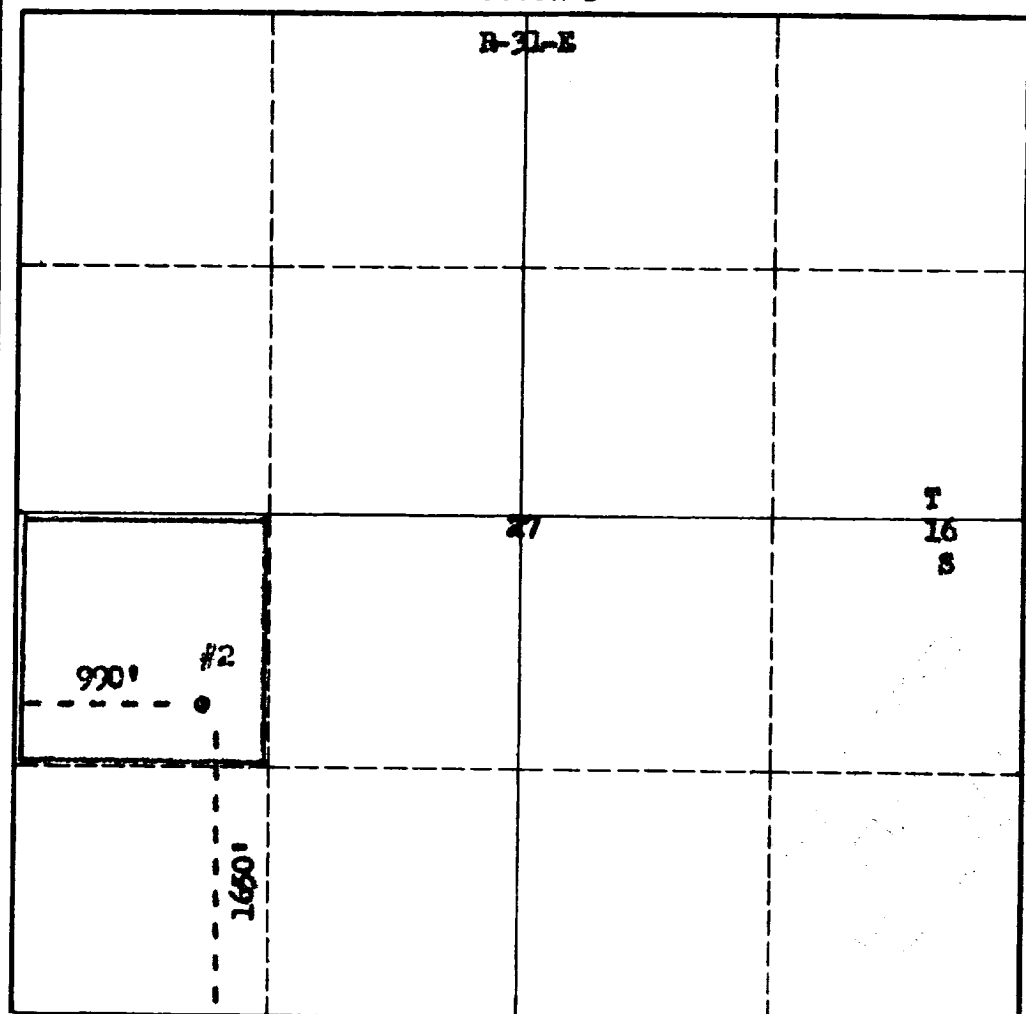

**ARTESIA, OFFICE
 CERTIFICATION**

I hereby certify that the information in SECTION A above is true and complete to the best of my knowledge and belief.

Name Rex Alcorn
Position Geologist
Company OLEN F. FEATHERSTONE
Date July 20, 1964

I hereby certify that the well location shown on the plat in SECTION B was plotted from field notes of actual surveys made by me or under my supervision, and that the same is true and correct to the best of my knowledge and belief.

Date Surveyed July 17, 1964
Registered Professional Engineer and/or Land Surveyor

James H. Brown
 Certificate No. **542**

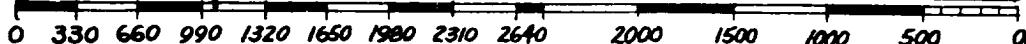

INSTRUCTIONS FOR COMPLETION OF FORM C-128

1. Operator shall furnish and certify to the information called for in Section A.
2. Operator shall outline the dedicated acreage for *both* oil and gas wells on the plat in Section B.
3. A registered professional engineer or land surveyor registered in the State of New Mexico or approved by the Commission shall show on the plat the location of the well and certify this information in the space provided.
4. All distances shown on the plat must be from the outer boundaries of the Section.
5. If additional space is needed for listing owners and their respective interests as required in question 3 of Section A, please use space below.