

NEW MEXICO OIL CONSERVATION COMMISSION
Santa Fe, New Mexico

Form C-101
Revised (12/1/55)

NOTICE OF INTENTION TO DRILL

30-015-10313

Notice must be given to the District Office of the Oil Conservation Commission and approval obtained before drilling or recompletion begins. If changes in the proposed plan are considered advisable, a copy of this notice showing such changes will be returned to the sender. Submit this notice in QUINTUPLICATE. One copy will be returned following approval. See additional instructions in Rules and Regulations of the Commission. If State Land submit 6 Copies Attach Form C-128 in triplicate to first 3 copies of form C-101

Artesia, New Mexico

May 15, 1964

RECEIVED

MAY 18 1964

O. G. C.
ARTESIA, OFFICE

OIL CONSERVATION COMMISSION
SANTA FE, NEW MEXICO

Gentlemen:

You are hereby notified that it is our intention to commence the Drilling of a well to be known as

International-Yates

(Company or Operator)

State 647

(Lease)

Well No. 46A, in Unit 8. The well is

located 990 feet from the North line and 1900 feet from the

East

line of Section 32, T. 17S, R. 28E, NMPM.

(GIVE LOCATION FROM SECTION LINE)

Empire Abo

Pool,

Eddy

County

If State Land the Oil and Gas Lease is No. NM 647

If patented land the owner is

Address

We propose to drill well with drilling equipment as follows: Rotary Tools

The status of plugging bond is Blanket

Drilling Contractor Unknown

We intend to complete this well in the Abo

formation at an approximate depth of 6100 feet.

CASING PROGRAM

990' FNL, 1900' FEL

We propose to use the following strings of Casing and to cement them as indicated:

Size of Hole	Size of Casing	Weight per Foot	New or Second Hand	Depth	Sacks Cement
10 3/4"	8 5/8"OD	24#	Used	700 ft.	300 sx.
7 7/8"	5 1/2"OD	14# & 15.5#	New	6100 ft.	625 sx.

If changes in the above plans become advisable we will notify you immediately.

ADDITIONAL INFORMATION (If recompletion give full details of proposed plan of work.)

Approved: MAY 18 1964, 19
Except as follows:

OIL CONSERVATION COMMISSION

By: M. L. Armstrong

Sincerely yours,

International-Yates
(Company or Operator)
By: J. P. McMan

Position: District Engineer
Send Communications regarding well to

Name: International-Yates
Address: P. O. Box 427 Artesia New Mexico

OIL CONSERVATION COMMISSION	
ARTESIA DISTRICT OFFICE	
No. Copies Received	10
DISTRIBUTION	
OPERATOR	5
SANTA FE	1
PROPERTY	1
STATE LAND OFFICE	2
U. S. G. I.	1
TRANSCONTINENTAL	1
PIPE	1
BLVD. & D. MINES	1

NUMBER OF COPIES RECEIVED	
DISTRIBUTION	
STATE FILE	
U.S.G.S.	
LAND OFFICE	
TRANSPORTER	OIL GAS
PRODUCTION OFFICE	
OPERATOR	

NEW MEXICO OIL CONSERVATION COMMISSION
WELL LOCATION AND ACREAGE DEDICATION PLAT
 SEE INSTRUCTIONS FOR COMPLETING THIS FORM ON THE REVERSE SIDE

FORM C-128
 Revised 5/1/57

SECTION A

Operator International-Yates		Lease State 647		Well No. 46-A	
Unit Letter B	Section 32	Township T-17-S	Range R-28-E	County Eddy	
Actual Footage Location of Well:					
990 feet from the North line and		1900 feet from the East line			
Ground Level Elev. 3693	Producing Formation Abo		Pool Empire Abo		Dedicated Acreage: 40 Acres

1. Is the Operator the only owner in the dedicated acreage outlined on the plat below? YES ☒ NO ____ . ("Owner" means the person who has the right to drill into and to produce from any pool and to appropriate the production either for himself or for himself and another. (65-3-29 (e) NMSA 1935 Comp.)
2. If the answer to question one is "no," have the interests of all the owners been consolidated by communitization agreement or otherwise? YES ____ NO ____ . If answer is "yes," Type of Consolidation ____
3. If the answer to question two is "no," list all the owners and their respective interests below:

Owner	Land Description

SECTION B

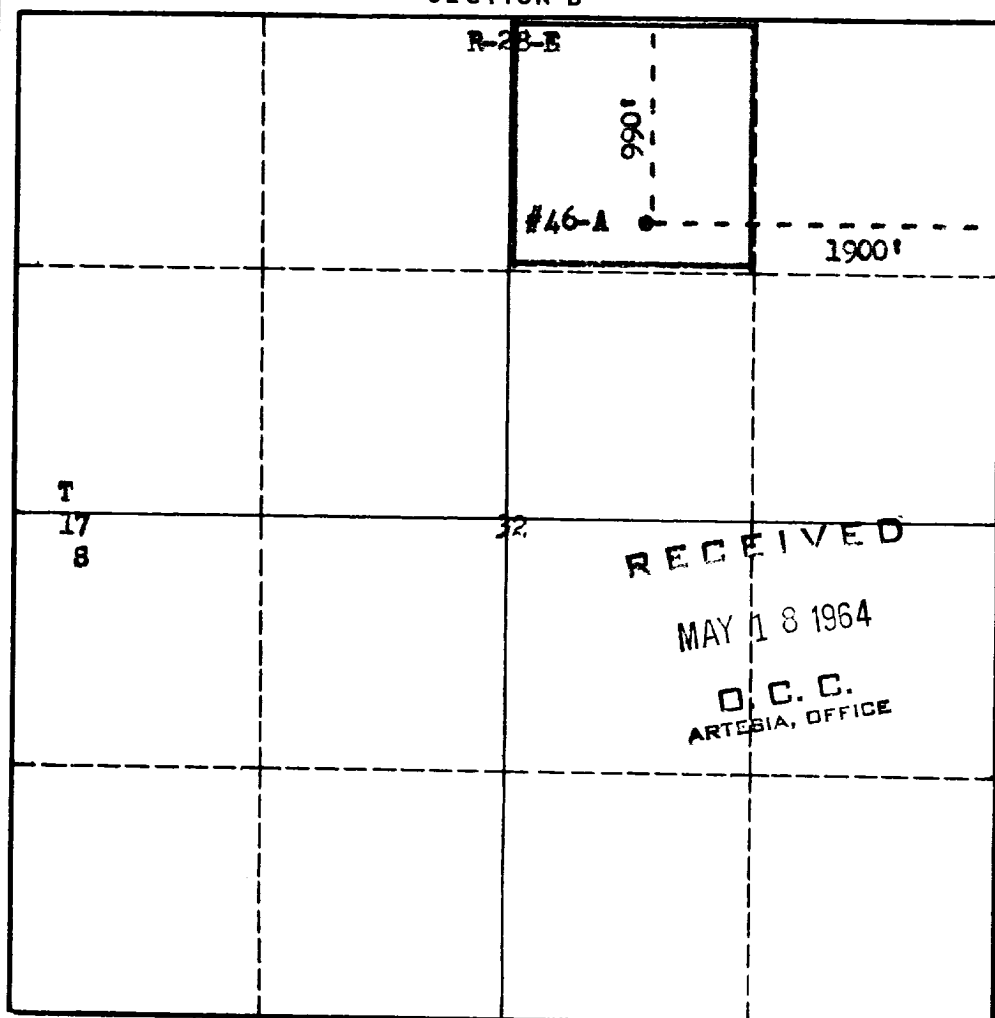

CERTIFICATION

I hereby certify that the information in SECTION A above is true and complete to the best of my knowledge and belief.

Name	<i>[Signature]</i>
Position	District Engineer
Company	International-Yates
Date	May 15, 1964

I hereby certify that the well location shown on the plat in SECTION B was plotted from field notes of actual surveys made by me or under my supervision, and that the same is true and correct to the best of my knowledge and belief.

Date Surveyed	May 15, 1964
Registered Professional Engineer and/or Land Surveyor	<i>[Signature]</i>
Certificate No.	512

RECEIVED
MAY 18 1964
O. C. C.
ARTESIA, OFFICE

INSTRUCTIONS FOR COMPLETION OF FORM C-128

1. Operator shall furnish and certify to the information called for in Section A.
2. Operator shall outline the dedicated acreage for *both* oil and gas wells on the plat in Section B.
3. A registered professional engineer or land surveyor registered in the State of New Mexico or approved by the Commission shall show on the plat the location of the well and certify this information in the space provided.
4. All distances shown on the plat must be from the outer boundaries of the Section.
5. If additional space is needed for listing owners and their respective interests as required in question 3 of Section A, please use space below.