

UNITED STATES  
DEPARTMENT OF THE INTERIOR  
GEOLOGICAL SURVEY

## APPLICATION FOR PERMIT TO DRILL, DEEPEN, OR PLUG BACK

## 1a. TYPE OF WORK

DRILL ☒DEEPEN ☐RE PLUG BACK ☒

## b. TYPE OF WELL

OIL  
WELL ☐GAS  
WELL ☐OTHER ☐SINGLE  
ZONE ☐MULTIPLE  
ZONE ☐

## 2. NAME OF OPERATOR

Ryder Scott Management Company

## 3. ADDRESS OF OPERATOR

922 8th Street - Wichita Falls, Texas

## 4. LOCATION OF WELL (Report location clearly and in accordance with any State requirements.)

At surface 10' FNL &amp; 10' FWL, Sec. 30, 16S, 31E, (NW/4 NW/4)

At proposed prod. zone

Same

## 14. DISTANCE IN MILES AND DIRECTION FROM NEAREST TOWN OR POST OFFICE\*

4 miles East and 5 miles North of Loco Hills, N. M.

## 15. DISTANCE FROM PROPOSED\*

10' FNL &amp; 10' FWL

LOCATION TO NEAREST  
PROPERTY OR LEASE LINE, FT.

(Also to nearest drlg. unit line, if any)

## 18. DISTANCE FROM PROPOSED LOCATION\*

TO NEAREST WELL, DRILLING, COMPLETED,  
OR APPLIED FOR, ON THIS LEASE, FT.

1900' NE of #4

## 21. ELEVATIONS (Show whether DF, RT, GR, etc.)

Gr. 3870

## 16. NO. OF ACRES IN LEASE

448.42

## 17. NO. OF ACRES ASSIGNED

40

## 19. PROPOSED DEPTH

3300'

## 20. ROTARY OR CABLE TOOLS

Rotary

## APPROX. DATE WORK WILL START\*

On Approval

## 23.

## PROPOSED CASING AND CEMENTING PROGRAM

SIZE OF HOLE	SIZE OF CASING	WEIGHT PER FOOT	SETTING DEPTH	QUANTITY OF CEMENT
16"	13" surface		300'	Cement to surface
11"	*	24#	450'	*
7-7/8"	4-1/2"	10.5#	3300'	250 sx.

- \* At H. J. Los Federal Well No. 3 there was no loss of circulation. Therefore, we are setting up to set no intermediate string to 450 ft. provided no loss of circulation occurs to this depth. If there is a loss of circulation then 8-5/8" casing will be set to 450 ft. and cement circulated. If no 8-5/8" casing is run, 50 sx. cement will be spotted outside 4-1/2" casing thru 1" pipe.

The acreage dedicated (40 ac.) to the objective pay zone will cover the depth from approximately 3000 ft. to 3300 ft. covering the Metex and the Upper, Middle and Lower Premier in the lower Grayburg formation, and the Lovington in the upper San Andres formation.

Approval for this well has been granted by New Mexico Conservation Commission Hearing Case No. 3310, Order No. R-2977-A.

IN ABOVE SPACE DESCRIBE PROPOSED PROGRAM: If proposal is to deepen or plug back, give data on present productive zone and proposed new productive zone. If proposal is to drill or deepen directionally, give pertinent data on subsurface locations and measured and true vertical depths. Give blowout preventer program, if any.

## 24.

SIGNED

TITLE

Agent

DATE Nov. 22, 1965

(This space for Federal or State office use)

PERMIT NO.

APPROVAL DATE

APPROVED BY

TITLE

DATE

CONDITIONS OF APPROVAL, IF ANY:

## Instructions

**General:** This form is designed for submitting proposals to perform certain well operations, as indicated, on all types of lands and leases for appropriate action by either a Federal or a State agency, or both, pursuant to applicable Federal and/or State laws and regulations. Any necessary special instructions concerning the use of this form and the number of copies to be submitted, particularly with regard to local, area, or regional procedures and practices, either are shown below or will be issued by, or may be obtained from, the local Federal and/or State office.

**Item 1:** If the proposal is to redrill to the same reservoir at a different subsurface location or to a new reservoir, use this form with appropriate notations. Consult applicable State or Federal regulations concerning subsequent work proposals or reports on the well.

**Item 4:** If there are no applicable State requirements, locations on Federal or Indian land should be described in accordance with Federal requirements. Consult local State or Federal office for specific instructions.

**Item 14:** Needed only when location of well cannot readily be found by road from the land or lease description. A plat, or plats, separate or on this reverse side, showing the roads to, and the surveyed location of, the well, and any other required information, should be furnished when required by Federal or State agency offices.

**Items 15 and 18:** If well is to be, or has been directionally drilled, give distances for subsurface location of hole in any present or objective production zone.

**Item 22:** Consult applicable Federal or State regulations, or appropriate officials, concerning approval of the proposal before operations are started.

NEW MEXICO OIL CONSERVATION COMMISSION  
WELL LOCATION AND ACREAGE DEDICATION PLAT

Form C-102  
Supersedes C-128  
Effective 1-1-65

All distances must be from the outer boundaries of the Section.

Operator <b>Ryder Scott Management Company</b>			Lease <b>Lee - Federal</b>		Well No. <b>7</b>
Unit Letter <b>D</b>	Section <b>30</b>	Township <b>T-16-S</b>	Range <b>R-31-E</b>	County <b>Eddy</b>	
Actual Footage Location of Well: <b>10</b> feet from the <b>North</b> line and <b>10</b> feet from the <b>West</b> line					
Ground Level Elev. <b>3870</b>	Producing Formation <b>Gls. SA</b>		Pool <b>Square Lake</b>		Dedicated Acreage: <b>40</b> Acres

- Outline the acreage dedicated to the subject well by colored pencil or hachure marks on the plat below.
- If more than one lease is dedicated to the well, outline each and identify the ownership thereof (both as to working interest and royalty).
- If more than one lease of different ownership is dedicated to the well, have the interests of all owners been consolidated by communitization, unitization, force-pooling, etc?

☐ Yes ☐ No If answer is "yes," type of consolidation \_\_\_\_\_

If answer is "no," list the owners and tract descriptions which have actually been consolidated. (Use reverse side of this form if necessary.) \_\_\_\_\_

No allowable will be assigned to the well until all interests have been consolidated (by communitization, unitization, forced-pooling, or otherwise) or until a non-standard unit, eliminating such interests, has been approved by the Commission.

RECEIVED  
RECEIVED

NOV 30 1965

NOV 24 1965

O. C. C.  
ARTESIA, OFFICE

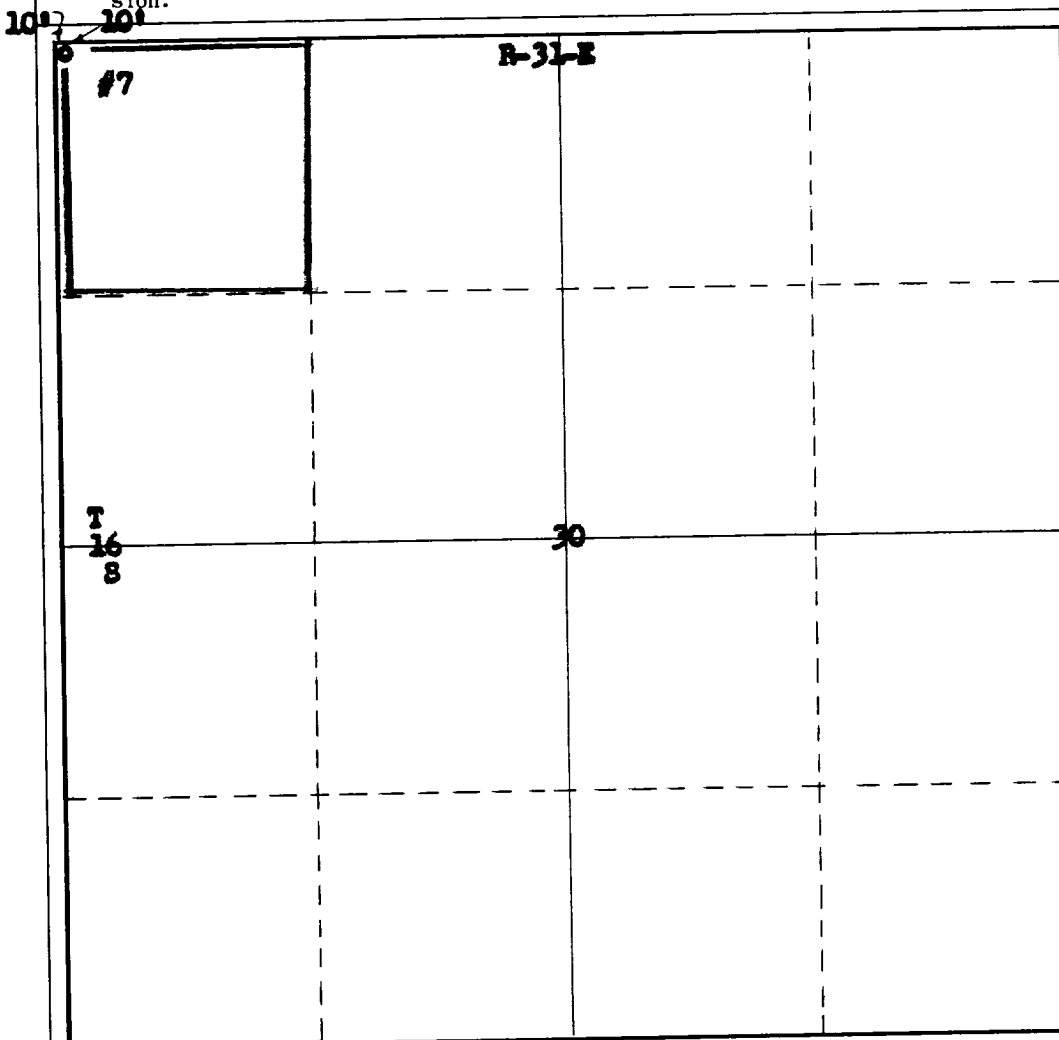

CERTIFICATION

I hereby certify that the information contained herein is true and complete to the best of my knowledge and belief.

Name <b>G. F. Cawdy</b>
Position <b>Agent</b>
Company <b>Ryder Scott Mgmt. Co.</b>
Date <b>November 22, 1965</b>

I hereby certify that the well location shown on this plat was plotted on field notes of actual survey made by me or under my supervision, and that the same is true and correct to the best of my knowledge and belief.

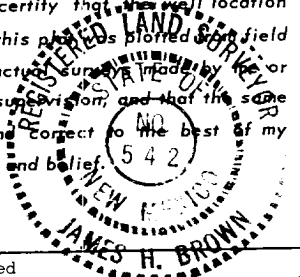

Date Surveyed <b>November 9, 1965</b>
Registered Professional Engineer and/or Land Surveyor

*James H. Brown*  
Certificate No. **542**