

UNITED STATES  
DEPARTMENT OF THE INTERIOR  
GEOLOGICAL SURVEY

Copy 1 of 4

5. LEASE DESIGNATION AND SERIAL NO.

R-0158721-A

6. IF INDIAN, ALLOTTEE OR TRIBE NAME

7. UNIT AGREEMENT NAME

8. FARM OR LEASE NAME

Superior Fed.

9. WELL NO.

1

10. FIELD AND POOL, OR WILDCAT

Square Lake

11. SEC., T., R., M., OR BSK.  
AND SURVEY OR AREA

Sec. 20, T-16S, R-31E

12. COUNTY OR PARISH

Bddy

13. STATE

New Mexico

14. TYPE OF WORK

DRILL ☒DEEPEN ☐PLUG BACK ☐

b. TYPE OF WELL

OIL ☐GAS ☐OTHER ☐SINGLE  
ZONE ☐MULTIPLE  
ZONE ☒

15. NAME OF OPERATOR

Superior Oil Company, Inc.

16. ADDRESS OF OPERATOR

P.O. Box 151 - Lordsburg, New Mexico

17. DEPTH OF WELL (or depth of casing and log program, with any state requirements.)

REMARKS

1900' TRL

(32 1/4" ID/4)

2310' TRL

At proposed prod. zone

Sec. 20, T-16S, R-31E

NMBH

18. DISTANCE IN FEET AND DIRECTION FROM NEAREST TOWN OR POST OFFICE\*

19. DISTANCE FROM NEAREST TOWN OR POST OFFICE

380'

20. NO. OF ACRES IN LEASE

160

21. NO. OF ACRES ASSIGNED  
TO THIS WELL

40

22. DISTANCE FROM PROPOSED LOCATION  
TO NEAREST WELL, DRILLING, COMPLETED,  
OR APPLIED FOR, ON THIS LEASE, FT.

None

23. PROPOSED DEPTH

3500'

24. ROTARY OR CABLE TOOLS

Rotary

25. ELEVATIONS (SHOW WHETHER DT, RT, GR, etc.)

3951 OR

26. APPROX. DATE WORK WILL START\*

November 22, 1965

27.

## PROPOSED CASING AND CEMENTING PROGRAM

SIZE OF HOLE	SIZE OF CASING	WEIGHT PER FOOT	SETTING DEPTH	QUANTITY OF CEMENT
17 1/2"	17 1/2"	25.35	10'	1 1/4 cubic Yards
7 1/2"	7 1/2"	9.5	1550'	200 sacks & 50 on 2-stage

Propose to test the Grayburg and the Livingston sand member of the San Andres.

Propose to 2-stage, use 4 1/2" oil string around 525', with 50 sacks, by  
running 1" tubing outside the 4 1/2" casing.

Propose to log, perforate and treat selective pay zones.

RECEIVED

NOV 23 1965

RECEIVED  
NOV 22 1965  
U. S. GEOLOGICAL SURVEY  
ARIESIA, NEW MEXICO

IN ABOVE SPACE DESCRIBE PROPOSED PROGRAM: If proposal is to deepen or plug back, give data on present productive zone and proposed new productive zone. If proposal is to drill or deepen directionally, give pertinent data on subsurface locations and measured and true vertical depths. Give blowout prevention program if any.

28.

SIGNED

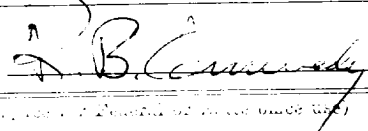

TITLED

Vice President

DATE

11-16-65

APPROVED BY

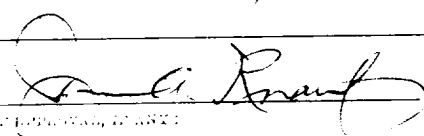

APPROVAL DATE

NOV 22 1965

DATE

DATE

1965

**NEW MEXICO OIL CONSERVATION COMMISSION  
WELL LOCATION AND ACREAGE DEDICATION PLAT**

Form C-102  
Supersedes C-128  
Effective 1-1-65

All distances must be from the outer boundaries of the Section.

Operator <b>Kennedy Oil Company</b>			Lease <b>Superior-Federal</b>		Well No. <b>1</b>
Unit Letter <b>F</b>	Section <b>20</b>	Township <b>16 South</b>	Range <b>31 East</b>	County <b>Eddy</b>	
Actual Footage Location of Well: <b>2310</b> feet from the <b>North</b> line and <b>1980</b> feet from the <b>West</b> line					
Ground Level Elev. <b>3951</b>	Producing Formation		Pool <i>Artesia Square Lake</i>	Dedicated Acreage: <b>40</b> Acres	

1. Outline the acreage dedicated to the subject well by colored pencil or hachure marks on the plat below.
2. If more than one lease is dedicated to the well, outline each and identify the ownership thereof (both as to working interest and royalty).
3. If more than one lease of different ownership is dedicated to the well, have the interests of all owners been consolidated by communitization, unitization, force-pooling, etc?

**RECEIVED**

☐ Yes    ☐ No    If answer is "yes," type of consolidation \_\_\_\_\_

If answer is "no," list the owners and tract descriptions which have actually been consolidated (Use reverse side of this form if necessary.) \_\_\_\_\_

No allowable will be assigned to the well until all interests have been consolidated (by communitization, unitization, forced-pooling, or otherwise) or until a non-standard unit, eliminating such interests, has been approved by the Commission.

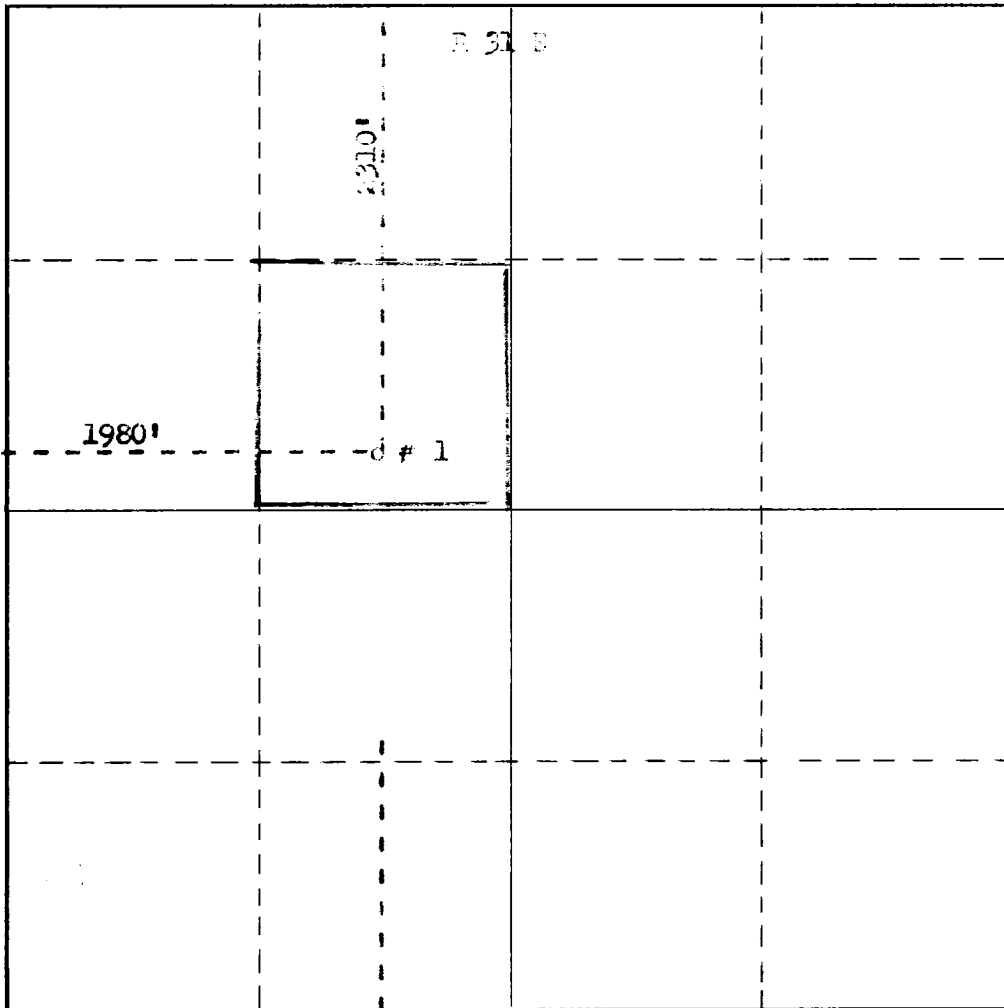

**CERTIFICATION**

I hereby certify that the information contained herein is true and complete to the best of my knowledge and belief.

*Robert B. Kennedy*  
Name

**Robert B. Kennedy**

Position

**Vice President**

Company

**Kennedy Oil Co., Inc.**

Date

**11/16/65**

I hereby certify that the well location shown on this plat was plotted from field notes of actual surveys made by me or under my supervision, and that the same is true and correct to the best of my knowledge and belief.

Date Surveyed

**November, 9th, 1965**

Registered Professional Engineer and/or Land Surveyor

*James H. Brown*  
Certificate No.

**N.M.L.S.No. 542**

