

Form 9-331 C
(May 1963)

SUBMIT IN TRIPLICATE*

(Other instructions on
reverse side)Form approved.
Budget Bureau No. 42-R1425.

30-015-20251

UNITED STATES
DEPARTMENT OF THE INTERIOR
GEOLOGICAL SURVEY

APPLICATION FOR PERMIT TO DRILL, DEEPEN, OR PLUG BACK

1a. TYPE OF WORK

DRILL ☒DEEPEN ☐PLUG BACK ☐

b. TYPE OF WELL

OIL
WELL ☐GAS
WELL ☐

OTHER

Water
InjectionSINGLE
ZONE ☒MULTIPLE
ZONE ☐

2. NAME OF OPERATOR

Continental Oil Company

3. ADDRESS OF OPERATOR

Box 460, Hobbs New Mexico 88240

4. LOCATION OF WELL (Report location clearly and in accordance with any State requirements.)*

1980' FNL & 1450' FNL of Sec. 35, T-16S, R-29E in Eddy
County New Mexico.
At proposed prod. zone Same

14. DISTANCE IN MILES AND DIRECTION FROM NEAREST TOWN OR POST OFFICE*

6 miles from Leco Hills

10. DISTANCE FROM PROPOSED*

LOCATION TO NEAREST
PROPERTY OR LEASE LINE, FT.
(Also to nearest drlg. unit line, if any)

120'

16. NO. OF ACRES IN LEASE

40

18. DISTANCE FROM PROPOSED LOCATION*
TO NEAREST WELL, DRILLING, COMPLETED,
OR APPLIED FOR, ON THIS LEASE, FT.

1120'

19. PROPOSED DEPTH

2700'

17. NO. OF ACRES ASSIGNED
TO THIS WELL

20. ROTARY OR CABLE TOOLS

Rotary

21. ELEVATIONS (Show whether DF, RT, GR, etc.)

22. APPROX. DATE WORK WILL START*

23.

PROPOSED CASING AND CEMENTING PROGRAM

SIZE OF HOLE	SIZE OF CASING	WEIGHT PER FOOT	SETTING DEPTH	QUANTITY OF CEMENT
11"	7 7/8"	24 ^{lb}	400	185 sacks
6 3/4"	3 1/2"	9.3 ^{lb}	2700'	400 sacks

Drill a straight hole to total depth and complete and equip this well as a water injection. Commission Order No. R-3756 authorized us to inject water into the Forest.

Application for approval of an unorthodox location was a matter of a hearing held 8-27-69 in Santa Fe. Order pending Case # 4197

RECEIVED

SEP 8 1969

SEP-5 1969

RECEIVED
GEOLOGICAL SURVEY
ALBUQUERQUE

IN ABOVE SPACE DESCRIBE PROPOSED PROGRAM: If proposal is to deepen or plug back, give data on present productive zone and proposed new productive zone. If proposal is to drill or deepen directionally, give pertinent data on subsurface conditions and measured and true vertical depths. Give blowout preventer program, if any.

ARIZONA, OFFICE

24.

SIGNED

M.E. Yeahley

TITLE

Adm. Sec. Chief

DATE

9-3-69

(This space for Federal or State office use)

PERMIT NO.

APPROVED BY

CONDITIONS OF APPROVAL, IF ANY:

APPROVED
SEP 10 1969
H. L. BECKMAN
ACTING DISTRICT ENGINEER

APPROVAL DATE

THIS APPROVAL IS RESCINDED IF OPERATIONS
ARE NOT COMMENCED WITHIN 3 MONTHS.

EXPIRES

DEC-5 1969

DATE

U.S.G.S-3
(Alaska)

*See Instructions On Reverse Side

Subject to NMOC Approval
location

NEW MEXICO OIL CONSERVATION COMMISSION
WELL LOCATION AND ACREAGE DEDICATION PLAT

Form C-102
Supersedes C-128
Effective 1-1-65

All distances must be from the outer boundaries of the Section.

Operator CONTINENTAL OIL COMPANY		Lease DONAHUE		Well No. 4	
Unit Letter F	Section 35	Township 16 SOUTH	Range 29 EAST	County EDDY	
Actual Footage Location of Well: 1980 feet from the NORTH line and 1450 feet from the WEST line					
Ground Level Elev.	Producing Formation		Pool Larcat Pool	Dedicated Acreage: 40 Acres	

1. Outline the acreage dedicated to the subject well by colored pencil or hatchure marks on the plat below.
2. If more than one lease is dedicated to the well, outline each and identify the ownership thereof (both as to working interest and royalty).
3. If more than one lease of different ownership is dedicated to the well, have the interests of all owners been consolidated by communitization, unitization, force-pooling, etc?

☐ Yes ☐ No If answer is "yes," type of consolidation _____

If answer is "no," list the owners and tract descriptions which have actually been consolidated. (Use reverse side of this form if necessary.) _____

No allowable will be assigned to the well until all interests have been consolidated (by communitization, unitization, forced-pooling, or otherwise) or until a non-standard unit, eliminating such interests, has been approved by the Commission.

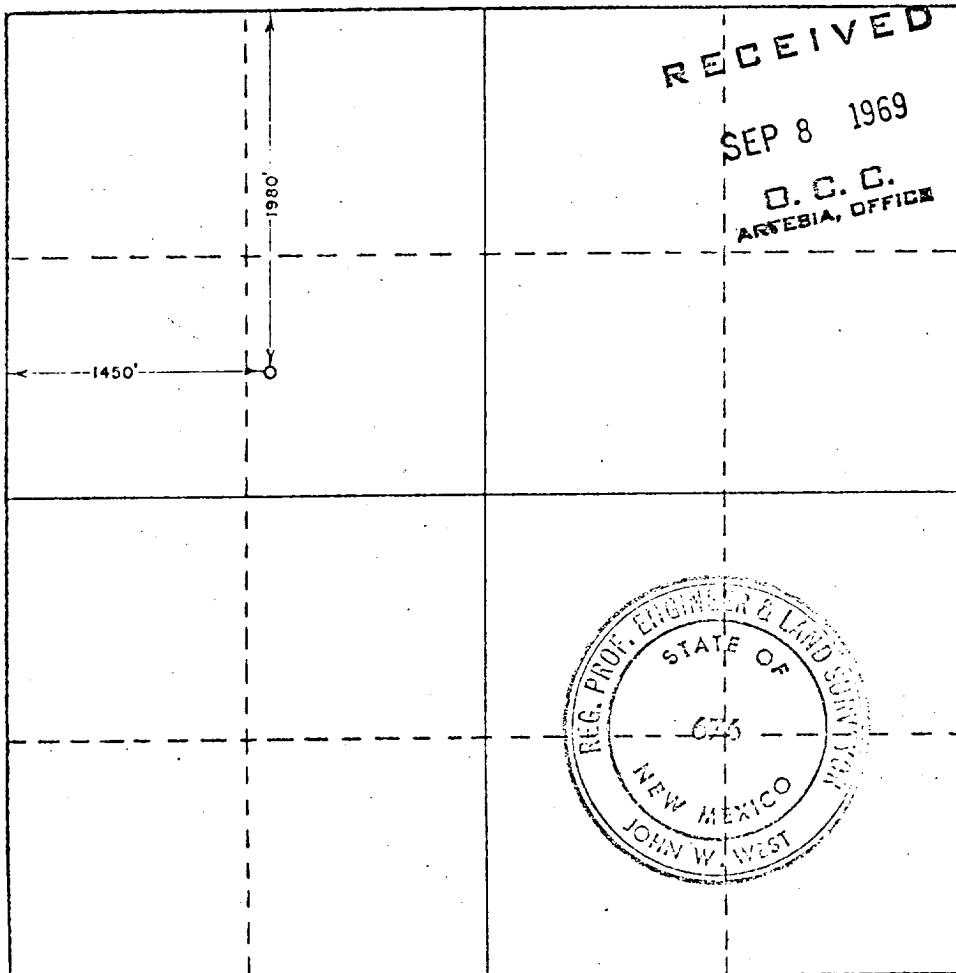

CERTIFICATION

I hereby certify that the information contained herein is true and complete to the best of my knowledge and belief.

Name **M. E. Yeakley**
Position **Adm. Section Chief**
Company **Continental Oil Co.**
Date **9-3-69**

I hereby certify that the well location shown on this plat was plotted from field notes of actual surveys made by me or under my supervision, and that the same is true and correct to the best of my knowledge and belief.

JUNE 10, 1969

Date Surveyed **John W. West**
Registered Professional Engineer
and/or Land Surveyor

Certificate No. **676**

