

NO. OF COPIES RECEIVED	11
DISTRIBUTION	
SANTA FE	1
FILE	1
U.S.G.S.	21
LAND OFFICE	
OPERATOR	5

RECEIVED
NEW MEXICO OIL CONSERVATION COMMISSION

MAR 31 1971

O. C. C.
ARTESIA, OFFICE

30-015-20405
Form C-101
Revised 1-1-65

5A. Indicate Type of Lease STATE <input type="checkbox"/> FEE <input checked="" type="checkbox"/>
5. State Oil & Gas Lease No.
7. Unit Agreement Name
8. Name of Lease Name Cisler AV
9. Well No. 4
10. Field and Pool, or Wilson/JNC. Eagle Creek SW
12. County Eddy
19. Proposed Depth Approx. 1500'
19A. Formation San Andres
20. Rotary or C.T. Rotary
21. Elevations (Show whether DE, RT, etc.) 3507' GL
21A. Kind & Status Plug. Bond Blanket
21B. Drilling Contractor Cactus Drilling Co.
22. Approx. Date Work will start When approved

APPLICATION FOR PERMIT TO DRILL, DEEPEN, OR PLUG BACK

1. Type of Work a. Type of Well OIL <input checked="" type="checkbox"/> GAS WELL <input type="checkbox"/> OTHER <input type="checkbox"/> b. Type of Well DRILL <input checked="" type="checkbox"/> DEEPEN <input type="checkbox"/> PLUG BACK <input type="checkbox"/> c. Type of Well OIL <input type="checkbox"/> GAS WELL <input type="checkbox"/> OTHER <input type="checkbox"/> SINGLE ZONE <input type="checkbox"/> MULTIPLE ZONE <input type="checkbox"/>	2. Name of Operator Petroleum Corporation ✓ 3. Address of Operator 24 South 4th Street - Artesia, New Mexico 83210
4. Location of Well UNIT LETTER <u>L</u> LOCATED <u>1650</u> FEET FROM THE <u>South</u> LINE AND <u>990'</u> FEET FROM THE <u>West</u> LINE OF SEC. <u>23</u> TWP. <u>17S</u> RGE. <u>25E</u> NMPM	5. Location of Well UNIT LETTER <u>L</u> LOCATED <u>1650</u> FEET FROM THE <u>South</u> LINE AND <u>990'</u> FEET FROM THE <u>West</u> LINE OF SEC. <u>23</u> TWP. <u>17S</u> RGE. <u>25E</u> NMPM
23. PROPOSED CASING AND CEMENT PROGRAM	

SIZE OF HOLE	SIZE OF CASING	WEIGHT PER FOOT	SETTING DEPTH	SACKS OF CEMENT	EST. TOP
9 7/8"	---	---	700'	---	---
7"	7"	20#	Approx 1150'	Circulate	
6 1/2"	4 1/2" Tapered	9.5#	" 450'	Circulate	
5 1/2"	5 1/2"	15.5#	" 1050'		

We now intend to drill a 9 7/8" hole to approx 700', reduce hole to 9" and drill to approx 1150', set 7" surface casing and circulate the cement. We will then reduce hole to 6 1/2" and drill to approx. 1500'. If production is encountered, set 4 1/2" & 5 1/2" tapered string of production casing according to the NMOC rules and regulations.

APPROVAL VALID
FOR 90 DAYS UNLESS
DRILLING COMMENCED,
EXPIRES 6-30-71

IN ABOVE SPACE DESCRIBE PROPOSED PROGRAM: IF PROPOSAL IS TO DEEPEN OR PLUG BACK, GIVE DATA ON PRESENT PRODUCTIVE ZONE AND PROPOSED NEW PRODUCTIVE ZONE. GIVE GLOWOUT PREVENTER PROGRAM, IF ANY.

I hereby certify that the information above is true and complete to the best of my knowledge and belief.

Signed [Signature] Title Engineer Date 3-29-71

(This space for State Use)

APPROVED BY W.A. Gussitt TITLE OIL AND GAS INSPECTOR DATE MAR 30 1971

CONDITIONS OF APPROVAL, IF ANY:

Cement must be circulated to
surface behind 7" casing

Notify NMOC in sufficient
time to witness cementing
the 7" casing

**N MEXICO OIL CONSERVATION COMMISSION
WELL LOCATION AND ACREAGE DEDICATION PLAT**

Form C-102
Supersedes C-128
Effective 1-1-65

All distances must be from the outer boundaries of the Section.

Operator Yates Petroleum Corp.			Lease Ginsler No. 1		Well No. 4
Unit Letter 1	Section 22	Township 11 South	Range 15 East	County Eddy	
Actual Footage Location of Well: 170' feet from the West line and 990' feet from the East line					
Ground Level Elev. 5207	Producing Formation San Andres		Pool Und. Eagle Creek S.A.		Dedicated Acreage: 40 Acres

1. Outline the acreage dedicated to the subject well by colored pencil or hatchure marks on the plat below.
2. If more than one lease is dedicated to the well, outline each and identify the ownership thereof (both as to working interest and royalty).
3. If more than one lease of different ownership is dedicated to the well, have the interests of all owners been consolidated by communitization, unitization, force-pooling, etc?

☐ Yes ☐ No If answer is "yes," type of consolidation _____

If answer is "no," list the owners and tract descriptions which have actually been consolidated. (Use reverse side of this form if necessary.) _____

No allowable will be assigned to the well until all interests have been consolidated (by communitization, unitization, forced-pooling, or otherwise) or until a non-standard unit, eliminating such interests, has been approved by the Commission.

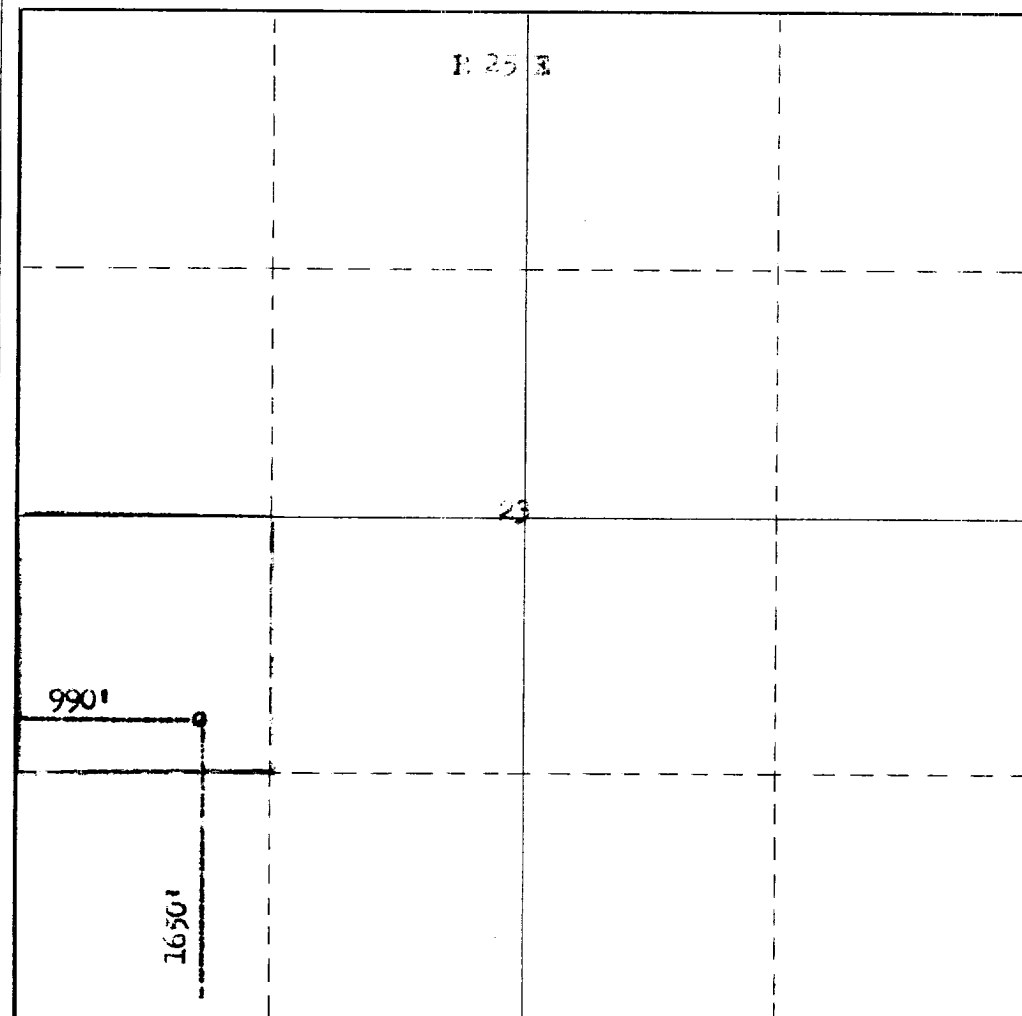

CERTIFICATION

I hereby certify that the information contained herein is true and complete to the best of my knowledge and belief.

Eddie M. Mahfood

Name Eddie M. Mahfood
Position Engineer
Company Yates Petroleum Corp.
Date 3-29-71

I hereby certify that the well location shown on this plat was plotted from field notes of actual surveys made by me or under my supervision, and that the same is true and correct to the best of my knowledge and belief.

Date Surveyed Mar 29 1971
Registered Professional Engineer and/or Land Surveyor <i>James H. Brown</i>
Certificate No. 54