

NO. OF COPIES RECEIVED	
DISTRIBUTION	
SANTA FE	
FILE	
U.S.G.S.	
LAND OFFICE	
OPERATOR	

RECEIVED
NEW MEXICO OIL CONSERVATION COMMISSION
APR 5 1971

O. C. C.
ARTESIA, OFFICE

30-015-20415
 Form C-101
 Revised 1-1-65

5A. Indicate Type of Lease
 STATE ☐ FEE ☒

5. State Oil & Gas Lease No.

7. Unit Agreement Name

8. Farm or Lease Name

J Lazy J

9. Well No.

4

10. Field and Pool, or Wildcat

Eagle Creek S.A.

12. County

Eddy

APPLICATION FOR PERMIT TO DRILL, DEEPEN, OR PLUG BACK

1a. Type of Work DRILL <input checked="" type="checkbox"/> DEEPEN <input type="checkbox"/> PLUG BACK <input type="checkbox"/>		7. Unit Agreement Name	
b. Type of Well OIL WELL <input checked="" type="checkbox"/> GAS WELL <input type="checkbox"/> OTHER <input type="checkbox"/> SINGLE ZONE <input type="checkbox"/> MULTIPLE ZONE <input type="checkbox"/>		8. Farm or Lease Name J Lazy J	
2. Name of Operator Yates Petroleum Corporation ✓		9. Well No. 4	
3. Address of Operator 207 South 4th Street - Artesia, New Mexico 88210		10. Field and Pool, or Wildcat Eagle Creek S.A.	
4. Location of Well UNIT LETTER I LOCATED 1650' FEET FROM THE South LINE 330' East 22 TWP. 17S RGE. 25E NMPM		12. County Eddy	
19. Proposed Depth Approx. 1500'		19A. Formation San Andres	
20. Rotary or C.T. Rotary		21. Elevations (Show whether DF, RT, etc.) 3516' GL	
21A. Kind & Status Plug. Bond Blanket Bond		21B. Drilling Contractor Cactus Drilling Co.	
22. Approx. Date Work will start As soon as approved			

23. PROPOSED CASING AND CEMENT PROGRAM

SIZE OF HOLE	SIZE OF CASING	WEIGHT PER FOOT	SETTING DEPTH	SACKS OF CEMENT	EST. TOP
9 7/8"	-	-	700'	-	
9"	7"	20#	Approx. 1150'	Circulate	
6 1/4"	4 1/2" (Tapered)	9.5#	" 450'	Circulate	
	5 1/2"	15.5#	" 1050'		

It is our intention to drill a 9 7/8" hole to approx. 700', reduce hole to 9" and drill to approx. 1150', set 7" surface casing and circulate the cement. We will then reduce the hole to 6 1/4" and drill to approx. 1500'. If production is encountered, set 5 1/2" & 4 1/2", tapered string, of production casing according to the NMOC rules and regulations.

**APPROVAL VALID
 FOR 90 DAYS UNLESS
 DRILLING COMMENCED,
 EXPIRES 7-5-71**

IN ABOVE SPACE DESCRIBE PROPOSED PROGRAM: IF PROPOSAL IS TO DEEPEN OR PLUG BACK, GIVE DATA ON PRESENT PRODUCTION ZONE AND PROPOSED NEW PRODUCTION ZONE, GIVE BLOWOUT PREVENTER PROGRAM, IF ANY.

I hereby certify that the information above is true and complete to the best of my knowledge and belief.

Signed Eddy J. H. H. H. Title Engineer Date 4-2-71

(This space for State Use)

APPROVED BY W. A. Gressett TITLE OIL AND GAS INSPECTOR DATE APR 5 1971

CONDITIONS OF APPROVAL, IF ANY: Notify N.M.O.C.C. in sufficient time to witness cementing the 7" casing

Cement must be circulated to surface behind 7" casing

N. MEXICO OIL CONSERVATION COMMISSION
WELL LOCATION AND ACREAGE DEDICATION PLAT

Form C-102
Supersedes C-128
Effective 1-1-65

All distances must be from the outer boundaries of the Section.

Operator Yates Petroleum Corporation			Lease J Lazy J		Well No. 4
Unit Letter XXXI I	Section 22	Township 17 South	Range 25 East	County Eddy	
Actual Footage Location of Well: 1650' feet from the South line and 330' feet from the East line					
Ground Level Elev. 3516	Producing Formation San Andres		Pool Eagle Creek S.A.		Dedicated Acreage: 40 Acres

1. Outline the acreage dedicated to the subject well by colored pencil or hachure marks on the plat below.
2. If more than one lease is dedicated to the well, outline each and identify the ownership thereof (both as to working interest and royalty).
3. If more than one lease of different ownership is dedicated to the well, have the interests of all owners been consolidated by communitization, unitization, force-pooling, etc?

☐ Yes ☐ No If answer is "yes," type of consolidation _____

If answer is "no," list the owners and tract descriptions which have actually been consolidated. (Use reverse side of this form if necessary.) _____

No allowable will be assigned to the well until all interests have been consolidated (by communitization, unitization, forced-pooling, or otherwise) or until a non-standard unit, eliminating such interests, has been approved by the Commission.

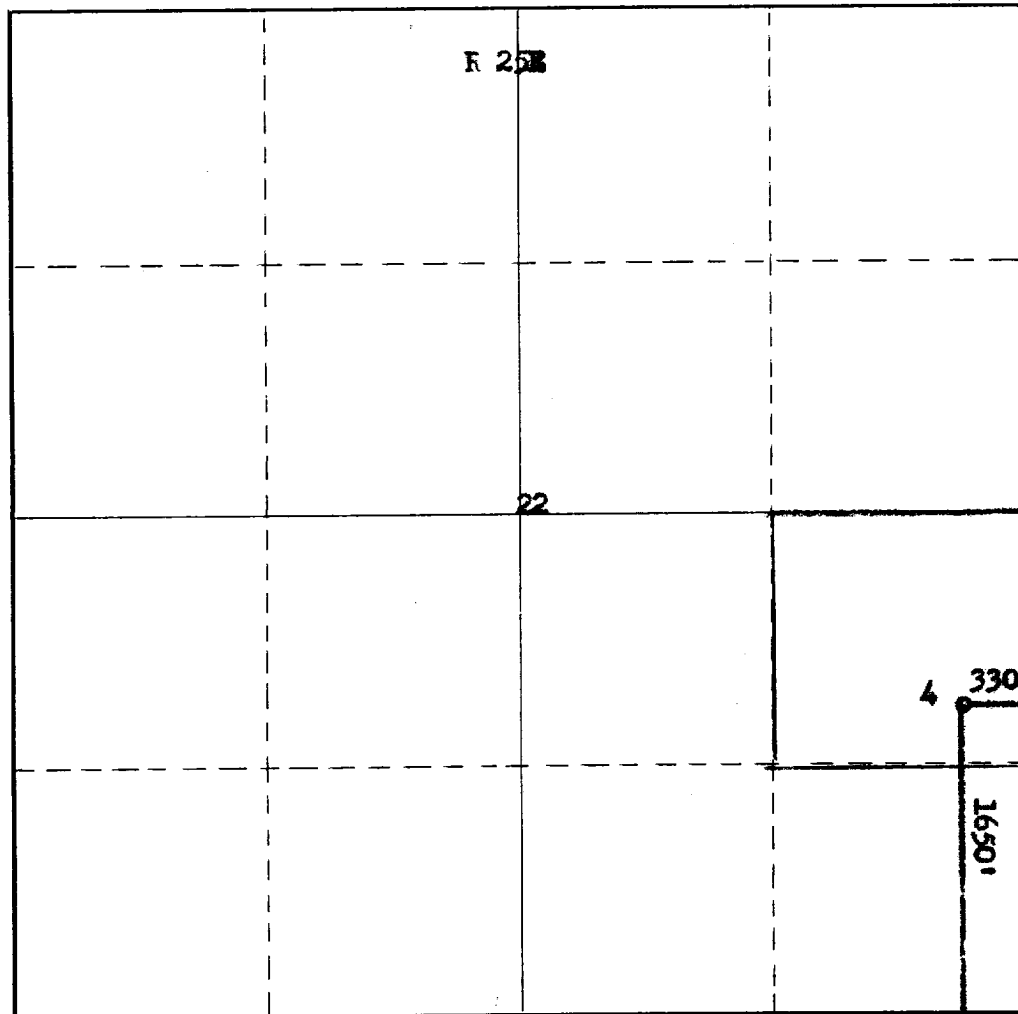

CERTIFICATION

I hereby certify that the information contained herein is true and complete to the best of my knowledge and belief.

Eddie M. Mahfood
Name

Eddie M. Mahfood

Position
Engineer

Company
Yates Petroleum Corp.

Date
4-2-71

I hereby certify that the well location shown on this plat was plotted from field notes and actual surveys made by me or under my supervision, and that the same is true and correct to the best of my knowledge and belief.

Date Surveyed
March 30 1971

Registered Professional Engineer and/or Land Surveyor

James H. Brown
Certificate No.
542