

Form 9-331 C
(May 1963)SUBMIT IN TR DATE*
(Other instructions on
reverse side)Form approved.
Budget Bureau No. 42-R1425.UNITED STATES
DEPARTMENT OF THE INTERIOR
GEOLOGICAL SURVEY

30-115-20489

APPLICATION FOR PERMIT TO DRILL, DEEPEN, OR PLUG BACK

1a. TYPE OF WORK

DRILL ☒DEEPEN ☐PLUG BACK ☐

b. TYPE OF WELL

OIL
WELL ☒GAS
WELL ☐

OTHER

SINGLE
ZONE ☐MULTIPLE
ZONE ☐

2. NAME OF OPERATOR

Yates Petroleum Corporation ✓

3. ADDRESS OF OPERATOR

207 South 4th Street - Artesia, New Mexico

4. LOCATION OF WELL (Report location clearly and in accordance with any State requirements.*)

At surface

330' FSL & 2310' FWL of Sec. 15-17S-25E

At proposed prod. zone

14. DISTANCE IN MILES AND DIRECTION FROM NEAREST TOWN OR POST OFFICE*

Approx. 6 miles West of Artesia, New Mexico

10. DISTANCE FROM PROPOSED* 330'
LOCATION TO NEAREST
PROPERTY OR LEASE LINE, FT.
(Also to nearest drlg. unit line, if any)

16. NO. OF ACRES IN LEASE

17. NO. OF ACRES ASSIGNED
TO THIS WELL

40

18. DISTANCE FROM PROPOSED LOCATION*
TO NEAREST WELL, DRILLING, COMPLETED,
OR APPLIED FOR, ON THIS LEASE, FT.

19. PROPOSED DEPTH

Approx. 1500'

20. ROTARY OR CABLE TOOLS

Rotary

21. ELEVATIONS (Show whether DF, RT, GR, etc.)

3528' GL

22. APPROX. DATE WORK WILL START*

Immediately

23. PROPOSED CASING AND CEMENTING PROGRAM

SIZE OF HOLE	SIZE OF CASING	WEIGHT PER FOOT	SETTING DEPTH	QUANTITY OF CEMENT
13 3/4"	10 3/4"	32#	200'	Circulate
9 7/8"	7"	20#	1130'	Circulate
6 1/8"	4 1/2") Tapered 5 1/2")	9.5# 14#	450') 1050') 1500'	Circulate

It is our intention to drill a 13 3/4" hole to approx. 200', set 10 3/4" casing, if necessary, and circulate, then reduce hole to 9 7/8"- drill to approx. 1130', set 7" surface casing and circulate, reduce hole to 6 1/8" and drill to a total depth of approx. 1500'. If production is encountered, a tapered string of production casing will be set according to the USGS rules and regulations.

RECEIVED
AUG 18 1971

RECEIVED

AUG 16 1971

U. S. GEOLOGICAL SURVEY
ARTESIA, NEW MEXICO

IN ABOVE SPACE DESCRIBE PROPOSED PROGRAM: If proposal is to deepen or plug back, give location of present productive zone and proposed new productive zone. If proposal is to drill or deepen directionally, give pertinent data on subsurface locations and measured and true vertical depths. Give blowout preventer program, if any.

24.

SIGNED

Eddie M. Healy

TITLE Engineer

DATE 8-16-71

(This space for Federal or State office use)

AUG 16 1971

PERMIT NO.

APPROVAL DATE

APPROVED BY

J. T. Rouse

TITLE

DISTRICT ENGINEER

DATE

AUG 16 1971

CONDITIONS OF APPROVAL, IF ANY:

DECLARED WATER BASIN

CEMENT BEHIND THE 10 3/4" + 7"
CASING MUST BE CIRCULATED

*See Instructions On Reverse Side

NOTIFY USGS IN SUFFICIENT TIME TO
WITNESS CEMENTING THE 10 3/4" + 7" CASING.

**MEXICO OIL CONSERVATION COMMISSION
WELL LOCATION AND ACREAGE DEDICATION PLAT**

Form C-102
Supersedes C-128
Effective 1-1-65

All distances must be from the outer boundaries of the Section.

Operator Yates SE Petroleum Corporation			Lease Federal CB		Well No. X 1
Unit Letter N	Section 15	Township 17 South	Range 25 East	County Eddy	
Actual Footage Location of Well: 330 XXXX feet from the South line and 2310 feet from the West line					
Ground Level Elev. 3528	Producing Formation San Andres		Pool Und. Eagle Creek S.A.		Dedicated Acreage: 40 Acres

1. Outline the acreage dedicated to the subject well by colored pencil or hachure marks on the plat below.
2. If more than one lease is dedicated to the well, outline each and identify the ownership thereof (both as to working interest and royalty).
3. If more than one lease of different ownership is dedicated to the well, have the interests of all owners been consolidated by communitization, unitization, force-pooling, etc?

☐ Yes ☐ No If answer is "yes," type of consolidation _____

If answer is "no," list the owners and tract descriptions which have actually been consolidated. (Use reverse side of this form if necessary.) _____

No allowable will be assigned to the well until all interests have been consolidated (by communitization, unitization, forced-pooling, or otherwise) or until a non-standard unit, eliminating such interests, has been approved by the Commission.

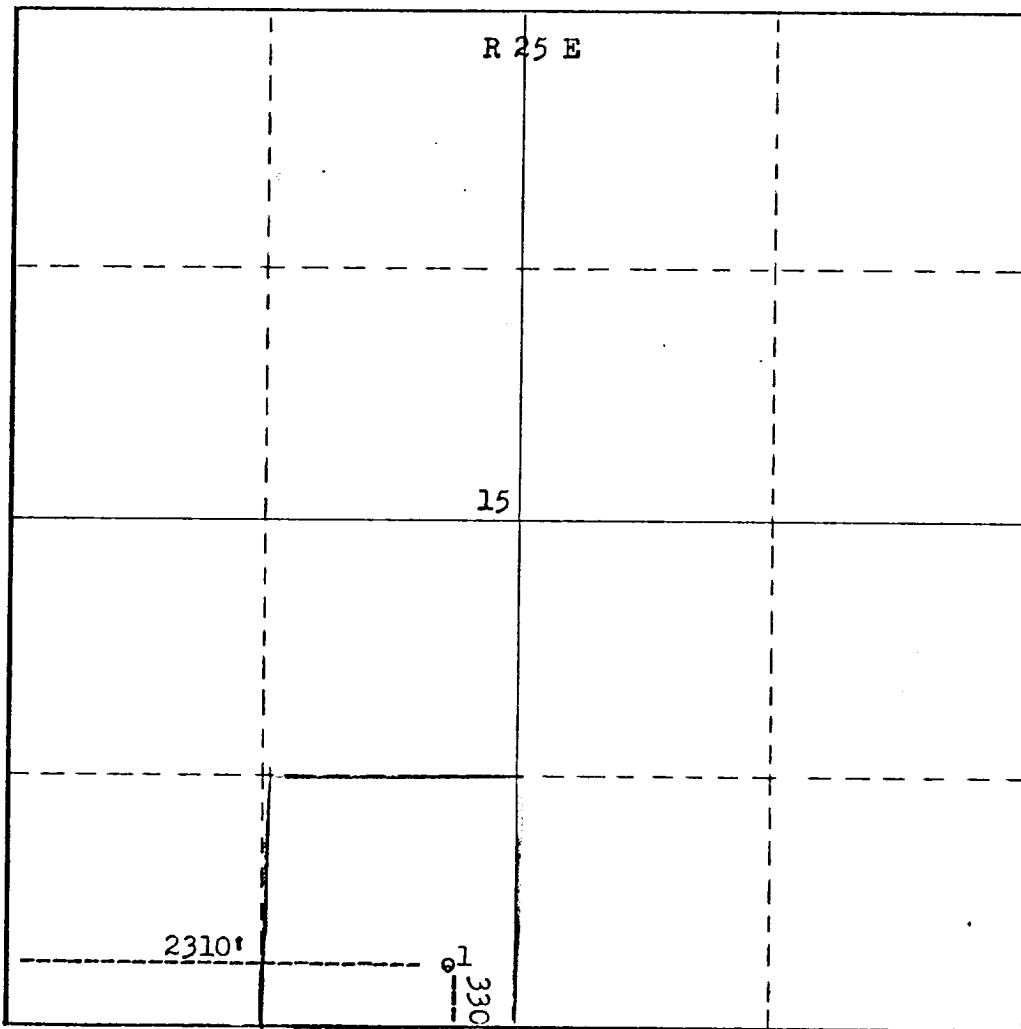

CERTIFICATION

I hereby certify that the information contained herein is true and complete to the best of my knowledge and belief.

Eddie M. Mahfood
Name
Eddie M. Mahfood

Position
Engineer

Company
Yates Pet. Corporation

Date
8-16-71

I hereby certify that the well location shown on this plat is from field notes of actual surveys made by me or under my supervision and that the same is true and correct to the best of my knowledge and belief.

RECEIVED
AUG 16 1971
U.S. GEOLOGICAL SURVEY
ARTESIA, NEW MEXICO

Date Surveyed

July 29 1971

Registered Professional Engineer
and/or Land Surveyor

James H. Brown
Certificate No.
542

T
17
S