

UNITED STATES
DEPARTMENT OF THE INTERIOR
GEOLOGICAL SURVEY

30-015-20495

5. LEASE DESIGNATION AND SERIAL NO.
NM 0630

6. IF INDIAN, ALLOTTEE OR TRIBE NAME

7. UNIT AGREEMENT NAME

8. FARM OR LEASE NAME

Federal LDY

9. WELL NO.

3

10. FIELD AND POOL, OR WILDCAT Und.
Eagle Creek S.A.11. SEC., T., R., M., OR BLK.
AND SURVEY OR AREA
Sec. 27-17S-25E

Unit F NMPM

12. COUNTY OR PARISH 13. STATE

Eddy

N. Mex.

APPLICATION FOR PERMIT TO DRILL, DEEPEN, OR PLUG BACK

1a. TYPE OF WORK

DRILL ☒DEEPEN ☐PLUG BACK ☐

b. TYPE OF WELL

OIL
WELL ☒GAS
WELL ☐

OTHER

SINGLE
ZONE ☐MULTIPLE
ZONE ☐

2. NAME OF OPERATOR

Yates Petroleum Corporation ✓

3. ADDRESS OF OPERATOR

207 South 4th Street - Artesia, New Mexico 88210

4. LOCATION OF WELL (Report location clearly and in accordance with any State requirements.)*

At surface

2310' FNL & 2310' FWL of Sec. 27-17S-25E

At proposed prod. zone

14. DISTANCE IN MILES AND DIRECTION FROM NEAREST TOWN OR POST OFFICE*

Approx. 5 miles from Artesia, New Mexico 88210

15. DISTANCE FROM PROPOSED* LOCATION TO NEAREST
PROPERTY OR LEASE LINE, FT.
(Also to nearest drlg. unit line, if any)

2310'

16. NO. OF ACRES IN LEASE

17. NO. OF ACRES ASSIGNED
TO THIS WELL

40

18. DISTANCE FROM PROPOSED LOCATION*
TO NEAREST WELL, DRILLING, COMPLETED,
OR APPLIED FOR, ON THIS LEASE, FT.

19. PROPOSED DEPTH

Approx. 1500'

20. ROTARY OR CABLE TOOLS

Rotary

21. ELEVATIONS (Show whether DF, RT, GR, etc.)

3531' GL

22. APPROX. DATE WORK WILL START*

Immediately

23.

PROPOSED CASING AND CEMENTING PROGRAM

SIZE OF HOLE	SIZE OF CASING	WEIGHT PER FOOT	SETTING DEPTH	QUANTITY OF CEMENT
13 3/4"	10 3/4"	32#	150'	Circulate
9 7/8"	7"	20#	1130'	Circulate
6 1/8"	4 1/2") Tapered 11#		450') 1500'	Circulate
	5 1/2") 14#		1050'	

It is our intention to drill a 13 3/4" hole to approx. 150', set 10 3/4" casing, if necessary, and circulate, then reduce hole to 9 7/8" and drill to approx. 1130', set 7" surface casing and circulate, reduce hole to 6 1/8" and drill to a total depth of approx. 1500'. If production is encountered, a tapered string of production casing will be set according to USGS rules and regulations.

RECEIVED

SEP 1 1971

D. C. C.

ARTESIA, NEW MEXICO

RECEIVED

AUG 31 1971

U. S. GEOLOGICAL SURVEY

ARTESIA, NEW MEXICO

IN ABOVE SPACE DESCRIBE PROPOSED PROGRAM: If proposal is to deepen or plug back, give data on present productive zone and proposed new productive zone. If proposal is to drill or deepen directionally, give pertinent data on subsurface locations and measured and true vertical depths. Give blowout preventer program, if any.

24.

SIGNED

E. L. BEEKMAN

TITLE

Engineer

DATE

8-31-71

(This space for Federal or State office use)

PERMIT NO.

APPROVED

CONDITIONS OF APPROVAL, IF ANY:

AUG 31 1971

H. L. BEEKMAN

ACTING DISTRICT ENGINEER

THIS APPROVAL IS RESCINDED IF OPERATIONS
ARE NOT COMMENCED WITHIN 3 MONTHS.
EXPIRES NOV 31 1971

*See Instructions On Reverse Side

DECLARED WATER BASIN

CEMENT BEHIND THE
CASING MUST BE CIRCULATEDNOTIFY USGS IN SUFFICIENT TIME TO
FINISH CEMENTING THE CASING

NEW MEXICO OIL CONSERVATION COMMISSION
WELL LOCATION AND ACREAGE DEDICATION PLAT

Form C-102
Supersedes C-128
Effective 1-1-65

All distances must be from the outer boundaries of the Section.

Operator Yates Petroleum Corp.			Lease 23111		Well No. 2
Unit Letter 2311	Section 10	Township 33N	Range 23E	County MC	
Actual Footage Location of Well: 2311 feet from the 107th line and 2311 feet from the 107th line					
Ground Level Elev. 2311	Producing Formation San Andres	Pool Und. Eagle Creek S.A.		Dedicated Acreage: 2311 Acres	

1. Outline the acreage dedicated to the subject well by colored pencil or hachure marks on the plat below.
2. If more than one lease is dedicated to the well, outline each and identify the ownership thereof (both as to working interest and royalty).
3. If more than one lease of different ownership is dedicated to the well, have the interests of all owners been consolidated by communitization, unitization, force-pooling, etc?

☐ Yes ☐ No If answer is "yes," type of consolidation _____

If answer is "no," list the owners and tract descriptions which have actually been consolidated. (Use reverse side of this form if necessary.) _____

No allowable will be assigned to the well until all interests have been consolidated (by communitization, unitization, forced-pooling, or otherwise) or until a non-standard unit, eliminating such interests, has been approved by the Commission.

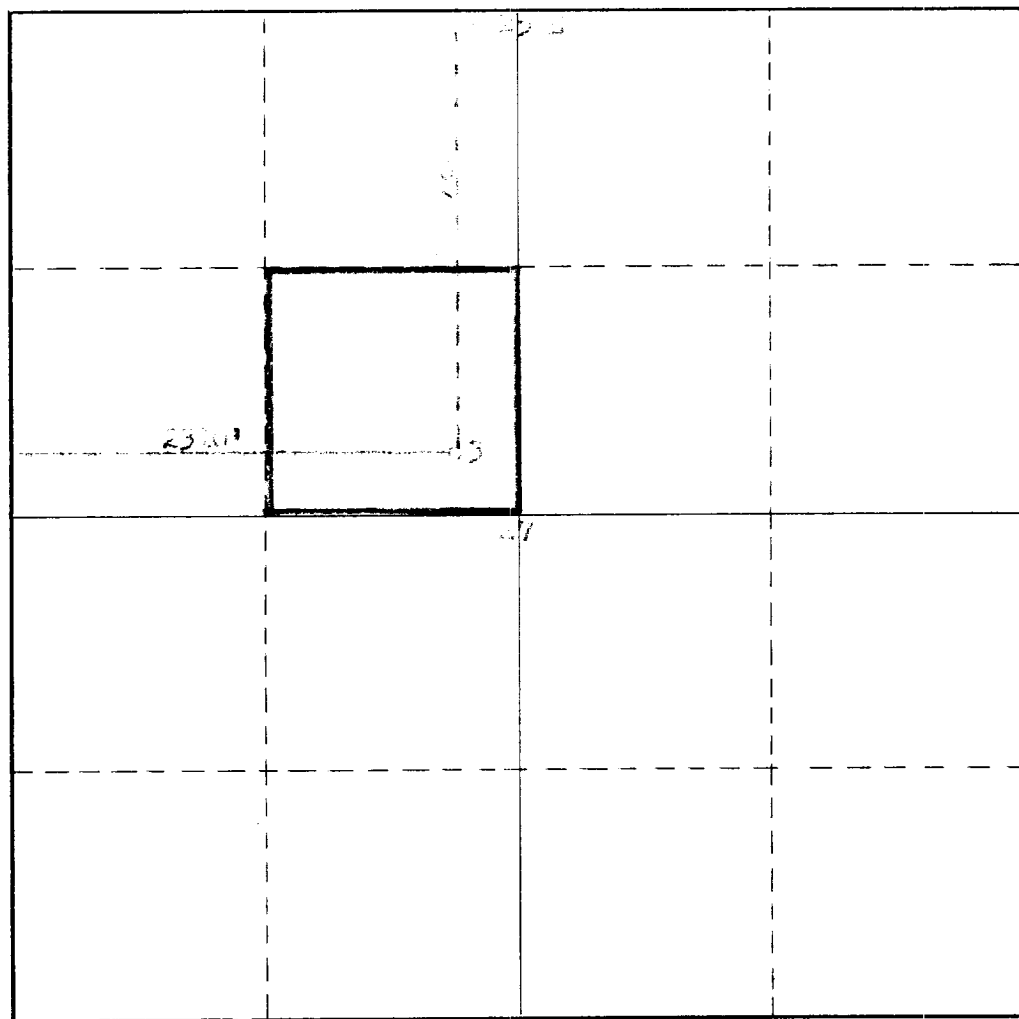

CERTIFICATION

I hereby certify that the information contained herein is true and complete to the best of my knowledge and belief.

Eddie M. Mahfood
Name
Eddie M. Mahfood

Position
Engineer

Company
Yates Pet. Corporation

Date
8-31-71

I hereby certify that the well location shown on this plat was plotted from field notes of actual surveys made by me or under my supervision, and that the same is true and correct to the best of my knowledge and belief.

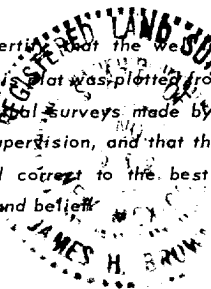

Date Surveyed

Aug. 31, 1971

Registered Professional Engineer and/or Land Surveyor

Certificate No.

