

NO. OF COPIES RECEIVED	
DISTRIBUTION	
SANTA FE	
FILE	
U.S.G.S.	
LAND OFFICE	
OPERATOR	

RECEIVED NEW MEXICO OIL CONSERVATION COMMISSION

OCT 1 1971

O. C. C.
ARTESIA, OFFICE

30-115-20509

Form C-101
Revised 1-1-65

5A. Indicate Type of Lease
STATE ☐ FEE ☒

5. State Oil & Gas Lease No.

APPLICATION FOR PERMIT TO DRILL, DEEPEN, OR PLUG BACK

1a. Type of Work b. Type of Well OIL WELL <input checked="" type="checkbox"/> GAS WELL <input type="checkbox"/> OTHER <input type="checkbox"/> SINGLE ZONE <input type="checkbox"/> MULTIPLE ZONE <input type="checkbox"/>		7. Unit Agreement Name	
2. Name of Operator Yates Petroleum Corporation/		8. Farm or Lease Name Morris Estate CC	
3. Address of Operator 207 South 4th Street - Artesia, New Mexico 88210		9. Well No. 1	
4. Location of Well UNIT LETTER M LOCATED 330 FEET FROM THE South LINE AND 990 FEET FROM THE West LINE OF SEC. 14 TWP. 17S RGE. 25E NMPM		10. Field and Pool, or Wildcat Area. Eagle Creek S.A.	
12. County Eddy			
19. Proposed Depth Approx. 1500'		19A. Formation San Andres	
20. Rotary or C.T. Rotary			
21. Elevations (Show whether DL, RT, etc.) 3499' GL		21A. Kind & Status Plug. Bond Blanket	
21B. Drilling Contractor Cactus Drilling Co.		22. Approx. Date Work will start Immediately	

23. PROPOSED CASING AND CEMENT PROGRAM

SIZE OF HOLE	SIZE OF CASING	WEIGHT PER FOOT	SETTING DEPTH	SACKS OF CEMENT	EST. TOP
13 3/4"	10 3/4"	32#	200'	Circulate	
9 7/8"	7"	23#	1100'	Circulate	
6 1/4"	4 1/2") Tapered 5 1/2")	9.5# 14#	450') 1050') 1500'	Circulate	

It is our intention to drill a 13 3/4" hole to approx. 200', set 10 3/4" casing, if necessary, and circulate, then reduce hole to 9 7/8", drill to approx. 1100', set 7" surface casing and circulate, reduce hole to 6 1/4" drill to a total depth of approx. 1500'. If production is encountered, a tapered string of production casing will be set according to the NMOCC rules and regulations.

APPROVAL VALID
FOR 90 DAYS UNLESS
DRILLING COMMENCED,
EXPIRES 1-1-72

IN ABOVE SPACE DESCRIBE PROPOSED PROGRAM: IF PROPOSAL IS TO DEEPEN OR PLUG BACK, GIVE DATA ON PRESENT PRODUCTIVE ZONE AND PROPOSED NEW PRODUCTIVE ZONE. GIVE BLOWOUT PREVENTER PROGRAM, IF ANY.

I hereby certify that the information above is true and complete to the best of my knowledge and belief.

Signed W. A. Gassett Title Owner Date 9-17-71

(This space for State Use)

APPROVED BY W. A. Gassett TITLE OIL AND GAS INSPECTOR DATE OCT 1 1971

CONDITIONS OF APPROVAL, IF ANY:
Cement must be circulated
surface behind 6 1/4" casing

Notify N.M.O.C.C. in sufficient
time to witness cementing

N. MEXICO OIL CONSERVATION COMMISSION
WELL LOCATION AND ACREAGE DEDICATION PLAT

Form C-102
Supersedes C-128
Effective 1-1-65

All distances must be from the outer boundaries of the Section.

Operator YATES PETROLEUM CORPORATION			Lease MORRIS Est. CC		Well No. 1
Unit Letter M	Section 14	Township 17S	Range 25E	County Eddy	
Actual Footage Location of Well: 330 feet from the South line and 990 feet from the West line					
Ground Level Elev. 3499	Producing Formation San Andres		Pool Eagle Creek S.A.		Dedicated Acreage: 40 Acres

1. Outline the acreage dedicated to the subject well by colored pencil or hachure marks on the plat below.
2. If more than one lease is dedicated to the well, outline each and identify the ownership thereof (both as to working interest and royalty).
3. If more than one lease of different ownership is dedicated to the well, have the interests of all owners been consolidated by communitization, unitization, force-pooling, etc?

☐ Yes ☐ No If answer is "yes," type of consolidation _____

If answer is "no," list the owners and tract descriptions which have actually been consolidated. (Use reverse side of this form if necessary.) _____

No allowable will be assigned to the well until all interests have been consolidated (by communitization, unitization, forced-pooling, or otherwise) or until a non-standard unit, eliminating such interests, has been approved by the Commission.

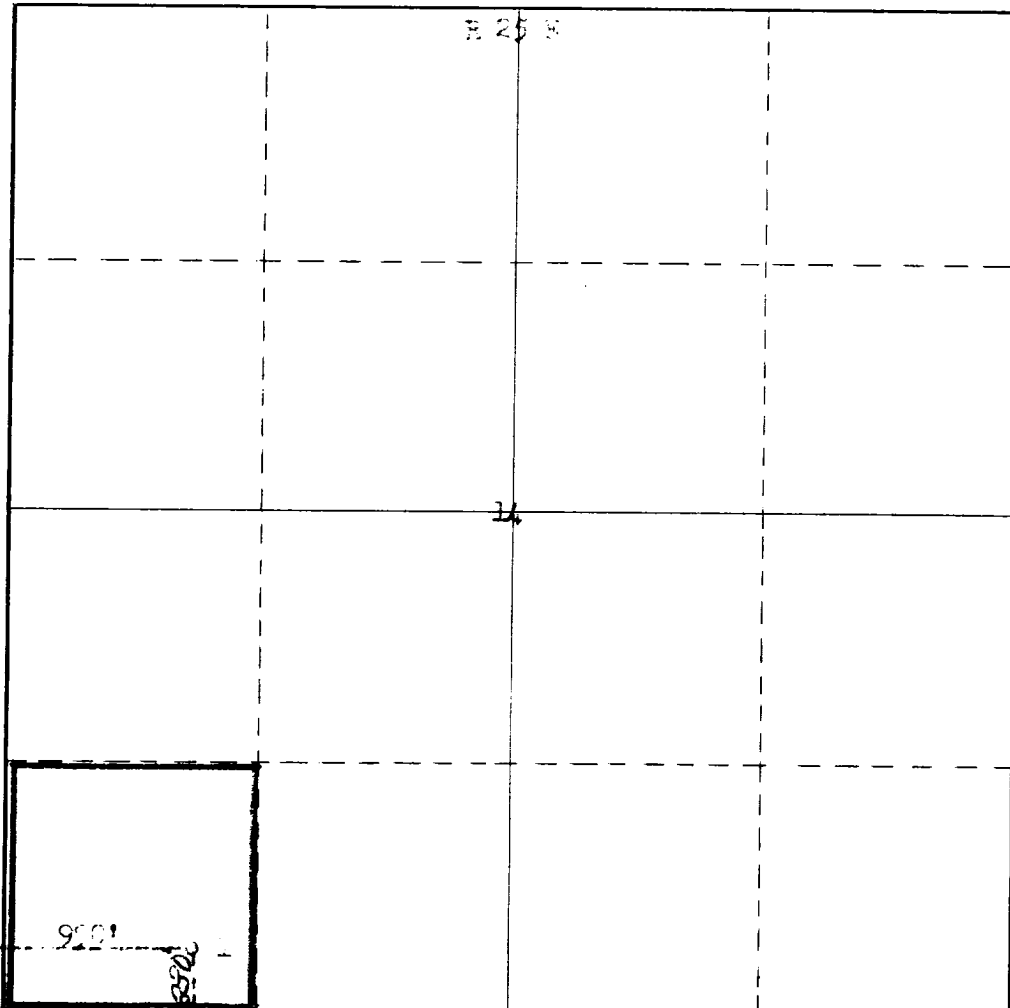

CERTIFICATION

I hereby certify that the information contained herein is true and complete to the best of my knowledge and belief.

Eddie M. Mahfood
Name

Eddie M. Mahfood

Position

Engineer

Company

Yates Pet. Corporation

Date

9-17-71

I hereby certify that the well location shown on this plat was plotted from field notes of actual surveys made by me or under my supervision and that the same is true and correct to the best of my knowledge and belief.

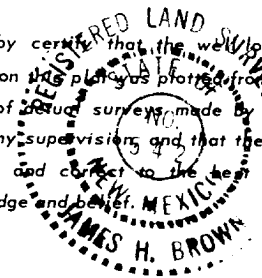

Date Surveyed

September 9th, 1971

Registered Professional Engineer
and/or Land Surveyor

James H. Brown
Certificate No.

542

