

NO. OF COPIES RECEIVED	2
DISTRIBUTION	
SANTA FE	1
FILE	1
U.S.G.S.	1
LAND OFFICE	
OPERATOR	1

RECEIVED

NEW MEXICO OIL CONSERVATION COMMISSION
NOV 10 1971

O. C. C.
ARTESIA, OFFICE

30-015-20534

Form C-101
Revised 1-1-65

5A. Indicate Type of Lease
STATE ☐ FEE ☒

5. State Oil & Gas Lease No.

APPLICATION FOR PERMIT TO DRILL, DEEPEN, OR PLUG BACK

1a. Type of Work DRILL <input checked="" type="checkbox"/> DEEPEN <input type="checkbox"/> PLUG BACK <input type="checkbox"/>		7. Unit Agreement Name	
b. Type of Well OIL WELL <input type="checkbox"/> GAS WELL <input checked="" type="checkbox"/> OTHER <input type="checkbox"/>		8. Farm or Lease Name Holden	
2. Name of Operator Delaware-Apache Corporation		9. Well No. 1	
3. Address of Operator 1720 Wilco Bldg. Midland, Texas 79701		10. Field and Pool, or Wildcat Wildcat	
4. Location of Well UNIT LETTER J LOCATED 1980 FEET FROM THE South LINE		11. Field and Pool, or Wildcat Wildcat	
AND 1980 FEET FROM THE East LINE OF SEC. 12 TWP. 17S RGE. 26E N40PM		12. County Eddy	
19. Proposed Depth 8800'		19A. Formation Morrow Sd	
20. Rotary or C.T. Rotary			
21. Elevations (Show whether Dr, RT, etc.) Gr 3304'		21A. Kind & Status Plug. Bond Statewide	
21B. Drilling Contractor unknown		22. Approx. Date Work will start immediately	

23.

PROPOSED CASING AND CEMENT PROGRAM

SIZE OF HOLE	SIZE OF CASING	WEIGHT PER FOOT	SETTING DEPTH	SACKS OF CEMENT	EST. TOP
17-1/2"	12-3/4"	34#	350'	400	surface
11"	8-5/8"	24#	1500	650	circ to surface
7 7/8"	4 1/2"	11.6	8800	4-600	

Series 900, Double Ram, Hydraulic, 2000-3000 Psi

THIS FORM IS VALID
FOR 60 DAYS UNLESS
DRILLING COMMENCED,
EXPIRES 2-11-72

IN ABOVE SPACE DESCRIBE PROPOSED PROGRAM: IF PROPOSAL IS TO DEEPEN OR PLUG BACK, GIVE DATA ON PRESENT PRODUCTIVE ZONE AND PROPOSED NEW PRODUCTIVE ZONE. GIVE BLOWOUT PREVENTER PROGRAM, IF ANY.

I hereby certify that the information above is true and complete to the best of my knowledge and belief.

Signed Bonnie Husband Title Production Clerk Date 11-9-71

(This space for State Use)

APPROVED BY W. A. Gressett TITLE OIL AND GAS INSPECTOR DATE NOV 11 1971

CONDITIONS OF APPROVAL, IF ANY:

Cement must be circulated to
surface behind 12 3/4" & 8 5/8" casing

Notify N.M.O.C.C. in sufficient
time to witness cementing
the 8 7/8" casing

Notify N.M.O.C.C. in sufficient time to witness
Inspect 8 7/8" Casing

NEW MEXICO OIL CONSERVATION COMMISSION
WELL LOCATION AND ACREAGE DEDICATION PLAT

Form C-102
Supersedes C-128
Effective 1-1-65

All distances must be from the outer boundaries of the Section.

Operator DELAWARE APACHE CORP.			Lease HOLDEN		Well No. 1
Unit Letter J	Section 12	Township 17 SOUTH	Range 26 EAST	County EDDY	
Actual Footage Location of Well:					
1980 feet from the SOUTH line and		1980 feet from the EAST line			
Ground Level Elev. 3304	Producing Formation Morrow Sd	Pool Wildcat	Dedicated Acreage: 320 Acres		

1. Outline the acreage dedicated to the subject well by colored pencil or hachure marks on the plat below.
2. If more than one lease is dedicated to the well, outline each and identify the ownership thereof (both as to working interest and royalty).
3. If more than one lease of different ownership is dedicated to the well, have the interests of all owners been consolidated by communitization, unitization, force-pooling, etc?

☐ Yes ☐ No If answer is "yes," type of consolidation _____

If answer is "no," list the owners and tract descriptions which have actually been consolidated. (Use reverse side of this form if necessary.) _____

No allowable will be assigned to the well until all interests have been consolidated (by communitization, unitization, forced-pooling, or otherwise) or until a non-standard unit, eliminating such interests, has been approved by the Commission.

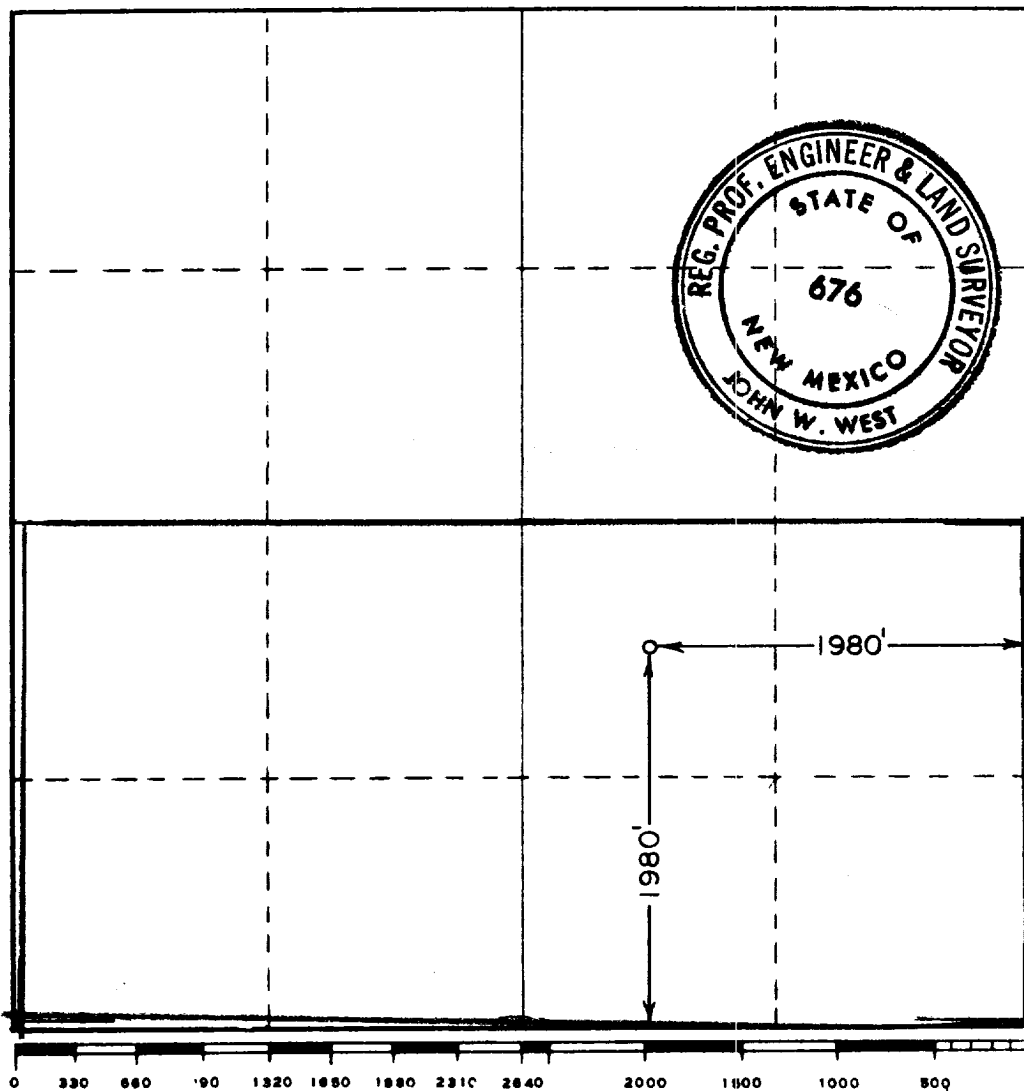

CERTIFICATION

I hereby certify that the information contained herein is true and complete to the best of my knowledge and belief.

Bonnie Husband

Name

Bonnie Husband

Position

Production Clerk

Company

Delaware-Apache Corp.

Date

11-9-71

I hereby certify that the well location shown on this plat was plotted from field notes of actual surveys made by me or under my supervision, and that the same is true and correct to the best of my knowledge and belief.

Date Surveyed

NOVEMBER 8, 1971

Registered Professional Engineer and/or Land Surveyor

John W. West

Certificate No.

676