

Notify N.M.O.C.C. in sufficient  
time to witness cementing  
the 8 5/8" casing

**MEXICO OIL CONSERVATION COMMISS**  
**WELL LOCATION AND ACREAGE DEDICATION PLAT**

Form C-102  
 Supersedes C-128  
 Effective 1-1-65

All distances must be from the outer boundaries of the Section.

Operator <b>PUBCO PETROLEUM CORP.</b>			Lease <b>Cass North "Com"</b>		Well No. <b>1</b>
Unit Letter <b>0</b>	Section <b>29</b>	Township <b>17 SOUTH</b>	Range <b>24 EAST</b>	County <b>EDDY</b>	
Actual Footage Location of Well: <b>660</b> feet from the <b>SOUTH</b> line and <b>1980</b> feet from the <b>EAST</b> line					
Ground Level Elev. <b>3824.5</b>	Producing Formation <i>Permian</i>		Pool <b>Wildcat</b>	Dedicated Acreage: <b>320</b> Acres	

1. Outline the acreage dedicated to the subject well by colored pencil or hachure marks on the plat below.
2. If more than one lease is dedicated to the well, outline each and identify the ownership thereof (both as to working interest and royalty).
3. If more than one lease of different ownership is dedicated to the well, have the interests of all owners been consolidated by communitization, unitization, force-pooling, etc?

☒ Yes    ☐ No    If answer is "yes," type of consolidation Communitization

If answer is "no," list the owners and tract descriptions which have actually been consolidated. (Use reverse side of this form if necessary.) \_\_\_\_\_

No allowable will be assigned to the well until all interests have been consolidated (by communitization, unitization, forced-pooling, or otherwise) or until a non-standard unit, eliminating such interests, has been approved by the Commission.

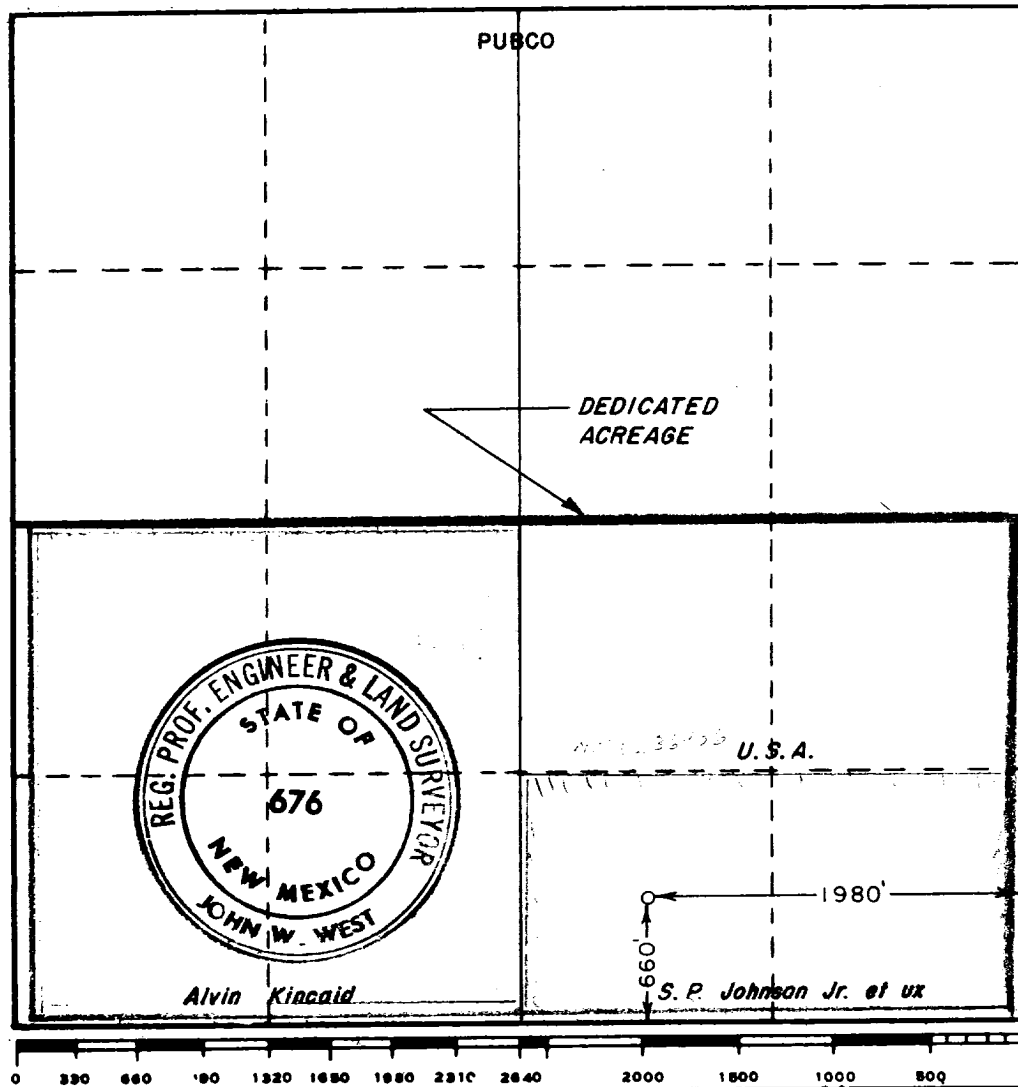

**CERTIFICATION**

I hereby certify that the information contained herein is true and complete to the best of my knowledge and belief.

*[Signature]*  
 Name

**J. C. Johnson**

Position

**Vice President Production**

Company

**Pubco Petroleum Corporation**

Date

**January 26, 1972**

I hereby certify that the well location shown on this plat was plotted from field notes of actual surveys made by me or under my supervision, and that the same is true and correct to the best of my knowledge and belief.

Date Surveyed

**JANUARY 5, 1972**

Registered Professional Engineer and/or Land Surveyor

*[Signature]*  
 Certificate No. **676**

1/11/72 - 1 copy

*BeHe*

Box 1357  
Roswell, New Mexico 88201

January 11, 1972

Public Petroleum Corporation  
P. O. Box 869  
Albuquerque, New Mexico 87103

Attention: Mr. James A. Wilkinson

Gentlemen:

Enclosed are three approved copies of communitization agreement  
No. Can. Agr.-SU-625 involving 80 acres of land in Federal lands  
New Mexico 0236986 and 240 acres of privately owned land, Eddy  
County, New Mexico.

The agreement communitizes all rights as to dry gas and associated  
liquid hydrocarbons producible from the Atocha formation in the  
S $\frac{1}{2}$  sec. 29, T. 17 S., R. 24 E., N.M.P.M., and is effective as of  
December 30, 1971.

You are requested to furnish all interested principals with appropriate  
evidence of this approval.

Sincerely yours,

(ORIG. SEC. 1 N. O. F. 10000)

N. O. FREDERICK  
Regional Oil and Gas Supervisor

cc:  
Washington (2) (w/cy agr.)  
Artesia (w/cy agr.) ✓  
BIM, Santa Fe (w/cy agr.)

