

NO. OF COPIES RECEIVED	5
DISTRIBUTION	
SANTA FE	1
FILE	1
U.S.G.S.	1
LAND OFFICE	1
OPERATOR	1

NEW MEXICO OIL CONSERVATION COMMISSION

JUL 23 1973

O. C. C.
ARTESIA, OFFICE

30-015-20913
Form C-101
Revised 1-1-65

5A. Indicate Type of Lease
STATE ☐ FEE ☒

5. State Oil & Gas Lease No.

APPLICATION FOR PERMIT TO DRILL, DEEPEN, OR PLUG BACK

1a. Type of Work DRILL <input checked="" type="checkbox"/> DEEPEN <input type="checkbox"/> PLUG BACK <input type="checkbox"/>		7. Unit Agreement Name
b. Type of Well OIL WELL <input type="checkbox"/> GAS WELL <input checked="" type="checkbox"/> OTHER <input type="checkbox"/> SINGLE ZONE <input checked="" type="checkbox"/> MULTIPLE ZONE <input type="checkbox"/>		8. Farm or Lease Name Bolton "CU" Com
2. Name of Operator Yates Petroleum Corporation		9. Well No. 1
3. Address of Operator 207 South 4th Street - Artesia, NM 88210		10. Field and Pool, or Wildcat Undesignated
4. Location of Well UNIT LETTER B LOCATED 660 FEET FROM THE North LINE AND 2180 FEET FROM THE East LINE OF SEC. 9 TWP. 17S RGE. 26E NMPM		12. County Eddy
19. Proposed Depth 8300'		19A. Formation Morrow
21. Elevations (Show whether DF, RT, etc.) 3349 GL		22. Approx. Date Work will start July 27, 1973
21A. Kind & Status Plug. Bond Blanket		21B. Drilling Contractor Ard Drilling Co.

23.

PROPOSED CASING AND CEMENT PROGRAM

SIZE OF HOLE	SIZE OF CASING	WEIGHT PER FOOT	SETTING DEPTH	SACKS OF CEMENT	EST. TOP
17½"	13-3/8"	48#	400'	Circulate	Surface
12¼"	8-5/8"	24#	1360' (Approx)	Circulate	Surface
7-7/8"	5½" or 4½"	15.5 & 17# 10.5 & 11.6#	8300'	250 sxs	-

Propose to drill & test the Morrow and intermediate formations. Approx. 400' of surface casing will be needed for protection from cavings and 8-5/8" casing will be set 100' below the Artesian zone, cement circulated on the 13-3/8" and 8-5/8". If commercial will then run 5½" or 4½" casing. Mud Program: Gel & Loss circulation material to 1360' (dry drill if necessary); KCl water to 7600' and low fluid loss mud to total depth. BOP Program: BOP's to be installed on 8-5/8" casing and tested, pipe rams daily, blind rams on trips.

APPROVAL VALID
FOR 90 DAYS UNLESS
DRILLING COMMENCED

EXPIRES 10-30-73

IN ABOVE SPACE DESCRIBE PROPOSED PROGRAM: IF PROPOSAL IS TO DEEPEN OR PLUG BACK, GIVE DATA ON PRESENT PRODUCTIVE ZONE AND PROPOSED NEW PRODUCTIVE ZONE. GIVE BLOWOUT PREVENTER PROGRAM, IF ANY.

I hereby certify that the information above is true and complete to the best of my knowledge and belief.

Signed Eddy M. [Signature] Title Engineer Date 7-20-73

(This space for State Use)

APPROVED BY W. A. Gressett TITLE OIL AND GAS INSPECTOR DATE JUL 30 1973

CONDITIONS OF APPROVAL, IF ANY:

Cement must be circulated to
surface behind 13 3/8" & 8 5/8" casing

Notify N.M.O.C.C. in sufficient
time to witness cementing
the 8 7/8" casing

NEW MEXICO OIL CONSERVATION COMMISSION
WELL LOCATION AND ACREAGE DEDICATION AT

Form C-102
Supersedes C-138
Effective 1-1-65

All distances must be from the outer boundaries of the Section.

Operator Yates Petroleum Corporation		Lease Bolton "CU" Com		Well No. 1
Unit Letter B	Section 9	Township 17S	Range 26 E	County Eddy
Actual Footage Location of Well: 2180 feet from the east line and 660 feet from the north line				
Ground Level Elev. 3349'	Producing Formation Atoka-Morrow	Pool Undesignated	Dedicated Acreage: N/2 320 Acres	

1. Outline the acreage dedicated to the subject well by colored pencil or hachure marks on the plat below.
2. If more than one lease is dedicated to the well, outline each and identify the ownership thereof (both as to working interest and royalty).
3. If more than one lease of different ownership is dedicated to the well, have the interests of all owners been consolidated by communitization, unitization, force-pooling, etc?

To Be

☒ Yes ☐ No If answer is "yes," type of consolidation working interest (Com)

If answer is "no," list the owners and tract descriptions which have actually been consolidated. (Use reverse side of this form if necessary.)

No allowable will be assigned to the well until all interests have been consolidated (by communitization, unitization, forced-pooling, or otherwise) or until a non-standard unit, eliminating such interests, has been approved by the Commission.

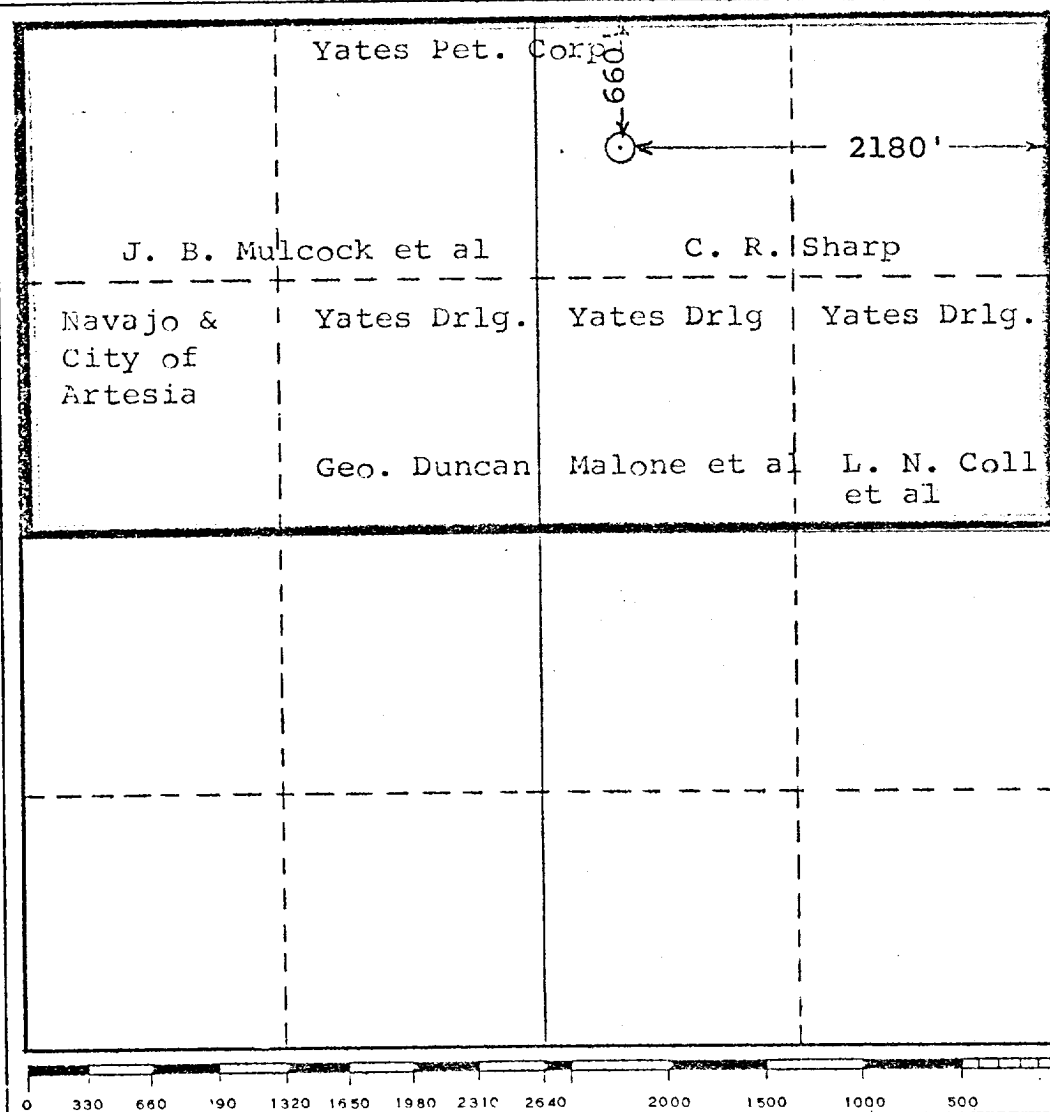

CERTIFICATION

I hereby certify that the information contained herein is true and complete to the best of my knowledge and belief.

Eddie M. Mahfood

Name
Eddie M. Mahfood

Position
Engineer

Company
Yates Petroleum Corp.

Date
July 21, 1973

I hereby certify that the well location shown on this plat was plotted from field notes of actual surveys made by me or under my supervision, and that the same is true and correct to the best of my knowledge and belief.

July 19, 1973

Date Surveyed

Registered Professional Engineer and/or Land Surveyor

N. Raymond Lamb

N. Raymond Lamb
Certificate No. **929**