

NO. OF COPIES RECEIVED	6
DISTRIBUCION	
SANTA FE	1
FILE	1
U.S.G.S.	1
LAND OFFICE	1
OPERATOR	1

NEW MEXICO OIL CONSERVATION COMMISSION

RECEIVED

AUG 10 1973

30-015-20927  
Form C-101  
Revised 1-1-65

5A. Indicate Type of Lease
STATE <input checked="" type="checkbox"/> FEE <input type="checkbox"/>
5. State Oil & Gas Lease No.
K 3503

APPLICATION FOR PERMIT TO DRILL, DEEPEN, OR PLUG BACK

1a. Type of Work		7. Unit Agreement Name	
b. Type of Well OIL WELL <input type="checkbox"/> GAS WELL <input checked="" type="checkbox"/> OTHER <input type="checkbox"/>		8. Farm or Lease Name State CV Com	
2. Name of Operator Yates Petroleum Corporation		9. Well No. 1	
3. Address of Operator 207 So. 4th Street		10. Field and Pool, or Wildcat Undesignated	
4. Location of Well UNIT LETTER B LOCATED 660 FEET FROM THE North LINE AND 2123 FEET FROM THE East LINE OF SEC. 16 TWP. 17S RGE. 26E		12. County Eddy	
19. Proposed Depth 8400		19A. Formation Morrow	
20. Rotary or C.T. Rotary		21. Elevations (Show whether DF, RT, etc.) 3362 GL	
21A. Kind & Status Plug. Bond Blanket		21B. Drilling Contractor Ard Drilling	
22. Approx. Date Work will start 8-15-73			

23.

PROPOSED CASING AND CEMENT PROGRAM

SIZE OF HOLE	SIZE OF CASING	WEIGHT PER FOOT	SETTING DEPTH	SACKS OF CEMENT	EST. TOP
16	13 3/8	48#	450	175 sx	Surface
12 1/4 & 11"	8 5/8	24#	1400	600 sx	Surface
7 7/8	5 1/2 or 4 1/2	15.5 & 17# or 10.5 & 11.6#	8400	150 sx	7400'

Propose to drill and test the Morrow and intermediate formations. Approximately 450' of conductor pipe will be set if needed for protection from cavings and 8 5/8" casing will be set 100' below the Artesian Zone. and cement circulated. If commercial will run 5 1/2" or 4 1/2" casing. If non-commercial may deepen to Devonian for disposal.

Mud Program: Gel and loss circ material to approx 1400' (dry drill if necessary), KCl water to 8500' and 10 fluid loss mud to TD.

BOP Program: BOP's (and hydril) will be utilized w/pipe rams tested daily, blind rams on trips.

APPROVAL VALID  
FOR 90 DAYS UNLESS  
DRILLING COMMENCED,  
EXPIRES 11-10-73

IN ABOVE SPACE DESCRIBE PROPOSED PROGRAM: IF PROPOSAL IS TO DEEPEN OR PLUG BACK, GIVE DATA ON PRESENT PRODUCTIVE ZONE, GIVE BLOWOUT PREVENTER PROGRAM, IF ANY.

I hereby certify that the information above is true and complete to the best of my knowledge and belief.

Signed Eddie M. Lutz Title Engineer Date 8-9-73

(This space for State Use)

APPROVED BY W. A. Gressett TITLE OIL AND GAS INSPECTOR DATE AUG 10 1973

CONDITIONS OF APPROVAL, IF ANY:

Cement must be circulated to surface behind 13 3/8" & 8 5/8" casing

Notify N.M.O.C.C. in sufficient time to witness cementing the 8 5/8" casing,

NEW MEXICO OIL CONSERVATION COMMISSION  
WELL LOCATION AND ACREAGE DEDICATION AT

Form C-102  
Supersedes C-128  
Effective 1-1-65

All distances must be from the outer boundaries of the Section.

Operator <b>YATES PETROLEUM CORPORATION</b>			Lease <b>STATE CV COMM.</b>		Well No. <b>1</b>
Unit Letter <b>B</b>	Section <b>16</b>	Township <b>17S</b>	Range <b>26E</b>	County <b>Eddy</b>	
Actual Footage Location of Well: <b>660</b> feet from the <b>north</b> line and <b>2123</b> feet from the <b>east</b> line					
Ground Level Elev. <b>3362 Gr</b>	Producing Formation <b>Morrow</b>	Pool <b>Undesignated</b>		Dedicated Acreage: <b>N/2 320 Acres</b>	

1. Outline the acreage dedicated to the subject well by colored pencil or hatchure marks on the plat below.
2. If more than one lease is dedicated to the well, outline each and identify the ownership thereof (both as to working interest and royalty).
3. If more than one lease of different ownership is dedicated to the well, have the interests of all owners been consolidated by communitization, unitization, force-pooling, etc?

☒ Yes ☐ No If answer is "yes," type of consolidation Communitization

If answer is "no," list the owners and tract descriptions which have actually been consolidated. (Use reverse side of this form if necessary.)

No allowable well be assigned to the well until all interests have been consolidated (by communitization, unitization, forced-pooling, or otherwise) or until a non-standard unit, eliminating such interests, has been approved by the Commission.

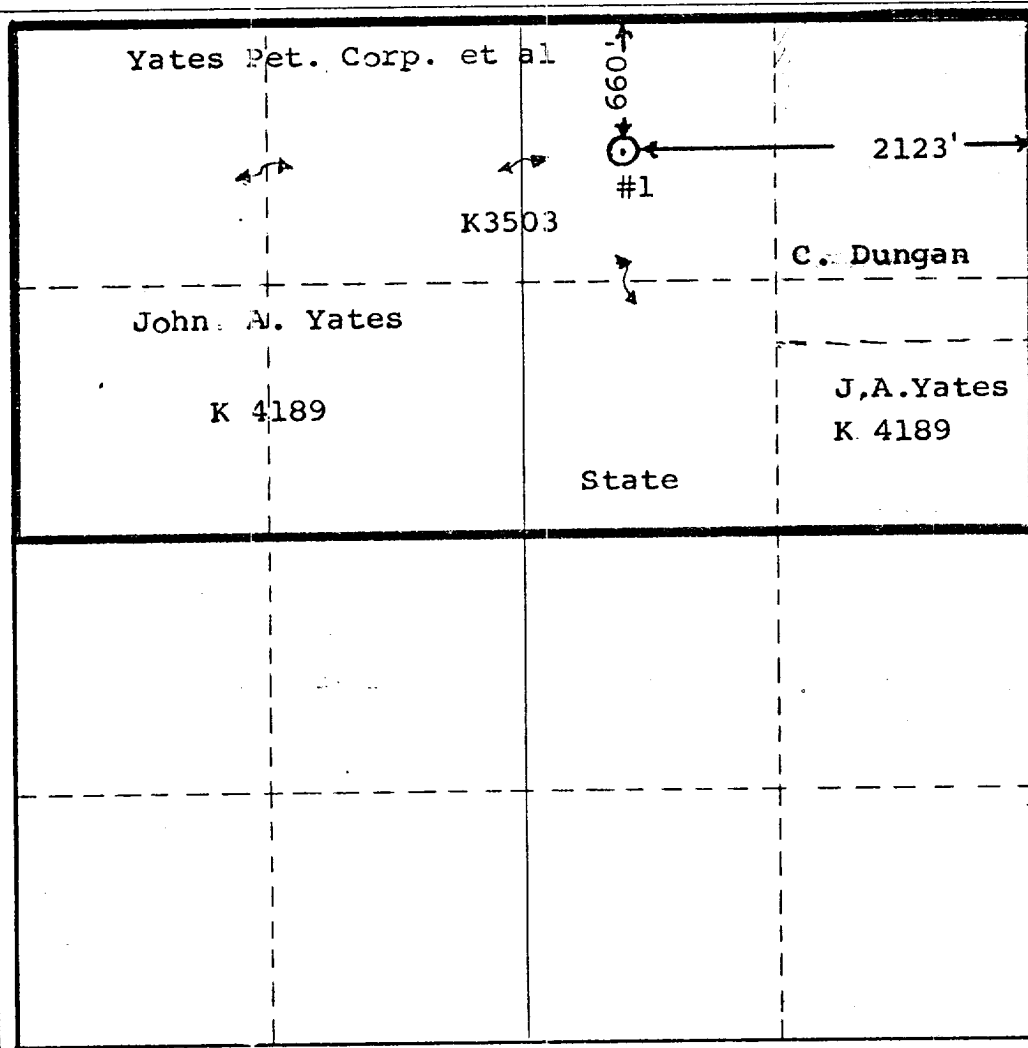

CERTIFICATION

I hereby certify that the information contained herein is true and complete to the best of my knowledge and belief.

Name Eddie M. Mahfood

Position Engineer

Company YATES PETROLEUM CORP.

Date 8-7-73

I hereby certify that the well location shown on this plat was plotted from field notes of actual surveys made by me or under my supervision, and that the same is true and correct to the best of my knowledge and belief.

Date Surveyed 8-7-73

Registered Professional Engineer and/or Land Surveyor N. Raymond Lamb

Certificate No. 929