

NEW MEXICO OIL CONSERVATION COMMISSION
WELL LOCATION AND ACREAGE DEDICATION PLAT

Form 1-17
Superseded 6-1-68
Effective 1-1-69

All distances must be from the outer boundaries of the Section

AMOCO PRODUCTION COMPANY		HONDO		FED GAS COM	
27		17 SOUTH		27 EAST	
1980		SOUTH		WEST	
MORROW		LOGAN DRAW-MORROW		320	

1. Outline the acreage dedicated to the subject well by colored pencil or hatchure marks on the plat below.
2. If more than one lease is dedicated to the well, outline each and identify the ownership thereof (both as to working interest and royalty).
3. If more than one lease of different ownership is dedicated to the well, have the interests of all owners been consolidated by communitization, unitization, force-pooling, etc?
- ☒ Yes ☐ No If answer is "yes," type of consolidation Comm.

If answer is "no," list the owners and tract descriptions which have actually been consolidated. (Use reverse side of this form if necessary.)

No oil/water will be assigned to the well until all interests have been consolidated (by communitization, unitization, force-pooling, or otherwise) or until a non-standard unit, eliminating such interests, has been approved by the Commission.

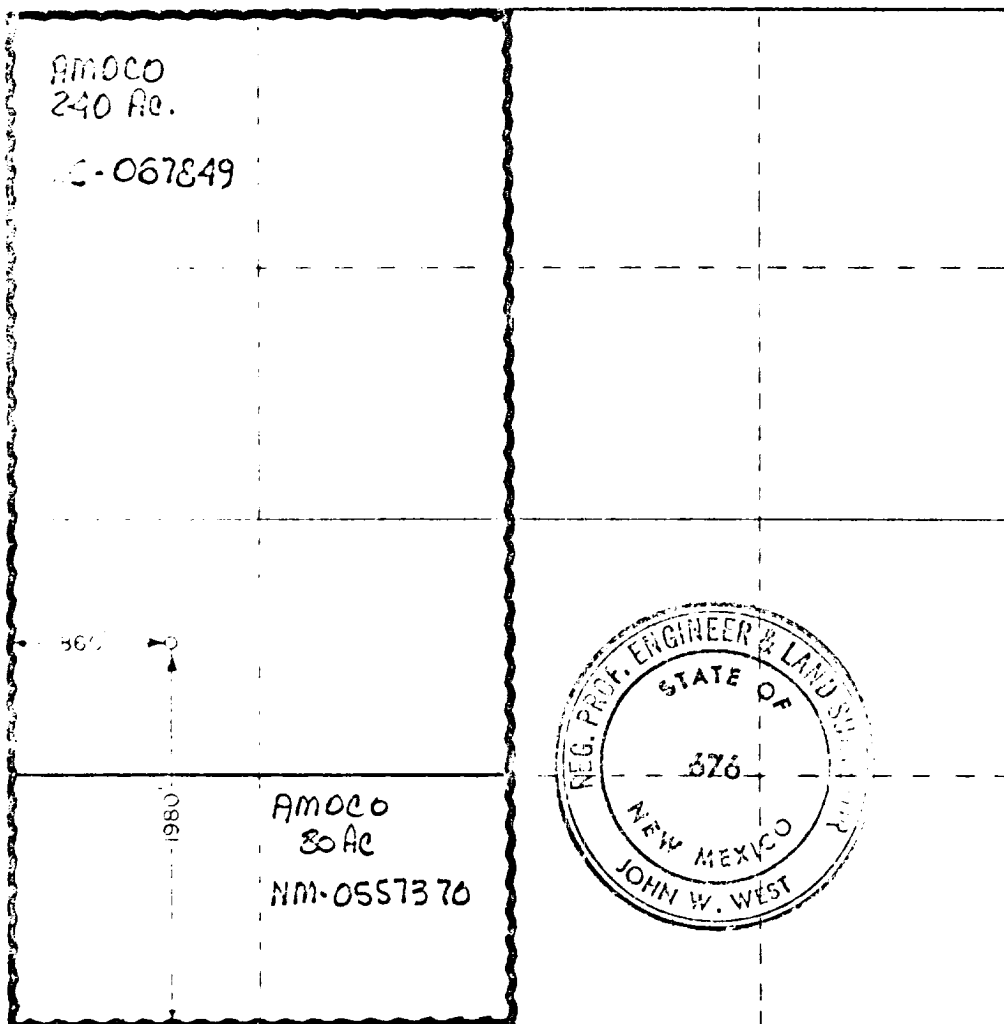

CERTIFICATION

I hereby certify that the information contained herein is true and complete to the best of my knowledge and belief.

J. E. York
AREA ENGINEER

Amoco Production Company

FEB 19 1974

RECEIVED
FEB 20 1974
U.S. GEOLOGICAL SURVEY
ARTESIA, NEW MEXICO
I hereby certify that the information shown on this plat was plotted from field notes of actual surveys made by me or under my supervision and that the same is true and correct to the best of my knowledge and belief.

Date Surveyed

FEBRUARY 14, 1974

Registered Professional Engineer and Professional Surveyor

John W. West
Certificate No. 676