

NO. OF COPIES RECEIVED	1
DISTRIBUTION	1
SANITARY	1
FILE	1
U.S.G.S.	2
LAND OFFICE	1
OPERATOR	1

NEW MEXICO OIL CONSERVATION COMMISSION

30-015-21124  
Form C-101  
Revised 1-1-65

RECEIVED

MAR 13 1974

5A. Indicate Type of Lease	STATE <input type="checkbox"/>	FEE <input checked="" type="checkbox"/>
----------------------------	--------------------------------	---

5. State Oil & Gas Lease No.

APPLICATION FOR PERMIT TO DRILL, DEEPEN, OR PLUG BACK

1a. Type of Work ARTESIA, OFFICE		7. Unit Agreement Name	
b. Type of Well DRILL <input checked="" type="checkbox"/> DEEPEN <input type="checkbox"/> PLUG BACK <input type="checkbox"/> OIL WELL <input checked="" type="checkbox"/> GAS WELL <input type="checkbox"/> OTHER <input type="checkbox"/> SINGLE ZONE <input checked="" type="checkbox"/> MULTIPLE ZONE <input type="checkbox"/>		8. Farm or Lease Name J Lazy J	
2. Name of Operator Vates Petroleum Corporation		9. Well No. 5	
3. Address of Operator 207 So. 4th St., Artesia, New Mexico 88210		10. Field and Pool, or Wildcat Eagle Creek S.A.	
4. Location of Well UNIT LETTER I LOCATED 2310 FEET FROM THE South LINE AND 990 FEET FROM THE East LINE OF SEC. 22 TWP. 17S RGE. 25E NMPM		12. County Eddy	
19. Proposed Depth 1500		19A. Formation San Andres	20. Rotary or C.T. Rotary
21. Elevations (Show whether DF, RT, etc.) 3523 GR	21A. Kind & Status Plug. Bond Blanket	21B. Drilling Contractor Cactus Drilling Co.	22. Approx. Date Work will start 3-15-74

23.

PROPOSED CASING AND CEMENT PROGRAM

SIZE OF HOLE	SIZE OF CASING	WEIGHT PER FOOT	SETTING DEPTH	SACKS OF CEMENT	EST. TOP
15"	10 3/4"	32.3#	Approx 200	100 sx	Circulate
9 7/8"	7"	20#, 23#	Approx 1140	350 sx	Circulate
6 1/4"	4 1/2" & 5 1/2" taper	9.5# & 15.5#	Approx 1500	100 sx	

Propose to drill San Andres test with approximately 200' of 10 3/4" csg to shut off surface gravel and cavings and 7" casing set 100' below the Artesian Zone with cement circulated. A tapered production string will be run to TD and cemented, perforated and sand-frac'd for slaughter production.

Mud Program: Fresh water gel and LCM to 1140 (or dry drill), water from csg pt to TD.

BOP Program: BOP's will be installed on 7" csg and tested daily.

APPROVAL VALID  
FOR 90 DAYS UNLESS  
DRILLING COMMENCED,

IN ABOVE SPACE DESCRIBE PROPOSED PROGRAM: IF PROPOSAL IS TO DEEPEN OR PLUG BACK, GIVE DATA ON PRESENT PRODUCTION ZONE AND PROPOSED NEW PRODUCTION ZONE. GIVE BLOWOUT PREVENTER PROGRAM, IF ANY.

I hereby certify that the information above is true and complete to the best of my knowledge and belief.

Signed Eddie M. Mahfood Title Eddie M. Mahfood Date March 12, 1974

(This space for State Use)

APPROVED BY W. A. Gressett TITLE OIL AND GAS INSPECTOR DATE MAR 14 1974

CONDITIONS OF APPROVAL, IF ANY:

Cement must be circulated to  
surface behind 10 3/4" & 7" casing

Notify N.M.O.C.C. in sufficient  
time to witness cementing  
the 7" casing

NEW MEXICO OIL CONSERVATION COMMISSION  
WELL LOCATION AND ACREAGE DEDICATION PLAT

Form C-102  
Supersedes C-128  
Effective 1-1-65

All distances must be from the outer boundaries of the Section.

Operator <b>Yates Petroleum Corporation</b>			Lease <b>J Lazy J</b>		Well No. <b>5</b>
Unit Letter <b>I</b>	Section <b>22</b>	Township <b>17S</b>	Range <b>25E</b>	County <b>Eddy</b>	
Actual Footage Location of Well: <b>990</b> feet from the <b>East</b> line and <b>2310</b> feet from the <b>South</b> line					
Ground Level Elev. <b>3523</b>	Producing Formation <b>San Andres</b>		Pool <b>Eagle Creek</b>		Dedicated Acreage: <b>40</b> Acres

1. Outline the acreage dedicated to the subject well by colored pencil or hachure marks on the plat below.
2. If more than one lease is dedicated to the well, outline each and identify the ownership thereof (both as to working interest and royalty).
3. If more than one lease of different ownership is dedicated to the well, have the interests of all owners been consolidated by communitization, unitization, force-pooling, etc?

☐ Yes ☐ No If answer is "yes," type of consolidation \_\_\_\_\_

If answer is "no," list the owners and tract descriptions which have actually been consolidated. (Use reverse side of this form if necessary.) \_\_\_\_\_

No allowable will be assigned to the well until all interests have been consolidated (by communitization, unitization, forced-pooling, or otherwise) or until a non-standard unit, eliminating such interests, has been approved by the Commission.

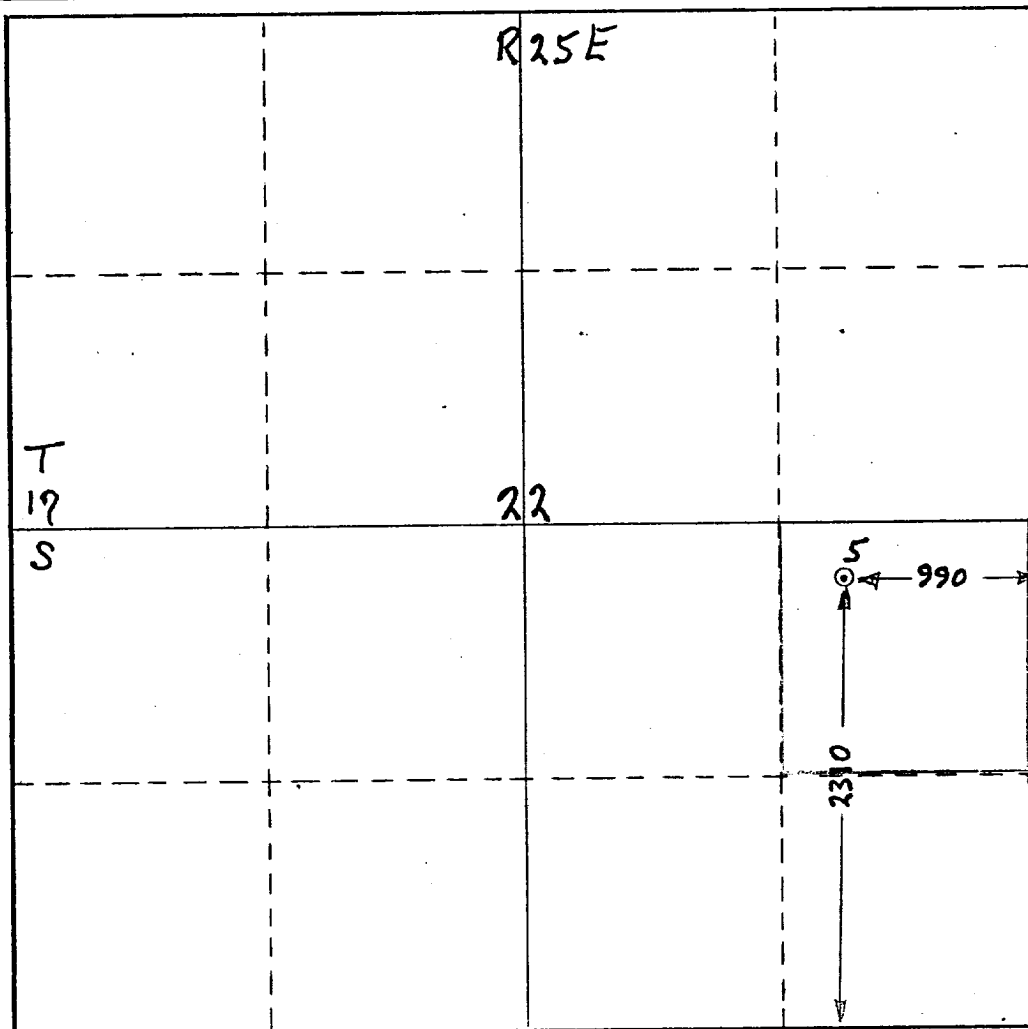

CERTIFICATION

I hereby certify that the information contained herein is true and complete to the best of my knowledge and belief.

*Eddie M. Mahfood*  
Name

**Eddie M. Mahfood**

Position  
**Engineer**

Company  
**Yates Pet. Corporation**

Date  
**3-13-74**

I hereby certify that the well location shown on this plat was plotted from field notes of actual surveys made by me or under my supervision, and that the same is true and correct to the best of my knowledge and belief.

Date Surveyed  
*March 12th 1974*  
Registered Professional Engineer  
and/or Land Surveyor

*James H. Brown*  
Certificate No. **542**

