

NO. OF COPIES RECEIVED	5
DISTRIBUTION	
SANTA FE	1
FILE	1
U.S.G.S.	2
1000 OFFICE	
OPERATOR	1

NEW MEXICO OIL CONSERVATION COMMISSION

RECEIVED

MAR 22 1974

O. C. C.

ARTESIA, OFFICE

APPLICATION FOR PERMIT TO DRILL, DEEPEN, OR PLUG BACK

1a. Type of Work DRILL <input checked="" type="checkbox"/> DEEPEN <input type="checkbox"/> PLUG BACK <input type="checkbox"/>		7. Unit Agreement Name	
b. Type of Well OIL WELL <input checked="" type="checkbox"/> GAS WELL <input type="checkbox"/> OTHER <input type="checkbox"/> SINGLE ZONE <input type="checkbox"/> MULTIPLE ZONE <input type="checkbox"/>		8. Farm or Lease Name J Lazy J	
2. Name of Operator Yates Petroleum Corporation		9. Well No. 7	
3. Address of Operator 207 South 4th Steeet - Artesia, NM 88210		10. Field and Pool, or Well Unit Eagle Creek S.A.	
4. Location of Well UNIT LETTER H LOCATED 1700 FEET FROM THE North LINE AND 1080 FEET FROM THE East LINE OF SEC. 22 TWP. 17S RGE. 25E NMPM		12. County Eddy	
19. Proposed Depth Approx 1500'		19A. Formation San Andres	
20. Rotary or C.T. Rotary		21. Elevations (Show whether DF, RT, etc.) 3502' GR	
21A. Kind & Status Plug. Bond Blanket		21B. Drilling Contractor Cactus Drilling Co.	
22. Approx. Date Work will start 3-25-74			

23.

PROPOSED CASING AND CEMENT PROGRAM

SIZE OF HOLE	SIZE OF CASING	WEIGHT PER FOOT	SETTING DEPTH	SACKS OF CEMENT	EST. TOP
15"	10-3/4"	32.3#	Approx. 300'	100 sx	Circulate
9-7/8"	7"	20.23#	1140'	350 sx	Circulate
6 1/4"	4 1/2" & 5 1/2" (Tapered)	9.5# 15.5#	1500'	100 sx	

REPLACES NOTICE OF INTENT - DATED 3-14-74. NON STANDARD LOCATION APPROVED 3-21-74

Propose to drill San Andres test with approx. 300' of 10-3/4" csg to shut off surface gravel and cavings and 7" csg set 100' below the Artesian zone with cement circulated. A tapered production string will be run to TD and cemented, perforated and Sand-Frac'd for Slaughter production.

Mud Program: - Fresh water gel & LCM to 1140' (or dry drill), water from casing point to Total Depth.

BOP Program: - BOP's will be installed on 7" casing and tested FOR 20 DAYS UNLESS DRILLING COMMENCED,

APPROVAL VALID

EXPIRES 6-22-74

NSL-648
3-22-74

IN ABOVE SPACE DESCRIBE PROPOSED PROGRAM: IF PROPOSAL IS TO DEEPEN OR PLUG BACK, GIVE DATA ON PRESENT PRODUCTIVE ZONE AND PROPOSED NEW PRODUCTIVE ZONE. GIVE BLOWOUT PREVENTER PROGRAM, IF ANY.

I hereby certify that the information above is true and complete to the best of my knowledge and belief.

Signed Eddie L. Walcott Title Engineer Date 3-22-74

(This space for State Use)

APPROVED BY W. A. Grassett TITLE OIL AND GAS INSPECTOR DATE MAR 22 1974

CONDITIONS OF APPROVAL, IF ANY:

Cement must be circulated to surface behind 10 3/4" & 7" casing

Notify N.M.O.C.C. in sufficient time to witness cementing the 7" casing

NEW MEXICO OIL CONSERVATION COMMISSION
WELL LOCATION AND ACREAGE DEDICATION PLAT

Form C-102
Supersedes C-128
Effective 1-1-65

All distances must be from the outer boundaries of the Section.

Operator Yates Petroleum Corporation		Lease J Lazy J		Well No. 7
Unit Letter H	Section 22	Township 17S	Range 25E	County Eddy
Actual Four-Corner Location of Well: 1080 feet from the East line and 1700 feet from the North line				
Ground Level Elev. 3502' GR	Producing Formation San Andres	Pool Eagle Creek S.A.	Dedicated Acreage: 40 Acres	

1. Outline the acreage dedicated to the subject well by colored pencil or hachure marks on the plat below.
2. If more than one lease is dedicated to the well, outline each and identify the ownership thereof (both as to working interest and royalty).
3. If more than one lease of different ownership is dedicated to the well, have the interests of all owners been consolidated by communitization, unitization, force-pooling, etc?

☐ Yes ☐ No If answer is "yes," type of consolidation _____

If answer is "no," list the owners and tract descriptions which have actually been consolidated. (Use reverse side of this form if necessary.) _____

No allowable will be assigned to the well until all interests have been consolidated (by communitization, unitization, forced-pooling, or otherwise) or until a non-standard unit, eliminating such interests, has been approved by the Commission.

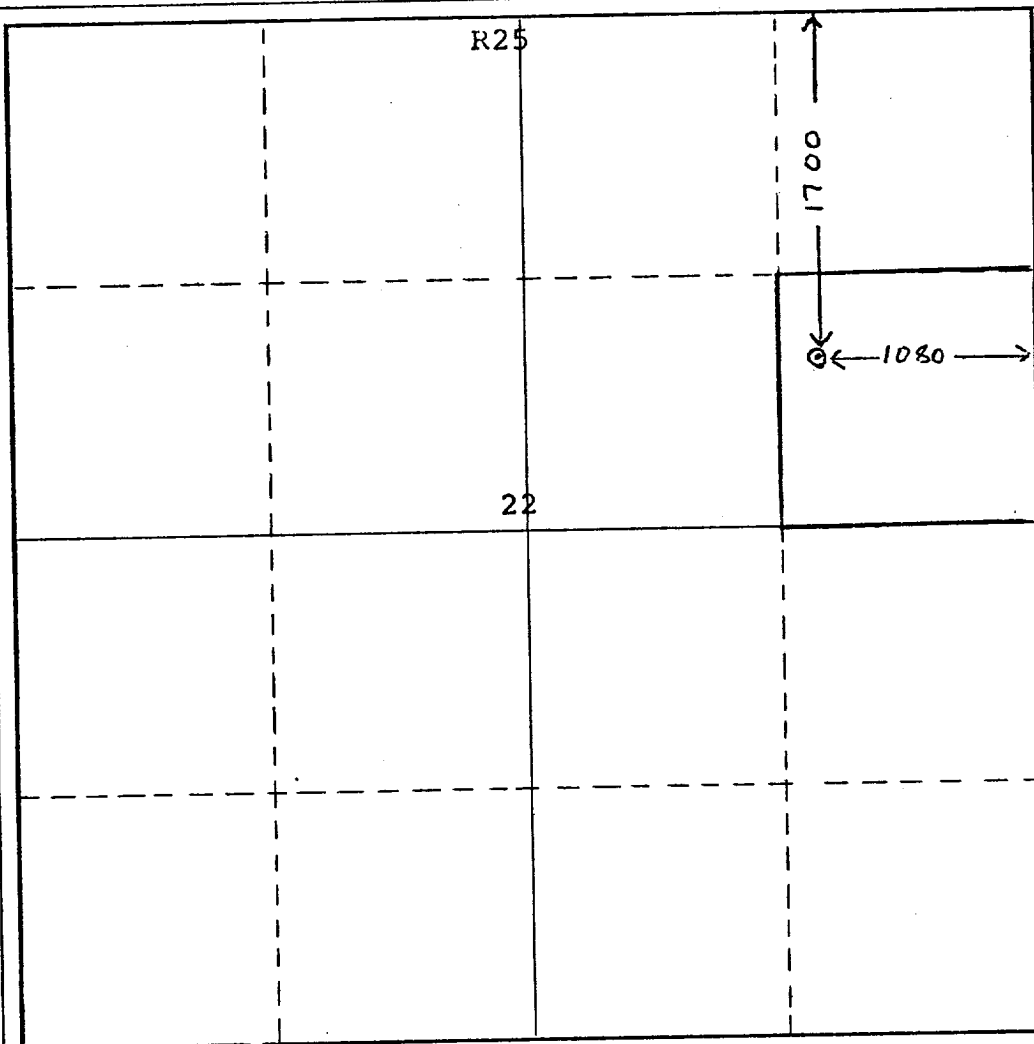

CERTIFICATION

I hereby certify that the information contained herein is true and complete to the best of my knowledge and belief.

Eddie M. Mahfood
Name

Eddie M. Mahfood

Position
Engineer

Company
Yates Pet. Corporation

Date
3-22-74

I hereby certify that the well location shown on this plat was plotted from field notes of actual surveys made by me or under my supervision, and that the same is true and correct to the best of my knowledge and belief.

3-21-74

Date Surveyed
Eddie M. Mahfood
Registered Professional Engineer
and/or Land Surveyor

Certificate No. **4605**

0 330 660 990 1320 1650 1980 2310 2640 2000 1500 1000 500 0

T
17
S



YATES BUILDING - 207 SOUTH 4TH ST.
ARTESIA, NEW MEXICO - 88210

March 14, 1974

S. P. YATES
PRESIDENT
MARTIN YATES, III
VICE PRESIDENT
JOHN A. YATES
VICE PRESIDENT
B. W. HARPER
SEC. - TREAS.

RECEIVED

MAR 15 1974

Mr. A. L. Porter, Jr.
Secretary-Director
Oil Conservation Commission
P. O. Box 2088
Santa Fe, New Mexico 87501

O. C. C.
ARTESIA, OFFICE

Re: Unorthodox Location
Unit H, Sec. 22-17S-25E
Eagle Creek (S.A.) Field
Eddy County, New Mexico

Dear Mr. Porter:

Administrative approval of a non-standard location for a San Andres oil test is asked. Application for permit to drill our J Lazy J No. 7 well on standard location for 990' FEL and 1650' FNL of Section 22-17S-25E has been filed. However, rancher, J. W. Gissler of Artesia, has raised objection to the location on the basis that the staked location is too close to his corrals and feed pen. The ranch improvements are to the east and north. The rancher is asking that we move the location 100 feet westerly.

Approval is asked for non-standard location for our J Lazy J No. 7 at 1700' FNL and 1080' FEL of Section 22-17S-25E, Eagle Creek (S.A.) field, Eddy County, New Mexico.

Yours very truly,

YATES PETROLEUM CORPORATION

E. M. Mahfood
Eddie M. Mahfood
Petroleum Engineer

NSL-648
3-22-74
EMM/jg

cc: Mr. W. A. Gressett, Supervisor
District II, Artesia

NO. OF COPIES RECEIVED		
DISTRIBUTION		
SANTA FE		
FILE		
U.S.G.S.		
LAND OFFICE		
OPERATOR		

NEW MEXICO OIL CONSERVATION COMMISSION

Form C-101
Revised 1-1-65

RECEIVED

MAR 15 1974

APPLICATION FOR PERMIT TO DRILL, DEEPEN, OR PLUG BACK

1a. Type of Work O. C. C.		5A. Indicate Type of Lease STATE <input type="checkbox"/> FEE <input checked="" type="checkbox"/>	
b. Type of Well DRILL <input checked="" type="checkbox"/> DEEPEN <input type="checkbox"/> ARTESIA, OFFICE PLUG BACK <input type="checkbox"/> OIL WELL <input checked="" type="checkbox"/> GAS WELL <input type="checkbox"/> OTHER <input type="checkbox"/> SINGLE ZONE <input checked="" type="checkbox"/> MULTIPLE ZONE <input type="checkbox"/>		5. State Oil & Gas Lease No.	
2. Name of Operator Yates Petroleum Corporation		7. Unit Agreement Name	
3. Address of Operator 207 South 4th Street - Artesia, NM 88210		8. Farm or Lease Name J Lazy J	
4. Location of Well UNIT LETTER H LOCATED 1650 FEET FROM THE North LINE AND 990 FEET FROM THE East LINE OF SEC. 22 TWP. 17S RGE. 25E NMPM		9. Well No. 7	
		10. Field and Pool, or Wildcat Eagle Creek S.A.	
		12. County Eddy	
		19. Proposed Depth Approx. 1500'	
		19A. Formation San Andres	
		20. Rotary or C.T. Rotary	
21. Elevations (Show whether DF, RT, etc.) 3521' GR		21A. Kind & Status Plug. Bond Blanket	
		21B. Drilling Contractor Cactus Drilling Co.	
		22. Approx. Date Work will start 3-25-74	

23.

PROPOSED CASING AND CEMENT PROGRAM

SIZE OF HOLE	SIZE OF CASING	WEIGHT PER FOOT	SETTING DEPTH	SACKS OF CEMENT	EST. TOP
15"	10-3/4"	32.3#	Approx. 200'	100 SX	Circulate
9-7/8"	7"	20.23#	" 1140'	350 SX	Circulate
6 1/4"	4 1/2" & 5 1/2" (Tapered)	9.5# & 15.5#	" 1500'	100 SX	

Propose to drill San Andres test with approx. 200' of 10-3/4" casing to shut off surface gravel and cavings and 7" casing set 100 ft. below the Artesian zone with cement circulated. A tapered production string will be run to TD and cemented, perforated and sand-frac'd for Slaughter production

Mud Program: Fresh water gel & LCM to 1140' (or dry drill), water from casing point to Total Depth.

BOP Program: BOP's will be installed on 7" casing and tested daily.

IN ABOVE SPACE DESCRIBE PROPOSED PROGRAM: IF PROPOSAL IS TO DEEPEN OR PLUG BACK, GIVE DATA ON PRESENT PRODUCTIVE ZONE AND PROPOSED NEW PRODUCTIVE ZONE. GIVE BLOWOUT PREVENTER PROGRAM, IF ANY.

I hereby certify that the information above is true and complete to the best of my knowledge and belief.

Signed Eddie M. Haly Title Engineer Date 3-14-74

(This space for State Use)

APPROVED BY _____ TITLE _____ DATE _____
CONDITIONS OF APPROVAL, IF ANY:

NEW MEXICO OIL CONSERVATION COMMISSION
WELL LOCATION AND ACREAGE DEDICATION PLAT

Form C-102
Supersedes C-128
Effective 1-1-65

All distances must be from the outer boundaries of the Section.

Operator Yates Petroleum Corporation			Lease J Lazy J		Well No. 7
Unit Letter H	Section 22	Township 17S	Range 25E	County Eddy	
Actual Footage Location of Well: 1650, feet from the North line and 990 feet from the East line					
Ground Level Elev: 3521	Producing Formation San Andres		Pool Eagle Creek S.A		Dedicated Acreage: 40 Acres

1. Outline the acreage dedicated to the subject well by colored pencil or hachure marks on the plat below.

2. If more than one lease is dedicated to the well, outline each and identify the ownership thereof (both as to working interest and royalty).

3. If more than one lease of different ownership is dedicated to the well, have the interests of all owners been consolidated by communitization, unitization, force-pooling, etc?

☐ Yes ☐ No If answer is "yes," type of consolidation _____

If answer is "no," list the owners and tract descriptions which have actually been consolidated. (Use reverse side of this form if necessary.) _____

No allowable will be assigned to the well until all interests have been consolidated (by communitization, unitization, forced-pooling, or otherwise) or until a non-standard unit, eliminating such interests, has been approved by the Commission.

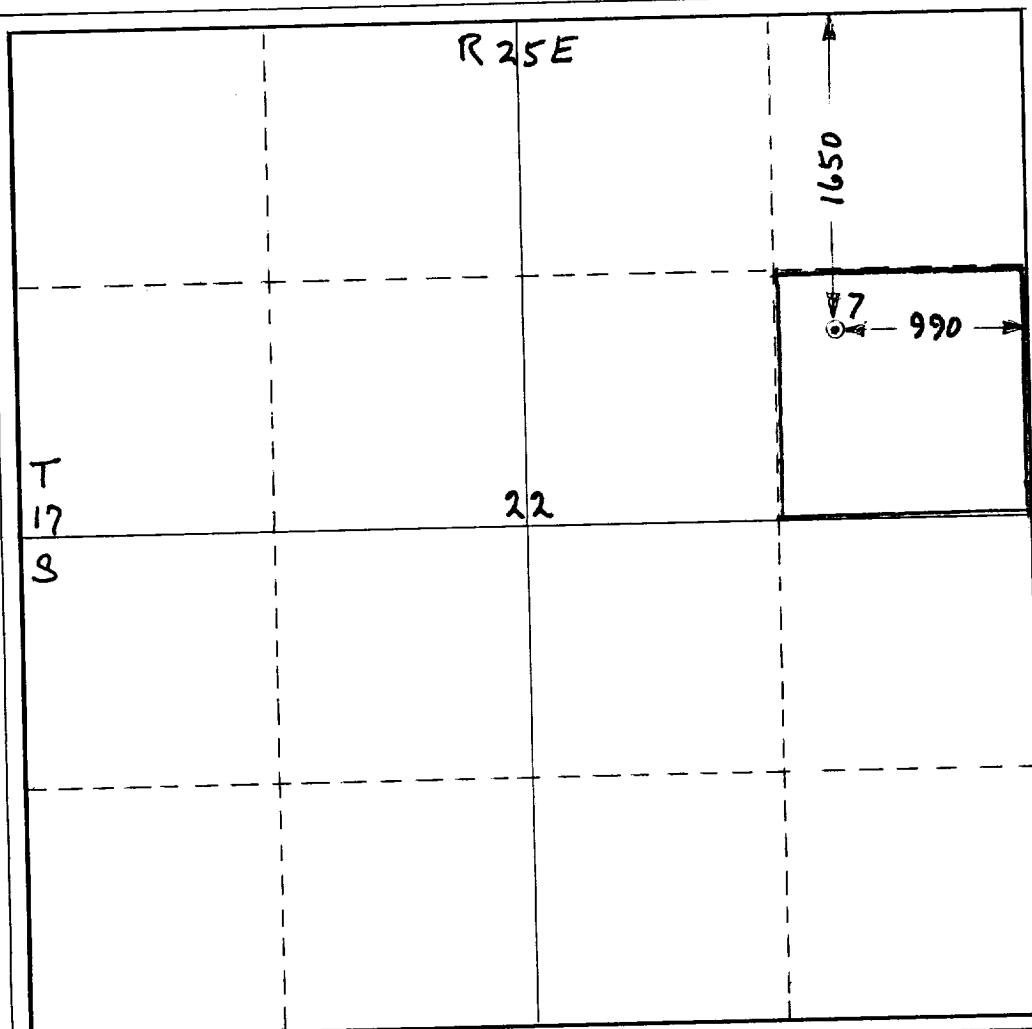

CERTIFICATION

I hereby certify that the information contained herein is true and complete to the best of my knowledge and belief.

Eddie M. Mahfood

Name

Eddie M. Mahfood

Position

Engineer

Company

Yates Pet. Corporation

Date

3-13-74

I hereby certify that the well location shown on this plat was plotted from field notes of actual surveys made by me or under my supervision, and that the same is true and correct to the best of my knowledge and belief.

Date Surveyed

March 12th 1974

Registered Professional Engineer
and/or Land Surveyor

James H. Brown

Certificate No.

542