

NO. OF COPIES RECEIVED	3
DISTRIBUTION	
SANTA FE	1
FILE	1 ✓
U.S.G.S.	2
LAND OFFICE	
OPERATOR	1

## NEW MEXICO OIL CONSERVATION COMMISSION

RECEIVED

APR 30 1974

30-015-21195

Form C-101

Revised 1-1-65

5A. Indicate Type of Lease

STATE ☐

FEE ☒

5. State Oil &amp; Gas Lease No.

O. C. C.

## APPLICATION FOR PERMIT TO DRILL, DEEPEN, OR PLUG BACK, OFFICE

1a. Type of Work		7. Unit Agreement Name	
b. Type of Well DRILL <input checked="" type="checkbox"/> DEEPEN <input type="checkbox"/> PLUG BACK <input type="checkbox"/> OIL WELL <input checked="" type="checkbox"/> GAS WELL <input type="checkbox"/> OTHER <input type="checkbox"/> SINGLE ZONE <input type="checkbox"/> MULTIPLE ZONE <input type="checkbox"/>		8. Farm or Lease Name Gissler AV	
2. Name of Operator Yates Petroleum Corporation ✓		9. Well No. 10	
3. Address of Operator 207 South 4th Street - Artesia, NM 88210		10. Field and Pool, or Wildcat Eagle Creek S.A.	
4. Location of Well UNIT LETTER E LOCATED 330 FEET FROM THE West LINE AND 1650 FEET FROM THE North LINE OF SEC. 23 TWP. 17S RGE. 25E NMPM		12. County Eddy	
19. Proposed Depth Approx. 1500		19A. Formation San Andres	
20. Rotary or C.T. Rotary		21. Elevations (Show whether DF, RT, etc.) 3530' GR	
21A. Kind & Status Plug. Bond Blanket		21B. Drilling Contractor RIG 65 Cactus Drilling Co.	
22. Approx. Date Work will start As soon as approved			

23.

## PROPOSED CASING AND CEMENT PROGRAM

SIZE OF HOLE	SIZE OF CASING	WEIGHT PER FOOT	SETTING DEPTH	SACKS OF CEMENT	EST. TOP
14 3/4"	10 3/4"	32#	300'	175	Circulate
9 7/8"	7"	23, 26#	1180'	400	Circulate
6 1/4"	4 1/2" & 5 1/2"	9.5 & 15.5#	1500'	125	

Propose to drill San Andres test. Approximately 300' of 10 3/4" casing will be run and cemented to surface to shut off surface gravel and cavings, and 7" casing will be run 100' below Artesian Zone, cemented to surface. A tapered oil string will be run and cemented, perforated and Sand Frac'd for production.

Mud Program: - Fresh water mud w/LCM from surface to 1180', fresh wtr to TD.

BOP Program: - BOP's to be installed on 7" casing and tested daily for operational.

APPROVAL VALID  
FOR 90 DAYS UNLESS  
DRILLING COMMENCED,

EXPIRES 8-1-74

IN ABOVE SPACE DESCRIBE PROPOSED PROGRAM: IF PROPOSAL IS TO DEEPEN OR PLUG BACK, GIVE DATA ON PRESENT PRODUCTIVE ZONE AND PROPOSED NEW PRODUCTIVE ZONE. GIVE BLOWOUT PREVENTER PROGRAM, IF ANY.

I hereby certify that the information above is true and complete to the best of my knowledge and belief.

Signed Eddie L. Bradley Title Engineer Date 4-30-74

(This space for State Use)

APPROVED BY W. A. Gassett TITLE OIL AND GAS INSPECTOR

CONDITIONS OF APPROVAL, IF ANY:

Cement must be circulated to  
surface behind 10 3/4" + 7" casing

DATE MAY 1 1974  
Notify N.M.O.C.C. in sufficient  
time to witness cementing  
the 7" casing

NE EXICO OIL CONSERVATION COMMISSIC  
WELL LOCATION AND ACREAGE DEDICATION PLAT

Form C-102  
Supersedes C-128  
Effective 1-1-65

All distances must be from the outer boundaries of the Section.

Operator <b>Yates Petroleum Corporation</b>			Lease <b>Gissler AV</b>		Well No. <b>10</b>
Unit Letter <b>E</b>	Section <b>23</b>	Township <b>17S</b>	Range <b>25E</b>	County <b>Eddy</b>	
Actual Footage Location of Well: <b>330</b> feet from the <b>West</b> line and <b>1650</b> feet from the <b>North</b> line					
Ground Level Elev. <b>3530</b>	Producing Formation <b>San Andres</b>		Pool <b>Eagle Creek, (S.A.)</b>		Dedicated Acreage: <b>40</b> Acres

1. Outline the acreage dedicated to the subject well by colored pencil or hachure marks on the plat below.
2. If more than one lease is dedicated to the well, outline each and identify the ownership thereof (both as to working interest and royalty).
3. If more than one lease of different ownership is dedicated to the well, have the interests of all owners been consolidated by communitization, unitization, force-pooling, etc?

☐ Yes ☐ No If answer is "yes," type of consolidation \_\_\_\_\_

If answer is "no," list the owners and tract descriptions which have actually been consolidated. (Use reverse side of this form if necessary.) \_\_\_\_\_

No allowable will be assigned to the well until all interests have been consolidated (by communitization, unitization, forced-pooling, or otherwise) or until a non-standard unit, eliminating such interests, has been approved by the Commission.

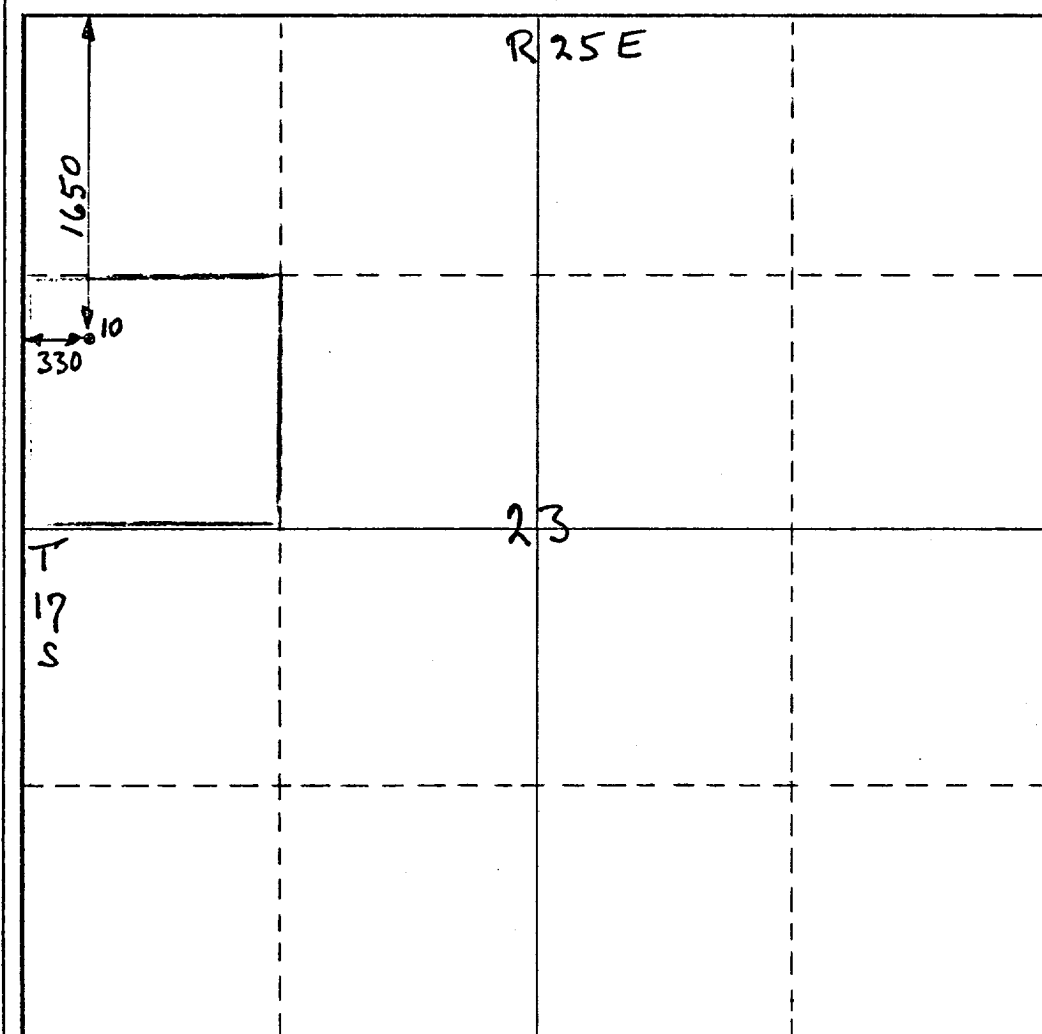

CERTIFICATION

I hereby certify that the information contained herein is true and complete to the best of my knowledge and belief.

**Eddie M. Mahfood**

Name **Eddie M. Mahfood**  
Position **Engineer**

Company **Yates Petroleum Corp.**

Date **3-26-74**

I hereby certify that the well location shown on this plat was plotted from field notes of actual surveys made by me or under my supervision, and that the same is true and correct to the best of my knowledge and belief.

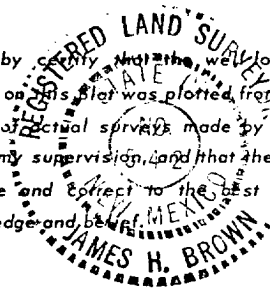

Date Surveyed **March 27th 1974**  
Registered Professional Engineer and/or Land Surveyor

**James H. Brown**  
Certificate No. **542**

