

NO. OF COPIES RECEIVED	
DISTRIBUTION	
SALE	/
FILE	/
U.S.G.S.	
LAND OFFICE	
TRANSPORTER	OIL / GAS /
OPERATOR	/
PRODUCTION OFFICE	

NEW MEXICO OIL CONSERVATION COMMISSION
REQUEST FOR ALLOWABLE
AND
AUTHORIZATION TO TRANSPORT OIL AND NATURAL GAS

Form C-104
Superseding Old C-104 and C-11
Effective 1-1-65

RECEIVED

FEB 17 1977

Operator Yates Petroleum Corporation		O. C. C.	
Address 207 South 4th Street - Artesia, NM 88210		ARTESIA, OFFICE	
Reason(s) for filing (Check proper box)		Other (Please explain)	
New Well <input checked="" type="checkbox"/>	Change in Transporter of:		
Recompletion <input type="checkbox"/>	Oil <input type="checkbox"/>	Dry Gas <input type="checkbox"/>	
Change in Ownership <input type="checkbox"/>	Casinghead Gas <input type="checkbox"/>	Condensate <input type="checkbox"/>	

If change of ownership give name
and address of previous owner

K-5460 - 7-1-77

Eagle Creek Perms Perm

II. DESCRIPTION OF WELL AND LEASE

Lease Name Powell "DG" Com	Well No. 1	Pool Name, including Formation Wildeat Wolfcamp	Kind of Lease State, Federal or Fee Fee	Lease No.
Location Unit Letter: 0 ; 660 Feet From The South Line and 1980 Feet From The East Line of Section 35 Township 17S Range 25E, NMPM, Eddy County				

III. DESIGNATION OF TRANSPORTER OF OIL AND NATURAL GAS

Name of Authorized Transporter of Oil <input type="checkbox"/> or Condensate <input checked="" type="checkbox"/>	Address (Give address to which approved copy of this form is to be sent)					
Navajo Crude Oil Purchasing Company	No. Freeman Ave-Artesia, NM 88210					
Name of Authorized Transporter of Casinghead Gas <input type="checkbox"/> or Dry Gas <input checked="" type="checkbox"/>	Address (Give address to which approved copy of this form is to be sent)					
Transwestern Pipeline Company	P. O. Box 2521-Houston, TX 77001					
If well produces oil or liquids, give location of tanks.	Unit 0	Sec. 35	Twp. 17S	Rge. 25E	Is gas actually connected? Yes	When 2-7-77

If this production is commingled with that from any other lease or pool, give commingling order number:

COMPLETION DATA

Designate Type of Completion - (X)	Oil Well	Gas Well	New Well	Workover	Deepen	Plug Back	Same Resv. Dist. Resv.
		X	X				
Date Spudded 6-14-74	Date Compl. Ready to Prod. 6-13-75		Total Depth 8740'		P.B.T.D. 8561'		
Elevations (DF, RKB, RT, GR, etc.) 3490'	Name of Producing Formation Wolfcamp		Top Oil/Gas Pay 6539'		Tubing Depth 8312'		
Perforations 6539-6683'					Depth Casing Shoe 8561'		

TUBING, CASING, AND CEMENTING RECORD

HOLE SIZE	CASING & TUBING SIZE	DEPTH SET	SACKS CEMENT
17 1/2"	13-3/8"	391'	250
12 1/4"	8-5/8"	1238'	1100
7-7/8"	4 1/2"	8561'	250
	2-3/8"	8312'	

TEST DATA AND REQUEST FOR ALLOWABLE OIL WELL

(Test must be after recovery of total volume of load oil and must be equal to or exceed top allowable for this depth or be for full 24 hours)

Date First New Oil Run To Tanks	Date of Test	Producing Method (Flow, pump, gas lift, etc.)	
Length of Test	Tubing Pressure	Casing Pressure	Choke Size
Actual Prod. During Test	Oil-Bbls.	Water-Bbls.	Gas-MCF

GAS WELL

Actual Prod. Test-MCF/D 2052	Length of Test 24	Bbls. Condensate/MMCF 34.06	Gravity of Condensate 50.6
Testing Method (pilot, back pr.) Back Pressure	Tubing Pressure (Shut-in) 1910	Casing Pressure (Shut-in) 2234 (Morrow)	Choke Size 1/2"

CERTIFICATE OF COMPLIANCE

I hereby certify that the rules and regulations of the Oil Conservation Commission have been complied with and that the information given above is true and complete to the best of my knowledge and belief.

Christine Tomlinson
(Signature)

Christine Tomlinson-Geol. Secty

(Title)

2-16-77

(Date)

OIL CONSERVATION COMMISSION

APPROVED FEB 22 1977, 19

BY *W. A. Gussert*

TITLE SUPERVISOR, DISTRICT II

This form is to be filed in compliance with RULE 1104.

If this is a request for allowable for a newly drilled or deepened well, this form must be accompanied by a tabulation of the deviation tests taken on the well in accordance with RULE 111.

All sections of this form must be filled out completely for allowable on new and recompleted wells.

Fill out only Sections I, II, III, and VI for change of owner, well name or number, or transporter, or other such change of condition.

NEW MEXICO OIL CONSERVATION COMMISSION
WELL LOCATION AND ACREAGE DEDICATION PLAT

Form C-102
Supersedes C-128
Effective 1-1-65

All distances must be from the outer boundaries of the Section.

Operator Yates Petroleum Corporation			Lease Powell DG Com		Well No. 1
Unit Letter 0	Section 35	Township 17S	Range 25E	County Eddy	
Actual Footage Location of Well: 660 feet from the South line and 1980 feet from the East line					
Ground Level Elev. 3490'	Producing Formation Wolfcamp	Pool Wildcat Wolfcamp	Dedicated Acreage: 320 Acres		

1. Outline the acreage dedicated to the subject well by colored pencil or hatchure marks on the plat below.
2. If more than one lease is dedicated to the well, outline each and identify the ownership thereof (both as to working interest and royalty).
3. If more than one lease of different ownership is dedicated to the well, have the interests of all owners been consolidated by communitization, unitization, force-pooling, etc?

☒ Yes ☐ No If answer is "yes," type of consolidation Communitized

If answer is "no," list the owners and tract descriptions which have actually been consolidated. (Use reverse side of this form if necessary.)

No allowable will be assigned to the well until all interests have been consolidated (by communitization, unitization, forced-pooling, or otherwise) or until a non-standard unit, eliminating such interests, has been approved by the Commission.

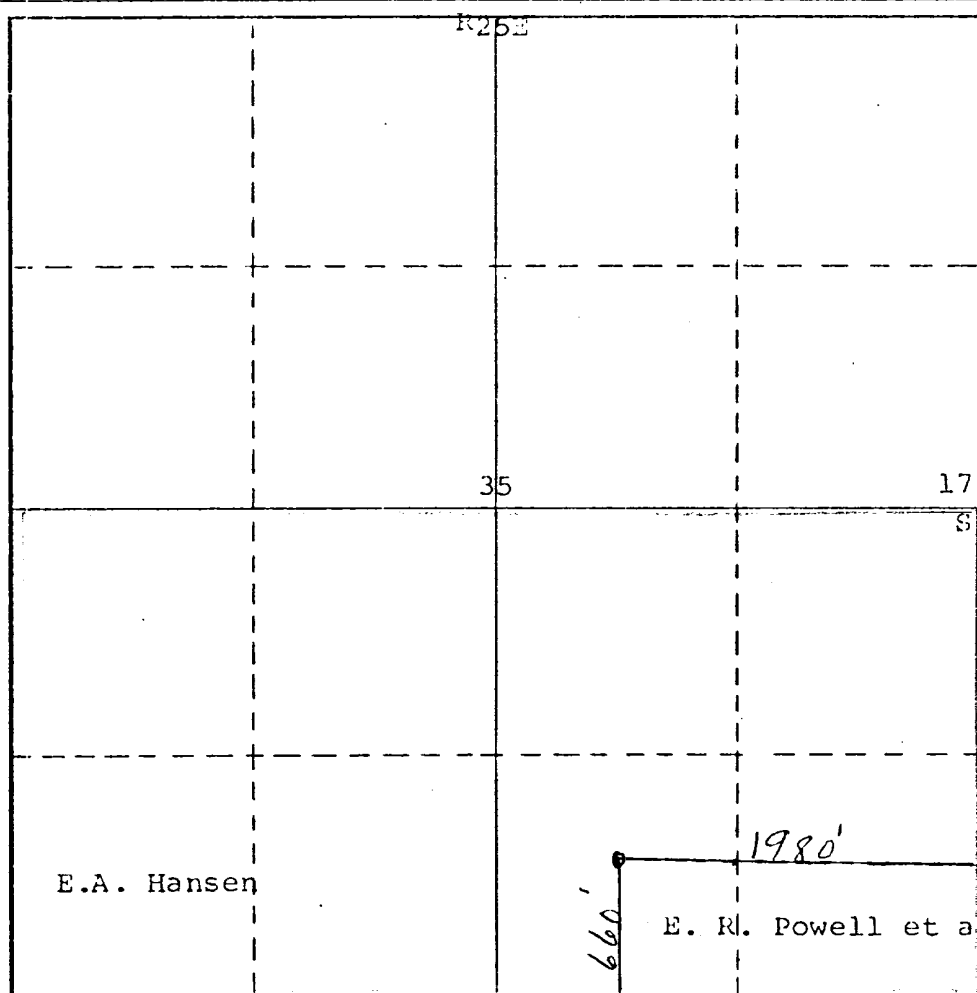

CERTIFICATION

I hereby certify that the information contained herein is true and complete to the best of my knowledge and belief.

Eddie M. Mahfood
Name

Eddie M. Mahfood

Position
Engineer

Company
Yates Petroleum Corp

Date
2-16-77

I hereby certify that the well location shown on this plat was plotted from field notes of actual surveys made by me or under my supervision, and that the same is true and correct to the best of my knowledge and belief.

Refer to Original Plat

Date Surveyed
Dated 2-14-74

Registered Professional Engineer
and/or Land Surveyor

Certificate No.

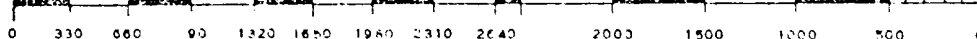

RECEIVED

NEW MEXICO OIL CONSERVATION COMMISSION

FEB 21 1977

P. O. DRAWER "DD"

ARTESIA, NEW MEXICO 88210

O. C. C.
ARTESIA, NEW MEXICO
AIR MAIL

NOTICE OF GAS CONNECTION

DATE February 17, 1977

This is to notify the Oil Conservation Commission that connection
for the purchase of gas from the Yates Petroleum Corp.. Powell "DG" Com.
Operator Lease
Well #1 - Unit Letter* . 35-17S-25E . *Wildcat Wolfcamp* . Transwestern .
Well Unit S.T.R. Pool Name of purchaser
~~*Unknown~~ Eddy County (~~Morrow-Cisco~~)
was made on February 7, 1977 .

Transwestern Pipeline Company

H. N. Aicklen

H. N. Aicklen

Representative

Supervisor Gas Purchase Contract Administration
Title

cc: Operator
Oil Conservation Commission - Santa Fe