

NEW MEXICO OIL CONSERVATION COMMISSION
WELL LOCATION AND ACREAGE DEDICATION PLAT

Form C-102
Supersedes C-128
Effective 1-1-65

All distances must be from the outer boundaries of the Section.

Operator Estoril Producing Corp			Lease Mesa Federal		Well No. 1
Unit Letter K	Section 30	Township 17 South	Range 24 East	County Eddy	
Actual Footage Location of Well: 1930 feet from the South line and 1930 feet from the West line					
Ground Level Elev. 3376	Producing Formation Morrow	Pool Wildcat	Dedicated Acreage: 320 Acres		

1. Outline the acreage dedicated to the subject well by colored pencil or hachure marks on the plat below.
2. If more than one lease is dedicated to the well, outline each and identify the ownership thereof (both as to working interest and royalty).
3. If more than one lease of different ownership is dedicated to the well, have the interests of all owners been consolidated by communitization, unitization, force-pooling, etc?

☒ Yes ☐ No If answer is "yes," type of consolidation _____

If answer is "no," list the owners and tract descriptions which have actually been consolidated. (Use reverse side of this form if necessary.) _____

No allowable will be assigned to the well until all interests have been consolidated (by communitization, unitization, forced-pooling, or otherwise) or until a non-standard unit, eliminating such interests, has been approved by the Commission.

North Line Section 30

West Line Section 30

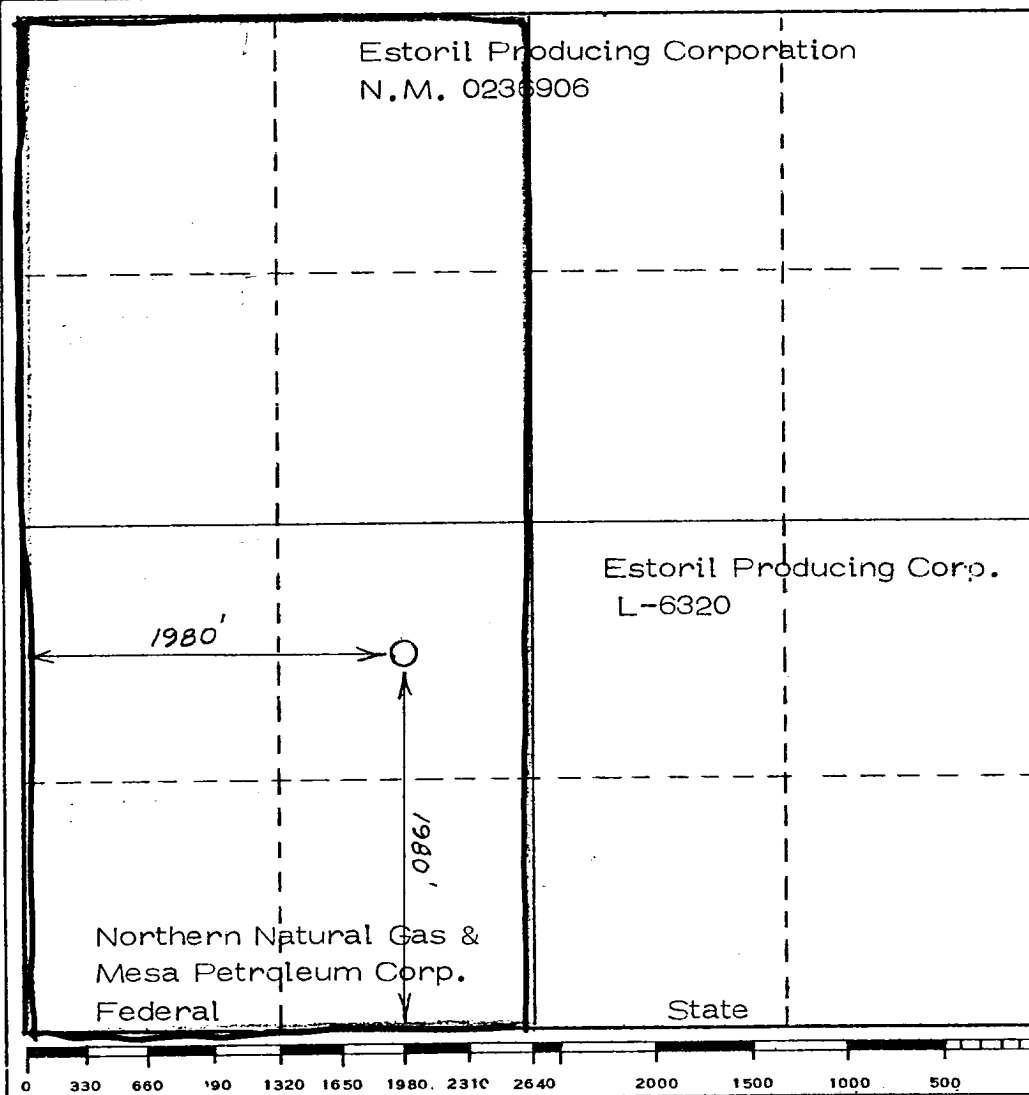

CERTIFICATION

I hereby certify that the information contained herein is true and complete to the best of my knowledge and belief.

Name Richard C. Norman
Position
Agent
Company
Estoril Producing Corp.

Date
February 27, 1974

I hereby certify that the well location shown on this plat was located from field checked actual surveys made by me or under my supervision and that the same is true and correct to the best of my knowledge and belief.

Date Surveyed
February 26th 1974
Registered Professional Engineer
and/or Land Surveyor

James H. Brown
Certificate No.

542