

NO. OF COPIES RECEIVED	6
DISTRICTION	
SANTA FE	
FILE	
U.S.G.S.	
LAND OFFICE	
OPERATOR	

RECEIVED  
NEW MEXICO OIL CONSERVATION COMMISSION

AUG 18 1980

O. C. D.  
ARTESIA OFFICE

30-015-21402  
Form C-101  
Revised 1-1-65

5A. Indicate Type of Lease STATE <input checked="" type="checkbox"/> FEE <input type="checkbox"/>
5. State Oil & Gas Lease No. B-2175

APPLICATION FOR PERMIT TO DRILL, DEEPEN, OR PLUG BACK

1a. Type of Work b. Type of Well OIL WELL <input type="checkbox"/> GAS WELL <input checked="" type="checkbox"/> OTHER <input type="checkbox"/> 2. Name of Operator Yates Petroleum Corporation 3. Address of Operator 207 S. 4th, Artesia, NM 88210 4. Location of Well UNIT LETTER H LOCATED 1980 FEET FROM THE North LINE AND 660 FEET FROM THE East LINE OF SEC. 32 TWP. 16S RGE. 30E NMPM		7. Unit Agreement Name 8. Farm or Lease Name Marco Polo EA State 9. Well No. 1 10. Field and Pool or Wildcat Wildcat <del>Morrow</del> <i>Atoka</i> 12. County Eddy
19. Proposed Depth 10958 PBTD 21. Elevations (Show whether DF, RT, etc.) 3749 KB - 3732 GL		19A. Formation Atoka 20. Rotary or C.T. Pulling Unit 22. Approx. Date Work will start On approval

23.

PROPOSED CASING AND CEMENT PROGRAM

SIZE OF HOLE	SIZE OF CASING	WEIGHT PER FOOT	SETTING DEPTH	SACKS OF CEMENT	EST. TOP
17-1/2"	12-3/4"	48#	508'	285	Circ
11"	8-5/8"	32#	3200'	350	2100' Temp Survey
7-7/8"	4-1/2"	11.6# & 13.5#	10958'	810	8200' Temp Survey

Propose to temporarily abandon the Morrow by setting a retrievable bridge plug above existing Morrow perforations. Atoka intervals 10425-28' and 10660-66' will then be perforated and treated as necessary to obtain production.

IN ABOVE SPACE DESCRIBE PROPOSED PROGRAM: IF PROPOSAL IS TO DEEPEN OR PLUG BACK, GIVE DATA ON PRESENT PRODUCTIVE ZONE AND PROPOSED NEW PRODUCTIVE ZONE, GIVE BLOWOUT PREVENTER PROGRAM, IF ANY.

I hereby certify that the information above is true and complete to the best of my knowledge and belief.

Signed Albert R. Haly Title Engineer Date August 15, 1980  
(This space for State Use)

APPROVED BY W.A. Gussitt TITLE SUPERVISOR, DISTRICT II DATE AUG 20 1980  
CONDITIONS OF APPROVAL, IF ANY:

NEW MEXICO OIL CONSERVATION COMMISSION  
WELL LOCATION AND ACREAGE DEDICATION PLAT

Form C-102  
Supersedes C-128  
Effective 1-1-65

All distances must be from the outer boundaries of the Section.

Operator <b>Yates Petroleum Corporation</b>			Lease <b>Marco Polo EA State</b>		Well No. <b>1</b>
Unit Letter <b>H</b>	Section <b>32</b>	Township <b>16S</b>	Range <b>30E</b>	County <b>Eddy</b>	
Actual Footage Location of Well: <b>1980</b> feet from the <b>North</b> line and <b>660</b> feet from the <b>East</b> line					
Ground Level Elev. <b>3732 GL</b>	Producing Formation <b>Atoka</b>		Pool <b>Wildcat</b>		Dedicated Acreage: <b>320</b> Acres

1. Outline the acreage dedicated to the subject well by colored pencil or hachure marks on the plat below.
2. If more than one lease is dedicated to the well, outline each and identify the ownership thereof (both as to working interest and royalty).
3. If more than one lease of different ownership is dedicated to the well, have the interests of all owners been consolidated by communitization, unitization, force-pooling, etc?

☐ Yes ☐ No If answer is "yes," type of consolidation \_\_\_\_\_

If answer is "no," list the owners and tract descriptions which have actually been consolidated. (Use reverse side of this form if necessary.) \_\_\_\_\_

No allowable will be assigned to the well until all interests have been consolidated (by communitization, unitization, forced-pooling, or otherwise) or until a non-standard unit, eliminating such interests, has been approved by the Commission.

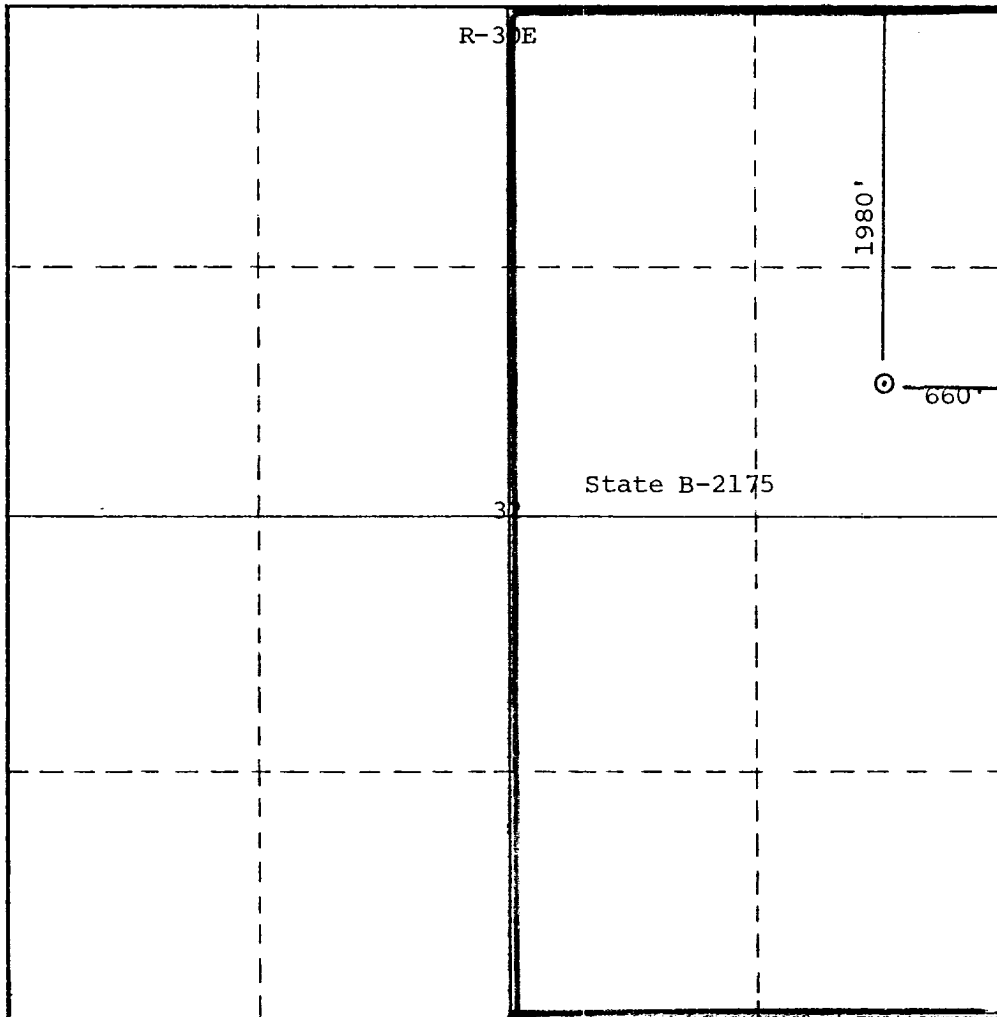

CERTIFICATION

I hereby certify that the information contained herein is true and complete to the best of my knowledge and belief.

*Albert R. Stall*  
Name

Albert R. Stall

Position  
Engineer

Company  
Yates Petroleum Corporation

Date  
8/15/80

I hereby certify that the well location shown on this plat was plotted from field notes of actual surveys made by me or under my supervision, and that the same is true and correct to the best of my knowledge and belief.

(Please refer to original plat)

Date Surveyed

Registered Professional Engineer  
and/or Land Surveyor

Certificate No.