

NEW MEXICO OIL CONSERVATION COMMISSION
WELL LOCATION AND ACREAGE DEDICATION PLAT

Form O-112
Supersedes C-12
Effective 10/1/65

All distances must be from the outer boundaries of the Section

Texas Pacific Oil Company, Inc.		J. H. Ansley Unit		1
A	27	17 South	26 East	Eddy
660	North	660	East	
3318.4	Morrow	Kennedy Farms - Morrow	320	

- Outline the acreage dedicated to the subject well by colored pencil or hatchure marks on the plat below
- If more than one lease is dedicated to the well, outline each and identify the ownership thereon (interest and royalty)
- If more than one lease of different ownership is dedicated to the well, have the interests of all owners been consolidated by communitization, unitization, force-pooling etc?

RECEIVED

1974

Yes No If answer is "yes," type of consolidation Unitization

If answer is "no" list the owners and tract descriptions which have actually been consolidated. Use reverse side of this form, if necessary.

No allowable well will be assigned to the well until all interests have been consolidated (by communitization, unitization, forced-pooling, or otherwise) or until a non-standard unit, eliminating such interests, has been approved by the Commission.

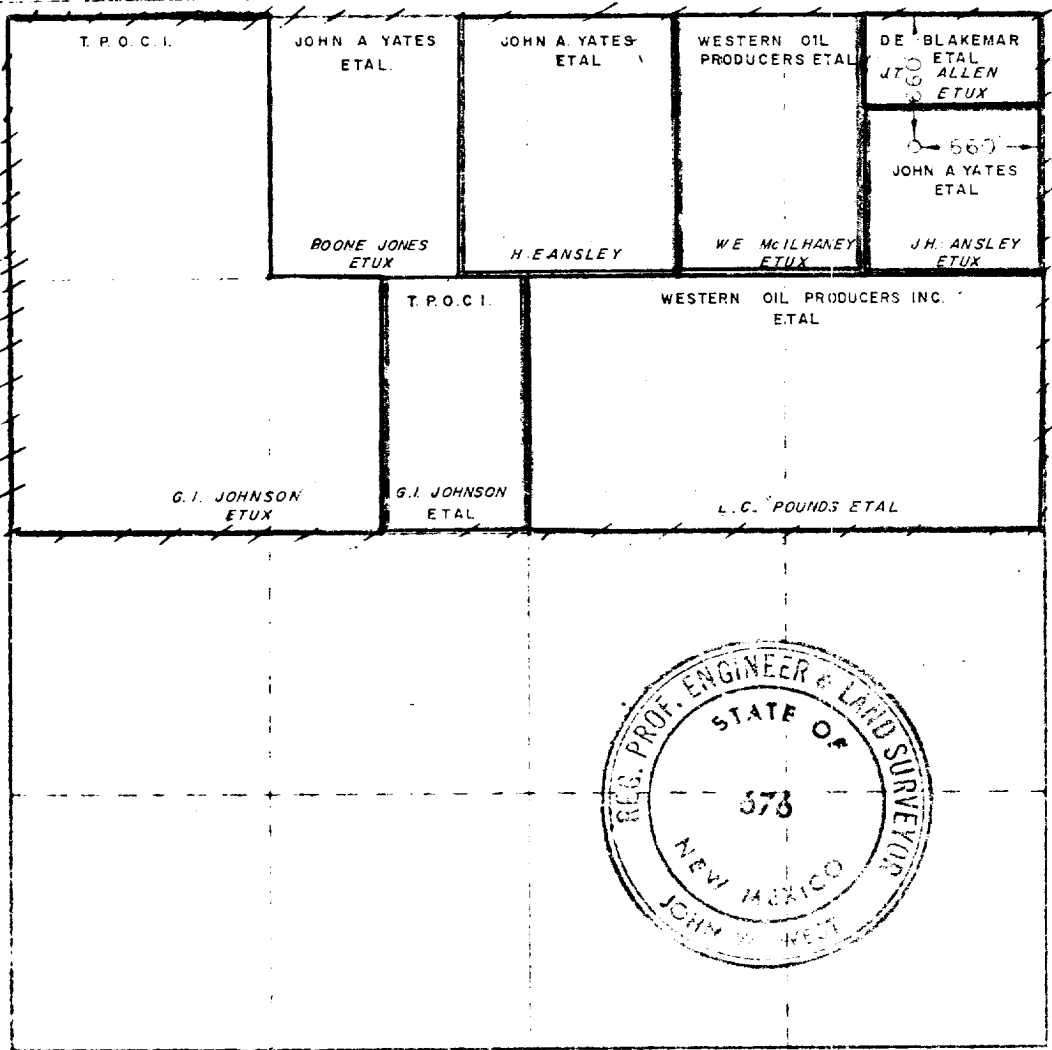

CERTIFICATION

I hereby certify that the information contained hereon is true and complete to the best of my knowledge and belief.

B. J. Knight
B. J. Knight

Drilling Coordinator

Texas Pacific Oil Co., Inc.

November 12, 1974

I hereby certify that the well location shown on this plat was plotted from field notes of actual surveys made by me or under my supervision, and that the same is true and correct to the best of my knowledge and belief.

November 6, 1974

John W. West

