

UNITED STATES
DEPARTMENT OF THE INTERIOR
GEOLOGICAL SURVEY

30-015-21479

APPLICATION FOR PERMIT TO DRILL, DEEPEN, OR PLUG BACK

| | | |
|---|----------------------------------|--|
| 1a. TYPE OF WORK DRILL <input checked="" type="checkbox"/> DEEPEN <input type="checkbox"/> PLUG BACK <input type="checkbox"/> | | 5. LEASE DESIGNATION AND SERIAL NO. Las Cruces 029431A |
| b. TYPE OF WELL OIL WELL <input checked="" type="checkbox"/> GAS WELL <input type="checkbox"/> OTHER <input type="checkbox"/> SINGLE ZONE <input checked="" type="checkbox"/> MULTIPLE ZONE <input type="checkbox"/> | | 6. IF INDIAN, ALLOTTEE OR TRIBE NAME |
| 2. NAME OF OPERATOR J. M. Welch | | 7. UNIT AGREEMENT NAME |
| 3. ADDRESS OF OPERATOR Box 496, Artesia, New Mexico 88210 | | 8. FARM OR LEASE NAME Federal |
| 4. LOCATION OF WELL (Report location clearly and in accordance with any State requirements.) At surface SE 1/4 SW 1/4 Sec. 18 - 16 - 31 At proposed prod. zone 330/S 1330/W | | 9. WELL NO. 3 |
| 14. DISTANCE IN MILES AND DIRECTION FROM NEAREST TOWN OR POST OFFICE* 7 mi. north & 4 mi. east Loco Hills, N. M. | | 10. FIELD AND POOL, OR WILDCAT Henshaw |
| 15. DISTANCE FROM PROPOSED* LOCATION TO NEAREST PROPERTY OR LEASE LINE, FT. (Also to nearest drilg. unit line, if any) 330' from south line | 16. NO. OF ACRES IN LEASE 160 | 11. SEC., T., R., M., OR BLK. AND SURVEY OR AREA 18 - T16 - R31 |
| 18. DISTANCE FROM PROPOSED LOCATION* TO NEAREST WELL, DRILLING, COMPLETED, OR APPLIED FOR, ON THIS LEASE, FT. 850' east of Fed. #1 | 19. PROPOSED DEPTH 3300' | 12. COUNTY OR PARISH Eddy |
| 21. ELEVATIONS (Show whether DF, RT, GR, etc.) 3910' Gr. | | 13. STATE N. M. |
| 23. PROPOSED CASING AND CEMENTING PROGRAM | | 17. NO. OF ACRES ASSIGNED TO THIS WELL 40 |
| | | 20. ROTARY OR CABLE TOOLS Rotary |
| | | 22. APPROX. DATE WORK WILL START* 3/1/75 |

| SIZE OF HOLE | SIZE OF CASING | WEIGHT PER FOOT | SETTING DEPTH | QUANTITY OF CEMENT |
|--------------|----------------|-----------------|---------------|--------------------|
| 10" | 8 5/8" | 20# | 450' | 50 sacks |
| 7" | 4 1/2" | 10.79# | 3,300 | 100 sacks |

RECEIVED
RECEIVED

FEB 12 1975

JAN 31 1975
U. S. GEOLOGICAL SURVEY
ARTESIA, NEW MEXICOO. C. C.
ARTESIA, OFFICE

IN ABOVE SPACE DESCRIBE PROPOSED PROGRAM: If proposal is to deepen or plug back, give data on present productive zone and proposed new productive zone. If proposal is to drill or deepen directionally, give pertinent data on subsurface locations and measured and true vertical depths. Give blowout preventer program, if any.

24.

SIGNED J. M. Welch TITLE Owner DATE Jan. 31, 1975
(This space for Federal or State office use)

PERMIT NO. _____ APPROVAL DATE _____

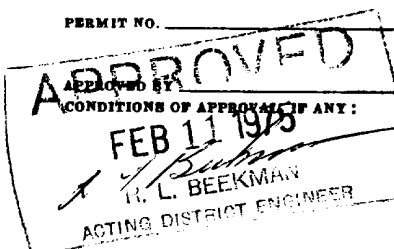

TITLE _____ DATE _____
THIS APPROVAL IS RESCINDED IF OPERATIONS
ARE NOT COMMENCED WITHIN 3 MONTHS.
EXPIRES MAY 11 1975

*See Instructions On Reverse Side

NE MEXICO OIL CONSERVATION COMMISSION
WELL LOCATION AND ACREAGE DEDICATION PLAT

Form C-102
Supersedes C-128
Effective 1-1-65

All distances must be from the outer boundaries of the Section.

| | | | | | |
|---|--|-----------------------------|---------------------------------------|-----------------------|--|
| Operator <i>James Welch</i> | | Lease <i>Federal</i> | | Well No. <i>3</i> | |
| Unit Letter <i>N</i> | Section <i>18</i> | Township <i>16 South</i> | Range <i>31 East</i> | County <i>Eddy</i> | |
| Actual Footage Location of Well: <i>1330</i> feet from the <i>West</i> line and <i>330</i> feet from the <i>South</i> line | | | | | |
| Ground Level Elev. <i>3910</i> | Producing Formation <i>SAN ANDRES</i> | Pool <i>HENSHAW</i> | Dedicated Acreage: <i>40</i> Acres | | |

1. Outline the acreage dedicated to the subject well by colored pencil or hachure marks on the plat below.
2. If more than one lease is dedicated to the well, outline each and identify the ownership thereof (both as to working interest and royalty).
3. If more than one lease of different ownership is dedicated to the well, have the interests of all owners been consolidated by communitization, unitization, force-pooling, etc?

☐ Yes ☐ No If answer is "yes," type of consolidation _____

If answer is "no," list the owners and tract descriptions which have actually been consolidated. (Use reverse side of this form if necessary.) _____

No allowable will be assigned to the well until all interests have been consolidated (by communitization, unitization, forced-pooling, or otherwise) or until a non-standard unit, eliminating such interests, has been approved by the Commission.

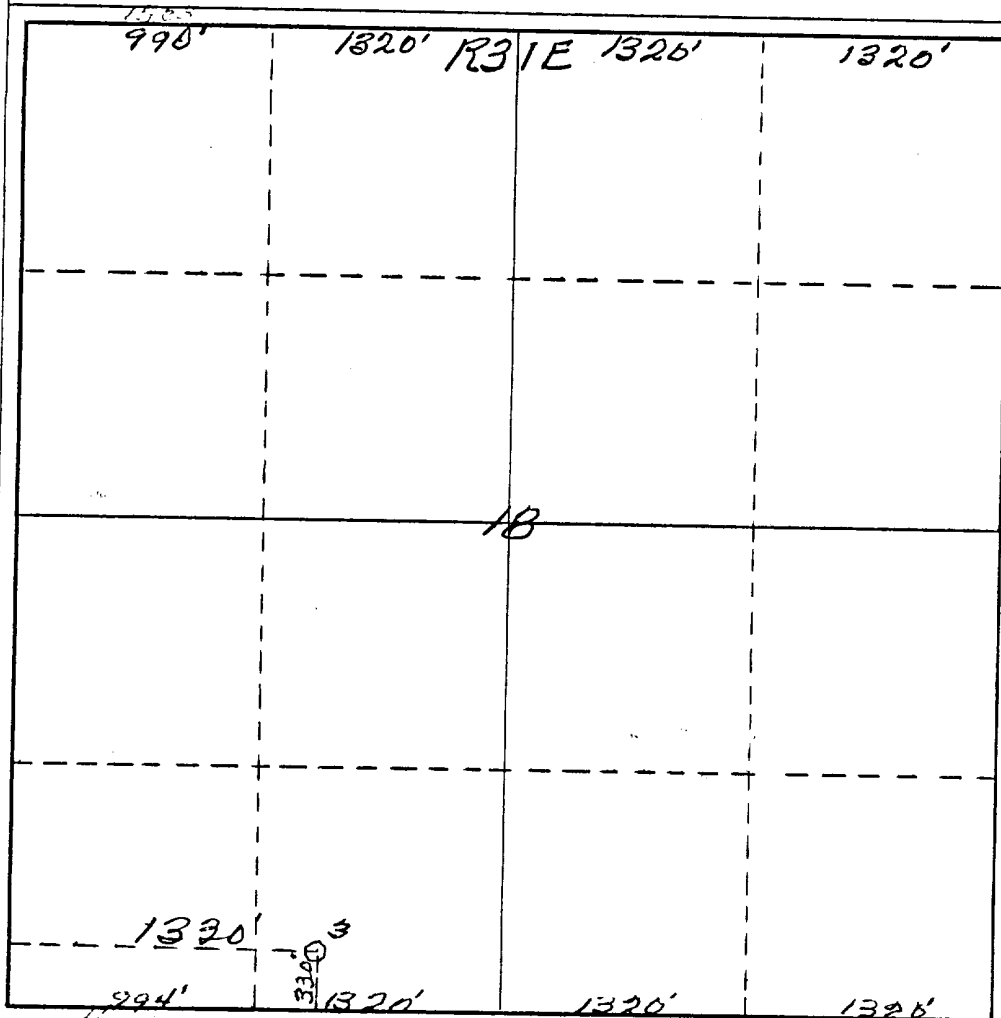

CERTIFICATION

I hereby certify that the information contained herein is true and complete to the best of my knowledge and belief.

Name *James Welch*

Position *Owner*

Company _____

Date *1-30-75*

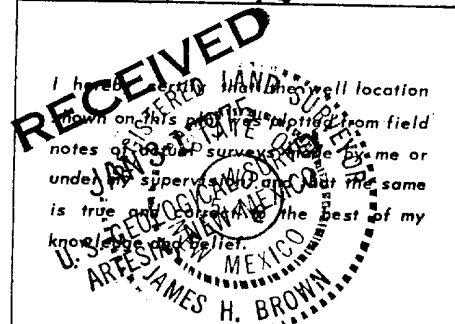

Date Surveyed *January 21st 1975*

Registered Professional Engineer and/or Land Surveyor

James H. Brown
Certificate No. *542*

J. M. Welch
Oil Producer and Operator
P. O. Box 496
Artesia, New Mexico - 88210

January 31, 1975

Department of the Interior
Geological Survey
P. O. Drawer 1857
Roswell, New Mexico 88201

Re: Welch Federal #3

Dear Sirs:

The water used for drilling on the Federal #3 well will be trucked from Loco Hills to the well site.

Method for disposal of waste material will be to put it in a reserve and cover it up after completion of the well.

The location of this well is in sandy, arid land and has mostly mesquite and cactus growing on it. If the well is a dry hole and if required, I will rip up the location and the proposed road to the location.

The person responsible for compliance of the Development Plan for Surface Use is J. M. Welch, Artesia, New Mexico, phone 746-2583.

If any additional information is required, please notify me.

Very truly yours,



J. M. Welch

JMW:1a

RECEIVED
JAN 31 1975
U. S. GEOLOGICAL SURVEY
ARTESIA, NEW MEXICO

A 30E

R 3E

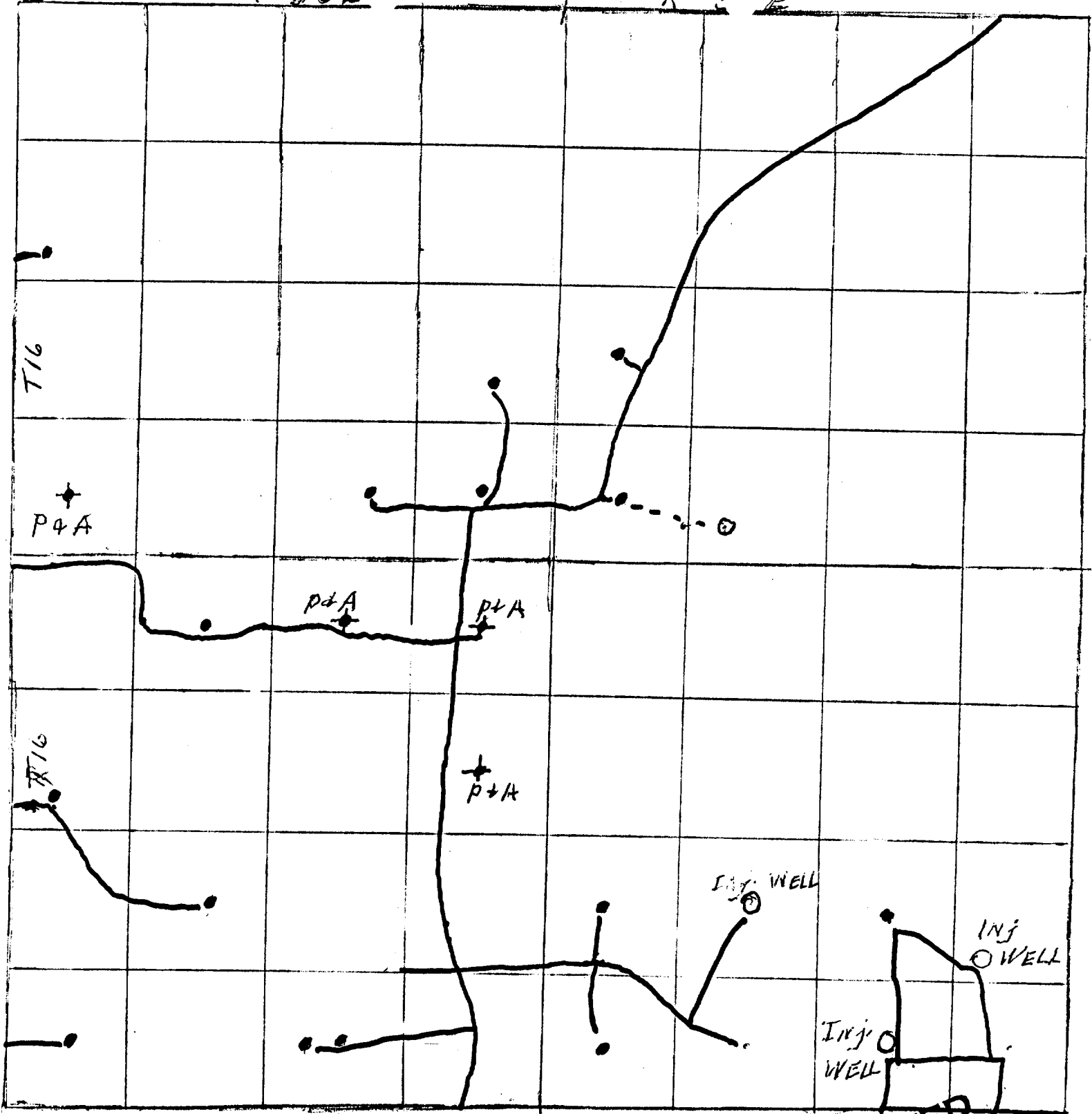

RECEIVED
JAN 31 1975
U. S. GEOLOGICAL SURVEY
ARTESIA, NEW MEXICO

OW + SEC. 18 116 R3, .

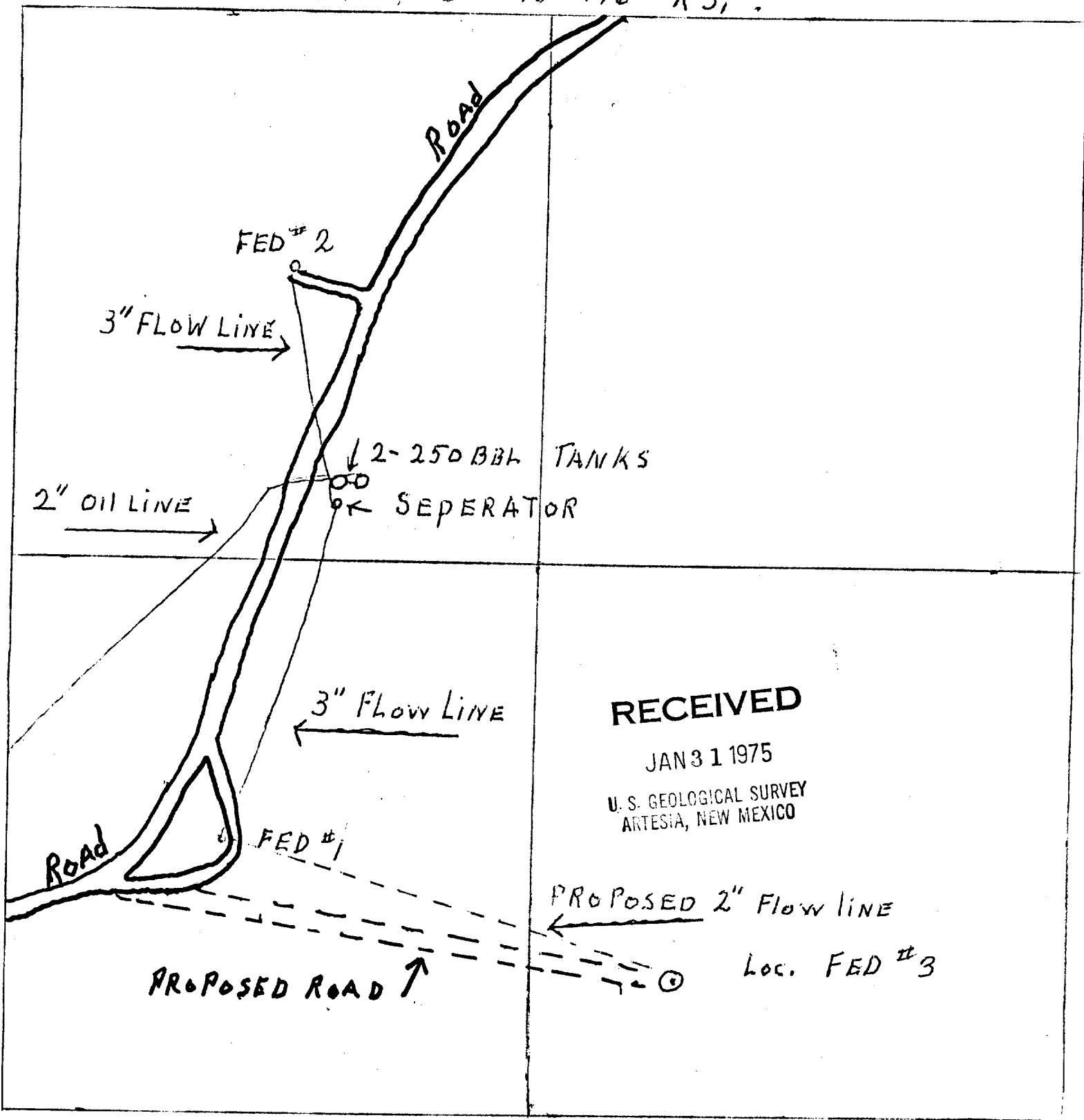

RECEIVED

JAN 31 1975

U. S. GEOLOGICAL SURVEY
ARTESIA, NEW MEXICO

PROPOSED ROAD WOULD HAVE 20' RIGHT OF WAY, 12' WIDE 6" DEEP
CALICHE COMPACTED ROAD 850' LONG

Rig 1 Location & Mud Pit Specs.

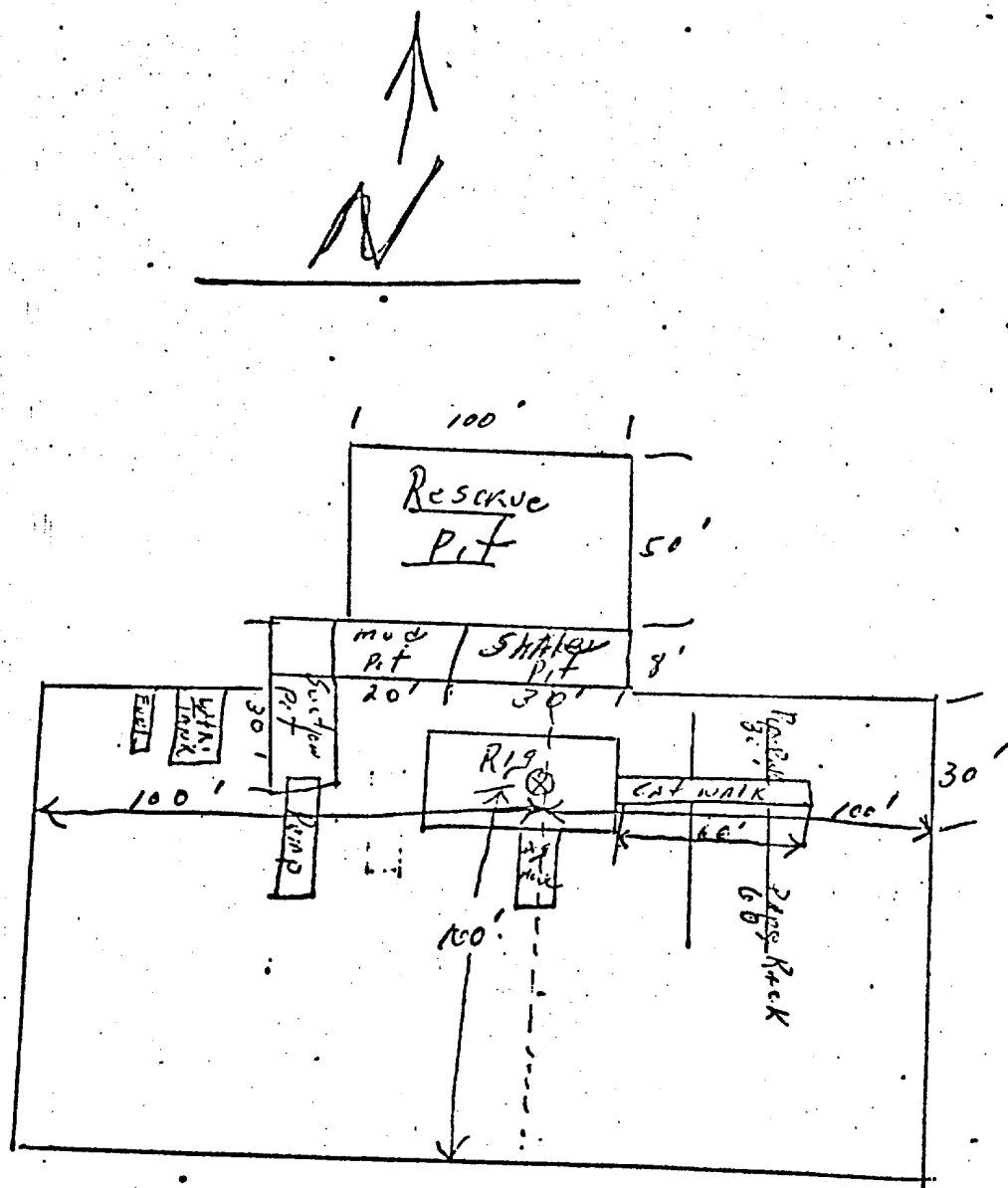

Schaeffer Type E 10" Series 900 Hydraulic BOP. The waste and debris from this well will be disposed of in a reserve pit and covered up.

RECEIVED

JAN 31 1975

U. S. GEOLOGICAL SURVEY
ARTESIA, NEW MEXICO

5130 11 SE
(KING CAMP)
124000

