

UNITED STATES  
DEPARTMENT OF THE INTERIOR  
GEOLOGICAL SURVEY

## APPLICATION FOR PERMIT TO DRILL, DEEPEN, OR PLUG BACK

## 1a. TYPE OF WORK

DRILL ☒DEEPEN ☐PLUG BACK ☐

## b. TYPE OF WELL

OIL  
WELL ☒GAS  
WELL ☐OTHER ☐SINGLE  
ZONE ☐MULTIPLE  
ZONE ☐

## 2. NAME OF OPERATOR

General American Oil Company of Texas

## 3. ADDRESS OF OPERATOR

P. O. Box 416 Loco Hills, New Mexico 88255

## 4. LOCATION OF WELL (Report location clearly and in accordance with any State requirements.\*)

At surface

825' FNL and 1295' FNL

Section: 13, T-16S, R-29E, C.C.

At proposed prod. zone

ARTESIA, OFFICE

## 14. DISTANCE IN MILES AND DIRECTION FROM NEAREST TOWN OR POST OFFICE\*

7 Miles North and 1-1/2 Miles West of Loco Hills, N. M. 88255

## 15. DISTANCE FROM PROPOSED\*

LOCATION TO NEAREST  
PROPERTY OR LEASE LINE, FT.  
(Also to nearest drlg. unit line, if any)

3985'

## 16. NO. OF ACRES IN LEASE

1040

## 18. DISTANCE FROM PROPOSED LOCATION\*

TO NEAREST WELL, DRILLING COMPLETED,  
OR APPLIED FOR, ON THIS LEASE, FT.

635'

## 19. PROPOSED DEPTH

2200

## 21. ELEVATIONS (Show whether DF, RT, GR, etc.)

3729.2 GR

## 23.

## PROPOSED CASING AND CEMENTING PROGRAM

SIZE OF HOLE	SIZE OF CASING	WEIGHT PER FOOT	SETTING DEPTH	QUANTITY OF CEMENT
12-1/4"	8-5/8"	20#	425'	100 sacks
7-7/8"	4-1/2"	9.5#	2200'	150 sacks

We propose to drill this well to 2200' and complete in the Penrose sand (Queen).

If necessary producing zone will be acidized or fraced.

Mud Program: Water and native mud will be used and approximately 200' from T.D.  
We will mud up to get hole in shape to log.

A 10" 3000# Blowout preventor will be used in the drilling of this well.

IN ABOVE SPACE DESCRIBE PROPOSED PROGRAM: If proposal is to deepen or plug back, give data on present productive zone and proposed new productive zone. If proposal is to drill or deepen directionally, give pertinent data on subsurface locations and measured and true vertical depths. Give blowout preventer program, if any.

24.

SIGNED

*Ray Crow*

TITLE

District Superintendent

DATE

March 17, 1975

(This space for Federal or State office use)

PERMIT NO.

APPROVAL DATE

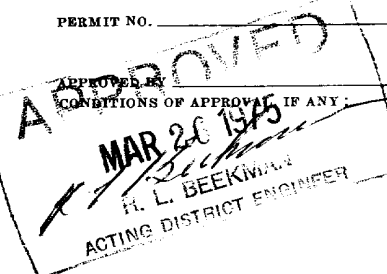
THIS APPROVAL IS RE-INDENTED IF OPERATIONS  
ARE NOT COMMENCED WITHIN 3 MONTHS.  
EXPIRES JUN 26 1975  
\*See Instructions On Reverse Side

DATE

RECEIVED

MAR 19 1975

U. S. GEOLOGICAL SURVEY  
ARTESIA, NEW MEXICONSL  
R-5012

NEW MEXICO OIL CONSERVATION COMMISSION  
WELL LOCATION AND ACREAGE DEDICATION PLAT

Form O-111  
Supersedes O-108  
Effective 1-1-65

All distances must be from the outer boundaries of the Section

General American Oil Co.

Brewer #29

29

D

13

16 South

29 East

Eddy

825

North

1295

West

3729.2

Penrose Sand (Queen)

High Lonesome

40

- 1 Outline the acreage dedicated to the subject well by colored pencil or hatchure marks on the plat below
- 2 If more than one lease is dedicated to the well, outline each and identify the ownership thereof (both as to working interest and royalty)
- 3 If more than one lease of different ownership is dedicated to the well, have the interests of all owners been consolidated by communitization, unitization, force-pooling, etc?

Yes ☐ No ☐ If answer is "yes" type of consolidation \_\_\_\_\_

If answer is "no" list the owners and tract descriptions which have actually been consolidated. Use reverse side of this form if necessary. \_\_\_\_\_

No allowable will be assigned to the well until all interests have been consolidated by communitization, unitization, force-pooling, or otherwise or until a non-standard unit, eliminating such interests, has been approved by the Commission.

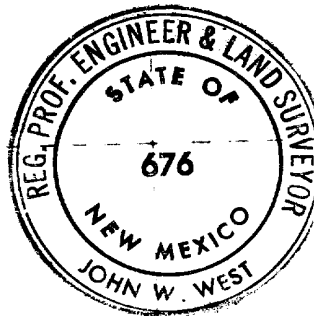
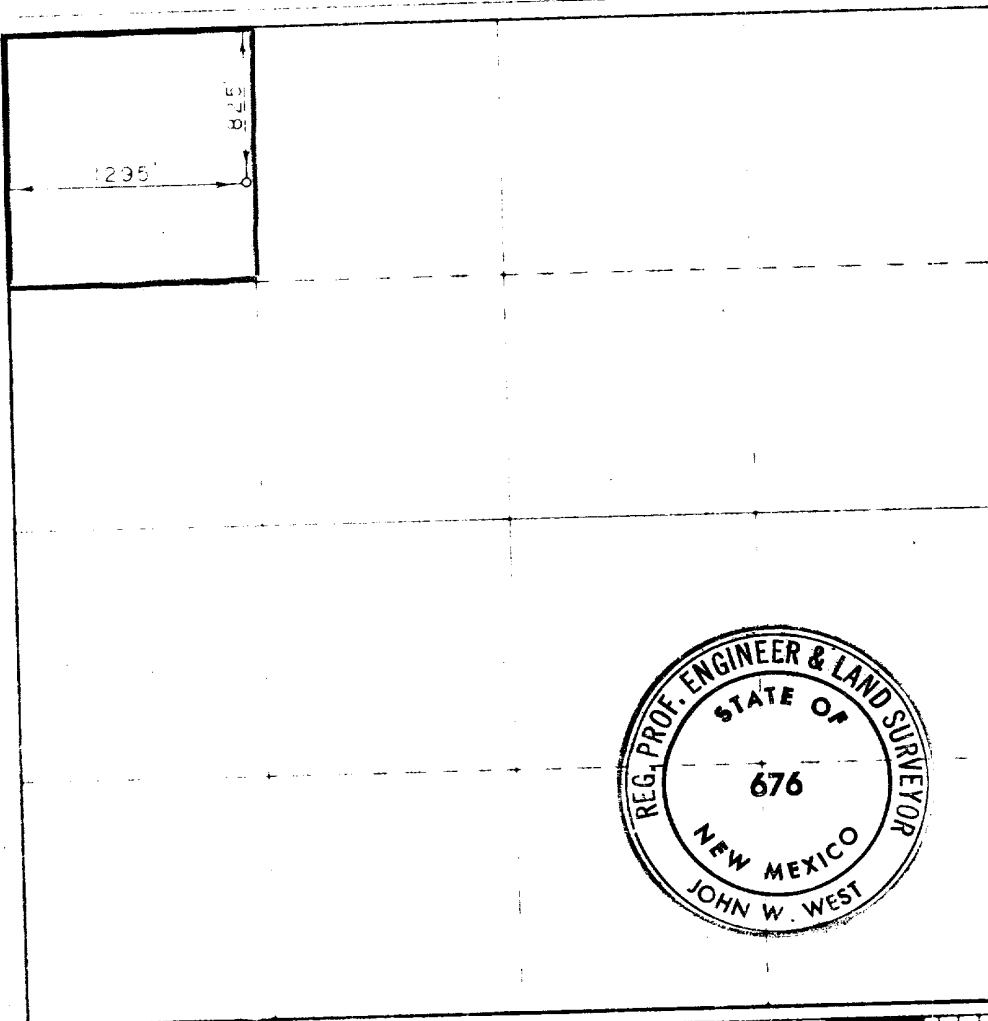

CERTIFICATION

I hereby certify that the information contained herein is true and complete to the best of my knowledge and belief.

Roy Crow

District Superintendent

General American Oil Co. of Texas

March 17, 1975

I hereby certify that the well location shown on this plat is based on field notes of actual surveys made by me or under my supervision and that the same are correct to the best of my knowledge.  
**RECEIVED**  
MAR 19 1975  
U.S. GEOLOGICAL SURVEY  
ARTESIA, NEW MEXICO

3-12-75

Registered Professional Engineer and Land Surveyor

John W. West

676

SURFACE USE CHECK LIST

GENERAL AMERICAN PROPOSED BREWER #29

Section 13, Township 16-S, Range 29-E

Eddy County, New Mexico

1. Existing main roads are shown on Exhibit "A" and "B".
2. Planned access road will require about 100' of new road. The road will be surfaced with caliche. The location will be surfaced with caliche.
3. Location of existing wells are shown on Exhibit "B".
4. Lateral roads to well locations are shown on Exhibit "B".
5. No new tank battery will be constructed. Existing tank battery on lease will be used. Tank batteries in the immediate area are shown on Exhibit "B".
6. Water supply to drill this well is available on lease and will be piped to location as shown on Exhibit "B" with no additional right of way required.
7. Waste disposal will be handled by appropriate approved means at such times as it becomes necessary.
8. No camps are planned.
9. No airstrips will be constructed.
10. Location and layout including position of the rig, mud tanks, reserve pits, pipe rack, etc. are shown on Exhibit "C".
11. All pits used for drilling will be leveled back to their natural contours after they have dried.

RECEIVED  
JAN 11 1967  
BUREAU OF LAND MANAGEMENT  
ALBUQUERQUE, NEW MEXICO

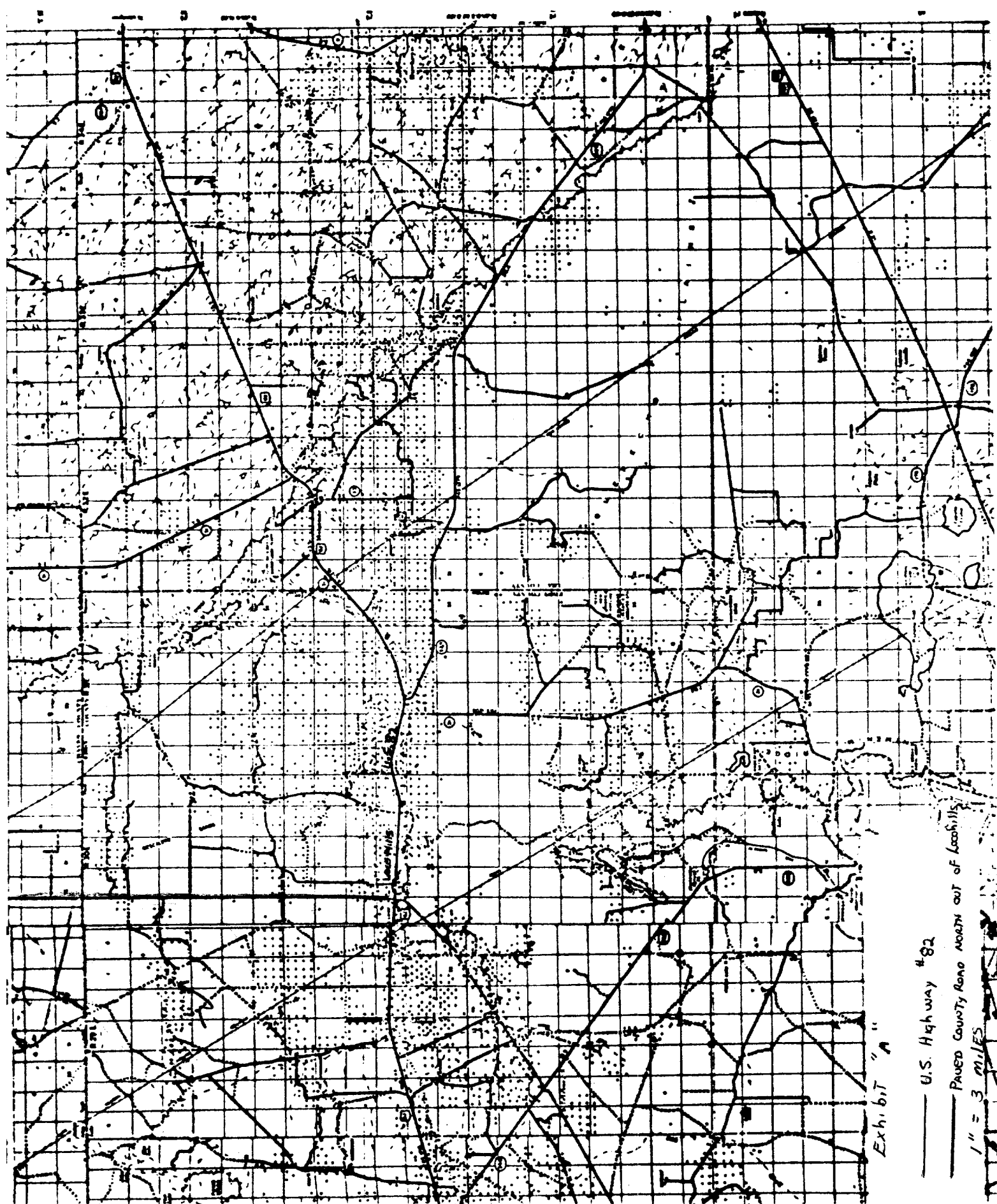
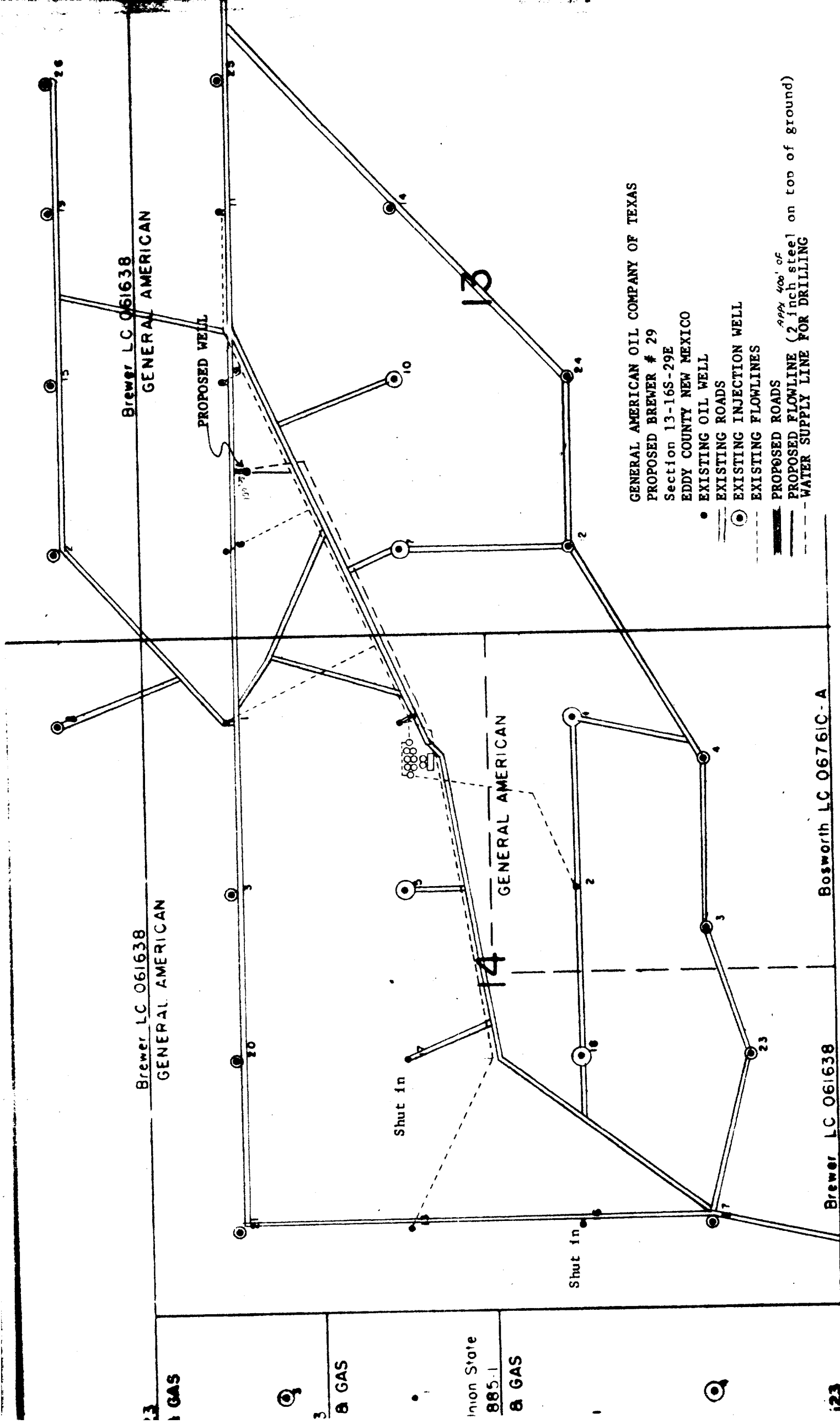

Exhibit "A"

- U.S. Highway #82
- PAVED COUNTY ROAD NORTH OUT OF LOACHILLS
- 1" = 3 MILES



GENERAL AMERICAN OIL COMPANY OF TEXAS

PROPOSED BREWER # 29

Section 13-16S-29E

EDDY COUNTY NEW MEXICO

• EXISTING OIL WELL

--- EXISTING ROADS

○ EXISTING INJECTION WELL

--- EXISTING FLOWLINES

=== PROPOSED ROADS

--- PROPOSED FLOWLINE (2 inch steel on top of ground)

--- WATER SUPPLY LINE FOR DRILLING

Exhibit "B"

Exhibit "c"

