

NO. OF COPIES RECEIVED	
DISTRIBUTION	
SANTA FE	
FILE	
U.S.G.S.	
LAND OFFICE	
OPERATOR	

NEW MEXICO OIL CONSERVATION COMMISSION

30-015-21559

Form C-101
Revised 1-1-65

JUN 2 1975

O. C. C.
ARTESIA, OFFICE

APPLICATION FOR PERMIT TO DRILL, DEEPEN, OR PLUG BACK

1a. Type of Work DRILL <input checked="" type="checkbox"/> DEEPEN <input type="checkbox"/> PLUG BACK <input type="checkbox"/>		7. Unit Agreement Name
b. Type of Well OIL WELL <input checked="" type="checkbox"/> GAS WELL <input type="checkbox"/> OTHER <input type="checkbox"/> SINGLE ZONE <input type="checkbox"/> MULTIPLE ZONE <input type="checkbox"/>		8. Farm or Lease Name Flint
2. Name of Operator Western Oil Producers Inc.		9. Well No. 2
3. Address of Operator Box 2055 Roswell, N.M.		10. Field and Pool, or Wildcat W.C. Wildcat
4. Location of Well UNIT LETTER N LOCATED 330 FEET FROM THE South LINE AND 2310 FEET FROM THE West LINE OF SEC. 25 TWP. 17-S RGE. 25-E NMPM		12. County Eddy
19. Proposed Depth 9100'		19A. Formation Devonian
20. Rotary or C.T. Rotary		21. Elevations (Show whether DF, RT, etc.) 3460 Gr.
21A. Kind & Status Plug. Bond ST. Wide		21B. Drilling Contractor WEK Drlg.
22. Approx. Date Work will start 6-10-75		

23.

PROPOSED CASING AND CEMENT PROGRAM

SIZE OF HOLE	SIZE OF CASING	WEIGHT PER FOOT	SETTING DEPTH	SACKS OF CEMENT	EST. TOP
17 1/2"	12 3/4"	32#	500'	300	Circ.
11" & 12 1/4"	8 5/8"	24#	1300' +/-	650	Circ.
7 7/8"	4 1/2" or 5 1/2"	11.6# or 17#	9100'	250	8000'

BOP will be Shaffer LWS Series 900 hydraulic double w/ remote controls, w/ series 900 Hydrill. Equipment will be checked every tripp.

APPROVAL VALID
FOR 90 DAYS UNLESS
DRILLING COMMENCED,
EXPIRES 9-5-75

IN ABOVE SPACE DESCRIBE PROPOSED PROGRAM: IF PROPOSAL IS TO DEEPEN OR PLUG BACK, GIVE DATA ON PRESENT PRODUCTIVE ZONE AND PROPOSED NEW PRODUCTIVE ZONE. GIVE BLOWOUT PREVENTER PROGRAM, IF ANY.

I hereby certify that the information above is true and complete to the best of my knowledge and belief.

Signed [Signature] Title [Signature] Date 6-2-75

(This space for State Use)

APPROVED BY W.A. Gassett TITLE SUPERVISOR, DISTRICT II DATE JUN 5 1975

CONDITIONS OF APPROVAL, IF ANY:

8 7/8" must be set at least 100' below bottom of bottom hole zone. Cement must be circulated to surface behind 12 7/8" & 8 7/8" casing the 8 7/8" casing

Notify N.M.O.C.C. in sufficient time to witness cementing

NEW MEXICO OIL CONSERVATION COMMISSION
WELL LOCATION AND ACREAGE DEDICATION PLAT

Form C-102
Supersedes C-128
Effective 1-1-65

All distances must be from the outer boundaries of the Section.

Operator Western Oil Prod., Inc.		Lease Flint		Well No. 2	
Unit Letter N	Section 25	Township 17S	Range 25E	County Eddy	
Actual Footage Location of Well: 2310' feet from the West line and 330' feet from the South line					
Ground Level Elev. 3460 Gr	Producing Formation Devonian	Pool Wildcat		Dedicated Acreage: 40 Acres	

1. Outline the acreage dedicated to the subject well by colored pencil or hatchure marks on the plat below.
2. If more than one lease is dedicated to the well, outline each and identify the ownership thereof (both as to working interest and royalty).
3. If more than one lease of different ownership is dedicated to the well, have the interests of all owners been consolidated by communitization, unitization, force-pooling, etc?

☐ Yes ☐ No If answer is "yes," type of consolidation _____

If answer is "no," list the owners and tract descriptions which have actually been consolidated. (Use reverse side of this form if necessary.) _____

No allowable will be assigned to the well until all interests have been consolidated (by communitization, unitization, forced-pooling, or otherwise) or until a non-standard unit, eliminating such interests, has been approved by the Commission.

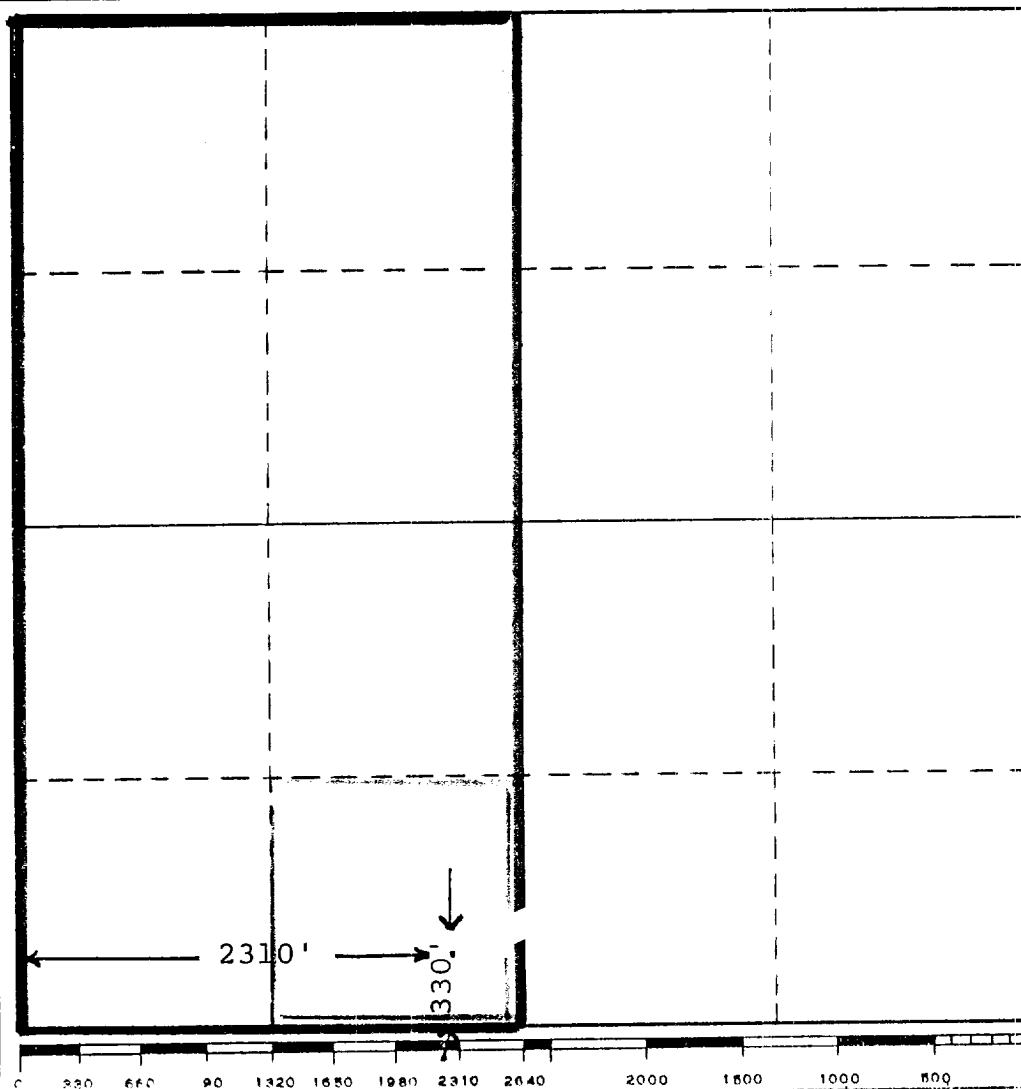

CERTIFICATION

I hereby certify that the information contained herein is true and complete to the best of my knowledge and belief.

Name *Ken Reynolds*
Position *Supt*
Company **Western Oil Prod., Inc.**
Date **6-2-75**

I hereby certify that the well location shown on this plat was plotted from field notes of actual surveys made by me or under my supervision, and that the same is true and correct to the best of my knowledge and belief.

Date Surveyed **5-22-75**
Registered Professional Engineer and/or Land Surveyor *N. Raymond Lamb*
N. Raymond Lamb
Certificate No. **929**