

NO. OF COPIES RECEIVED	
DISTRIBUTION	
SANTA FE	
FILE	
U.S.G.S.	
LAND OFFICE	
OPERATOR	

NEW MEXICO OIL CONSERVATION COMMISSION

RECEIVED

JUN 9 1975

30-015-21564
Form C-101
Revised 1-1-65

5A. Indicate Type of Lease
STATE ☐ FEDERAL ☒

5. State Oil & Gas Lease No.

7. Unit Agreement Name

8. Form or Lease Name

Jackson "EM" Com

9. Well No.

1

10. Field and Pool, or Wildcat

Wildcat

12. County

Eddy

APPLICATION FOR PERMIT TO DRILL, DEEPEN, OR PLUG BACK
ARTESIA OFFICE

1a. Type of Work
b. Type of Well DRILL ☒ DEEPEN ☐ PLUG BACK ☐
OIL WELL ☐ GAS WELL ☒ OTHER ☐ SINGLE ZONE ☐ MULTIPLE ZONE ☐

2. Name of Operator
Yates Petroleum Corporation

3. Address of Operator
207 South 4th Street - Artesia, NM 88210

4. Location of Well
UNIT LETTER 0 LOCATED 660 FEET FROM THE South LINE
AND 1980 FEET FROM THE East LINE OF SEC. 25 TWP. 17S RGE. 25E NMPM

19. Proposed Depth
Approx 8950

19A. Formation
Morrow

20. Rotary or C.T.
Rotary

21. Elevations (Show whether DT, RT, etc.)
3453'

21A. Kind & Status Plug. Bond
Blanket

21B. Drilling Contractor
Ard Drilling Company

22. Approx. Date Work will start
As soon as approved

23. PROPOSED CASING AND CEMENT PROGRAM

SIZE OF HOLE	SIZE OF CASING	WEIGHT PER FOOT	SETTING DEPTH	SACKS OF CEMENT	EST. TOP
17 1/2"	12 1/4 or 13-3/8"	30 or 48#	Approx 400'	Circulate	
12 1/4"	8-5/8"	24#	" 1300'	Circulate	
7-7/8"	4 1/2 or 5 1/2"	9.5 or 11.6	" 8950'	250 sacks	
	or 15.5 or 17#				

It is our intention to drill a Morrow Test to approx. 8950'. 13-3/8" or 12 1/4" casing will be set at approx. 400' and cement circulated, to prevent caving, 8-5/8" intermediate casing will be set 100' below the Artesian water zone and cement circulated. If commercial production is encountered 4 1/2 or 5 1/2" production casing will be run and cemented.

Mud Program: - FW gel & LCM to 1300', water to 6200', Flosal & Drispak from 6200' to Total Depth.

BOP Program: - BOP's will be installed on 8-5/8" casing, pipe valves tested daily and blind rams on trips.

Non-Standard location is pending.

IN ABOVE SPACE DESCRIBE PROPOSED PROGRAM: IF PROPOSAL IS TO DEEPEN OR PLUG BACK, GIVE DATA ON PROPOSED PRODUCTIVE ZONE AND PROPOSED NEW PRODUCTION ZONE. GIVE BLOWOUT PREVENTER PROGRAM, IF ANY.

I hereby certify that the information above is true and complete to the best of my knowledge and belief.

Signed Ray Beck Title Geologist Date 6-9-75

(This space for State Use)

APPROVED BY W. A. Gressett TITLE SUPERVISOR, DISTRICT II DATE JUN 12 1975

CONDITIONS OF APPROVAL, IF ANY:

Cement must be circulated to surface behind 12 3/4 + 8 3/8" casing

Notify N.M.O.C.C. in sufficient time to witness cementing the 8 3/8" casing

APPROVAL VALID FOR 90 DAYS UNLESS DRILLING COMMENCED, 9-12-75

NEW MEXICO OIL CONSERVATION COMMISSION
WELL LOCATION AND ACREAGE DEDICATION PLAT

Form O-102
Supersedes O-128
Effective 1-1-65

All distances must be from the outer boundaries of the Section.

Operator <i>Yates Petroleum Corp.</i>			Lease <i>Jackson "EM"</i>		Well No. <i>1</i>
Unit Letter <i>0</i>	Section <i>25</i>	Township <i>17 South</i>	Range <i>25 East</i>	County <i>Eddy</i>	
Actual Footage Location of Well: <i>660</i> feet from the <i>South</i> line and <i>1980</i> feet from the <i>East</i> line					
Ground Level Elev. <i>3453</i>	Producing Formation <i>Moran</i>		Pool <i>Undesignated</i>	Dedicated Acreage <i>3.20</i> Acres	

- Outline the acreage dedicated to the subject well by colored pencil or hatchure marks on the plat below.
- If more than one lease is dedicated to the well, outline each and identify the ownership thereof (both as to working interest and royalty).
- If more than one lease of different ownership is dedicated to the well, have the interests of all owners been consolidated by communitization, unitization, force-pooling, etc?

☒ Yes ☐ No If answer is "yes," type of consolidation Communitized

If answer is "no," list the owners and tract descriptions which have actually been consolidated. (Use reverse side of this form if necessary.) _____

No allowable will be assigned to the well until all interests have been consolidated (by communitization, unitization, forced-pooling, or otherwise) or until a non-standard unit, eliminating such interests, has been approved by the Commission.

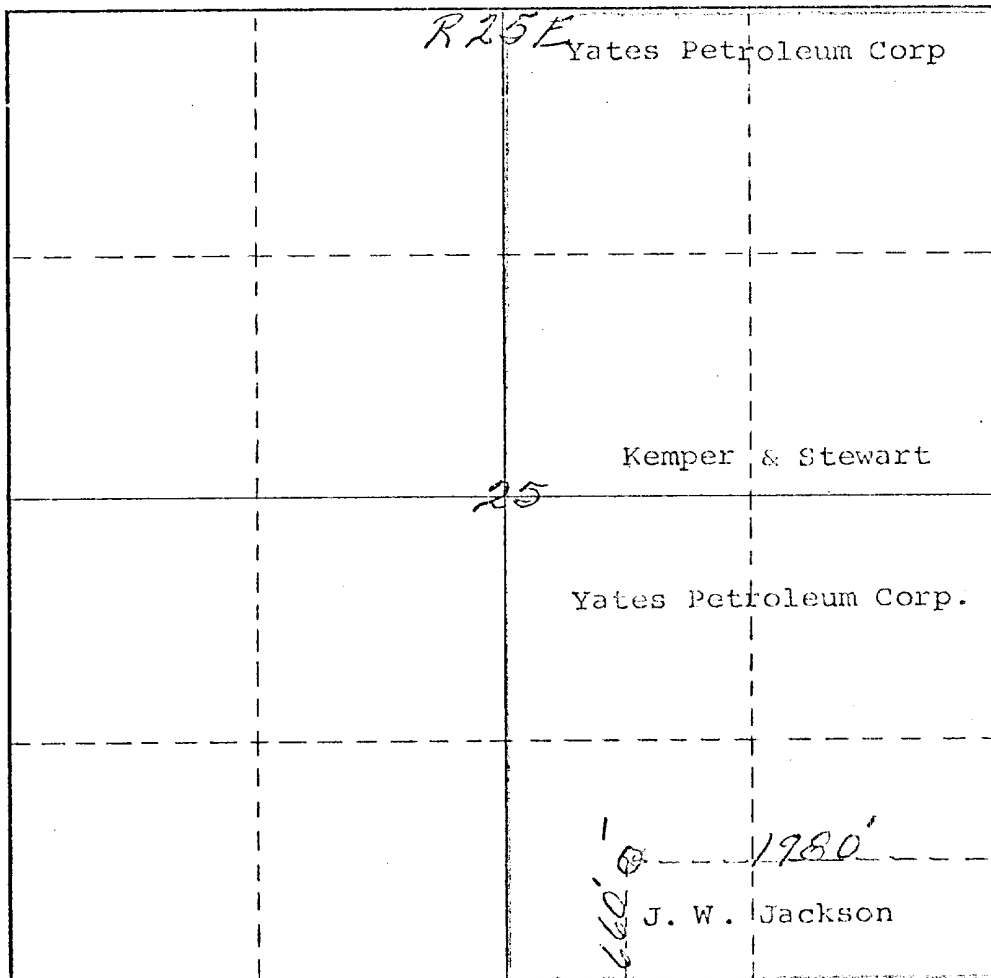

CERTIFICATION

I hereby certify that the information contained herein is true and complete to the best of my knowledge and belief.

Eddie M. Mahfood
Name
Eddie M. Mahfood
Position
Engineer
Company
Yates Pet. Corporation
Date
6-9-75

I hereby certify that the well location shown on this plat was plotted from field notes of actual surveys made by me or under my supervision, and that the same is true and correct to the best of my knowledge and belief.

James H. Brown
Date Surveyed
June 5th 1975
Registered Professional Engineer
and/or Land Surveyor
Certificate No.
542



DIAGRAMMA & SKETCH OF 3000 PSI BOP ASSEMBLY

ARD DRILLING COMPANY - Rig No. 4

RECEIVED

JUN 11 1975

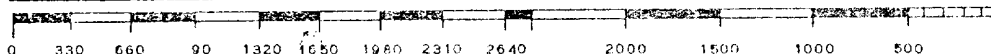
O. C. C.
ARTESIA, OFFICE

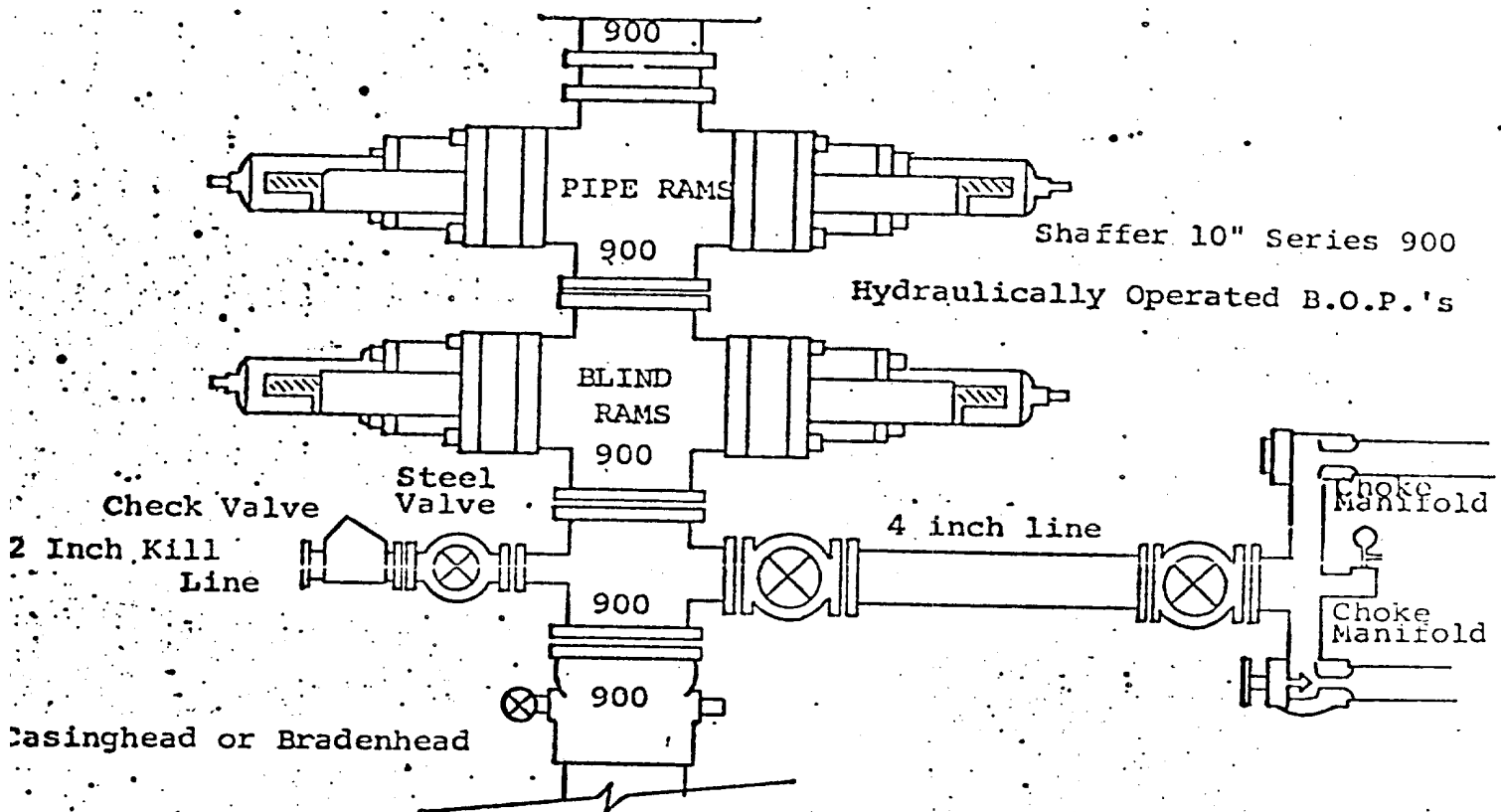

THE FOLLOWING CONSTITUTE MINIMUM BLOWOUT PREVENTER REQUIREMENTS

1. All preventers to be hydraulically operated with secondary manual controls installed prior to drilling out from under casing.
2. Choke outlet to be a minimum of 4" diameter.
3. Kill line to be of all steel construction of 2" minimum diameter...
4. All connections from operating manifolds to preventers to be all steel hole or tube a minimum of one inch in diameter.
5. The available closing pressure shall be at least 15% in excess of that required with sufficient volume to operate the B.O.P.'s.
6. All Connections to and from preventer to have a pressure rating equivalent to that of the B.O.P.'s.
7. Inside blowout preventer to be available on rig floor.
8. Operating controls located a safe distance from the rig floor.
9. Hole must be kept filled on trips below intermediate casing. Operator not responsible for blowouts resulting from not keeping hole full.
10. D.P. float must be installed and used below zone of first gas intrusion.

Yates Petroleum Corporation
Jackson "EM" Com No. 1
660' FSL & 1980' FEL of
Section 25-17S-25E,
Eddy County, New Mexico