

NO. OF COPIES RECEIVED	
DISTRIBUTION	
SANTA FE	
FILE	
U.S.G.S.	
LAND OFFICE	
OPERATOR	

NEW MEXICO OIL CONSERVATION COMMISSION
RECEIVED

SEP 12 1975

30-015-21627

Form C-101
Revised 1-1-65

5A. Indicate Type of Lease STATE <input type="checkbox"/> FEE <input checked="" type="checkbox"/>
5. State Oil & Gas Lease No.
7. Unit Agreement Name
8. Farm or Lease Name Gossett "EU"
9. Well No. 1
10. Field and Pool, or Wildcat Undesignated
12. County Eddy
19. Proposed Depth approx. 8550
19A. Formation Morrow
20. Rotary or C.T. Rotary
21. Elevations (Show whether DF, RT, etc.) 3498' GR
21A. Kind & Status Plug. Bond Blanket
21B. Drilling Contractor Ard Drilling Co.
22. Approx. Date Work will start As soon as approved

APPLICATION FOR PERMIT TO DRILL, DEEPEN, OR PLUG BACK

1a. Type of Work
b. Type of Well
OIL WELL ☐ GAS WELL ☒ OTHER ☐ DRILL ☒ DEEPEN ☐ PLUG BACK ☐
SINGLE ZONE ☐ MULTIPLE ZONE ☐

2. Name of Operator
Yates Petroleum Corporation

3. Address of Operator
207 South 4th Street - Artesia, NM 88210

4. Location of Well
UNIT LETTER K LOCATED 1980 FEET FROM THE West LINE
AND 1650 FEET FROM THE South LINE OF SEC. 26 TWP. 17S RGE. 25E NMPM

19. Proposed Depth
approx. 8550

19A. Formation
Morrow

20. Rotary or C.T.
Rotary

21. Elevations (Show whether DF, RT, etc.)
3498' GR

21A. Kind & Status Plug. Bond
Blanket

21B. Drilling Contractor
Ard Drilling Co.

22. Approx. Date Work will start
As soon as approved

PROPOSED CASING AND CEMENT PROGRAM

SIZE OF HOLE	SIZE OF CASING	WEIGHT PER FOOT	SETTING DEPTH	SACKS OF CEMENT	EST. TOP
17½"	12-3/4 or 13-3/8"	30 or 48#	Approx 340'	Circulate	
12¼ or 11"	8-5/8"	24#	" 1250'	Circulate	
7-7/8"	4½ or 5½"	9.5 or 11.6# or 15.5 or 17#	" 8550'	250 sx.	

It is our intention to drill a Morrow Test to approx 8550'. 13-3/8" or 12¼" casing will be set at approx 340' and cement circulated, to prevent caving, 8-5/8" intermediate casing will be set 100' below the Artesian water zone and cement circulated. If commercial production is encountered 4½ or 5½" production casing will be run and cemented.

Mud Program: - Gel & LCM 1250', FW to 5100', KCL to 6100', Flosal-Drispak to TD.

BOP Program: - BOP's will be installed on 8-5/8" casing, pipe rams tested daily and blind rams on trips.

APPROVAL VALID
FOR 90 DAYS UNLESS
DRILLING COMMENCED,

EXPIRES 12-15-75

IN ABOVE SPACE DESCRIBE PROPOSED PROGRAM: IF PROPOSAL IS TO DEEPEN OR PLUG BACK, GIVE DATA ON PRESENT PRODUCTIVE ZONE AND PROPOSED NEW PRODUCTIVE ZONE. GIVE BLOWOUT PREVENTER PROGRAM, IF ANY.

I hereby certify that the information above is true and complete to the best of my knowledge and belief.

Signed Eddie M. Huey Title Engineer Date 9-12-75

(This space for State Use)

APPROVED BY W.A. Gossett TITLE SUPERVISOR, DISTRICT II DATE SEP 15 1975

CONDITIONS OF APPROVAL, IF ANY:

Cement must be circulated to
surface behind 13 7/8" + 8 7/8" casing

Notify N.M.O.C.C. in sufficient
time to witness cementing
the 8 7/8" casing

NEW MEXICO OIL CONSERVATION COMMISSION
WELL LOCATION AND ACREAGE DEDICATION PLAT

Form O-15,
Supersedes O-12B
Effective 1-1-61

All dimensions must be from the outer boundaries of the Section

YATES PETROLEUM CORPORATION		Name GILBERT E. U.		Well No. 1
"K"	26	17 South	25 East	County Eddy
1650	South		1980	West
3497	MORROW	Unassigned	Dedicated Acreage: 320 Acres	

1. Outline the acreage dedicated to the subject well by colored pencil or hatchure marks on the plat below.
2. If more than one lease is dedicated to the well, outline each and identify the ownership thereof (both as to working interest and royalty)
3. If more than one lease of different ownership is dedicated to the well, have the interests of all owners been consolidated by communitization, unitization, force-pooling, etc?

☐ Yes ☐ No If answer is "yes," type of consolidation _____

If answer is "no," list the owners and tract descriptions which have actually been consolidated. (Use reverse side of this form if necessary.) _____

No allowable will be assigned to the well until all interests have been consolidated (by communitization, unitization, forced-pooling, or otherwise) or until a non-standard unit, eliminating such interests, has been approved by the Commission.

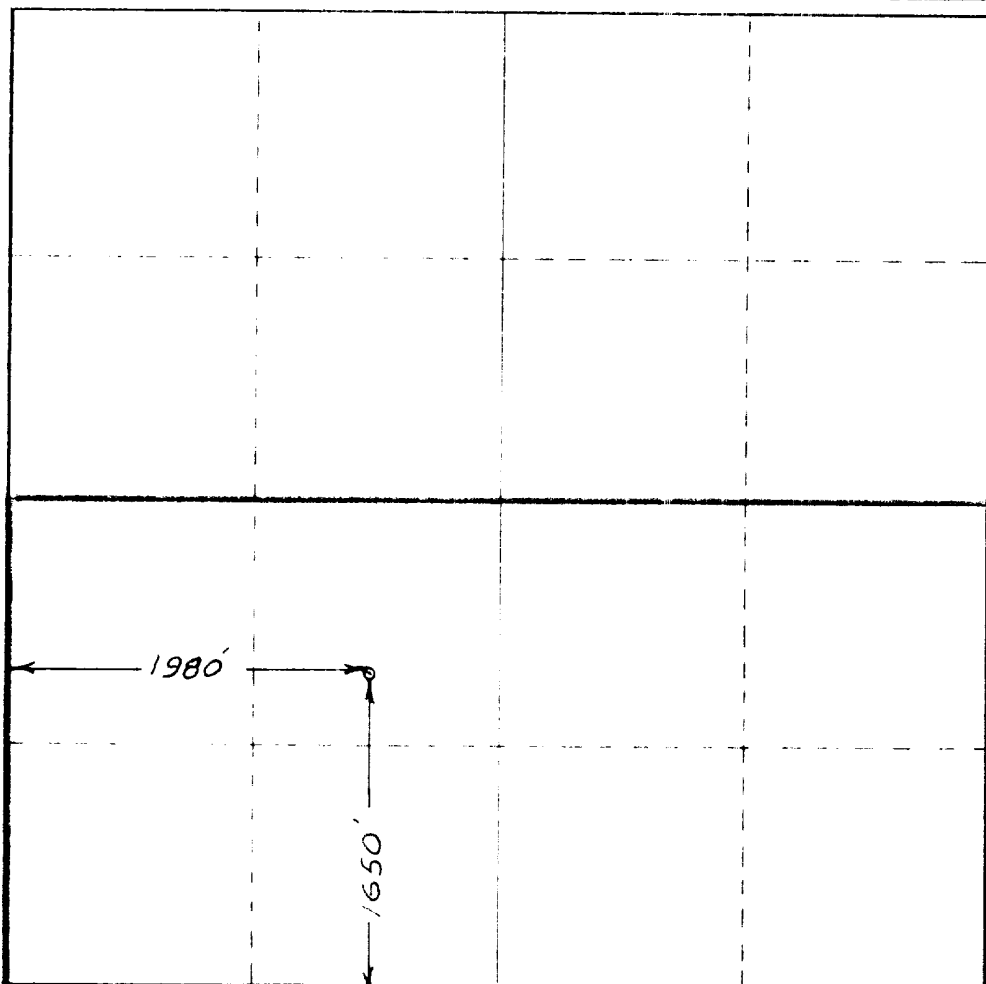

CERTIFICATION

I hereby certify that the information contained herein is true and complete to the best of my knowledge and belief.

Eddie M. Manrood

Name

Eddie M. Manrood

Position

Engineer

Company

Yates Petroleum Corp

Date

9-12-75

I hereby certify that the well location shown on this plat was plotted from field notes of actual surveys made by me or under my supervision, and that the same is true and correct to the best of my knowledge and belief.

Date Surveyed

September 9, 1975

Registered Professional Engineer and Land Surveyor

W. S. Jones

Certificate No.

3640

130 650 9 1320 1650 1980 2640 2900 3600 4200 4800 5400 6000

Yates Petroleum Corporation
Gossett "EU" No. 1
1980' SPWL & 1650' FSL of
Section 26-17S-25E
Eddy County, New Mexico

DIAGRAMMATIC SKETCH BOP ASSEMBLY

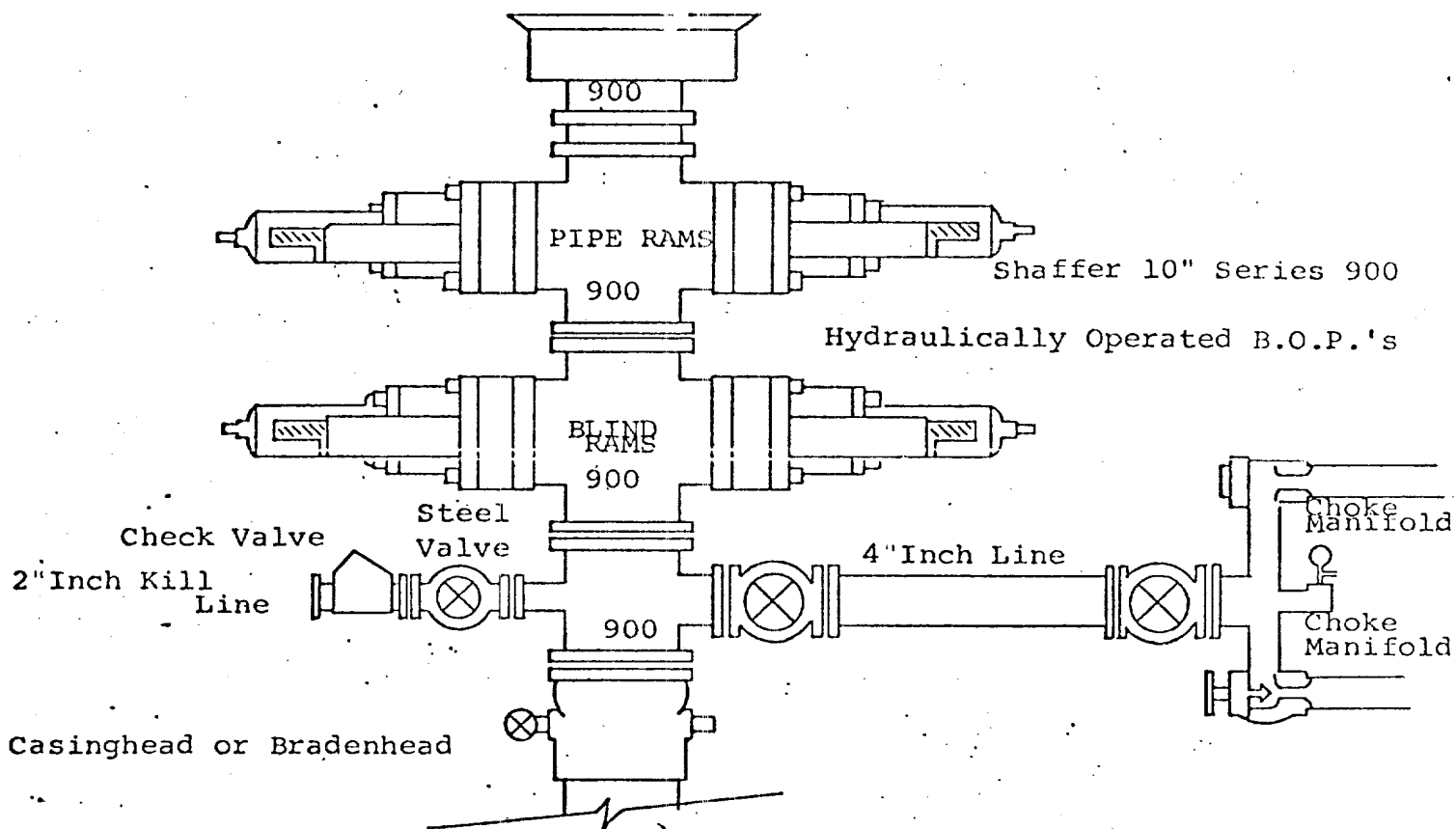

THE FOLLOWING CONSTITUTE MINIMUM BLOWOUT PREVENTER REQUIREMENTS

1. All preventers to be hydraulically operated with secondary manual controls installed prior to drilling out from under casing.
2. Choke outlet to be a minimum of 4" diameter.
3. Kill line to be of all steel construction of 2" minimum diameter.
4. All connections from operating manifolds to preventers to be all steel hole or tube a minimum of one inch in diameter.
5. The available closing pressure shall be at least 15% in excess of that required with sufficient volume to operate the B.O.P.'s.
6. All connections to and from preventer to have a pressure rating equivalent to that of the B.O.P.'s.
7. Inside blowout preventer to be available on rig floor.
8. Operating controls located a safe distance from the rig floor.
9. Hole must be kept filled on trips below intermediate casing. Operator not responsible for blowouts resulting from not keeping hole full.
10. D. P. float must be installed and used below zone of first gas intrusion.