

NO. OF COPIES RECEIVED	
DISTRIBUTION	
SANTA FE	
FILE	
U.S.G.S.	
LAND OFFICE	
OPERATOR	

NEW MEXICO OIL CONSERVATION COMMISSION

RECEIVED

SEP 15 1975

30-015-21630

Form C-101  
Revised 1-1-65

O. C. C.

ARTESIA OFFICE

## APPLICATION FOR PERMIT TO DRILL, DEEPEN, OR PLUG BACK

1a. Type of Work		7. Unit Agreement Name	
b. Type of Well DRILL <input checked="" type="checkbox"/> DEEPEN <input type="checkbox"/> PLUG BACK <input type="checkbox"/>		8. Farm or Lease Name	
OIL WELL <input checked="" type="checkbox"/> GAS WELL <input type="checkbox"/> OTHER Wildcat SINGLE ZONE <input type="checkbox"/> MULTIPLE ZONE <input type="checkbox"/>		Yates	
2. Name of Operator Read & Stevens, Inc.		9. Well No. 1	
3. Address of Operator P.O. Box 2126, Roswell, New Mexico 88201		10. Field and Pool, or Wildcat Wildcat	
4. Location of Well UNIT LETTER A LOCATED 660 FEET FROM THE North LINE AND 660 FEET FROM THE East LINE OF SEC. 11 TWP. 16-S RGE. 26-E NMPM		12. County Eddy	
19. Proposed Depth 8700'		19A. Formation Devonian	
20. Rotary or C.T. Rotary		21. Elevations (Show whether DF, RT, etc.) 3379' GR	
21A. Kind & Status Plug. Bond Statewide		21B. Drilling Contractor Hondo Drig. Co.	
22. Approx. Date Work will start September 18, 1975			

## PROPOSED CASING AND CEMENT PROGRAM

SIZE OF HOLE	SIZE OF CASING	WEIGHT PER FOOT	SETTING DEPTH	SACKS OF CEMENT	EST. TOP
17 1/2"	13 3/8" 12 3/4"	54# 34	350'	425	Circulated
// 12 1/4"	8 5/8"	24# 28"	1900' / 1400' to	500	Circulated

Drill 17 1/2" hole to 350' and run 13 3/8" casing as above w/cement circulated.  
 Drill 12 1/4" hole from 350' to 1900' and run 8 5/8" casing as above w/cement circulated.  
 Raise Vis. to 32-36 from 1200' to 1900' for good sample quality thru San Andres. Drill  
 7 7/8" hole from 1900' to 8700" using water and native mud from 1900' to 5200'. From  
 5200' to 7250', mud wt. 8.4#-8.6#, Vis. 36, WL no control. From 7250' to 8700', Mud wt.  
 8.4#-8.6#, Vis. 36, WL 10-20. DST all significant shows. Run production casing if  
 production indicated. Blowout preventor stack and casing head will be pressure tested with  
 test plug to 2000 PSI at 5200'. Daily check of blowout preventor system will be made from  
 5200' to TD. Contractor will furnish detail of blowout preventor system direct to OCC.

APPROVAL VALID  
FOR 90 DAYS UNLESS  
DRILLING COMMENCED,

EXPIRES 12-16-75

IN ABOVE SPACE DESCRIBE PROPOSED PROGRAM: IF PROPOSAL IS TO DEEPEN OR PLUG BACK, GIVE DATA ON PRESENT PRODUCTIVE ZONE AND PROPOSED NEW PRODUCTIVE ZONE. GIVE BLOWOUT PREVENTER PROGRAM, IF ANY.

I hereby certify that the information above is true and complete to the best of my knowledge and belief.

Signed John L. Anderson Jr. Title Agent

Date 9-12-75

(This space for State Use)

APPROVED BY W. A. Gressett

TITLE SUPERVISOR, DISTRICT II

SEP 16 1975

Notify N.M.O.C.C. in sufficient  
time to witness cementing

CONDITIONS OF APPROVAL, IF ANY:  
Minimum WOC time 18 hrs.

Cement must be circulated to  
surface behind 12 3/4" x 8 7/8" casing

NE EXICO OIL CONSERVATION COMMISSION  
WELL LOCATION AND ACREAGE DEDICATION PLAT

Form C-102  
Supersedes C-128  
Effective 1-1-65

All distances must be from the outer boundaries of the Section

Operator <b>Read &amp; Stevens, Inc.</b>		Lease <b>Yates</b>		Well No. <b>1</b>	
Unit Letter <b>A</b>	Section <b>11</b>	Township <b>16 South</b>	Range <b>26 East</b>	County <b>Eddy</b>	
Actual Well Location of Well:					
<b>660</b>		feet from the	<b>North</b>	line and	<b>660</b>
				feet from the	<b>East</b>
Ground Level Elev. <b>3379</b>	Producing Formation <b>Devonian</b>		Pool <b>Wildcat</b>		Dedicated Acreage: <b>40.00</b> Acres

1. Outline the acreage dedicated to the subject well by colored pencil or hatchure marks on the plat below.
2. If more than one lease is dedicated to the well, outline each and identify the ownership thereof (both as to working interest and royalty).
3. If more than one lease of different ownership is dedicated to the well, have the interests of all owners been consolidated by communitization, unitization, force-pooling, etc?

☐ Yes ☐ No If answer is "yes," type of consolidation \_\_\_\_\_

If answer is "no," list the owners and tract descriptions which have actually been consolidated. (Use reverse side of this form if necessary.) \_\_\_\_\_

No allowable will be assigned to the well until all interests have been consolidated (by communitization, unitization, forced-pooling, or otherwise) or until a non-standard unit, eliminating such interests, has been approved by the Commission.

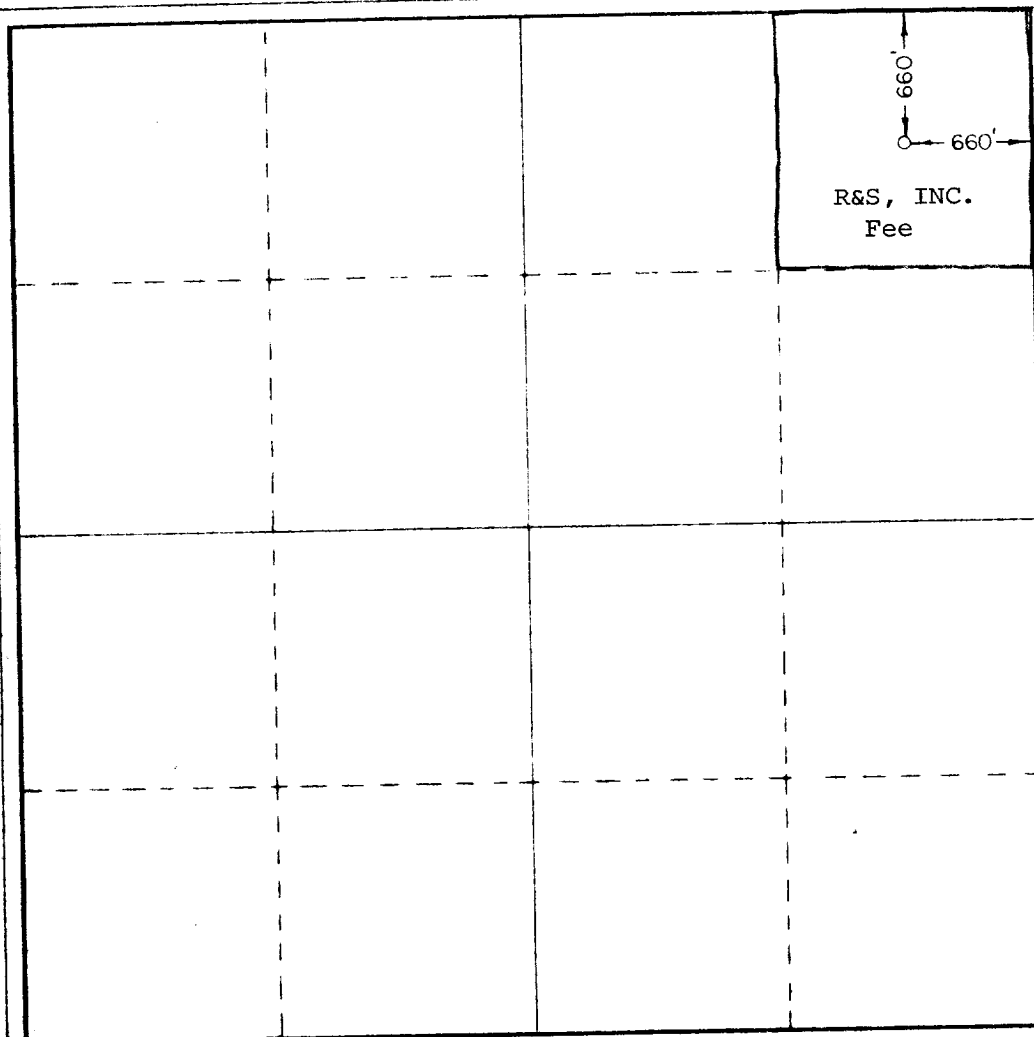

CERTIFICATION

I hereby certify that the information contained herein is true and complete to the best of my knowledge and belief.

*John L. Anderson, Jr.*  
Name

John L. Anderson, Jr.

Position

Agent

Company

Read & Stevens, Inc.

Date

September 12, 1975

I hereby certify that the well location shown on this plat was plotted from field notes of actual surveys made by me or under my supervision, and that the same is true and correct to the best of my knowledge and belief.

Date Surveyed

September 9, 1975

Registered Professional Engineer and Land Surveyor

676

Certificate No.

JOHN W. WEST

0 330 660 990 1320 1650 1980 2310 2640 2000 1500 1000 500

110.000 117 3

11.11.11

2.5

11" 900

11" 900

10" 900

11" 900

11" 900

11" 900

11" 900

11" 900

11" 900

11" 900

11" 900

11" 900

11" 900

11" 900

11" 900

11" 900

11" 900

11" 900

11" 900

11" 900

11" 900

11" 900

11" 900

11" 900

11" 900

11" 900

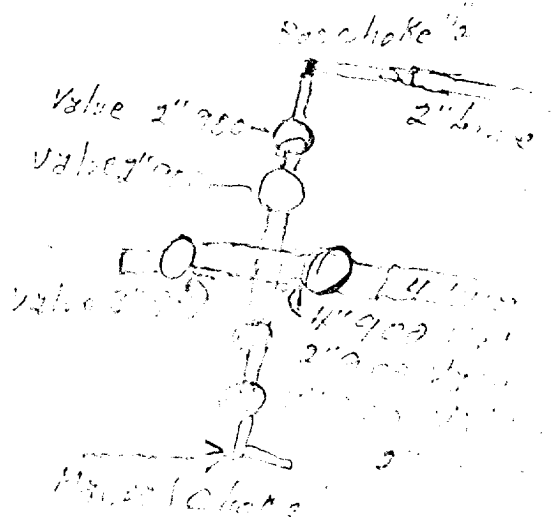

All Valves 8-11-72

Sec 11 16-5-76 E

660 N 46.0 E

Valves #1

CB, Read OPer

11.11.11

11.11.11

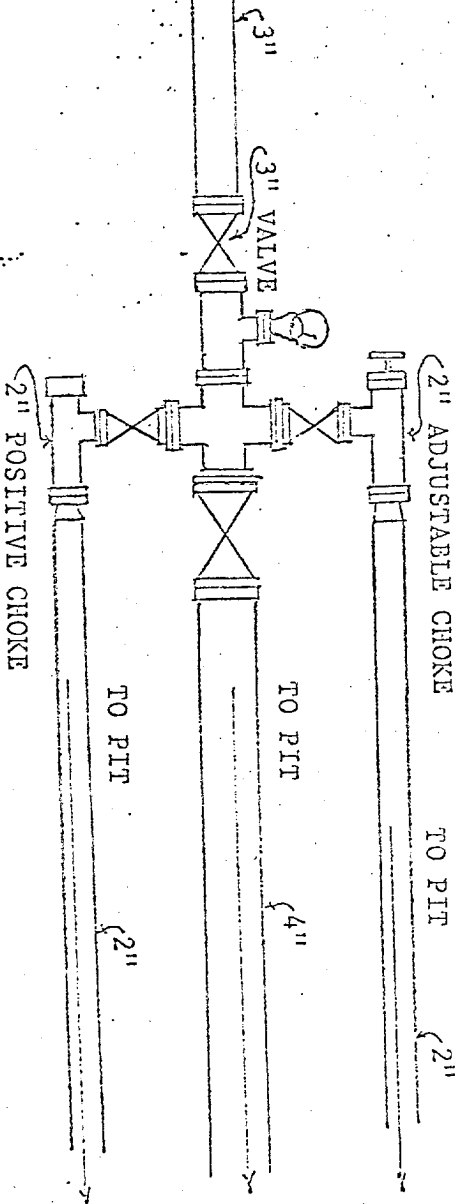
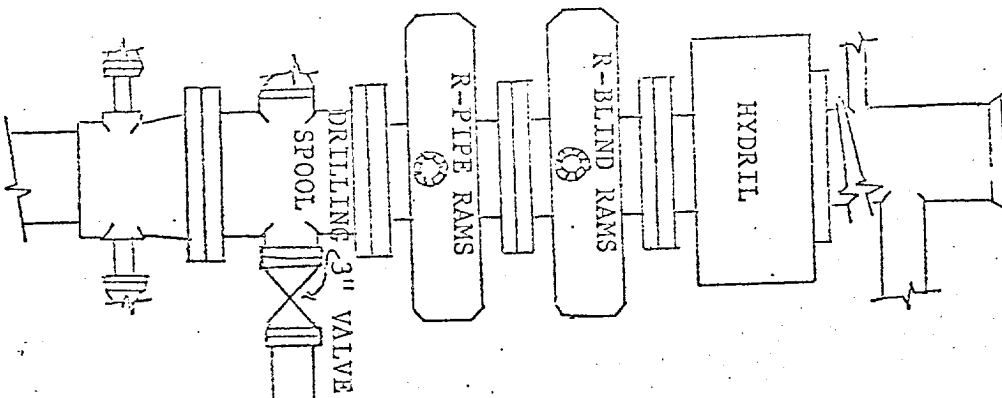

BLOW OUT PREVENTION EQUIPMENT  
 10" 900s ALL FLANGED CONNECTIONS  
 3,000# WORKING PRESSURE - 6,000# TEST

HONDO DRILLING COMPANY  
 RIG #3

BILL GRESSET

9-15-75

Csg. changed as per call  
from Mr. Reed

4:30 PM,

They want to drill to 1900  
run logs + if SA zone  
looks good go ahead +  
set csg - to 1900 if not  
set it @ bottom of water -

9-16-75 10:00 AM.

Mr. Reed called back they  
~~decided~~ decided to set 8 5/8".

just through water zone @ around  
1400 + or - - 8 5/8" 28" H-40

OK