

30-015-21822

Form C-101
Revised 1-1-65

NEW MEXICO OIL CONSERVATION COMMISSION

RECEIVED

U MAY 27 1976

O. C. C.

ARTESIAL OFFICE

APPLICATION FOR PERMIT TO DRILL, DEEPEN, OR PLUG BACK

NO. OF COPIES RECEIVED	
DISTRIBUTION	
SANTA FE	
FILE	
U.S.G.S.	
LAND OFFICE	
OPERATOR	

5A. Indicate Type of Lease
STATE <input checked="" type="checkbox"/> FEE <input type="checkbox"/>
5. State Oil & Gas Lease No.
647

1a. Type of Work
DRILL <input checked="" type="checkbox"/> DEEPEN <input type="checkbox"/> PLUG BACK <input type="checkbox"/>
b. Type of Well
OIL WELL <input checked="" type="checkbox"/> GAS WELL <input type="checkbox"/> OTHER <input type="checkbox"/>

7. Unit Agreement Name
Empire Abo Pressure Maintenance Project
8. Farm or Lease Name
Empire Abo Unit "E"

2. Name of Operator
Atlantic Richfield Company

9. Well No.
382

3. Address of Operator
P. O. Box 1710, Hobbs, New Mexico 88240

10. Field and Pool, or Wildcat
Empire Abo

4. Location of Well
UNIT LETTER C LOCATED 1316 FEET FROM THE West LINE
AND 1175 FEET FROM THE North LINE OF SEC. 35 TWP. 17S RGE. 28E NMPM

12. County
Eddy

18. Proposed Depth	19A. Formation	20. Rotary or C.T.
6400'	Abo	Rotary
21. Elevations (Show whether DF, RT, etc.)	21A. Kind & Status Plug. Bond	21B. Drilling Contractor
3684.3' GR	GCA #8	Hondo Drlg Company
		22. Approx. Date Work will start
		7/12/76

23. PROPOSED CASING AND CEMENT PROGRAM

SIZE OF HOLE	SIZE OF CASING	WEIGHT PER FOOT	SETTING DEPTH	SACKS OF CEMENT	EST. TOP
11"	8 1/2" OD	24# K-55	750'	475	Circ to surf.
7-7/8"	5 1/2" OD	14# K-55	6400'	1200	Circ to surf.

Propose to drill a producing oilwell in the Empire Abo Unit to complete a more efficient producing pattern, to conserve energy, promote the greatest ultimate recovery of Unit reserves, prevent waste and protect correlative rights. Proposed non-standard well location to meet all requirements of Order No. R-4549-B, Rule 14, NSL 743.

APPROVAL VALID
FOR 90 DAYS UNLESS
DRILLING COMMENCED,
EXPIRES 8-28-76

IN ABOVE SPACE DESCRIBE PROPOSED PROGRAM: IF PROPOSAL IS TO DEEPEN OR PLUG BACK, GIVE DATA ON PRESENT PRODUCTIVE ZONE AND PROPOSED NEW PRODUCTION ZONE. GIVE BLOWOUT PREVENTER PROGRAM, IF ANY.

I hereby certify that the information above is true and complete to the best of my knowledge and belief.

(This space for State Use)

APPROVED BY W. A. Gressett TITLE SUPERVISOR, DISTRICT II DATE MAY 28 1976

CONDITIONS OF APPROVAL, IF ANY:

N MEXICO OIL CONSERVATION COMMISS
WELL LOCATION AND ACREAGE DEDICATION PLAT

Form C-102
 Supersedes C-128
 Effective 1-1-65

All distances must be from the outer boundaries of the Section

Operator Atlantic Richfield Company			Lease Empire Abo Unit E		Well No. 382
Unit Letter C	Section 35	Township 17 South	Range 28 East	County Eddy	
Actual Footage Location of Well: 1316 feet from the West line and 1175 feet from the North line					
Ground Level Elev. 3684.3	Producing Formation Abo Reef		Pool Empire Abo		Estimated Acreage 40 Acres

1. Outline the acreage dedicated to the subject well by colored pencil or hatchure marks on the plat below.
2. If more than one lease is dedicated to the well, outline each and identify the ownership thereof (both as to working interest and royalty).
3. If more than one lease of different ownership is dedicated to the well, have the interests of all owners been consolidated by communitization, unitization, force-pooling, etc?

☒ Yes ☐ No If answer is "yes," type of consolidation **Unitization**

If answer is "no," list the owners and tract descriptions which have actually been consolidated. Use reverse side of this form if necessary.) _____

No allowable will be assigned to the well until all interests have been consolidated (by communitization, unitization, forced-pooling, or otherwise) or until a non-standard unit, eliminating such interests, has been approved by the Commission.

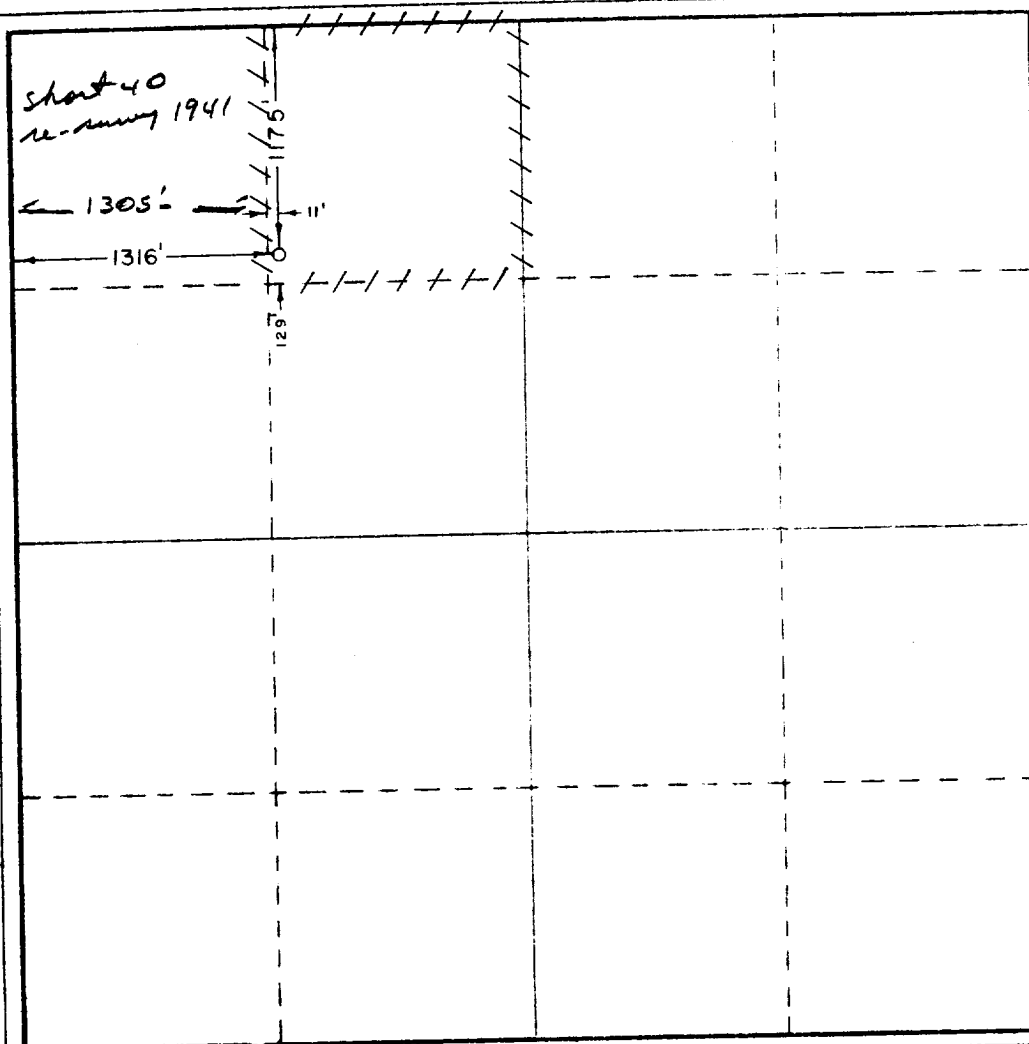

CERTIFICATION

I hereby certify that the information contained herein is true and complete to the best of my knowledge and belief.

Name _____
 Position _____
 Title **Dist. Dirg. Supv.**
 Company **Atlantic Richfield Company**
 Date **5/24/76**

I hereby certify that the well location shown on this plat was plotted from field notes of actual surveys made by me or under my supervision, and that the same is true and correct to the best of my knowledge and belief.

Date of Survey **November 18, 1975**
 Registered Professional Engineer and Land Surveyor
 Certificate No. **676**

0 330 660 990 1320 1650 1980 2310 2640 2970 3300 3630 3960 4290 4620 4950 5280 5610 5940 6270 6600 6930 7260 7590 7920 8250 8580 8910 9240 9570 9900

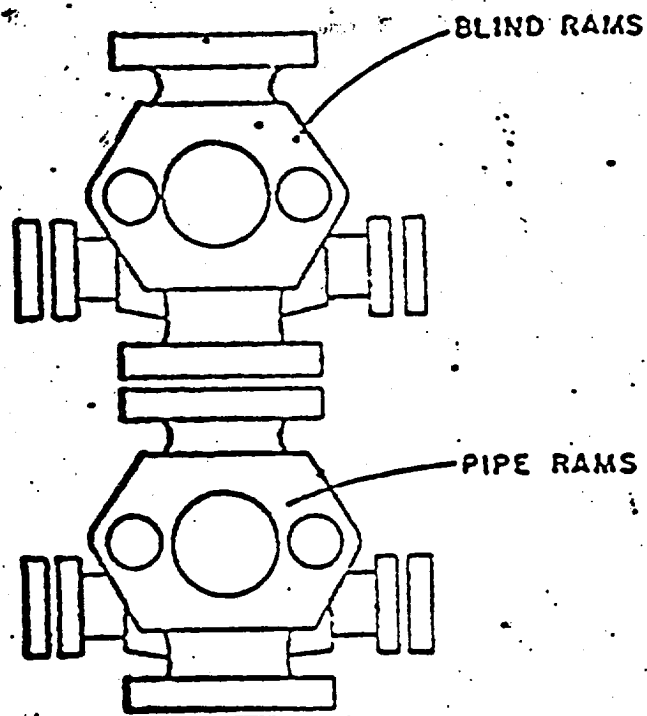

ATLANTIC RICHFIELD COMPANY
Blow Out Preventer Program

Lease Name Empire Abo Unit "a" E

Well No. 321 382

Location 1125N-1316W 35-17-28

BOP to be tested before installed on well and will be maintained in good working condition during workover. All wellhead fittings to be of sufficient pressure to operate in a safe manner.