

NO. OF COPIES RECEIVED	6
DISTRIBUTION	
SANTA FE	1
FILE	1
U.S.G.S.	2
LAND OFFICE	1
OPERATOR	1

RECEIVED
NEW MEXICO OIL CONSERVATION COMMISSION

JUL 30 1976

O. C. C.
ARTESIA, OFFICE

30-015-21879
Form C-101
Revised 1-1-65

5A. Indicate Type of Lease STATE <input checked="" type="checkbox"/> FEE <input type="checkbox"/>
5. State Oil & Gas Lease No. B-2071

APPLICATION FOR PERMIT TO DRILL, DEEPEN, OR PLUG BACK

1a. Type of Work DRILL <input checked="" type="checkbox"/> DEEPEN <input type="checkbox"/> PLUG BACK <input type="checkbox"/>		7. Unit Agreement Name
b. Type of Well OIL WELL <input checked="" type="checkbox"/> GAS WELL <input type="checkbox"/> OTHER <input type="checkbox"/> SINGLE ZONE <input type="checkbox"/> MULTIPLE ZONE <input type="checkbox"/>		8. Farm or Lease Name N G Phillips State
2. Name of Operator Marbob Energy Corporation		9. Well No. 21
3. Address of Operator P. O. Box 304, Artesia, N. M. 88210		10. Field and Pool, or Wildcat <u>Artesia</u>
4. Location of Well UNIT LETTER <u>J</u> LOCATED <u>2286.6</u> FEET FROM THE <u>East</u> LINE AND <u>1630.4</u> FEET FROM THE <u>South</u> LINE OF SEC. <u>27</u> TWP. <u>17 S</u> RGE. <u>28 E</u> NMRM		12. County Eddy
19. Proposed Depth 2100		19A. Formation Premier
20. Rotary or C.T. C T		
21. Elevation (Show whether D.F., K.L., etc.) 3663 GR	21A. Kind & Status Plug Bond Statewide active	21B. Drilling Contractor Burrows Drlg. Co.
22. Approx. Date Work will start 8-3-76		

PROPOSED CASING AND CEMENT PROGRAM

SIZE OF HOLE	SIZE OF CASING	WEIGHT PER FOOT	SETTING DEPTH	SACKS OF CEMENT	EST. TOP
10"	8 5/8"	20#	500'	110	surface
8 "	4 1/2"	10#	2100'	375	surface

We propose to drill to approximately 500' and run 8 5/8" drilling string of casing, cement with 110 sx cement, drill on to test Premier at approximately 2,100' and set 4 1/2" production string with 375 sx cement and complete well in Premier formation. We do not anticipate gas at these depths and will not set up a blowout preventer program at this time.

APPROVAL VALID
FOR 90 DAYS UNLESS
DRILLING COMMENCED,
EXPIRES 11-2-76

IN ABOVE SPACE DESCRIBE PROPOSED PROGRAM; IF PROPOSAL IS TO DEEPEN OR PLUG BACK, GIVE DATA ON PRESENT PRODUCTIVE ZONE AND PROPOSED NEW PRODUCTIVE ZONE, GIVE BLOWOUT PREVENTER PROGRAM, IF ANY.

I hereby certify that the information above is true and complete to the best of my knowledge and belief.

Signed Donathy Hammond Title Agent Date 7/30/76
(This space for State Use)

APPROVED BY W. A. Grossett TITLE SUPERVISOR, DISTRICT II DATE AUG 2 1976
CONDITIONS OF APPROVAL, IF ANY:

**NEW MEXICO OIL CONSERVATION COMMISSION
WELL LOCATION AND ACREAGE DEDICATION PLAT**

Form C-102
Supersedes C-128
Effective 1-1-65

All distances must be from the outer boundaries of the Section

Operator MARBOB ENERGY CORPORATION			Lease N. G. PHILLIPS STATE		Well No. 21
Unit Letter J	Section 27	Township 17 South	Range 28 East	County EDDY	
Actual Footage Location of Well: 1630.4 feet from the South line and 2286.6 feet from the East line					
Ground Level Elev. 3663	Producing Formation Premier		Permit Artesia that does not require a permit	Dedicated Acreage 40 Acres	

1. Outline the acreage dedicated to the subject well by colored pencil or hatchure marks on the plat below.
2. If more than one lease is dedicated to the well, outline each and identify the ownership thereof (both as to working interest and royalty).
3. If more than one lease of different ownership is dedicated to the well, have the interests of all owners been consolidated by communitization, unitization, force-pooling, etc?

☐ Yes ☐ No If answer is "yes," type of consolidation _____

If answer is "no," list the owners and tract descriptions which have actually been consolidated (Use reverse side of this form if necessary.) _____

No allowable will be assigned to the well until all interests have been consolidated (by communitization, unitization, forced-pooling, or otherwise) or until a non-standard unit, eliminating such interests, has been approved by the Commission.

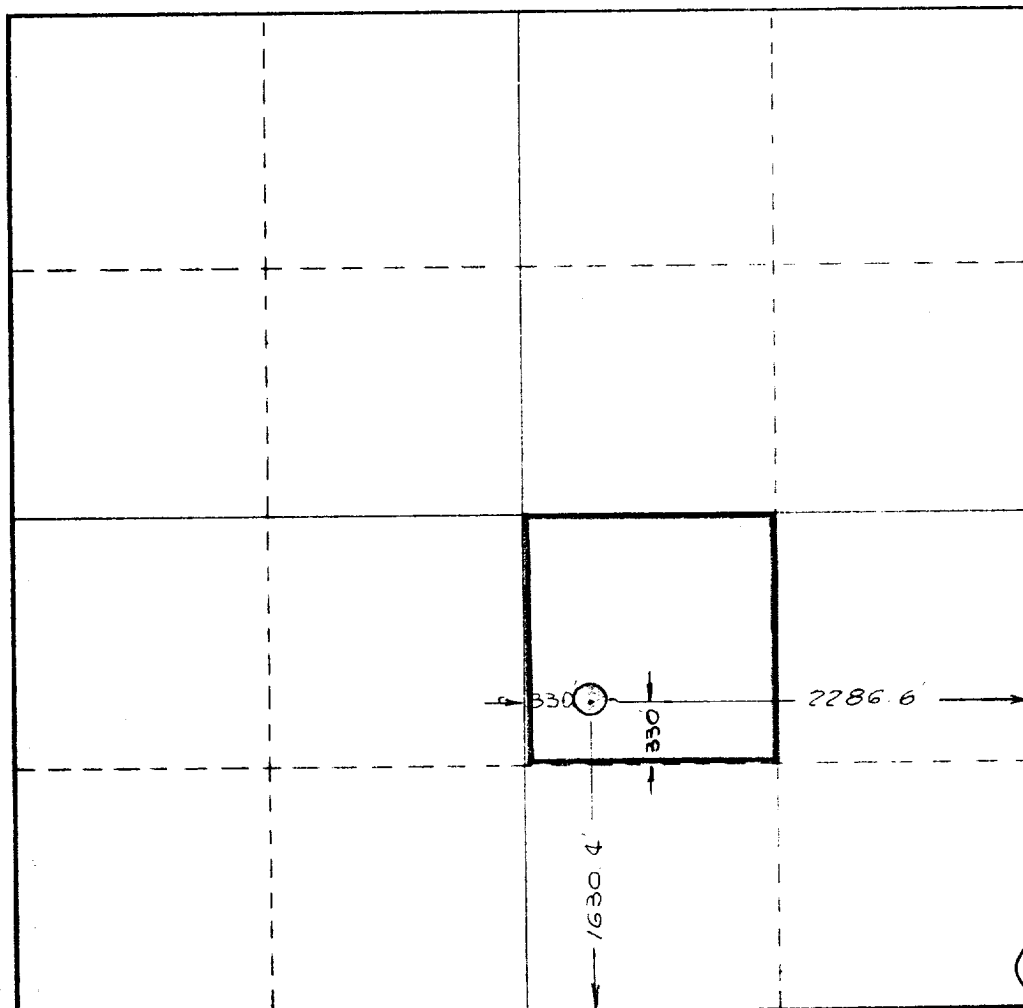

CERTIFICATION

I hereby certify that the information contained herein is true and complete to the best of my knowledge and belief.

Name *Dorothy Hammond*
Position **Agent**

Company **Marbob Energy Corp.**

Date **July 30, 1976**

I hereby certify that the well location shown on this plat was plotted from field notes of actual surveys made by me or under my supervision, and that the same is true and correct to the best of my knowledge and belief.

Date Surveyed **July 22 & 23, 1976**

Registered Professional Engineer and/or Land Surveyor

John W. Shearn

Certificate No. **1559**

