

30-015-21890

STATE OF NEW MEXICO
ENERGY AND MINERALS DEPARTMENT

OIL CONSERVATION DIVISION

Form C-101
Revised 10-1-78

P. O. BOX 2088
SANTA FE, NEW MEXICO 87501

JUL 07 1983

O. C. D.
ARTESIA, OFFICE

NO. OF COPIES RECEIVED	
DISTRIBUTION	
SANTA FE	
FILE	
U.S.G.S.	
LAND OFFICE	
OPERATOR	

5A. Indicate Type of Lease
STATE ☐ FEDERAL ☒
5. State Oil & Gas Lease No.

APPLICATION FOR PERMIT TO DRILL, DEEPEN, OR PLUG BACK

1a. Type of Work
DRILL ☐ DEEPEN ☐ PLUG BACK ☐
b. Type of Well
OIL WELL ☒ GAS WELL ☐ OTHER ☐ Re-entry ☐ SINGLE ZONE ☐ MULTIPLE ZONE ☐
2. Name of Operator
AH-VAL Associates ✓
3. Address of Operator
Rt. 1 Box 274, Artesia, New Mexico 88210
4. Location of Well
UNIT LETTER B M LOCATED 380 FEET FROM THE South LINE
AND 330 FEET FROM THE West LINE OF SEC. 12 TWP. 17 RGE. 25 NMPM
19. Proposed Depth 1500
19A. Formation Sandstone
20. Rotary or C.T.
21A. Kind & Status Plug. Bond Low Well Bond
21B. Drilling Contractor
22. Approx. Date Work will start
as soon as possible

7. Unit Agreement Name
8. Farm or Lease Name
Norris F.K.
9. Well No.
2
10. Field and Pool, or Wildcat
Eagle Creek Sa.
12. County
Eddy

23. PROPOSED CASING AND CEMENT PROGRAM

SIZE OF HOLE	SIZE OF CASING	WEIGHT PER FOOT	SETTING DEPTH	SACKS OF CEMENT	EST. TOP
15	10 3/4"	32 #	330	200	
9 7/8	7"	23 #	1237	675	
6 1/4	4 1/2 & 5 1/2	9.5# & 14#	1506	150	

Re-entry, are going to drill out the 35 sacks of cement and the plug, and place the well into production. The well has already been acidized and fractured.

Will be producing from the original zone that was perforated and fractured.

APPROVAL 180 DAYS
PERMIT EXPIRES 1-7-84
UNLESS DRILLING UNDERWAY

Perforated & Re-entry
7-15-83
Perforated & Re-entry
7-15-83

IN ABOVE SPACE DESCRIBE PROPOSED PROGRAM: IF PROPOSAL IS TO DEEPEN OR PLUG BACK, GIVE DATA ON PRESENT PRODUCTIVE ZONE AND PROPOSED NEW PRODUCTIVE ZONE. GIVE BLOWOUT PREVENTER PROGRAM, IF ANY.

I hereby certify that the information above is true and complete to the best of my knowledge and belief.

Signed William H. Livingston Title Director Date 6-24-83

APPROVED BY Mike Walker TITLE JUL 07 1983 DATE OIL AND GAS INSPECTOR

NEW MEXICO OIL CONSERVATION COMMISSION
WELL LOCATION AND ACREAGE DEDICATION PLAT

Form C-102
Supersedes C-128
Effective 1-1-65

All distances must be from the outer boundaries of the Section.

Operator <u>AW-VAL</u> <u>Vates Petroleum Corporation</u>		Lease <u>"NORRIS FK"</u>		Well No. <u>2</u>	
Unit Letter <u>M</u>	Section <u>12</u>	Township <u>17 South</u>	Range <u>25 East</u>	County <u>Eddy</u>	
Actual Postage Location of Well: <u>380</u> feet from the <u>South</u> line and <u>330</u> feet from the <u>West</u> line					
Ground Level Elev. <u>3475</u>	Producing Formation <u>San Andres</u>	Pool <u>Eagle Creek (S.A.)</u>	Dedicated Acreage: <u>4/0</u> Acres		

1. Outline the acreage dedicated to the subject well by colored pencil or hachure marks on the plat below.
2. If more than one lease is dedicated to the well, outline each and identify the ownership thereof (both as to working interest and royalty).
3. If more than one lease of different ownership is dedicated to the well, have the interests of all owners been consolidated by communitization, unitization, force-pooling, etc?

☐ Yes ☐ No If answer is "yes," type of consolidation _____

If answer is "no," list the owners and tract descriptions which have actually been consolidated. (Use reverse side of this form if necessary.) _____

No allowable will be assigned to the well until all interests have been consolidated (by communitization, unitization, forced-pooling, or otherwise) or until a non-standard unit, eliminating such interests, has been approved by the Commission.

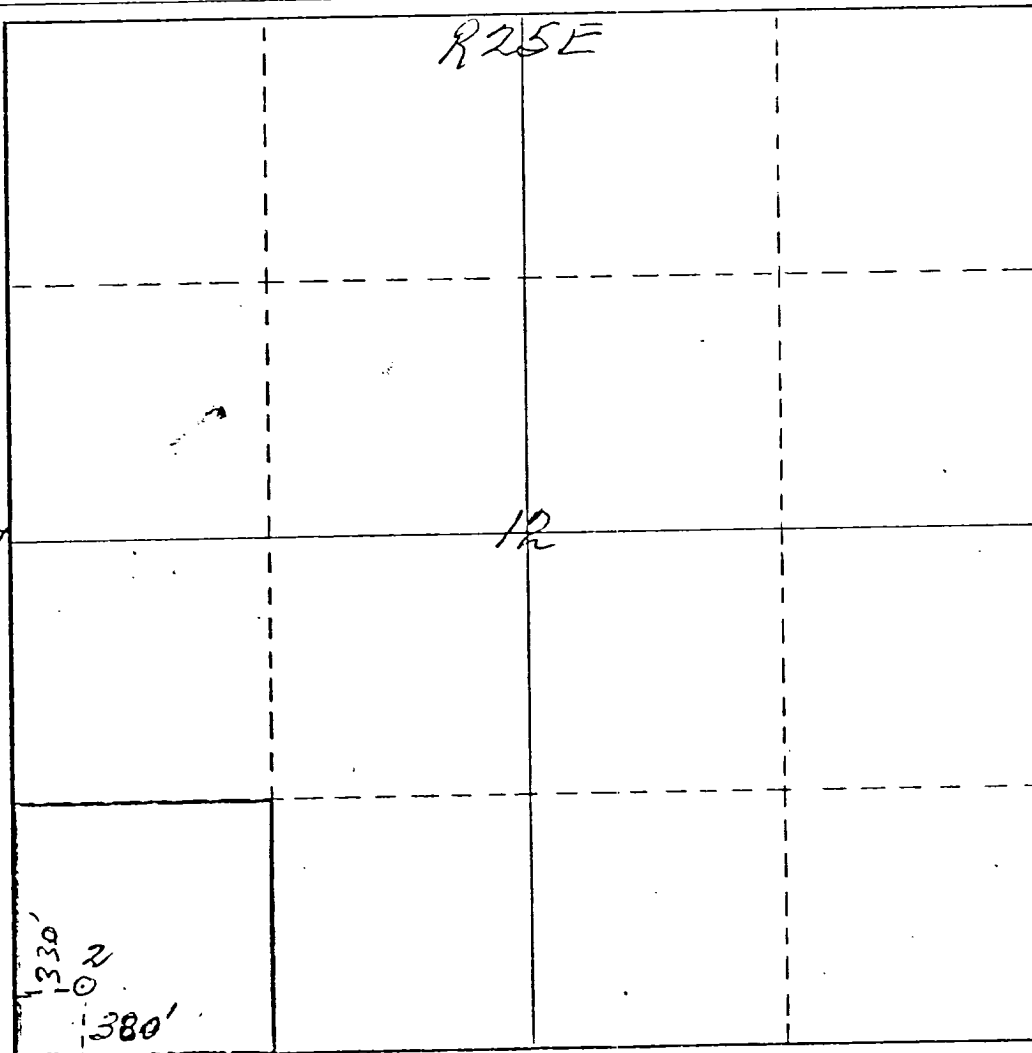

CERTIFICATION

I hereby certify that the information contained herein is true and complete to the best of my knowledge and belief.

Eddie M. Mahfood

Name

Eddie M. Mahfood

Position

Engineer

Company

Vates Pet. Corporation

Date

8-9-76

I hereby certify that the well location shown on this plat was plotted from field notes of actual surveys made by me or under my supervision, and that the same is true and correct to the best of my knowledge and belief.

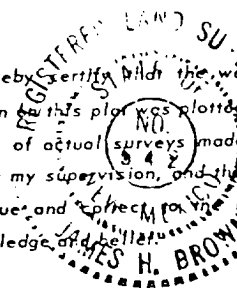

Date Surveyed

August 5th 1976

Registered Professional Engineer and/or Land Surveyor

James H. Brown

Certificate No.

542