

NO. OF COPIES RECEIVED	5
DISTRIBUTION	
SANTA FE	1
FILE	1
U.S.G.S.	2
LAND OFFICE	
OPERATOR	1

NEW MEXICO OIL CONSERVATION COMMISSION

RECEIVED

OCT 8 1976

O.C.C.

30-015-21953

Form C-101
Revised 1-1-65

5A. Indicate Type of Lease	
STATE <input type="checkbox"/>	FEE <input checked="" type="checkbox"/>
5. State Oil & Gas Lease No.	
7. Unit Agreement Name	
8. Farm or Lease Name	
Tom Brown "GO" Com	
9. Well No.	
1	
10. Field and Loc., or Wellers Und.	
Kennedy Farms Morrow	
12. County	
Eddy	
11. Estimated Depth	11A. Formation
Approx 8900'	Morrow
2. Rotary or C.T.	
Rotary	
21. Elevations (show whether DT, RT, etc.)	21A. Kind of Surface (Top, Bottom)
3339' GR	Blanket
21B. Drilling Contractor	22. Approx. Date Work will start
Ard Drilling Co.	As soon as approved

APPLICATION FOR PERMIT TO DRILL, DEEPEN, OR PLUG BACK

1a. Type of Work	
b. Type of Well	
DRILL <input checked="" type="checkbox"/>	DEEPEN <input type="checkbox"/>
PLUG BACK <input type="checkbox"/>	
OIL WELL <input type="checkbox"/>	GAS WELL <input checked="" type="checkbox"/>
OTHER <input type="checkbox"/>	
2. Name of Operator	
Yates Petroleum Corporation	
3. Address of Operator	
207 South 4th Street - Artesia, NM 88210	
4. Location of Well	
UNIT LETTER C	LOCATED 835'
FEET FROM THE North LINE	
AND 1980	FEET FROM THE West LINE OF SEC. 22
TWP. 17S R. 26E	
21. Elevation (show whether DT, RT, etc.)	
3339' GR	
21A. Kind of Surface (Top, Bottom)	
Blanket	
21B. Drilling Contractor	
Ard Drilling Co.	
22. Approx. Date Work will start	
As soon as approved	

PROPOSED CASING AND CEMENT PROGRAM

SIZE OF HOLE	SIZE OF CASING	WEIGHT PER FOOT	SETTING DEPTH	SACKS OF CEMENT	EST. TOP
17½"	13-3/8"	48#	Approx 400'	Circulate	
12½"	8-5/8"	24#	" 1400'	Circulate	
7-7/8"	4½ or 5½"	10.5-11.6#	" 8900'	250	

or 17-15.5#

Unorthodox location approval pending - Case #5771 9-29-76.

Propose to drill to approx. 8900' and test the Morrow and intermediate formations. Approx 400' of surface casing will be run and cemented to shut off gravel & cavings, intermediate casing will be run to 100' below the Artesian zone and cemented to the surface. If production is encountered 4½ or 5½" production casing will be run and cemented.

Mud Program: - FW gel and LCM from surface to 1400' (dry drill if unable to circulate); fresh wtr to 5300'; 2% KCL wtr to 7900' and Flosal-Drispak to TD.

BOP Program: - BOP's and hydril will be installed on intermediate casing, pipe rams & hydril tested daily for operational, blind rams on TD's.

APPROVAL VALID
FOR 90 DAYS UNLESS
DRILLING COMMENCED,

Gas acreage not dedicated

NSL order R-5303 10-27-76

IN ABOVE SPACE DESCRIBE PROPOSED PROGRAM IF PROPOSAL IS TO DEEPEN OR PLUG BACK, GIVE DATA ON PRESENT PRODUCTIVE ZONE AND PROPOSED NEW PRODUCTIVE ZONE, GIVE BLOWOUT PREVENTER PROGRAM, IF ANY.

I hereby certify that the information above is true and complete to the best of my knowledge and belief.

Signed Eddie H. Matlock Title Engineer Date 10-8-76

(This space for State Use)

APPROVED BY W. A. Gressett TITLE SUPERVISOR, DISTRICT II DATE NOV 1 1976

CONDITIONS OF APPROVAL, IF ANY

Cement must be circulated to surface behind 13 3/8" casing

Notify N.M.O.C.C. in sufficient time to witness cementing the 8 7/8" casing

N. MEXICO OIL CONSERVATION COMMISSION
WELL LOCATION AND ACREAGE DEDICATION, LAT

Form C-102
Supersedes C-128
Effective 1-1-65

All distances must be from the outer boundaries of the Section.

Operator <i>Yates Petroleum Corp</i>			Lease <i>Tom Brown "QO"</i>			Well No. <i>1</i>		
Unit Letter <i>C</i>	Section <i>2A</i>	Township <i>17 South</i>	Range <i>26 East</i>	County <i>Eddy</i>				
Actual Footage Location of Well: <i>835</i> feet from the <i>North</i> line and <i>1980</i> feet from the <i>West</i> line								
Ground Level Elev. <i>3339</i>	Producing Formation <i>Morrow</i>		Pool <i>J. Kennedy Farm</i>			Dedicated Acreage: <i>320.50</i> Acres		

1. Outline the acreage dedicated to the subject well by colored pencil or hachure marks on the plat below.
2. If more than one lease is dedicated to the well, outline each and identify the ownership thereof (both as to working interest and royalty).
3. If more than one lease of different ownership is dedicated to the well, have the interests of all owners been consolidated by communitization, unitization, force-pooling, etc?

☒ Yes ☐ No If answer is "yes," type of consolidation *Being Communitized*

If answer is "no," list the owners and tract descriptions which have actually been consolidated. (Use reverse side of this form if necessary.)

No allowable will be assigned to the well until all interests have been consolidated (by communitization, unitization, forced-pooling, or otherwise) or until a non-standard unit, eliminating such interests, has been approved by the Commission.

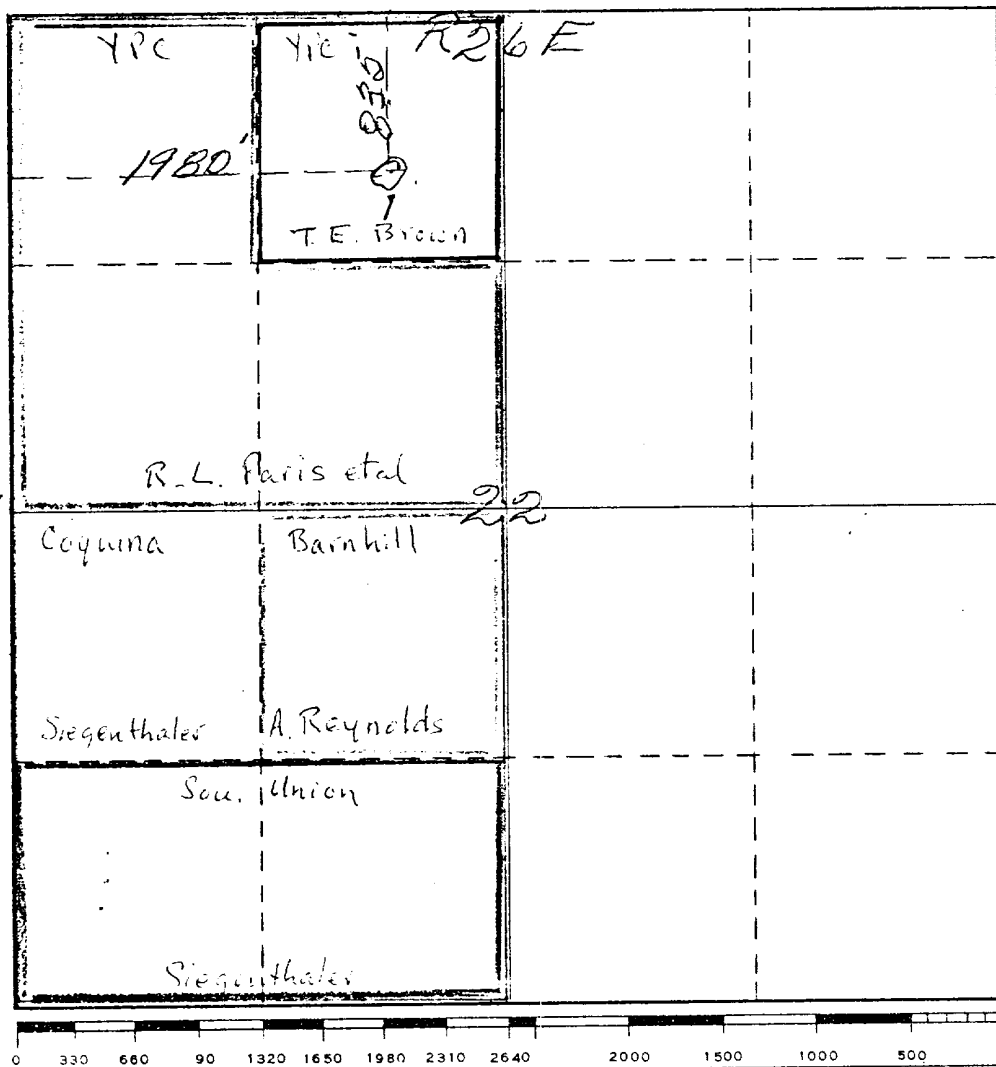

CERTIFICATION

I hereby certify that the information contained herein is true and complete to the best of my knowledge and belief.

Eddie M. Mahfood

Name
Eddie M. Mahfood

Position
Engineer

Company
Yates Petroleum Corp.

Date
10-8-76

I hereby certify that the well location shown on this plat was plotted from field notes of actual surveys made by me or under my supervision, and that the same is true and correct to the best of my knowledge and belief.

JAMES H. BROWN

Date Surveyed
October 2nd 1976

Registered Professional Engineer and/or Land Surveyor

James H. Brown
Certificate No. *542*

THE FOLLOWING CONSTITUTE MINIMUM BLOWOUT PREVENTER REQUIREMENTS

1. All preventers to be hydraulically operated with secondary manual controls installed prior to drilling out from under casing.
2. Choke outlet to be a minimum of 4" diameter.
3. Kill line to be of all steel construction of 2" minimum diameter.
4. All connections from operating manifolds to preventers to be all steel hole or tube a minimum of one inch in diameter.
5. The available closing pressure shall be at least 15% in excess of that required with sufficient volume to operate the B.O.P.'s.
6. All connections to and from preventer to have a pressure rating equivalent to that of the B.O.P.'s.