

NO. OF COPIES RECEIVED		4
DISTRIBUTION		
SANTA FE		/
FILE		/
U.S.G.S.		
LAND OFFICE		
TRANSPORTER	OIL	
	GAS	/
OPERATOR		/
PRORATION OFFICE		

NEW MEXICO OIL CONSERVATION COMMISSION
REQUEST FOR ALLOWABLE
AND
AUTHORIZATION TO TRANSPORT OIL AND NATURAL GAS

Form C-104
Supersedes Old C-104 and C-110
Effective 1-1-65

RECEIVED

APR 10 1978

Operator McCLELLAN OIL CORPORATION ✓	
Address Post Office Box 848, Roswell, New Mexico 88201	
Reason(s) for filing (Check proper box) New Well <input checked="" type="checkbox"/> Change in Transporter of: Recompletion <input type="checkbox"/> Oil <input type="checkbox"/> Dry Gas <input type="checkbox"/> Change in Ownership <input type="checkbox"/> Casinghead Gas <input type="checkbox"/> Condensate <input type="checkbox"/>	
Other (Please explain)	

If change of ownership give name
and address of previous owner

II. DESCRIPTION OF WELL AND LEASE

Lease Name Hinkle Federal	Well No. 4	Pool Name, Including Formation High Nitro Premier	Kind of Lease State, Federal or Fee Federal LC	Lease No. 068677
Location Unit Letter H 1980 Feet From The North Line and 330 Feet From The East Line of Section 9 Township 16-South Range 29-East, NMPM, Eddy County				

III. DESIGNATION OF TRANSPORTER OF OIL AND NATURAL GAS

Name of Authorized Transporter of Oil <input type="checkbox"/> or Condensate <input type="checkbox"/>	Address (Give address to which approved copy of this form is to be sent)					
Name of Authorized Transporter of Casinghead Gas <input type="checkbox"/> or Dry Gas <input checked="" type="checkbox"/>	Address (Give address to which approved copy of this form is to be sent)					
Phillips Petroleum Company	4th & Washington, Odessa, Texas 79760					
If well produces oil or liquids, give location of tanks.	Unit	Sec.	Twp.	Rge.	Is gas actually connected?	When
					Yes	March 20, 1978

If this production is commingled with that from any other lease or pool, give commingling order number:

IV. COMPLETION DATA

Designate Type of Completion - (X)	Oil Well	Gas Well	New Well	Workover	Deepen	Plug Back	Same Res'v.	Diff. Res'v.
		X	X					
Date Spudded 11/12/76	Date Compl. Ready to Prod. 1/4/77	Total Depth 2358'	P.B.T.D. Open Hole					
Elevations (DF, RKB, RT, GR, etc.) 3704' GR	Name of Producing Formation Premier Sand (Grayburg)	Top Oil/Gas Pay 2356'	Tubing Depth None					
Perforations Open hole 2356' - 2358' natural			Depth Casing Shoe 2355'					
TUBING, CASING, AND CEMENTING RECORD								
HOLE SIZE	CASING & TUBING SIZE	DEPTH SET	SACKS CEMENT					
10 1/4"	8-5/8"	362'	100 sx (circ)					
8"	7"	1669'	Set					
7"	4-1/2"	2356'	50 sx					

V. TEST DATA AND REQUEST FOR ALLOWABLE OIL WELL (Test must be after recovery of total volume of load oil and must be equal to or exceed top allowable for this depth or be for full 24 hours)

Date First New Oil Run To Tanks	Date of Test	Producing Method (Flow, pump, gas lift, etc.)	
Length of Test	Tubing Pressure	Casing Pressure	Choke Size
Actual Prod. During Test	Oil - Bbls.	Water - Bbls.	Gas - MCF

GAS WELL

Actual Prod. Test - MCF/D 858	Length of Test 16 1/2 hours	Bbls. Condensate/MMCF 0	Gravity of Condensate N/A
Testing Method (pitot, back pr.) Flowing	Tubing Pressure (Shut-in) 379	Casing Pressure (Shut-in) 700	Choke Size 1/4"

VI. CERTIFICATE OF COMPLIANCE

I hereby certify that the rules and regulations of the Oil Conservation Commission have been complied with and that the information given above is true and complete to the best of my knowledge and belief.

OIL CONSERVATION COMMISSION

APPROVED APR 28 1978
BY W. A. Gressett
TITLE SUPERVISOR, DISTRICT II

This form is to be filed in compliance with RULE 1104.

If this is a request for allowable for a newly drilled or deepened well, this form must be accompanied by a tabulation of the deviation tests taken on the well in accordance with RULE 111.

All sections of this form must be filled out completely for allowable on new and recompleted wells.

Fill out only Sections I, II, III, and VI for changes of owner, well name or number, or transporter, or other such change of condition.

Separate Forms C-104 must be filed for each pool in multiply completed wells.

J. M. McCall
Operator
April 6, 1978

RECEIVED

MAR 24 1978

OIL CONSERVATION COMMISSION

BOX 1980

HOBBS, NEW MEXICO

O. C. C.
ARTEZIA, OFFICE

NOTICE OF GAS CONNECTION

DATE March 22, 1978

This is to notify the Oil Conservation Commission that connection for
the purchase of gas from the McClellan Oil Corporation,
Operator Hugh
Hinkle Federal, 4-H, 9-16-29, Hi Nitro/Premier,
Lease Well Unit S.T.R. Pool
Phillips Petroleum Company, was made on March 20, 1978.
Name of Purchaser

Phillips Petroleum Company

Purchaser

J. E. Wilson
Representative J. E. Wilson

Prod. Records Supervisor

Title

cc: To Operator

Oil Conservation Commission - Santa Fe

NEW MEXICO OIL CONSERVATION
WELL LOCATION AND ACREAGE DEDICATION

Supersedes C-128
Effective 1-1-65

All distances must be from the outer boundaries of the Section

Operator McCLELLAN OIL CORP.		Lease Hinkle Federal		Well No. 4
Init Letter H	Section 9	Township 16 South	Range 29 East	County Eddy
Actual Footage Location of Well: 1980 feet from the North line and 330 feet from the East line				
Ground Level Elev. 3708.2-1	Producing Formation Premier sand	Pool Undesignated	Dedicated Acreage: 40.80 Acres	

1. Outline the acreage dedicated to the subject well by colored pencil or hatchure marks on the plat below.
2. If more than one lease is dedicated to the well, outline each and identify the ownership thereof (both as to working interest and royalty).
3. If more than one lease of different ownership is dedicated to the well, have the interests of all owners been consolidated by communitization, unitization, force-pooling, etc?

☐ Yes ☐ No If answer is "yes," type of consolidation _____

If answer is "no," list the owners and tract descriptions which have actually been consolidated. (Use reverse side of this form if necessary.) _____

No allowable will be assigned to the well until all interests have been consolidated (by communitization, unitization, forced-pooling, or otherwise) or until a non-standard unit, eliminating such interests, has been approved by the Commission.

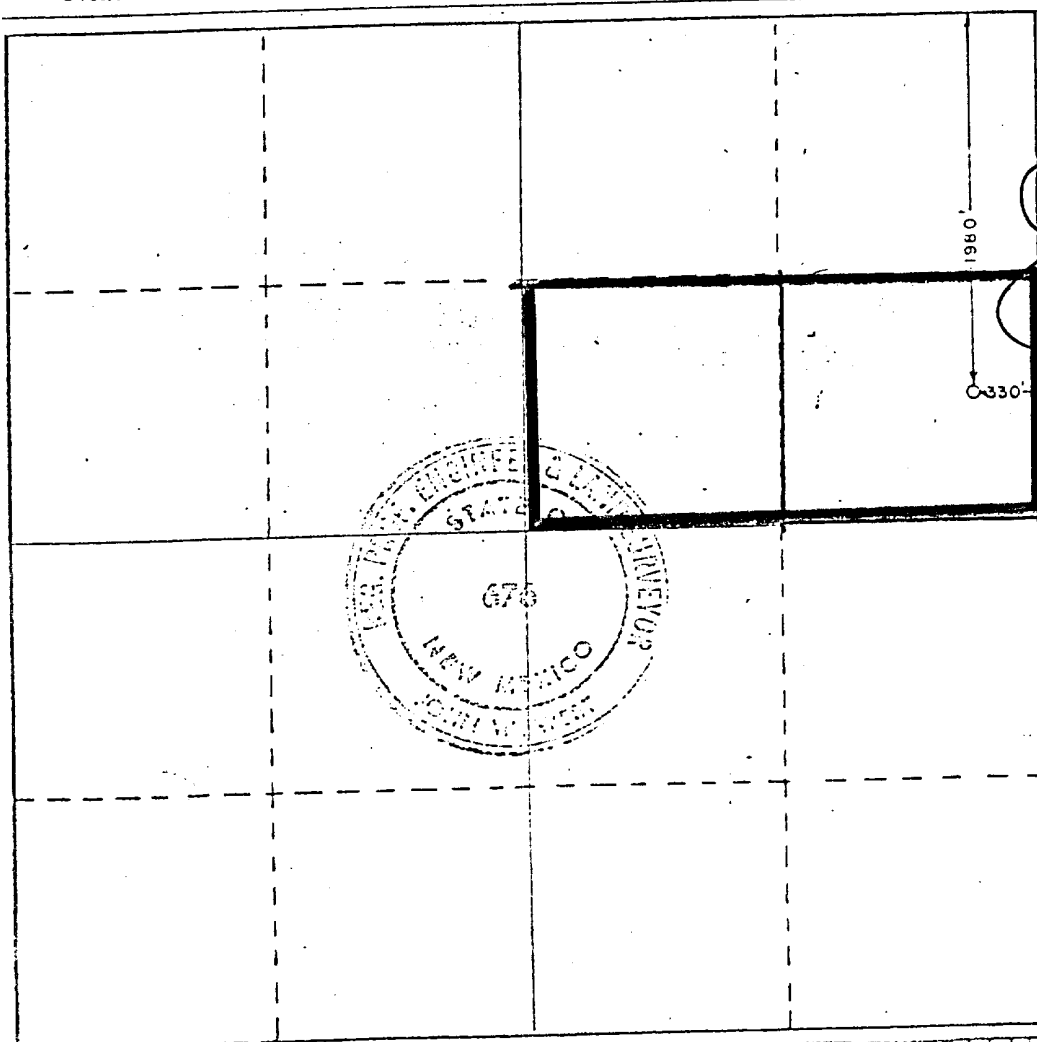

CERTIFICATION

I hereby certify that the information contained herein is true and complete to the best of my knowledge and belief.

Jack L. McClellan
Jack L. McClellan

Position
Operator

Company
McClellan Oil Corporation

Date
8/11/76

I hereby certify that the well location shown on this plat was plotted from field notes of actual surveys made by me or under my supervision, and that the same is true and correct to the best of my knowledge and belief.

Date Surveyed
August 10, 1976

Registered Professional Engineer
and/or Land Surveyor

John W. Wood
Certificate No. 676