

NO. OF COPIES RECEIVED	6
DISTRIBUTION	
SANTA FE	1
FILE	1
U.S.G.S.	2
LAND OFFICE	1
OPERATOR	1

**RECEIVED**  
 NEW MEXICO OIL CONSERVATION COMMISSION  
 NOV 1 1976  
**O. C. C.**  
**ARTESIA, OFFICE**

30-015-21962  
 Form C-101  
 Revised 1-1-65

5A. Indicate Type of Lease STATE <input checked="" type="checkbox"/> FEE <input type="checkbox"/>
5. State Oil & Gas Lease No. 647-364

**APPLICATION FOR PERMIT TO DRILL, DEEPEN, OR PLUG BACK**

1a. Type of Work b. Type of Well OIL WELL <input checked="" type="checkbox"/> GAS WELL <input type="checkbox"/> OTHER <input type="checkbox"/> DRILL <input checked="" type="checkbox"/> DEEPEN <input type="checkbox"/> PLUG BACK <input type="checkbox"/> SINGLE ZONE <input checked="" type="checkbox"/> MULTIPLE ZONE <input type="checkbox"/>		7. Unit Agreement Name Empire Abo Pressure Maintenance Project 8. Farm or Lease Name Empire Abo Unit "F" 9. Well No. 332 10. Field and Pool, or Wildcat Empire Abo 12. County Eddy
2. Name of Operator Atlantic Richfield Company ✓ 3. Address of Operator P. O. Box 1710, Hobbs, New Mexico 88240 4. Location of Well UNIT LETTER E LOCATED 2581.95 FEET FROM THE North LINE AND 150 FEET FROM THE West LINE OF SEC. 34 TWP. 17S RGE. 28E NMPM		
19. Proposed Depth 6360'		19A. Formation Abo Reef 20. Rotary or C.T. Rotary
21. Elevations (Show whether DF, RT, etc.) 3668.2' GR	21A. Kind & Status Plug. Bond GCA #8	21B. Drilling Contractor Not selected 22. Approx. Date Work will start 11/8/76

23.

**PROPOSED CASING AND CEMENT PROGRAM**

SIZE OF HOLE	SIZE OF CASING	WEIGHT PER FOOT	SETTING DEPTH	SACKS OF CEMENT	EST. TOP
11"	8-5/8" OD	24# K-55	600'	500	Circ to surf.
7-7/8"	5-1/2" OD	14 & 15.5#K-55	6360'	1650	Circ to surf

Propose to drill a producing oilwell in the Empire Abo unitized area to complete a more efficient producing pattern, conserve energy, promote the greatest ultimate recovery of reserves, prevent waste and protect correlative rights. Proposed non-standard location to meet all requirements of Order No. 4549-B, Rule 14 & NSL order.

Blowout preventer program attached.

Surveys	Mud Program	Estimated Formation Tops
GR-DLL w/RXO	0' - 600' Spud Mud	Queen 1347'
(MSFL) & Caliper	600' - 5800' Brackish Water	Grayburg 1542'
GR-Calibrated Neutron	5800' - 6360' SWG 34-38 Vis 5-8	San Andres 2092'
CNL-FDC	WL, 30,000 PPM	Abo 5820'
Sonic & Tape logs/Coriband Analysis	salinity	

**APPROVAL VALID**  
**FOR 90 DAYS UNLESS**  
**DRILLING COMMENCED,**

EXPIRES 2-5-77

IN ABOVE SPACE DESCRIBE PROPOSED PROGRAM: IF PROPOSAL IS TO DEEPEN OR PLUG BACK, GIVE DATA ON PRESENT PRODUCTIVE ZONE AND PROPOSED NEW PRODUCTIVE ZONE. GIVE BLOWOUT PREVENTER PROGRAM, IF ANY.

I hereby certify that the information above is true and complete to the best of my knowledge and belief.

Signed [Signature] Title Dist. Drlg. Supv. Date 10/29/76

(This space for State Use)

APPROVED BY [Signature] TITLE SUPERVISOR, DISTRICT II DATE NOV 5 1976

CONDITIONS OF APPROVAL, IF ANY:

NSL 802  
11-5-76

NEW MEXICO OIL CONSERVATION COMMISSION  
WELL LOCATION AND ACREAGE DEDICATION PLAT

Form O-102  
Supersedes O-128  
Effective 1-1-65

All distances must be from the outer boundaries of the Section

Operator <b>ATLANTIC RICHFIELD COMPANY</b>			Lease <b>Empire Abo Unit F</b>		Well # <b>7-332</b>
Unit Letter <b>E</b>	Section <b>34</b>	Township <b>17 South</b>	Range <b>28 East</b>	County <b>Eddy</b>	
Actual Footage Location of Well: <b>2581.95</b> feet from the <b>north</b> line and <b>150</b> feet from the <b>west</b> line					
Ground Level Elev. <b>3668.2</b>	Producing Formation <b>Abo Reef</b>		Pool <b>Empire Abo</b>	Dedicated Acreage <b>40</b> Acres	

1. Outline the acreage dedicated to the subject well by colored pencil or hachure marks on the plat below.
2. If more than one lease is dedicated to the well, outline each and identify the ownership thereof (both as to working interest and royalty).
3. If more than one lease of different ownership is dedicated to the well, have the interests of all owners been consolidated by communitization, unitization, force-pooling, etc?

☒ Yes ☐ No If answer is "yes," type of consolidation Unitization

If answer is "no," list the owners and tract descriptions which have actually been consolidated. (Use reverse side of this form if necessary.)

No allowable will be assigned to the well until all interests have been consolidated (by communitization, unitization, forced-pooling, or otherwise) or until a non-standard unit, eliminating such interests, has been approved by the Commission.

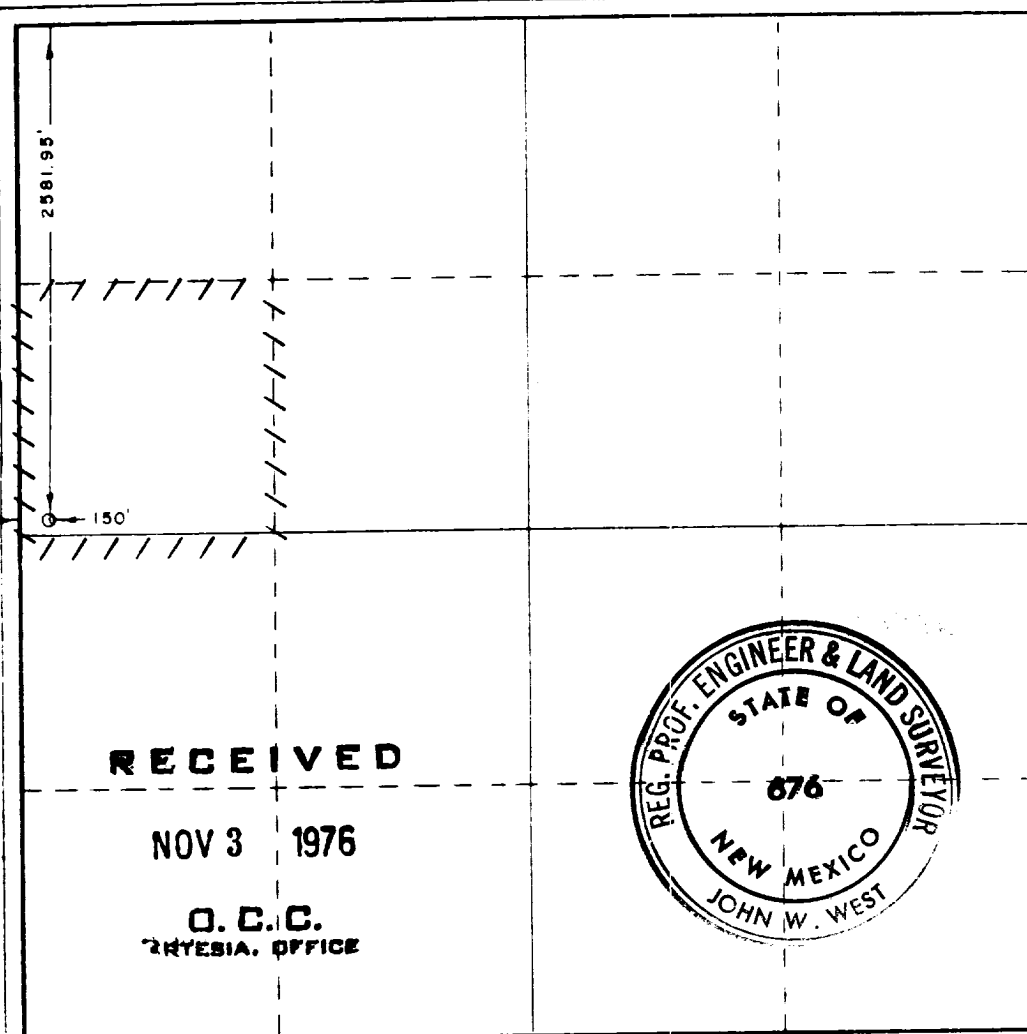

CERTIFICATION

I hereby certify that the information contained herein is true and complete to the best of my knowledge and belief.

Name

Position

**Dist. Dirg. Supv.**

Company

**Atlantic Richfield Company**

Date

**10/29/76**

I hereby certify that the well location shown on this plat was plotted from field notes of actual surveys made by me or under my supervision, and that the same is true and correct to the best of my knowledge and belief.

Date of Survey

**Oct. 1, 1976**

Registered Professional Engineer and Land Surveyor

*John W. West*

Certificate #

**676**

0 330 660 990 1320 1650 1980 2310 2640 2970 3300 3630 3960 4290 4620 4950 5280 5610 5940 6270 6600 6930 7260 7590 7920 8250 8580 8910 9240 9570 9900

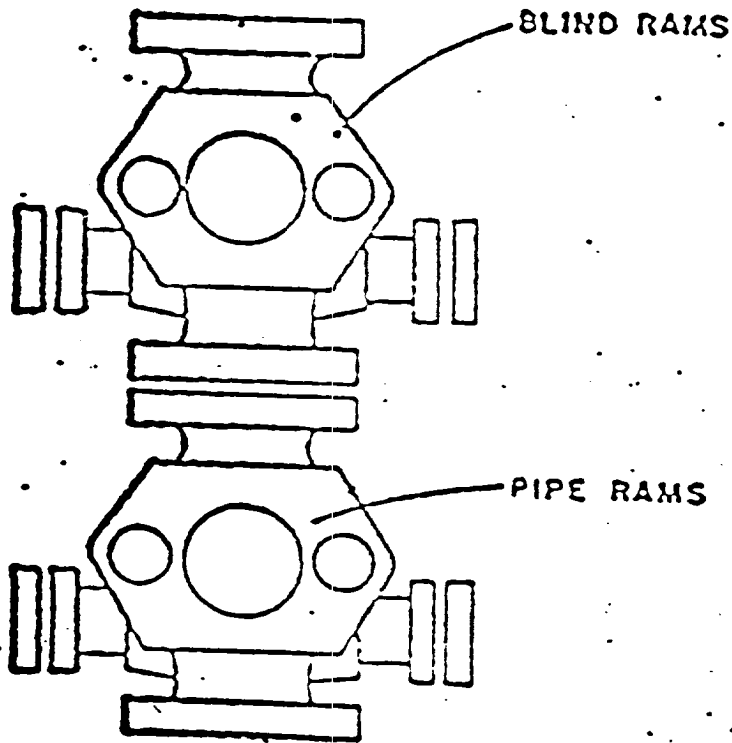

**RECEIVED**

NOV 1 1976

**O. C. C.**  
ARTESIA, OFFICE

**ATLANTIC RICHFIELD COMPANY**  
**Blow Out Preventer Program**

**Lease Name** Empire Abo Unit "F"

**Well No.** 332

**Location** 2581.95' FNL & 150' FWL  
Sec 34-17S-28E, Eddy County

BOP to be tested before installed on well and will be maintained in good working condition during drilling. All wellhead fittings to be of sufficient pressure to operate in a safe manner.