

| | |
|------------------------|-----|
| NO. OF COPIES RECEIVED | 6 |
| DISTRIBUTION | |
| SANTA FE | 1 |
| FILE | 1 ✓ |
| U.S.G.S. | 2 |
| LAND OFFICE | 1 |
| OPERATOR | 1 |

RECEIVED
NEW MEXICO OIL CONSERVATION COMMISSION

NOV 1 1976

O. C. C.
ARTESIA, OFFICE

30-015-21964
Form C-101
Revised 1-1-65

| |
|--|
| 5A. Indicate Type of Lease STATE <input checked="" type="checkbox"/> FEE <input type="checkbox"/> |
| 5. State Oil & Gas Lease No. B-2071-24 |
| 7. Unit Agreement Name Empire Abo Pressure Maintenance Project |
| 8. Farm or Lease Name Empire Abo Unit "G" |
| 9. Well No. 342 |
| 10. Field and Pool, or Wildcat Empire Abo |
| 12. County Eddy |

APPLICATION FOR PERMIT TO DRILL, DEEPEN, OR PLUG BACK

| | | | | | | | |
|--|--|---|---|--|-----------------------------|----------------------------|------------------------------|
| 1a. Type of Work b. Type of Well OIL WELL <input checked="" type="checkbox"/> GAS WELL <input type="checkbox"/> OTHER <input type="checkbox"/> DRILL <input checked="" type="checkbox"/> DEEPEN <input type="checkbox"/> PLUG BACK <input type="checkbox"/> SINGLE ZONE <input checked="" type="checkbox"/> MULTIPLE ZONE <input type="checkbox"/> | | 2. Name of Operator Atlantic Richfield Company ✓ | 3. Address of Operator P. O. Box 1710, Hobbs, New Mexico 88240 | 4. Location of Well UNIT LETTER K LOCATED 2400 FEET FROM THE South LINE AND 2080 FEET FROM THE West LINE OF SEC. 34 TWP. 17S RGE. 28E NMPM | 13. Proposed Depth 6360' | 19A. Formation Abo Reef | 20. Rotary or C.T. Rotary |
| 21. Elevations (Show whether DF, RT, etc.) 3667.6' GR | | 21A. Kind & Status Plug. Bond GCA #8 | 21B. Drilling Contractor Not Selected | 22. Approx. Date Work will start 11/24/76 | | | |

23.

PROPOSED CASING AND CEMENT PROGRAM

| SIZE OF HOLE | SIZE OF CASING | WEIGHT PER FOOT | SETTING DEPTH | SACKS OF CEMENT | EST. TOP |
|--------------|----------------|-----------------|---------------|-----------------|--------------|
| 11" | 8-5/8" OD | 24# K-55 | 600' | 500 | Circ to surf |
| 7-7/8" | 5-1/2" OD | 14 & 15.5# K-55 | 6360' | 1650 | Circ to surf |

Propose to drill a producing oilwell in the Empire Abo unitized area to complete a more efficient producing pattern, conserve energy, promote the greatest ultimate recovery of reserves, prevent waste & protect correlative rights. Proposed non-standard location to meet all requirements of Order No. 4549-B, Rule 14 & NSL order. Blowout Preventer Program diagram attached.

Surveys

GR-DLL w/RXO
(MSFL) & Caliper
GR-Calibrated Neutron
CNL-FDC
Sonic
Tape logs for Coriband analysis

Mud Program

0' - 600' Spud Mud
600' - 5800' Brackish Water
5800' - 6360' SWG 34-38 Vis
5-8 WL 30,000
PPM salinity

Estimated Formation Tops

Queen 1347'
Grayburg 1542'
San Andres 2092'
Abo 5820'

**APPROVAL VALID
FOR 90 DAYS UNLESS
DRILLING COMMENCED,**

EXPIRES 2-5-77

IN ABOVE SPACE DESCRIBE PROPOSED PROGRAM; IF PROPOSAL IS TO DEEPEN OR PLUG BACK, GIVE DATA ON PRESENT PRODUCTIVE ZONE AND PROPOSED NEW PRODUCTIVE ZONE. GIVE BLOWOUT PREVENTER PROGRAM, IF ANY.

I hereby certify that the information above is true and complete to the best of my knowledge and belief.

Signed [Signature] Title Dist. Drlg. Supv. Date 10/29/76

(This space for State Use)

APPROVED BY W. A. Gussett TITLE SUPERVISOR, DISTRICT II DATE NOV 5 1976

CONDITIONS OF APPROVAL, IF ANY:

NSL 802
11-5-76

**NEW MEXICO OIL CONSERVATION COMMISSION
WELL LOCATION AND ACREAGE DEDICATION PLAT**

Form O-112
Supersedes O-128
Effective 1-1-65

All distances must be from the outer boundaries of the Section

| | | | | | |
|---|--|-----------------------------|-----------------------------------|--------------------------------|--------------------------|
| Lessee ATLANTIC RICHFIELD COMPANY | | | Lease Empire Abo Unit G | | Well No. G-342 |
| Section K | Section 34 | Township 17 South | Range 28 East | County Eddy | |
| Actual Well Location of Well: | | | | | |
| 2400 | | feet from the | south | line and | 2080 |
| | | | | feet from the | west |
| Ground Level Elev. 3667.6 | Producing Formation Abo Reef | | Well Empire Abo | Estimated Acreage 40 | |

1. Outline the acreage dedicated to the subject well by colored pencil or hatchure marks on the plat below.
2. If more than one lease is dedicated to the well, outline each and identify the ownership thereof (both as to working interest and royalty).
3. If more than one lease of different ownership is dedicated to the well, have the interests of all owners been consolidated by communitization, unitization, force-pooling, etc?

☒ Yes ☐ No If answer is "yes," type of consolidation Unitization

If answer is "no," list the owners and tract descriptions which have actually been consolidated (use reverse side of this form if necessary.) _____

No allowable will be assigned to the well until all interests have been consolidated (by communitization, unitization, forced-pooling, or otherwise) or until a non-standard unit, eliminating such interests, has been approved by the Commission.

RECEIVED

NOV 1 1976

**O. C. C.
ARTESIA, OFFICE**

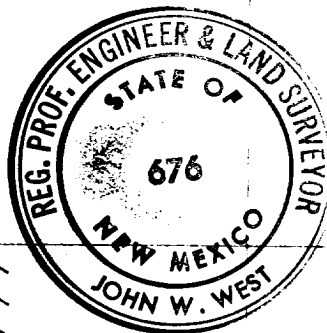

CERTIFICATION

I hereby certify that the information contained herein is true and complete to the best of my knowledge and belief.

[Signature]
Dist. Dir. Supv.

Atlantic Richfield Company

10/23/76

I hereby certify that the well location shown on this plat was plotted from field notes of actual surveys made by me or under my supervision and that the same is true and correct to the best of my knowledge and belief.

Date Surveyed:

Oct. 1, 1976

Registered Professional Engineer and Land Surveyor

[Signature]
Certificate No. **676**

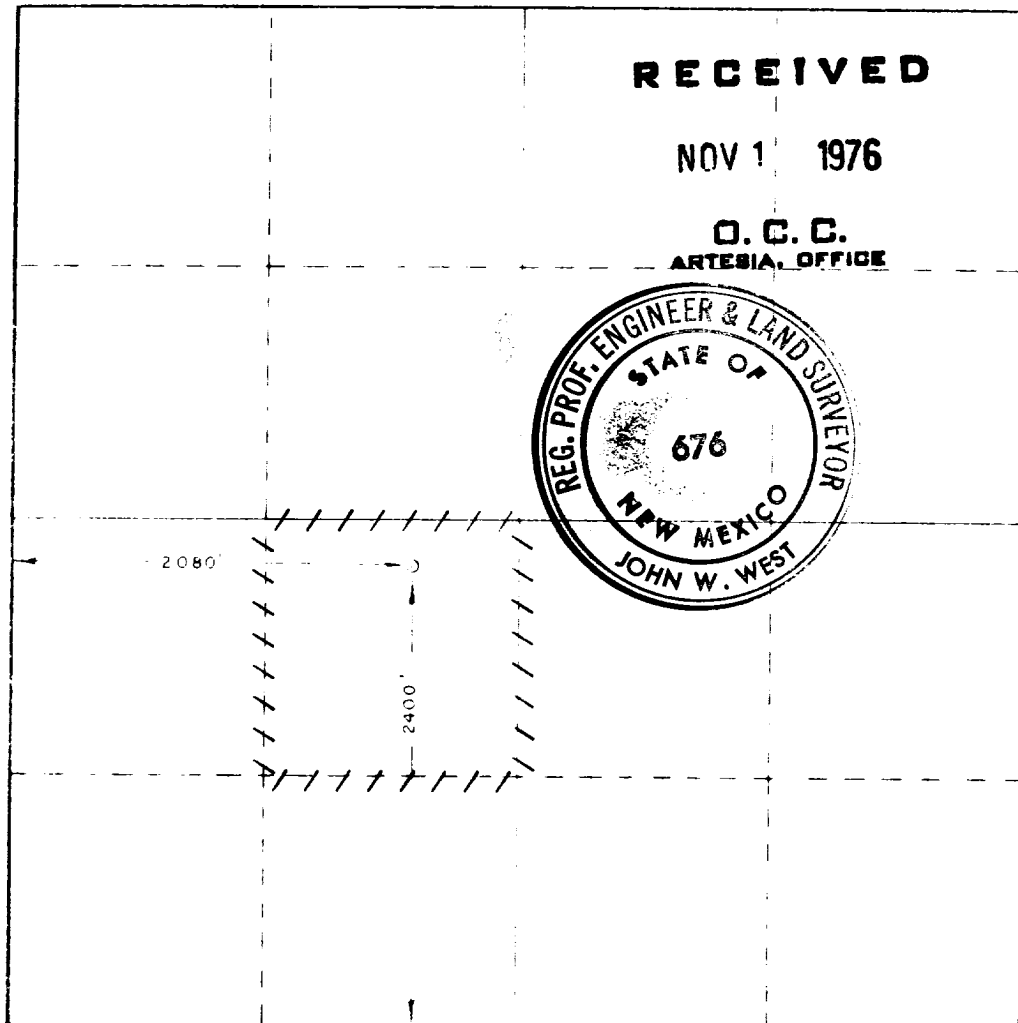

330 660 990 1320 1650 1980 2310 2640 2970 3300 3630 3960 4290 4620 4950 5280 5610 5940 6270 6600

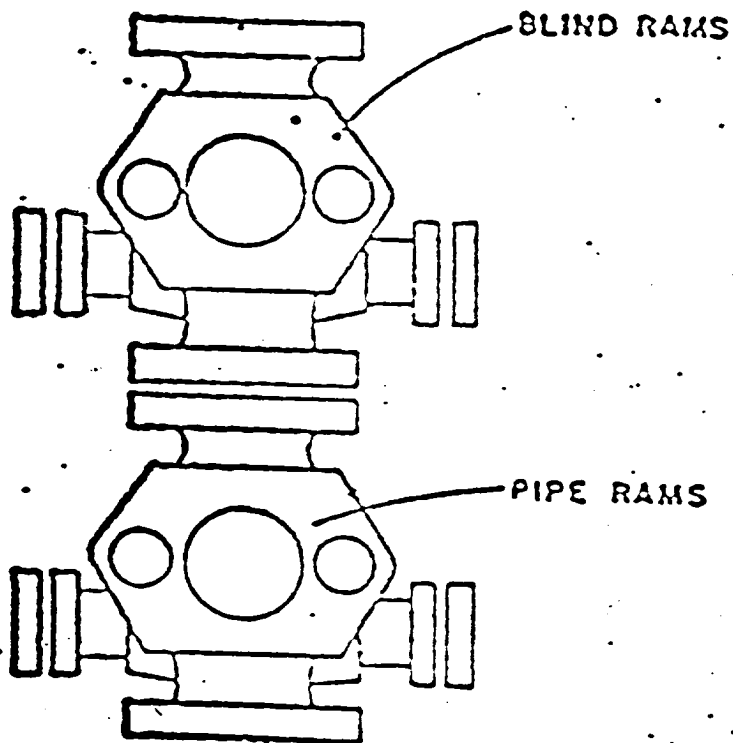

ATLANTIC RICHFIELD COMPANY
Blow Out Preventer Program

Lease Name Empire Abo Unit "G"

Well No. 342

Location 2400' FSL & 2080' FWL
Sec 34-17S-28E, Eddy County

RECEIVED

NOV 1 1976

O. C. C.
ARTESIA, OFFICE

BOP to be tested before installed on well and will be maintained in good working condition during drilling. All wellhead fittings to be of sufficient pressure to operate in a safe manner.