

District I
PO Box 1980, Hobbs, NM 88241-1980

District II
811 South First, Artesia, NM 88210

District III
1000 Rio Brazos Rd., Aztec, NM 87410

District IV
2040 South Pacheco, Santa Fe, NM 87505

State of New Mexico
Energy, Minerals & Natural Resources Department

OIL CONSERVATION DIVISION

2040 South Pacheco
Santa Fe, NM 87505

Form C-101

Revised October 18, 1994

Instructions on back

Submit to Appropriate District Office

State Lease - 6 Copies

Fee Lease - 5 Copies

☐ AMENDED REPORT

APPLICATION FOR PERMIT TO DRILL, RE-ENTER, DEEPEN, PLUGBACK, OR ADD A ZONE

Operator Name and Address SDX Resources, Inc. PO Box 5061 Midland, TX 79704 915/685-1761		OGRID Number 020451
		API Number 30 - 015-22024
Property Code 23713	Property Name Big Boggy State	Well No. 1 Y

Surface Location

UL or lot no.	Section	Township	Range	Lot Idn	Feet from the	North/South line	Feet from the	East/West Line	County
O	36	17S	26E		990	South	2080	East	Eddy

Proposed Bottom Hole Location If Different From Surface

UL or lot no.	Section	Township	Range	Lot Idn	Feet from the	North/South line	Feet from the	East/West Line	County
Proposed Pool 1 Atoka-San Andres Red Lake, CN-GB-SA					Proposed Pool 2				

Work Type Code E	Well Type Code O	Cable/Rotary R	Lease Type Code S	Ground Level Elevation 3297
Multiple No	Proposed Depth 2000	Formation San Andres	Contractor Real	Spud Date 10-01-98

Proposed Casing and Cement Program

Hole Size	Casing Size	Casing weight/foot	Setting Depth	Sacks of Cement	Estimated TOC
* 26"	20"		120	225 sx C	Surface
* 12-1/4"	8-5/8"	24#	1382	200 sx C 900 sx Lite	Surface
7-7/8"	5-1/2"	14 - 17#	2000	250 sx C	Surface
*EXISTING					

Describe the proposed program. If this application is to DEEPEN or PLUG BACK give the data on the present productive zone and proposed new productive zone. Describe the blowout prevention program, if any. Use additional sheets if necessary.

Well P&A'd 3/4/77 (P&A report attached). Casing left in hole 1382' of 8-5/8" & 120' of 20". Both strings cmt'd to surface. Plan to drill out plugs to 2000'. Run 5-1/2" csg & cmt to surface.

Will run cased hole CNL-GR log. Perf the San Andres 1700' - 1900' & stimulate as necessary for optimum production.

Former; Harvey E Yates
Big Boggy St #1-Y

Posted 10-1
NA-9-25-98

I hereby certify that the information given above is true and complete to the best of my knowledge and belief.

Signature:

Bonnie Atwater

Printed name: Bonnie Atwater

Title: Regulatory Tech. 9/15/98

OIL CONSERVATION DIVISION

Approved By: ORIGINAL SIGNED BY TIM W. GUM
DISTRICT II SUPERVISOR

Title:

Approval Date: 9-16-98

Expiration Date: 9-16-99

Submit to Appropriate
District Office
State Lease - 4 copies
Fee Lease - 3 copies

State of New Mexico
Energy, Minerals and Natural Resources Department

Form C-102
Revised 1-1-89

OIL CONSERVATION DIVISION

P.O. Box 2088
Santa Fe, New Mexico 87504-2088

DISTRICT I

P.O. Box 1980, Hobbs, NM 88240

DISTRICT II

P.O. Drawer DD, Artesia, NM 88210

DISTRICT III

1000 Rio Brazos Rd., Aztec, NM 87410

WELL LOCATION AND ACREAGE DEDICATION PLAT

All Distances must be from the outer boundaries of the section

Operator SDX Resources, Inc.			Lease Big Boggy State		Well No. 14
Unit Letter 0	Section 36	Township 17S	Range 26E	County NMPM	Eddy
Actual Footage Location of Well: 990 feet from the South line and 2080 feet from the East line					
Ground level Elev. 3297'	Producing Formation San Andres		Pool Atoka San Andres		Dedicated Acreage: 40 Acres

1. Outline the acreage dedicated to the subject well by colored pencil or hatchure marks on the plat below.
2. If more than one lease is dedicated to the well, outline each and identify the ownership thereof (both as to working interest and royalty).
3. If more than one lease of different ownership is dedicated to the well, have the interest of all owners been consolidated by communitization, unitization, force-pooling, etc.?
☐ Yes ☐ No If answer is "yes" type of consolidation _____
If answer is "no" list the owners and tract descriptions which have actually been consolidated. (Use reverse side of this form if necessary). _____
No allowable will be assigned to the well until all interests have been consolidated (by communitization, unitization, forced-pooling, or otherwise) or until a non-standard unit, eliminating such interest, has been approved by the Division.

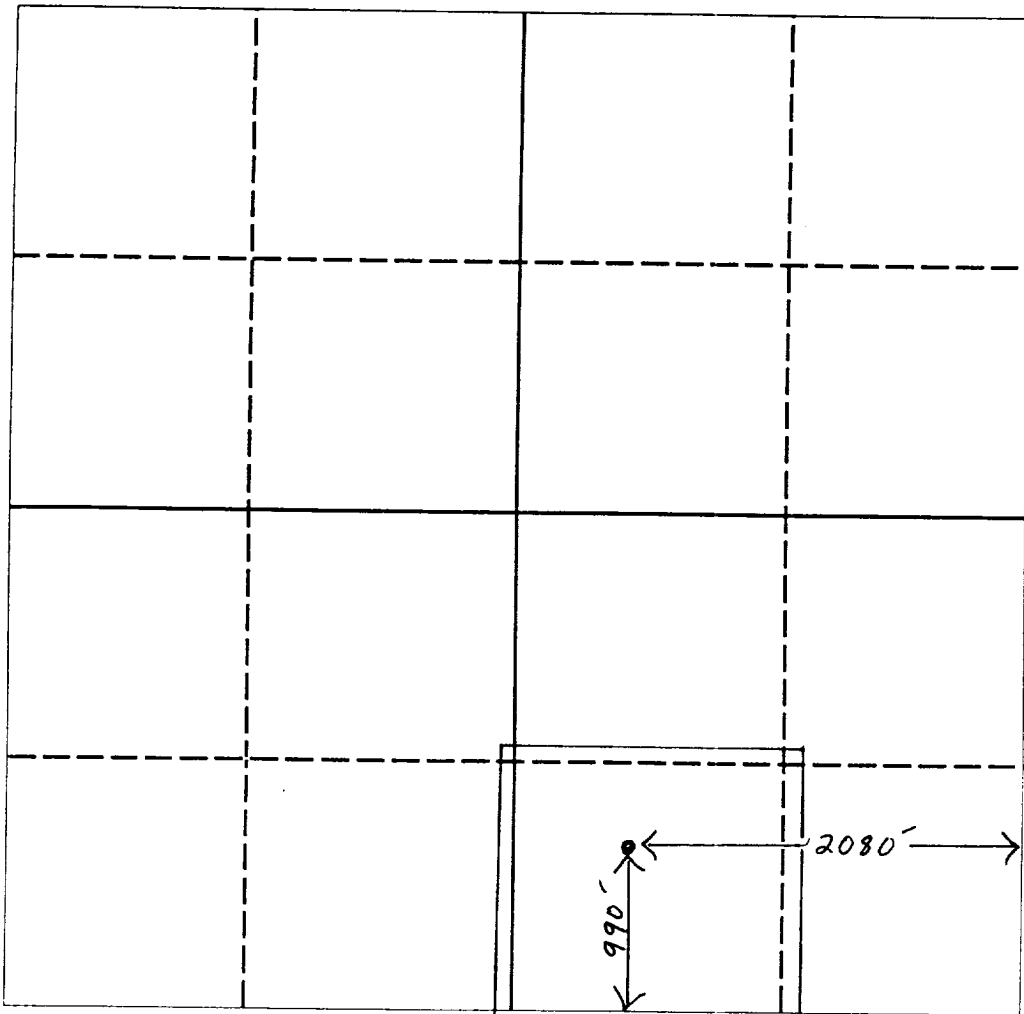

OPERATOR CERTIFICATION

I hereby certify that the information contained herein is true and complete to the best of my knowledge and belief.

Signature *Chuck Morgan*
Printed Name *Chuck Morgan*
Position Engineer
Company SDX Resources, Inc.
Date 9/15/98

SURVEYOR CERTIFICATION

I hereby certify that the well location shown on this plat was plotted from field notes of actual surveys made by me or under my supervision, and that the same is true and correct to the best of my knowledge and belief.

Date Surveyed _____
Signature & Seal of Professional Surveyor _____
ON FILE.
Certificate No. _____

Blow Out Preventor Schematic

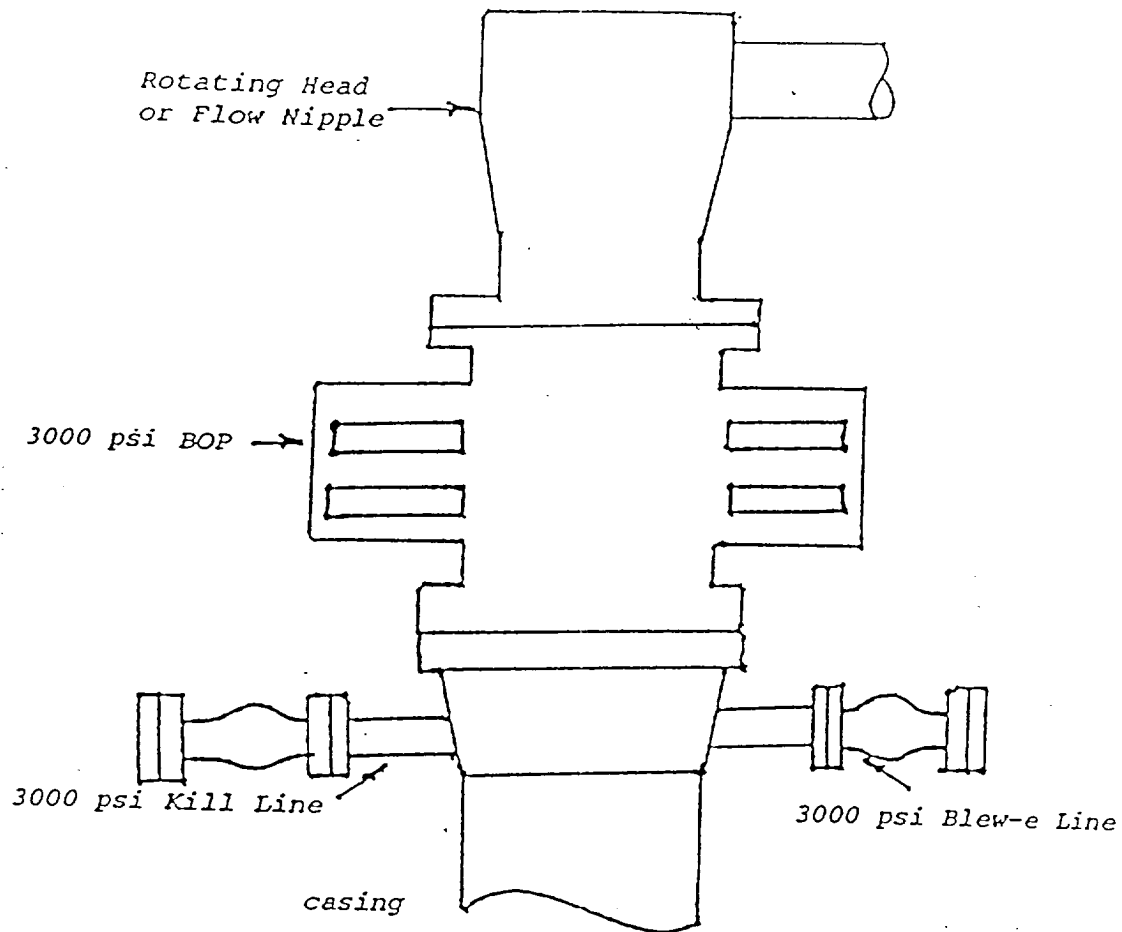

SDX RESOURCES, INC.

LEASE: Big Boggy State WELL #: 14

API 30-015-220.

NO. OF COPIES RECEIVED	3
DISTRIBUTION	
ALBUQUERQUE	1
DALE	1
S.G.S.	
AND OFFICE	
PERATOR	1

NEW MEXICO OIL CONSERVATION COMMISSION

Form C-102
Supersedes Old
C-102 and C-103
Effective 10-65

5a. Indicate Type of Lease
State <input checked="" type="checkbox"/> Fee <input type="checkbox"/>
5. State Oil & Gas Lease No.
K-6592, L-3093, LG-175

SUNDRY NOTICES AND REPORTS ON WELLS

(DO NOT USE THIS FORM FOR PROPOSALS TO DRILL OR TO DEEPEN OR PLUG BACK TO A DIFFERENT RESERVOIR.
USE "APPLICATION FOR PERMIT -" (FORM C-101) FOR SUCH PROPOSALS.)

OIL WELL <input type="checkbox"/>	GAS WELL <input checked="" type="checkbox"/>	OTHER <input type="checkbox"/>
Name of Operator Harvey E. Yates Company, Inc.		
Address of Operator Suite 1000 Security National Bank Bldg., Roswell, New Mexico		
Location of Well UNIT LETTER 0 990 FEET FROM THE South LINE AND 2080 FEET FROM East LINE, SECTION 36 TOWNSHIP 17S RANGE 26E		
15. Elevation (Show whether DF, RT, GR, etc.) 3297.0' GL		
12. County Eddy		

Check Appropriate Box To Indicate Nature of Notice, Report or Other Data
NOTICE OF INTENTION TO: SUBSEQUENT REPORT OF:

PERFORM REMEDIAL WORK <input type="checkbox"/>	PLUG AND ABANDON <input type="checkbox"/>	REMEDIAL WORK <input type="checkbox"/>	ALTERING CASING <input type="checkbox"/>
TEMPORARILY ABANDON <input type="checkbox"/>	CHANGE PLANS <input type="checkbox"/>	COMMENCE DRILLING OPS. <input type="checkbox"/>	PLUG AND ABANDONMENT <input checked="" type="checkbox"/>
WELL OR ALTER CASING <input type="checkbox"/>	OTHER <input type="checkbox"/>	CASING TEST AND CEMENT JOBS <input type="checkbox"/>	

Describe Proposed or Completed Operations (Clearly state all pertinent details, and give pertinent dates, including estimated date of starting any proposed work) SEE RULE 1503.

3-4-77 Plugged and abandoned in the following manner:

Plug #1 35 Sx Class H cement 8800' - 8900'
 Plug #2 35 Sx Class H cement 8125' - 8225'
 Plug #3 35 Sx Class H cement 7625' - 7725'
 Plug #4 35 Sx Class H cement 5825' - 5925'
 Plug #5 35 Sx Class H cement 4575' - 4675'
 Plug #6 35 Sx Class H cement 2425' - 2525'
 Plug #7 35 Sx Class H cement 1625' - 1725'
 Plug #8 50 Sx Class H cement 1325' - 1425'
 Plug #9 35 Sx Class H cement 1050' - 1150'
 Plug #10 10 Sx Class H cement at surface

Dry hole marker on top

Csg. left in hole 20" 120-cm.
898" 1375-cm.

Plugged
ID-2
PRA
4-8-77

I hereby certify that the information above is true and complete to the best of my knowledge and belief.

TITLE Vice President DATE March 28, 1977

APPROVED BY *[Signature]* TITLE OIL AND GAS INSPECTOR DATE NOV 4 1977