

**MEXICO OIL CONSERVATION COMMISSION
WELL LOCATION AND ACREAGE DEDICATION PLAT**

Form C-102
Supersedes C-128
Effective 1-1-65

All distances must be from the outer boundaries of the Section.

GENE A. SNOW			Lease R & S State		Well No. 1
Section "K"	Section 7	Township 17 South	Range 28 East	County Eddy	
Age Location of Well:					
1980	feet from the South	line and	1980	feet from the West	line
Well Elev. 3467.0	Producing Formation San Andres		Pool Undesignated		Dedicated Acreage: 40 Acres

- 1 Outline the acreage dedicated to the subject well by colored pencil or hachure marks on the plat below.
- 2 If more than one lease is dedicated to the well, outline each and identify the ownership thereof (both as to working interest and royalty).
- 3 If more than one lease of different ownership is dedicated to the well, have the interests of all owners been consolidated by communitization, unitization, force-pooling, etc?

☒ Yes ☐ No If answer is "yes," type of consolidation _____

If answer is "no," list the owners and tract descriptions which have actually been consolidated. (Use reverse side of this form if necessary.) _____

No allowable will be assigned to the well until all interests have been consolidated (by communitization, unitization, forced-pooling, or otherwise) or until a non-standard unit, eliminating such interests, has been approved by the Commission.

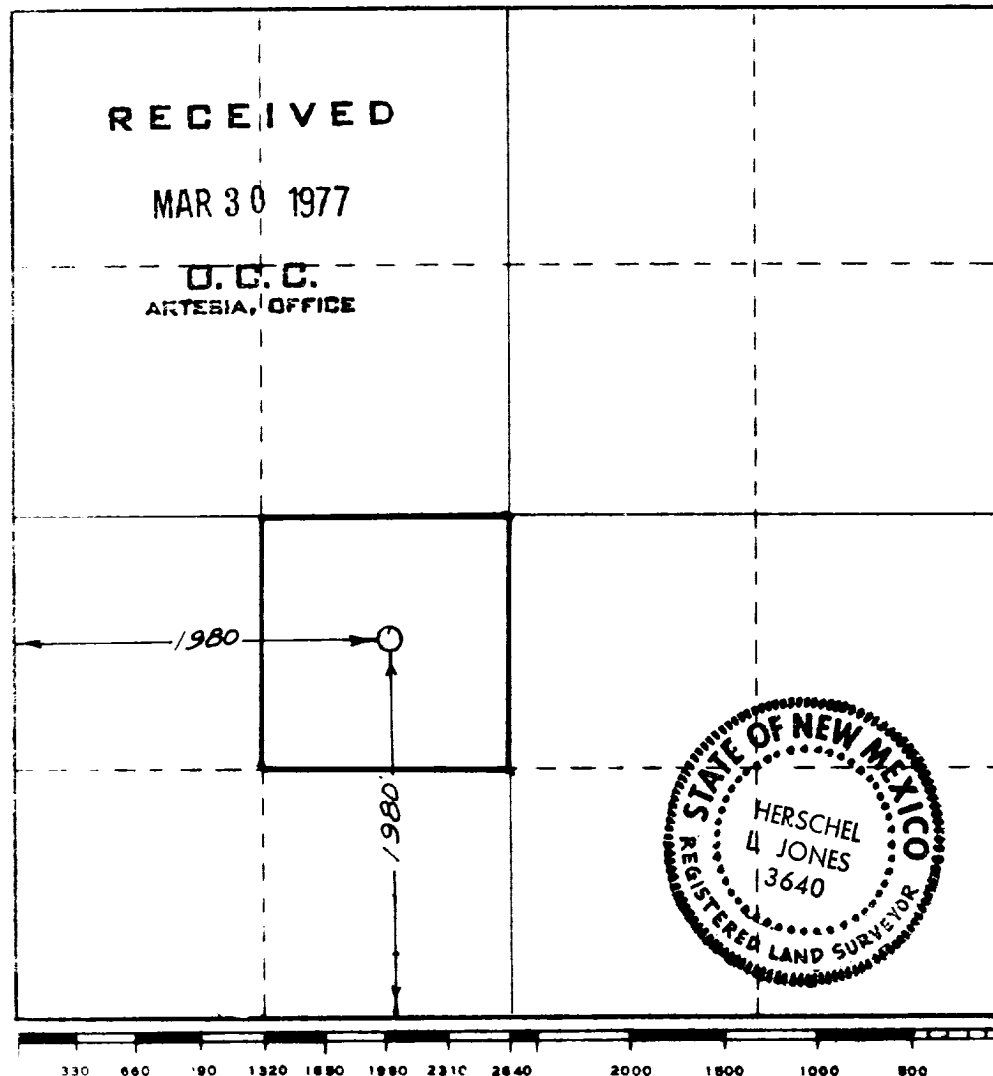

CERTIFICATION	
I hereby certify that the information contained herein is true and complete to the best of my knowledge and belief.	
Name	Gene A. Snow
Position	Operator
Company	
Date	3-27-1977
I hereby certify that the well location shown on this plat was plotted from field notes of actual surveys made by me or under my supervision, and that the same is true and correct to the best of my knowledge and belief.	
Date Surveyed	March 27, 1977
Registered Professional Engineer and/or Land Surveyor	
<i>Herschel A. Jones</i>	
Certificate No.	3640

1-19-99 Visit location -
has pit open w/ Junk in it.
Junk & cable on location -
old Drilling bits don't match
hand grade -
gravel mounds there for Betty
& unit

B

1-20-98 Called 484-3112 7:55AM
Not In. got Mobile # 365-7853
Currence - will call when cleaned
up -

Well needs to be
inspected &
signed off on

Betty