

**NEW MEXICO OIL CONSERVATION COMMISSION**  
**WELL LOCATION AND ACREAGE DEDICATION PLAT**

Form C-102  
 Supersedes C-128  
 Effective 1-1-65

All distances must be from the outer boundaries of the Section

Operator <b>Atlantic Richfield Co.</b>			Lease <b>Empire Abo Unit F</b>		Well No. <b>333</b>
Unit Letter <b>E</b>	Section <b>34</b>	Township <b>17 South</b>	Range <b>28 East</b>	County <b>Eddy</b>	

Actual Footage Location of Well:

<b>1286</b>	feet from the <b>West</b>	line and	<b>1602</b>	feet from the <b>North</b>	line
Ground Level Elev. <b>3672.7</b>	Producing Formation <b>Abo</b>		Foot <b>Empire</b>	Dedicated Acreage <b>40</b> Acres	

1. Outline the acreage dedicated to the subject well by colored pencil or hatchure marks on the plat below.
2. If more than one lease is dedicated to the well, outline each and identify the ownership thereof (both as to working interest and royalty).
3. If more than one lease of different ownership is dedicated to the well, have the interests of all owners been consolidated by communitization, unitization, force-pooling, etc?

☒ Yes    ☐ No    If answer is "yes," type of consolidation Unitization

If answer is "no," list the owners and tract descriptions which have actually been consolidated. (Use reverse side of this form if necessary.) \_\_\_\_\_

No allowable will be assigned to the well until all interests have been consolidated (by communitization, unitization, forced-pooling, or otherwise) or until a non-standard unit, eliminating such interests, has been approved by the Commission.

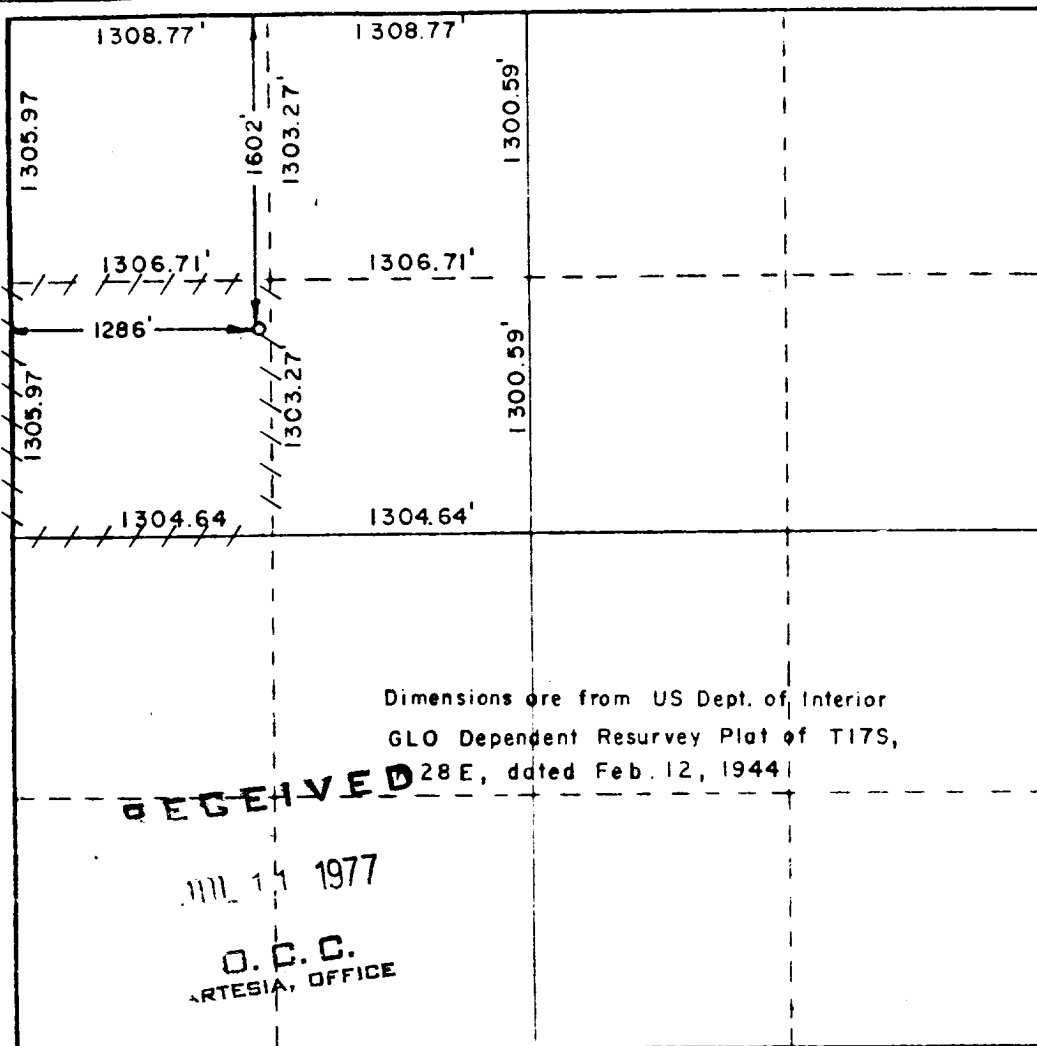

Dimensions are from US Dept. of Interior  
 GLO Dependent Resurvey Plat of T17S,  
 28E, dated Feb. 12, 1944

**RECEIVED**

JUL 14 1977

**O. C. C.**  
 ARTESIA, OFFICE

**CERTIFICATION**

I hereby certify that the information contained herein is true and complete to the best of my knowledge and belief.

\_\_\_\_\_  
 Position  
 Dist. Drlg. Supt.

Company  
 Atlantic Richfield Company

Date  
 7/7/77

I hereby certify that the well location shown on this plat was plotted from field notes of actual surveys made by me or under my supervision, and that the same is true and correct to the best of my knowledge and belief

Date Surveyed  
 June 23, 1977

Registered Professional Engineer  
 and/or Land Surveyor

\_\_\_\_\_  
 Certificate No.

**676**

300 600 900 1200 1500 1800 2100 2400 2700 3000 3300 3600 3900 4200 4500 4800 5100 5400 5700 6000

**N MEXICO OIL CONSERVATION COMMISSION  
WELL LOCATION AND ACREAGE DEDICATION PLAN**

Form No. 1  
Supersedes Form 128  
10-1-66, 1-67, 68

All distances must be from the outer boundaries of the Section.

Operator <b>Atlantic Richfield Co.</b>			Lease <b>Empire Abo Unit F</b>		Section <b>333</b>
Quarter <b>E</b>	Section <b>34</b>	Township <b>17 South</b>	Range <b>28 East</b>	County <b>Eddy</b>	
Actual distance of location of Well: <b>1286</b> feet from the <b>West</b> line and <b>1602</b> feet from the <b>North</b> line.					
Ground Level Elev. <b>3672.7</b>	Producing Formation <b>Abo Reef</b>		Pool <b>Empire Abo</b>		Section <b>40</b>

1. Outline the acreage dedicated to the subject well by colored pencil or hand-drawn marks on the map below.
2. If more than one lease is dedicated to the well, outline each and identify the ownership thereof (both as to working interest and royalty).
3. If more than one lease of different ownership is dedicated to the well, have the interests therein owners been consolidated by communitization, unitization, force-pooling, etc?

☒ Yes    ☐ No    If answer is "yes," type of consolidation Unitization

If answer is "no," list the owners and tract descriptions which have actually been consolidated (on reverse side of this form if necessary.) \_\_\_\_\_

No allowable will be assigned to the well until all interests have been consolidated (by communitization, unitization, forced-pooling, or otherwise) or until a non-standard unit, eliminating such interests, has been approved by the Commission.

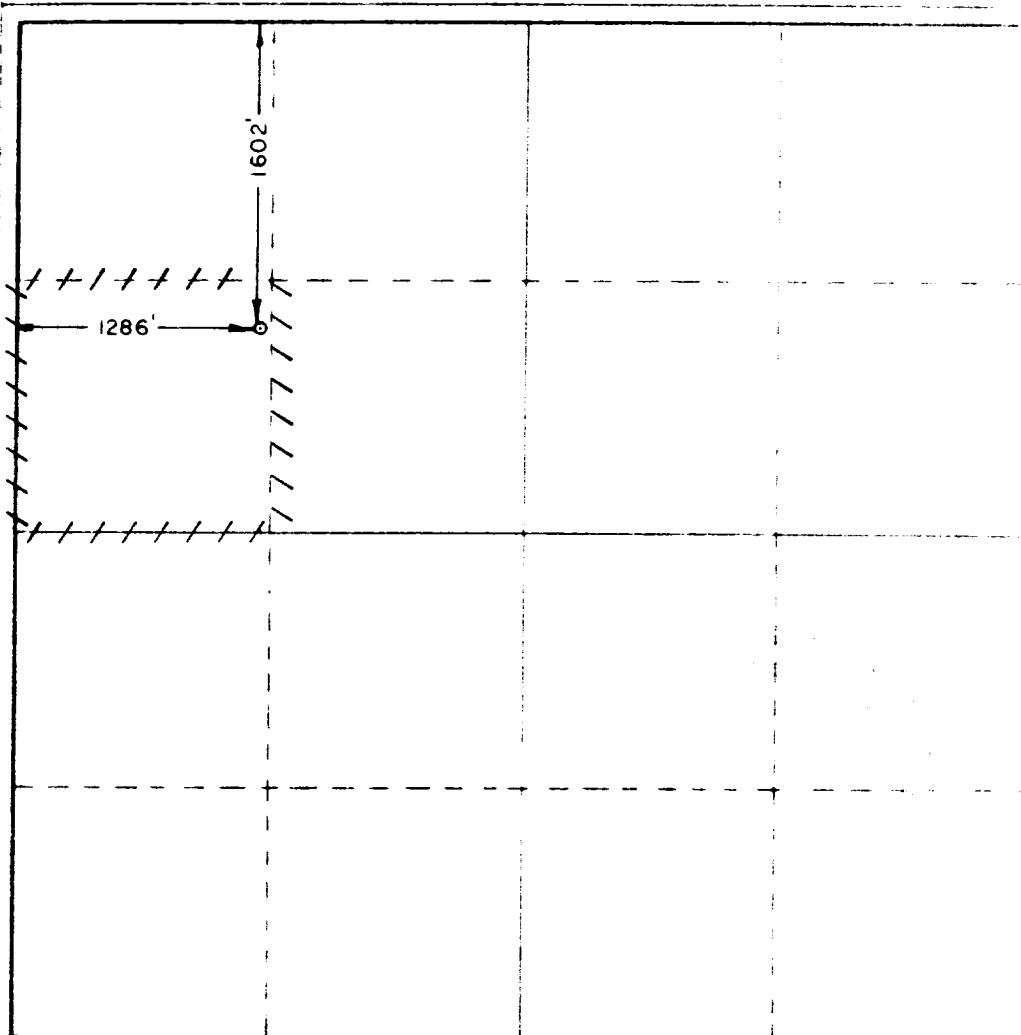

**CERTIFICATION**

I hereby certify that the information contained herein is true and complete to the best of my knowledge and belief.

*[Signature]*  
Dist. Engr. Supt.

**Atlantic Richfield Company**

**7/6/77**

I hereby certify that the well location shown on this plan was located from field notes of land surveys made by me or under my supervision and that the same is true and correct to the best of my knowledge and belief.

Witness my hand and seal this

**June 23, 1977**

Commissioner of the New Mexico Oil Conservation Commission

and State Engineer

*[Signature]*  
Commissioner

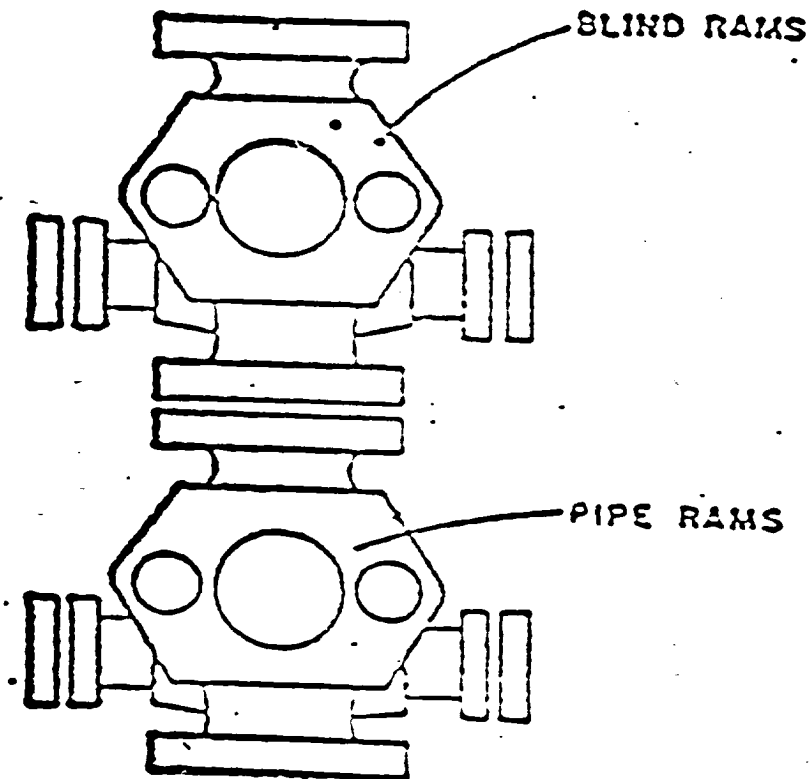

**ATLANTIC RICHFIELD COMPANY**  
**Blow Out Preventer Program**

**Lease Name** Empire Abo Unit "F"

**Well No.** 333

**Location** 1286' FWL & 1602' FNL  
Sec 34-17S-28E

Eddy County, N.M.

BOP to be tested before installed on well and will be maintained in good working condition during drilling. All wellhead fittings to be of sufficient pressure to operate in a safe manner.