

NO. OF COPIES RECEIVED	5
DISTRIBUTION	
SANTA FE	1
FILE	1 ✓
U.S.G.S.	2
LAND OFFICE	
OPERATOR	1

**RECEIVED**  
NEW MEXICO OIL CONSERVATION COMMISSION

AUG 4 1977

**O. C. C.**  
ARTESIA, OFFICE

30-015-22242

Form C-101  
Revised 1-1-65

5A. Indicate Type of Lease	
STATE <input type="checkbox"/>	FEE <input checked="" type="checkbox"/>
5. State Oil & Gas Lease No.	

**APPLICATION FOR PERMIT TO DRILL, DEEPEN, OR PLUG BACK**

1a. Type of Work				7. Unit Agreement Name	
b. Type of Well DRILL <input checked="" type="checkbox"/> DEEPEN <input type="checkbox"/> PLUG BACK <input type="checkbox"/> OIL WELL <input type="checkbox"/> GAS WELL <input checked="" type="checkbox"/> OTHER <input type="checkbox"/> SINGLE ZONE <input checked="" type="checkbox"/> MULTIPLE ZONE <input type="checkbox"/>				8. Farm or Lease Name Mitchell IN	
2. Name of Operator Yates Petroleum Corporation				9. Well No. 2	
3. Address of Operator 207 South 4th Street - Artesia, NM 88210				10. Field and Pool, or Wildcat Undesignated	
4. Location of Well UNIT LETTER <u>I</u> LOCATED <u>2030</u> FEET FROM THE <u>South</u> LINE AND <u>660</u> FEET FROM THE <u>East</u> LINE OF SEC. <u>23</u> TWP. <u>17S</u> RGE. <u>25E</u> NMRM				12. County Eddy	
21. Elevation (Show whether D.P., R.L., etc.) 3476' GR				20. Rotary or C.T. Rotary	
21A. Kind & Status Plug. Bond Blanket		21B. Drilling Contractor MORANCO		22. Approx. Date Work will start As soon as approved	

23.

**PROPOSED CASING AND CEMENT PROGRAM**

SIZE OF HOLE	SIZE OF CASING	WEIGHT PER FOOT	SETTING DEPTH	SACKS OF CEMENT	EST. TOP
17½"	13-3/8"	48#	Approx 360'	Circulate	
12½"	8-5/8"	24#	" 1250'	Circulate	
7-7/8"	4½ or 5½"	10.5-11.6 or 15.5-17#	" 8600'	250 sacks	

Propose to drill and test the Morrow and intermediate formations. Surface casing will be set at approx 360' to shut off gravel and cavings, and intermediate casing will be set 100' below the Artesian zone. If commercial pay is encountered, will run 4½" or 5½" production casing, perforate and stimulate for production.

Mud Program: - FW gel and LCM to 1250, Fresh water to 4800', KCL water to 7200', low fluid loss mud to total depth.

BOP Program: - BOP's & hydril to be installed on 8-5/8" casing and tested, pipe rams tested daily, blind rams on trips.

Gas acreage not dedicated

APPROVAL VALID  
FOR 90 DAYS UNLESS  
DRILLING COMMENCED,

EXPIRES 11-8-77

IN ABOVE SPACE DESCRIBE PROPOSED PROGRAM; IF PROPOSAL IS TO DEEPEN OR PLUG BACK, GIVE DATA ON PRESENT PRODUCTIVE ZONE AND PROPOSED NEW PRODUCTIVE ZONE. GIVE BLOWOUT PREVENTER PROGRAM, IF ANY.

I hereby certify that the information above is true and complete to the best of my knowledge and belief.

Signed Christine Tomlinson Title Geol. Secty Date 8-3-77

(This space for State Use)

APPROVED BY W.A. Gussert TITLE SUPERVISOR, DISTRICT II DATE AUG 8 1977

CONDITIONS OF APPROVAL, IF ANY:

Cement must be circulated to  
surface behind all casing

Notify N.M.O.C.C. in sufficient  
time to witness cementing  
the 8 7/8" & 4 1/2" casing

NEW MEXICO OIL CONSERVATION COMMISSION  
WELL LOCATION AND ACREAGE DEDICATION PLAT

Form C-102  
Supersedes C-128  
Effective 1-1-65

All distances must be from the outer boundaries of the Section.

Operator <b>YATES PETROLEUM CORP.</b>			Lease <b>Mitchell IN</b>		Well No. <b>2</b>
Unit Letter <b>I</b>	Section <b>23</b>	Township <b>17 South</b>	Range <b>25 East</b>	County <b>Eddy</b>	

Actual Footage Location of Well:

2030 feet from the <b>South</b> line and		660 feet from the <b>East</b> line	
Ground Level Elev. <b>3476</b>	Producing Formation <b>Morrow</b>	Pool <b>East Eagle Creek</b>	Dedicated Acreage: <b>320</b> Acres

1. Outline the acreage dedicated to the subject well by colored pencil or hachure marks on the plat below.
2. If more than one lease is dedicated to the well, outline each and identify the ownership thereof (both as to working interest and royalty).
3. If more than one lease of different ownership is dedicated to the well, have the interests of all owners been consolidated by communitization, unitization, force-pooling, etc?

☒ Yes ☐ No If answer is "yes," type of consolidation Being Communitized

If answer is "no," list the owners and tract descriptions which have actually been consolidated. (Use reverse side of this form if necessary.)

No allowable will be assigned to the well until all interests have been consolidated (by communitization, unitization, forced-pooling, or otherwise) or until a non-standard unit, eliminating such interests, has been approved by the Commission.

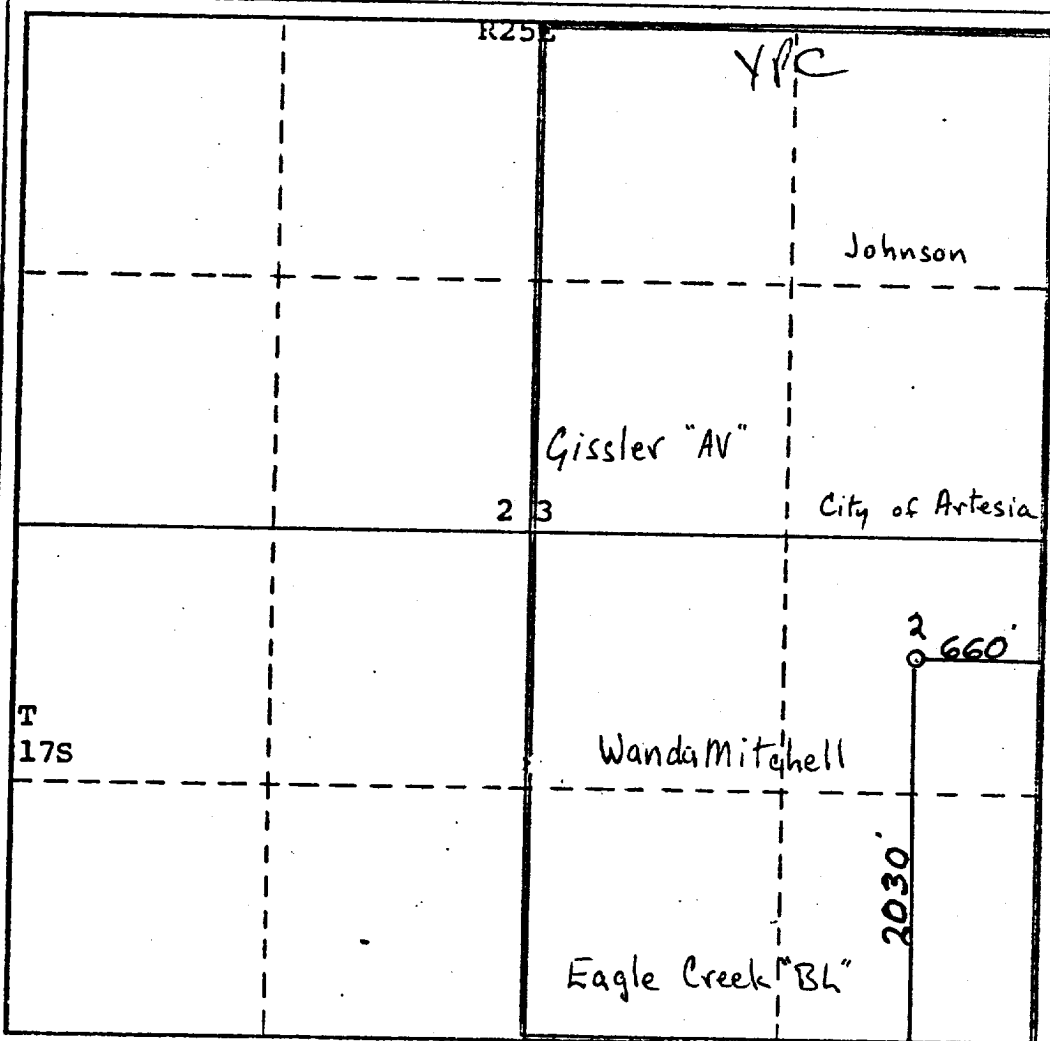

CERTIFICATION

I hereby certify that the information contained herein is true and complete to the best of my knowledge and belief.

*Eddie M. Mahfood*

Name  
**Eddie M. Mahfood**  
Position  
**Engineer**  
Company  
**Yates Petroleum Corp.**  
Date  
**7-13-77**

I hereby certify that the well location shown on this plat was plotted from field notes of actual surveys made by me or under my supervision, and that the same is true and correct to the best of my knowledge and belief.

Date Surveyed  
**7/12/77**  
Registered Professional Engineer  
and/or Land Surveyor  
*Michael S. Castle*  
Certificate No.  
**6272**

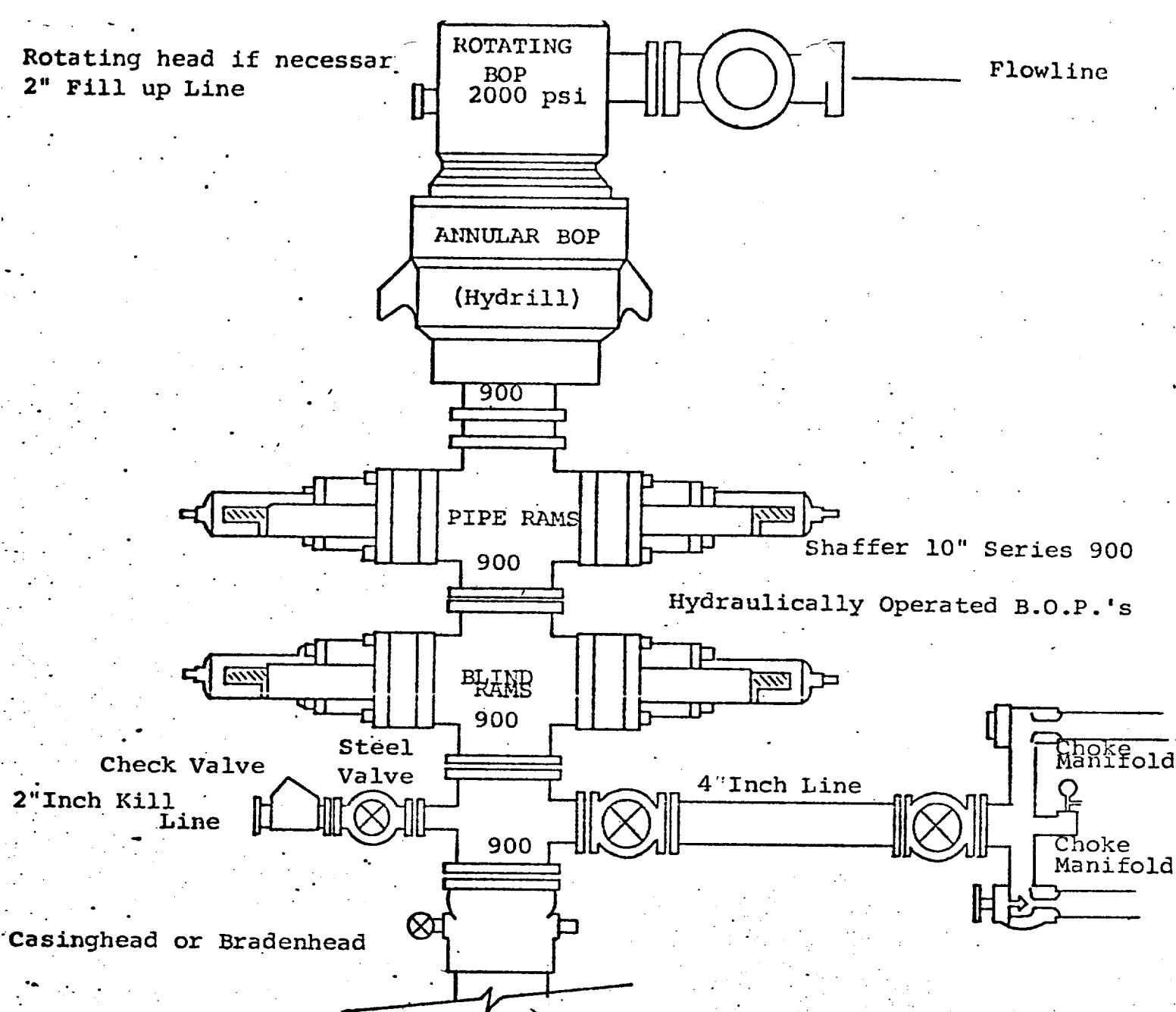

THE FOLLOWING CONSTITUTE MINIMUM BLOWOUT PREVENTER REQUIREMENTS

1. All preventers to be hydraulically operated with secondary manual controls installed prior to drilling out from under casing.
2. Choke outlet to be a minimum of 4" diameter.
3. Kill line to be of all steel construction of 2" minimum diameter.
4. All connections from operating manifolds to preventers to be all steel. hole or tube a minimum of one inch in diameter.
5. The available closing pressure shall be at least 15% in excess of that required with sufficient volume to operate the B.O.P.'s.
6. All connections to and from preventer to have a pressure rating equivalent to that of the B.O.P.'s.
7. Inside blowout preventer to be available on rig floor.
8. Operating controls located a safe distance from the rig floor.
9. Hole must be kept filled on trips below intermediate casing. Operator not responsible for blowouts resulting from not keeping hole full.
10. D. P. float must be installed and used below zone of first gas intrusion.