

District I
1625 N. French Dr., Hobbs, NM 88240
District II
1301 W. Grand Avenue, Artesia, NM 88210
District III
1000 Rio Brazos Road, Aztec, NM 87410
District IV
1220 S. St. Francis Dr., Santa Fe, NM 87505

State of New Mexico
Energy Minerals and Natural Resources

Oil Conservation Division
1301 W. Grand 1220 South St. Francis Dr.
Artesia, NM Santa Fe, NM 87505
88210

Form C-101
Revised March 17, 1999

Submit to appropriate District Office
State Lease - 6 Copies
Fee Lease - 5 Copies

☐ AMENDED REPORT

APPLICATION FOR PERMIT TO DRILL, RE-ENTER, DEEPEN, PLUGBACK, OR ADD A ZONE

¹ Operator Name and Address Ocean Energy, Inc. 1001 Fannin, Ste. 1600, Houston, TX 77002		² OGRID Number 23654
		³ API Number 30-015-22307
³ Property Code 23454	⁵ Property Name Bogle State Com	⁶ Well No. 1

⁷ Surface Location

UL or lot no.	Section	Township	Range	Lot Idn	Feet from the	North/South line	Feet from the	East/West line	County
H	2	16S	27E		2560'	North	660'	East	Eddy

⁸ Proposed Bottom Hole Location If Different From Surface

UL or lot no.	Section	Township	Range	Lot Idn	Feet from the	North/South line	Feet from the	East/West line	County

⁹ Proposed Pool 1 Wildcat Upper. Penn Carbonate	¹⁰ Proposed Pool 2
---	-------------------------------

¹¹ Work Type Code PB	¹² Well Type Code G	¹³ Cable/Rotary R	¹⁴ Lease Type Code	¹⁵ Ground Level Elevation 3578'
¹⁶ Multiple N	¹⁷ Proposed Depth	¹⁸ Formation Penn	¹⁹ Contractor	²⁰ Spud Date

²¹ Proposed Casing and Cement Program

Hole Size	Casing Size	Casing weight/foot	Setting Depth	Sacks of Cement	Estimated TOC
17 1/2"	13 3/8"	72	345	350	Surf
11	8 5/8"	24	1632	675	130
7 7/8"	4 1/2"	11.6, 10.5	8780	730	

²² Describe the proposed program. If this application is to DEEPEN or PLUG BACK, give the data on the present productive zone and proposed new productive zone. Describe the blowout prevention program, if any. Use additional sheets if necessary.

Recomplete to the Penn in the Bogle State Com #1 with perforations from 7926-32' and 7994-8003'. The Atoka/Morrow (8438' to 8602' is producing at it's economic limit at approximately 10 Mcfpd.

²³ I hereby certify that the information given above is true and complete to the best of my knowledge and belief.

Signature: Vickie Frederick

Printed name: Vickie Frederick

Title: Regulatory

Date: 6-14-02

Phone: 713-265-6817

OIL CONSERVATION DIVISION

Approved by: ORIGINAL SIGNED BY TIM W. GUM
DISTRICT II SUPERVISOR

Title:

Approval Date: JUN 19 2002

Expiration: JUN 19 2003

Conditions of Approval:

Attached ☐

WELL LOCATION AND ACREAGE DEDICATION PLAT.

Supersedes C-1
Effective 1-1-77

All distances must be from the outer boundaries of the section

Operator Ocean Energy, Inc.			Lease Bogle State Com		Well No. 1
Unit Letter H	Section 2	Township 16 South	Range 27 East	County Eddy	
Actual Footage Location of Well: 2560 feet from the North line and 660 feet from the East line					
Ground Level Elev. 3578.2	Producing Formation Penn Carbonate	Pool Undesignated	Dedicated Acreage: 273.18 Acres		

1. Outline the acreage dedicated to the subject well by colored pencil or hatchure marks on the plat below.
2. If more than one lease is dedicated to the well, outline each and identify the ownership thereof (both as to working interest and royalty).
3. If more than one lease of different ownership is dedicated to the well, have the interests of all owners been consolidated by communitization, unitization, force-pooling, etc?

☒ Yes ☐ No If answer is "yes," type of consolidation unitizations & communitization (being process

If answer is "no," list the owners and tract descriptions which have actually been consolidated. (Use reverse side of this form if necessary.) _____

No allowable will be assigned to the well until all interests have been consolidated (by communitization, unitization, forced-pooling, or otherwise) or until a non-standard unit, eliminating such interests, has been approved by the Commission.

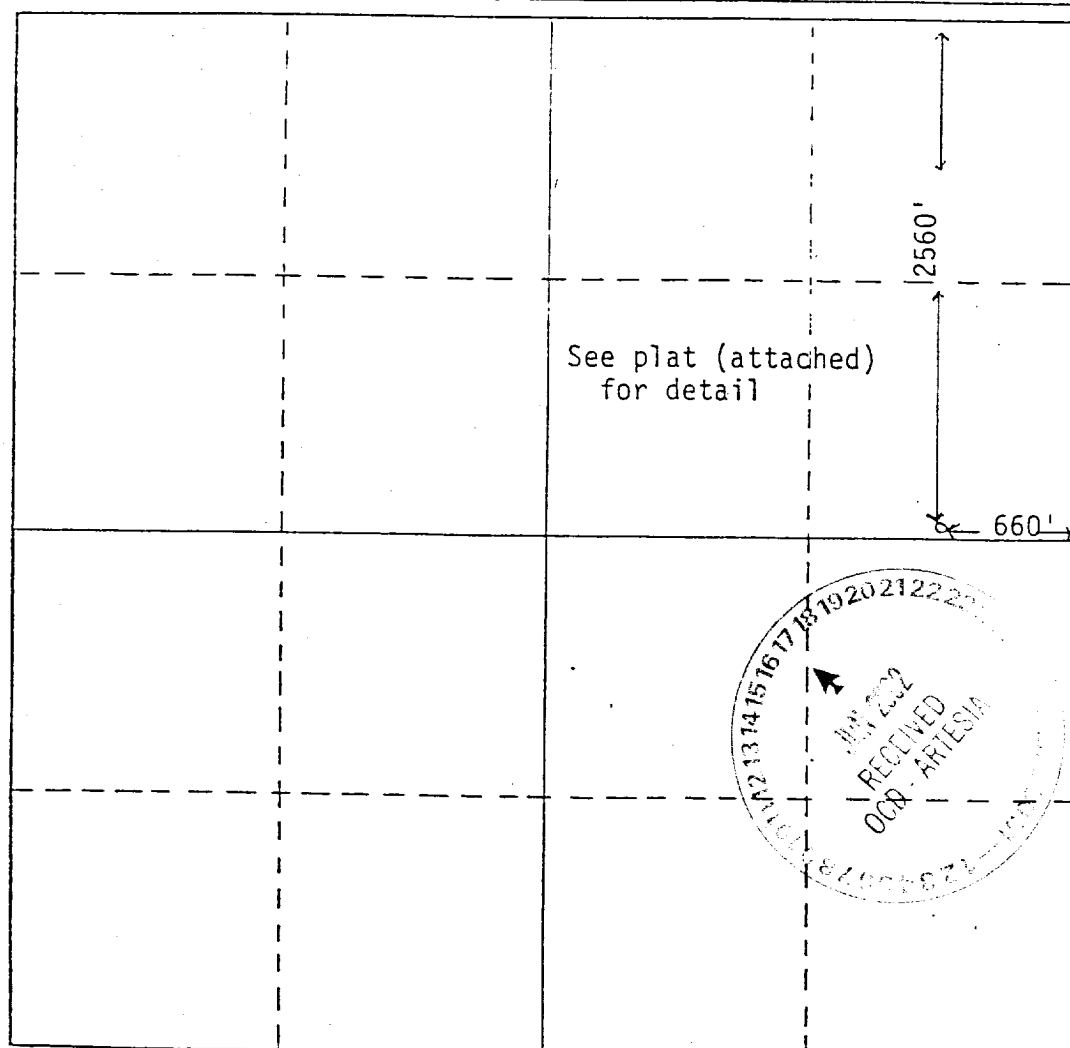

CERTIFICATION

I hereby certify that the information contained herein is true and complete to the best of my knowledge and belief.

Steve A Douglas

Name

Steve A. Douglas

Position

Staff Engineer

Company

Mesa Petroleum Co.

Date

December 4, 1978

I hereby certify that the well location shown on this plat was plotted from field notes of actual surveys made by me or under my supervision, and that the same is true and correct to the best of my knowledge and belief.

Date Surveyed

Registered Professional Engineer
and/or Land Surveyor

Certificate No.

27

