

UNITED STATES  
DEPARTMENT OF THE INTERIOR  
GEOLOGICAL SURVEY

APPLICATION FOR PERMIT TO DRILL, DEEPEN, OR PLUG BACK

1a. TYPE OF WORK

DRILL ☒

DEEPEN ☐

PLUG BACK ☐

b. TYPE OF WELL

OIL  
WELL ☒

GAS  
WELL ☐

OTHER

SINGLE  
ZONE ☐

MULTIPLE  
ZONE ☐

2. NAME OF OPERATOR

H & S Oil Company

3. ADDRESS OF OPERATOR

216 American Home Bldg., Artesia, New Mexico 88210

4. LOCATION OF WELL (Report location clearly and in accordance with any State requirements.)

At surface

330' from the South and 245' from the East lines of  
Section 13, T17S, R27E.

At proposed prod. zone

14. DISTANCE IN MILES AND DIRECTION FROM NEAREST TOWN OR POST OFFICE\*

9 miles east of Artesia, New Mexico 88210

15. DISTANCE FROM PROPOSED\*

LOCATION TO NEAREST  
PROPERTY OR LEASE LINE, FT.  
(Also to nearest drilg. unit line, if any)

330'

16. NO. OF ACRES IN LEASE

160

17. NO. OF ACRES ASSIGNED  
TO THIS WELL

40

18. DISTANCE FROM PROPOSED LOCATION\*  
TO NEAREST WELL, DRILLING, COMPLETED,  
OR APPLIED FOR, ON THIS LEASE, FT.

1650'

19. PROPOSED DEPTH

2000'

20. ROTARY OR CABLE TOOLS

Rotary

21. ELEVATIONS (Show whether DF, RT, GR, etc.)

22. APPROX. DATE WORK WILL START\*

December 1, 1977

23. PROPOSED CASING AND CEMENTING PROGRAM

SIZE OF HOLE	SIZE OF CASING	WEIGHT PER FOOT	SETTING DEPTH	QUANTITY OF CEMENT
11 1/4"	8 5/8"	29#	530'	150 sacks
7 7/8"	5 1/2"	15 1/2#	2000'	250 sacks

Estimated formation tops: Seven Rivers 150', Queen 990', Grayburg 1370', San Andres 1775'. Drilling fluid will be water with small amounts of mud additive from 1600' to assist in sample clarity. Well will be logged open hole with Gamma Ray Neutron. No abnormal pressures or hazards have been encountered in this field.

RECEIVED

OCT 20 1977

U.S. GEOLOGICAL SURVEY  
ARTESIA, NEW MEXICO

IN ABOVE SPACE DESCRIBE PROPOSED PROGRAM: If proposal is to deepen or plug back, give data on present productive zone and proposed new productive zone. If proposal is to drill or deepen directionally, give pertinent data on subsurface locations and measured and true vertical depths. Give blowout preventer program, if any.

24.

SIGNED

*Robert R. Spencer*

TITLE

Partner

DATE

10/20/77

(This space for Federal or State office use)

PERMIT NO.

APPROVAL DATE

NOV 16 1977

APPROVED BY

*Joe D. Lara*

TITLE

ACTING DISTRICT ENGINEER

DATE

NOV 16 1977

CONDITIONS OF APPROVAL, IF ANY:

THIS APPROVAL IS RESCINDED IF OPERATIONS  
ARE NOT COMMENCED WITHIN 3 MONTHS.  
EXPIRES

FEB 16 1978

\*See Instructions On Reverse Side

**MEXICO OIL CONSERVATION COMMISSION  
WELL LOCATION AND ACREAGE DEDICATION PLAT**

Form C-102  
Supersedes C-128  
Effective 1-1-65

All distances must be from the outer boundaries of the Section.

Operator <b>H &amp; S Oil Co.</b>			Lease <b>Saunders #2</b>		Well No. <b>12</b>
Unit Letter <b>O</b>	Section <b>13</b>	Township <b>17 South</b>	Range <b>27 East</b>	County <b>Lea</b>	
Actual Footage Location of Well: <b>330</b> feet from the <b>South</b> line and <b>2286</b> feet from the <b>East</b> line					
Ground Level Elev. <b>3529.2</b>	Producing Formation		Pool <b>Red Lake</b>	Dedicated Acreage: <b>40</b> Acres	

1. Outline the acreage dedicated to the subject well by colored pencil or hachure marks on the plat below.
2. If more than one lease is dedicated to the well, outline each and identify the ownership thereof (both as to working interest and royalty).
3. If more than one lease of different ownership is dedicated to the well, have the interests of all owners been consolidated by communitization, unitization, force-pooling, etc?

**RECEIVED**  
**OCT 20 1977**  
**U.S. GEOLOGICAL SURVEY**  
**ARTESIA, NEW MEXICO**

☐ Yes    ☐ No    If answer is "yes," type of consolidation \_\_\_\_\_

If answer is "no," list the owners and tract descriptions which have actually been consolidated. (Use reverse side of this form if necessary.) \_\_\_\_\_

No allowable will be assigned to the well until all interests have been consolidated (by communitization, unitization, forced-pooling, or otherwise) or until a non-standard unit, eliminating such interests, has been approved by the Commission.

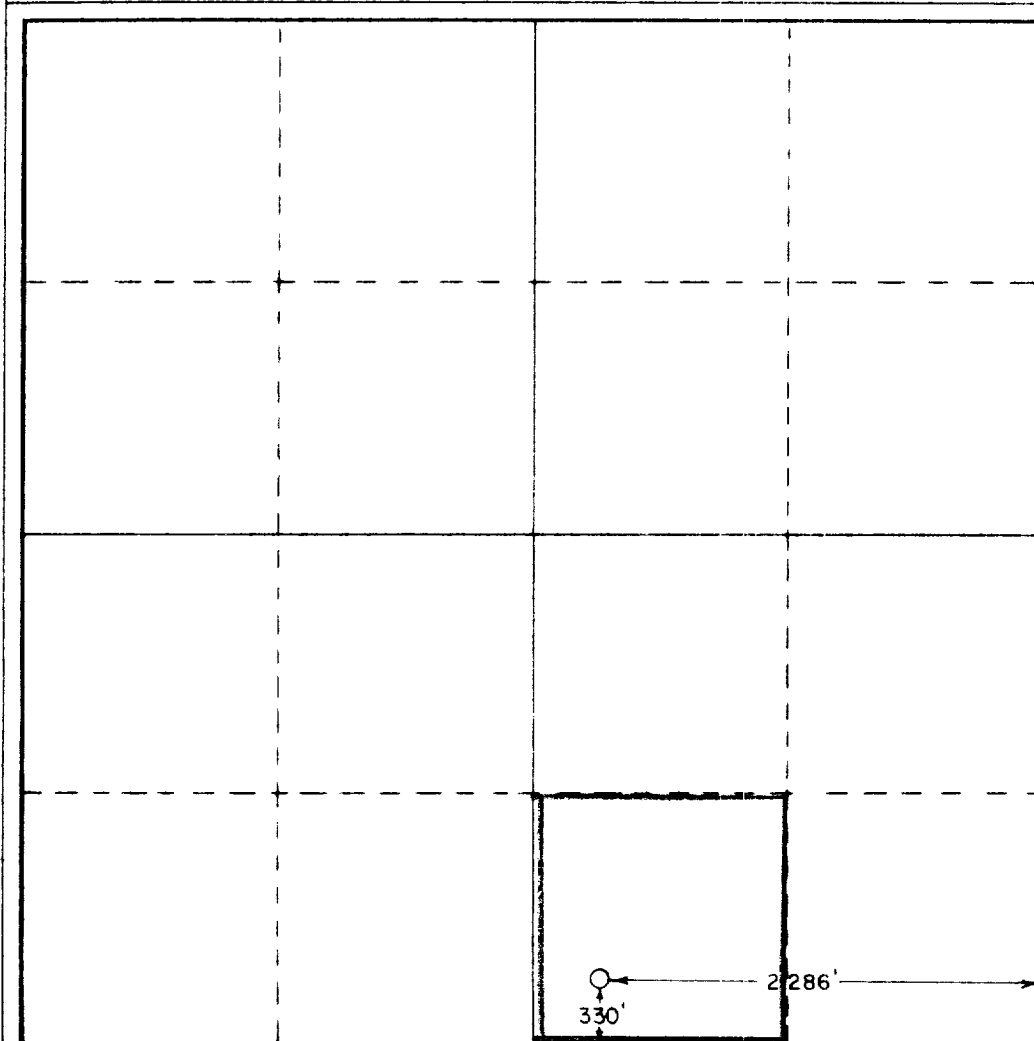

**CERTIFICATION**

I hereby certify that the information contained herein is true and complete to the best of my knowledge and belief.

*Robert R. Spencer*  
Name

Position

**Partner**

Company

**H & S Oil Company**

Date

**10/20/77**

I hereby certify that the well location shown on this plat was plotted from field notes of actual surveys made by me or under my supervision, and that the same is true and correct to the best of my knowledge and belief.

Date Surveyed

**October 17, 1977**

Registered Professional Engineer  
and/or Land Surveyor

*John W. West*

Certificate No.

**676**

0 330 660 990 1320 1650 1980 2310 2640 2970 3300 3630 3960 4290 4620 4950 5280 5610 5940 6270 6600 6930 7260 7590 7920 8250 8580 8910 9240 9570 9900