

30-015-22393

NO. OF COPIES RECEIVED	6
DISTRIBUTION	
SANTA FE	1
FILE	1
U.S.G.S.	2
LAND OFFICE	1
OPERATOR	1

NEW MEXICO OIL CONSERVATION COMMISSION

FEB 14 1978

O. C. C. ARTESIA, OFFICE

Form C-101 Revised 1-1-65

5A. Indicate Type of Lease STATE FEE

5. State Oil & Gas Lease No. B-2071

APPLICATION FOR PERMIT TO DRILL, DEEPEN, OR PLUG BACK

1a. Type of Work DRILL <input checked="" type="checkbox"/> DEEPEN <input type="checkbox"/> PLUG BACK <input type="checkbox"/>	7. Unit Agreement Name		
b. Type of Well OIL WELL <input checked="" type="checkbox"/> GAS WELL <input type="checkbox"/> OTHER <input type="checkbox"/> SINGLE ZONE <input checked="" type="checkbox"/> MULTIPLE ZONE <input type="checkbox"/>	8. Farm or Lease Name Gillespie State		
2. Name of Operator Collier & Collier ✓	9. Well No. 6		
3. Address of Operator P.O. Box 798, Artesia, New Mexico 88210	10. Field and Pool, or Wildcat E. Empire Yates Seven R.		
4. Location of Well UNIT LETTER <u>D</u> LOCATED <u>355</u> FEET FROM THE <u>North</u> LINE AND <u>446</u> FEET FROM THE <u>West</u> LINE OF SEC. <u>27</u> TWP. <u>17S</u> RGE. <u>28E</u> NMPM	12. County Eddy		
19. Proposed Depth 800	19A. Formation Seven Rivers	20. Rotary or C.T. CT	
21. Elevations (show whether D.P., K.T., etc.) 3637.6	21A. Kind & Status of Log, Bond Statewide	21B. Drilling Contractor Powco	22. Approx. Date Work will start Feb. 20, 1978

PROPOSED CASING AND CEMENT PROGRAM

SIZE OF HOLE	SIZE OF CASING	WEIGHT PER FOOT	SETTING DEPTH	SACKS OF CEMENT	EST. TOP
8"	7"	20#	560		
6 1/2"	5 1/2"	14#	795	200 circ. to surface	

Feb. 14, 1978

Plan to spud 7-Rivers well Feb. 20, 1978. Total depth will be approx. 800'. Will drill 8" hole to 560' and set cave string of 7". Will then reduce hole to 6 1/2" to T.D. Will run 790' of 5 1/2", 14# casing and circulate cement to surface using 200 SX Class "C" cement.

Decided 2/20/78 amended location

Amended Location

APPROVAL VALID FOR 90 DAYS UNLESS DRILLING COMMENCED,

EXPIRES 5-20-78

IN ABOVE SPACE DESCRIBE PROPOSED PROGRAM; IF PROPOSAL IS TO DEEPEN OR PLUG BACK, GIVE DATA ON PRESENT PRODUCTIVE ZONE AND PROPOSED NEW PRODUCTIVE ZONE, GIVE BLOWOUT PREVENTER PROGRAM, IF ANY.

I hereby certify that the information above is true and complete to the best of my knowledge and belief.

Signed Haris Siquetas Title Agent Date Feb. 14, 1978

(This space for State Use)

APPROVED BY W.A. Gussitt TITLE SUPERVISOR, DISTRICT II DATE FEB 20 1978

CONDITIONS OF APPROVAL, IF ANY:

Cement must be circulated to surface behind 5 1/2" casing

Notify N.M.O.C.C. in sufficient time to witness cementing the 5 1/2" casing

NEW MEXICO OIL CONSERVATION COMMISSION
WELL LOCATION AND ACREAGE DEDICATION PLAT

Form C-102
Supersedes C-128
Effective 1-1-65

All distances must be from the outer boundaries of the Section.

Operator Collier & Collier Producing Co.		Lease Gellespie State		Well No. 6
Unit Letter D	Section 27	Township 17 South	Range 28 East	County Eddy
Actual Footage Location of Well: 355 feet from the North line and 446 feet from the West line				
Ground Level Elev. 3637.6	Producing Formation Seven Rivers	Pool East Empire Yates SR	Dedicated Acreage: 40 Acres	

1. Outline the acreage dedicated to the subject well by colored pencil or hachure marks on the plat below.
2. If more than one lease is dedicated to the well, outline each and identify the ownership thereof (both as to working interest and royalty).
3. If more than one lease of different ownership is dedicated to the well, have the interests of all owners been consolidated by communitization, unitization, force-pooling, etc?

Yes No If answer is "yes," type of consolidation _____

If answer is "no," list the owners and tract descriptions which have actually been consolidated. (Use reverse side of this form if necessary.) _____

No allowable will be assigned to the well until all interests have been consolidated (by communitization, unitization, forced-pooling, or otherwise) or until a non-standard unit, eliminating such interests, has been approved by the Commission.

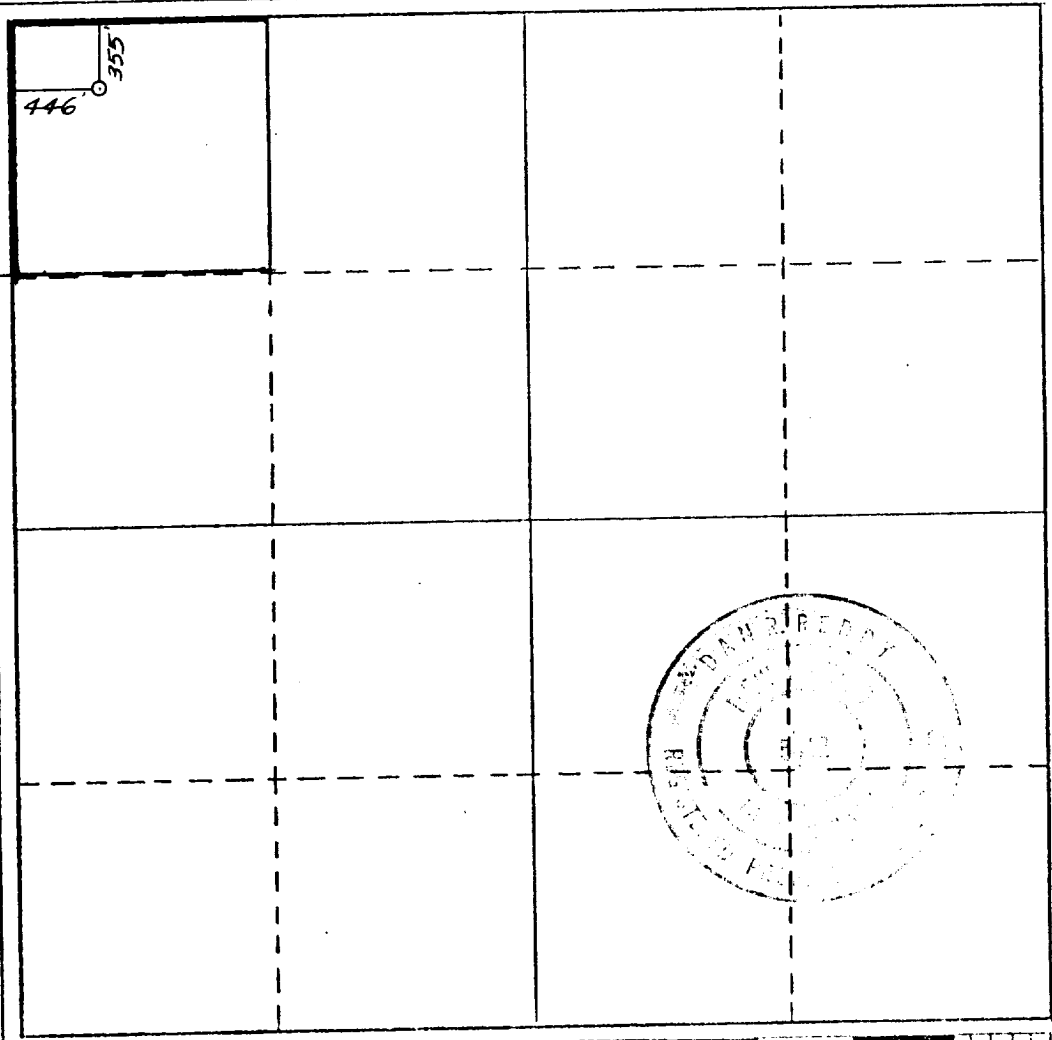

CERTIFICATION

I hereby certify that the information contained herein is true and complete to the best of my knowledge and belief.

Mario Siquentes M.S.
Name

Agent
Position

COLLIER & COLLIER
Company

Feb. 14, 1978
Date

Date Surveyed

1/27/78

I hereby certify that the well location shown on this plat was plotted from field notes of actual surveys made by me or under my supervision, and that the same is true and correct to the best of my knowledge and belief.

Registered Professional Engineer and/or Land Surveyor

Dan K. Reddy

Certificate No. **NMPE&LS 5412**

