

NO. OF COPIES RECEIVED	6
DISTRIBUTION	
SANTA FE	1
FILE	1
U.S.G.S.	2
LAND OFFICE	1
OPERATOR	1

RECEIVED
NEW MEXICO OIL CONSERVATION COMMISSION
MAR 17 1978
O. C. C.
ARTESIA, OFFICE

30-015-22464
Form C-101
Revised 14-65

5A. Indicate Type of Lease STATE <input checked="" type="checkbox"/> FEE <input type="checkbox"/>
5. State Oil & Gas Lease No. 647

APPLICATION FOR PERMIT TO DRILL, DEEPEN, OR PLUG BACK

1a. Type of Work b. Type of Well OIL WELL <input checked="" type="checkbox"/> GAS WELL <input type="checkbox"/> OTHER <input type="checkbox"/> SINGLE ZONE <input checked="" type="checkbox"/> MULTIPLE ZONE <input type="checkbox"/>		DRILL <input checked="" type="checkbox"/> DEEPEN <input type="checkbox"/> PLUG BACK <input type="checkbox"/>		7. Unit Agreement Name Empire Abo Pressure Maintenance Project
2. Name of Operator Atlantic Richfield Company		3. Address of Operator P. O. Box 1710, Hobbs, New Mexico 88240		8. Farm or Lease Name Empire Abo Unit "H"
4. Location of Well UNIT LETTER <u>N</u> LOCATED <u>150</u> FEET FROM THE <u>South</u> LINE AND <u>1650</u> FEET FROM THE <u>West</u> LINE OF SEC. <u>33</u> TWP. <u>17S</u> RGE. <u>28E</u> NMPM		9. Well No. 301		10. Field and Pool, or Wildcat Empire Abo
11. County Eddy		12. County Eddy		
13. Proposed Depth 6370'		14. Formation Abo		15. Rotary or C.T. Rotary
16. Elevations (Show whether DF, RT, etc.) 3659.8' GR	17. Kind & Status Plug. Bond GCA #8	18. Drilling Contractor Hondo Drilling Co		19. Approx. Date Work will start 4/15/78

23.

PROPOSED CASING AND CEMENT PROGRAM

SIZE OF HOLE	SIZE OF CASING	WEIGHT PER FOOT	SETTING DEPTH	SACKS OF CEMENT	EST. TOP
11"	8-5/8" OD	24# K-55	600'	300	Circ to surf
7-7/8"	5-1/2" OD	14# K-55	6000'		
	5-1/2" OD	15.5# K-55	6370'	1750	Circ to surf

Propose to drill an infill development well within the Empire Abo Unit area to more economically recover additional oil reserves and conserve reservoir pressure in accordance with Unit NMOCC Rules & Regulations (NSL-915).

Blowout Preventer Program attached.

APPROVED
DATE 6/20/78
EXHIBIT

IN ABOVE SPACE DESCRIBE PROPOSED PROGRAM: IF PROPOSAL IS TO DEEPEN OR PLUG BACK, GIVE DATA ON PRESENT PRODUCTIVE ZONE AND PROPOSED NEW PRODUCTIVE ZONE. GIVE BLOWOUT PREVENTER PROGRAM, IF ANY.

I hereby certify that the information above is true and complete to the best of my knowledge and belief.

Signed John H. Smith Title Dist. Drlg. Supt. Date 3/15/78

(This space for State Use)

APPROVED BY Mike Williams TITLE OIL AND GAS INSPECTOR DATE MAR 20 1978

CONDITIONS OF APPROVAL, IF ANY:

**NEW MEXICO OIL CONSERVATION COMMISSION
WELL LOCATION AND ACREAGE DEDICATION PLAT**

Form C-102
Supersedes C-128
Effective 1-1-65

All distances must be from the outer boundaries of the Section

Operator Atlantic Richfield Co.			Lease Empire Abo Unit - H		Well No. 301
Unit Letter N	Section 33	Township 17 South	Range 28 East	County Eddy	
Actual Footage Location of Well: 150 feet from the South line and 1650 feet from the West line					
Ground Level Elev. 3659.8	Producing Formation Abo Reef		Pool Empire Abo	Dedicated Acreage 40	

1. Outline the acreage dedicated to the subject well by colored pencil or hatchure marks on the plat below.
2. If more than one lease is dedicated to the well, outline each and identify the ownership thereof (both as to working interest and royalty).
3. If more than one lease of different ownership is dedicated to the well, have the interests of all owners been consolidated by communitization, unitization, force-pooling, etc?

☒ Yes ☐ No If answer is "yes," type of consolidation **Unitization**

If answer is "no," list the owners and tract descriptions which have actually been consolidated. (Use reverse side of this form if necessary.) _____

No allowable will be assigned to the well until all interests have been consolidated (by communitization, unitization, forced-pooling, or otherwise) or until a non-standard unit, eliminating such interests, has been approved by the Commission.

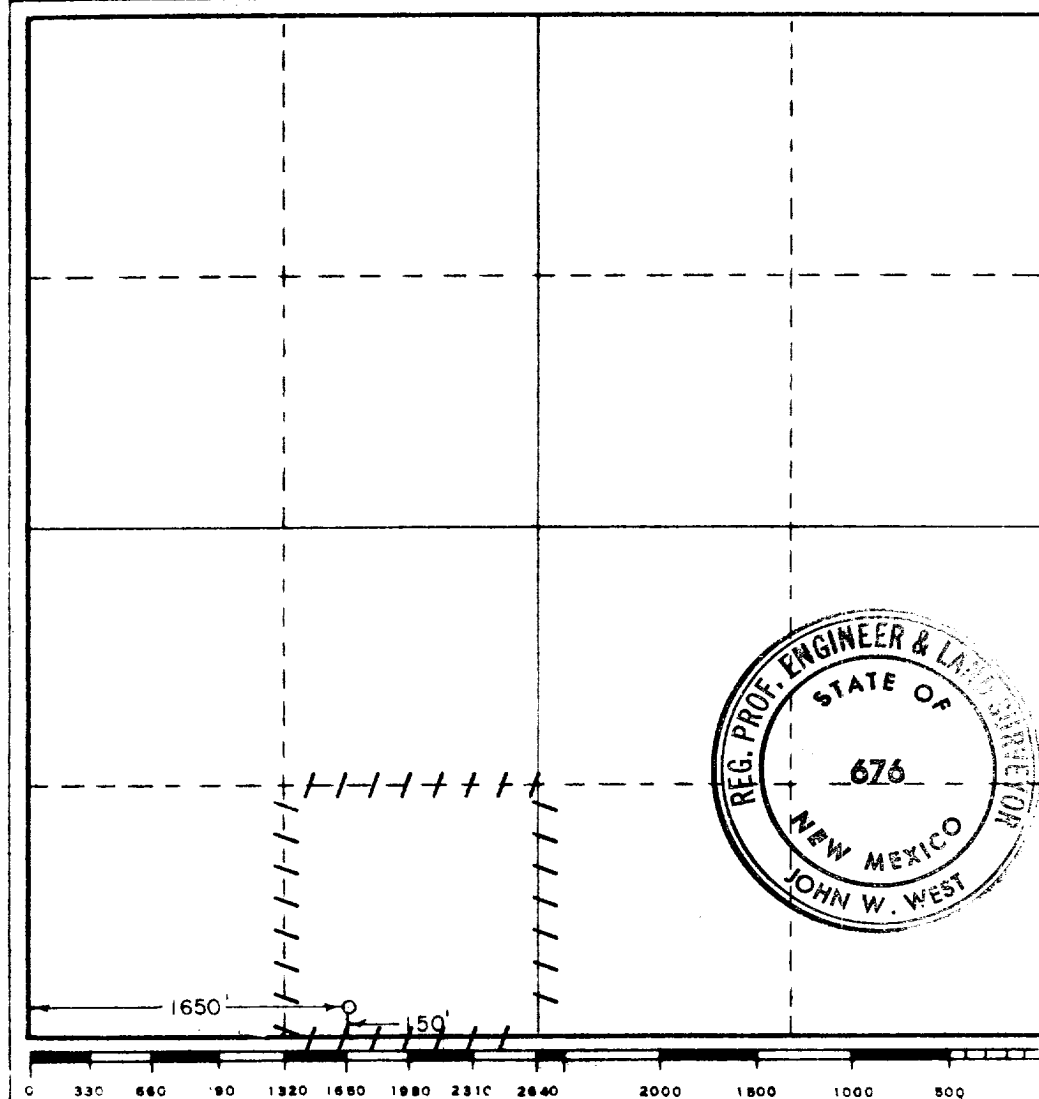

CERTIFICATION

I hereby certify that the information contained herein is true and complete to the best of my knowledge and belief.

Name *John West*
 Position _____
Dist. Drlg. Supt.
 Company _____
Atlantic Richfield Company
 Date _____
3/15/78

I hereby certify that the well location shown on this plat was plotted from field notes of actual surveys made by me or under my supervision, and that the same is true and correct to the best of my knowledge and belief.

December 16, 1977
 Date Surveyed

Registered Professional Engineer and/or Land Surveyor
John W. West
 Certificate No. **John W. West** **676**
Ronald J. Eidson **3239**

**NEW MEXICO OIL CONSERVATION COMMISSION
WELL LOCATION AND ACREAGE DEDICATION PLAT**

Form C-102
Supersedes C-128
Effective 1-1-65

All distances must be from the outer boundaries of the Section

Operator Atlantic Richfield Co.			Lease Empire Abo Unit - H		Well No. 301
Unit Letter N	Section 33	Township 17 South	Range 28 East	County Eddy	
Actual Footage Location of Well: 150 feet from the South line and 1650 feet from the West line					
Ground Level Elev. 3659.8	Producing Formation Abo Reef		Pool Empire Abo	Section Acreage 40	

1. Outline the acreage dedicated to the subject well by colored pencil or hachure marks on the plat below.
2. If more than one lease is dedicated to the well, outline each and identify the ownership thereof (both as to working interest and royalty).
3. If more than one lease of different ownership is dedicated to the well, have the interests of all owners been consolidated by communitization, unitization, force-pooling, etc?

☒ Yes ☐ No If answer is "yes," type of consolidation **Unitization**

If answer is "no," list the owners and tract descriptions which have actually been consolidated (Use reverse side of this form if necessary.) _____

No allowable will be assigned to the well until all interests have been consolidated (by communitization, unitization, forced-pooling, or otherwise) or until a non-standard unit, eliminating such interests, has been approved by the Commission.

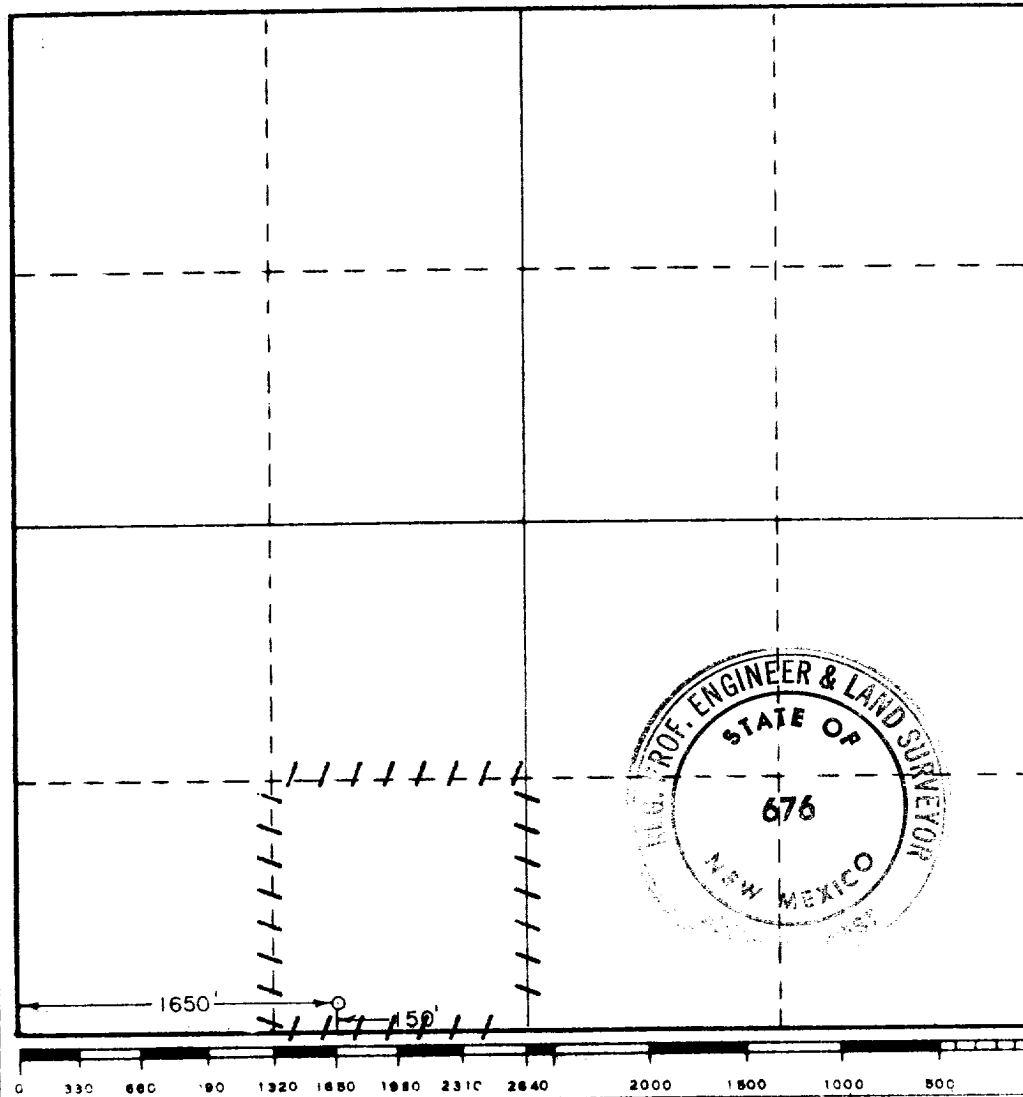

CERTIFICATION

I hereby certify that the information contained herein is true and complete to the best of my knowledge and belief

Name *Alley Knott*
 Position _____
Dist. Dir. Supt.
 Company **Atlantic Richfield Company**
 Date **3/15/78**

I hereby certify that the well location shown on this plat was plotted from field notes of actual surveys made by me or under my supervision, and that the same is true and correct to the best of my knowledge and belief.

December 16, 1977
 Date Surveyed

Registered Professional Engineer and/or Land Surveyor
John W. West
 Certificate No. **John W. West 676**
Ronald J. Eidson 3239

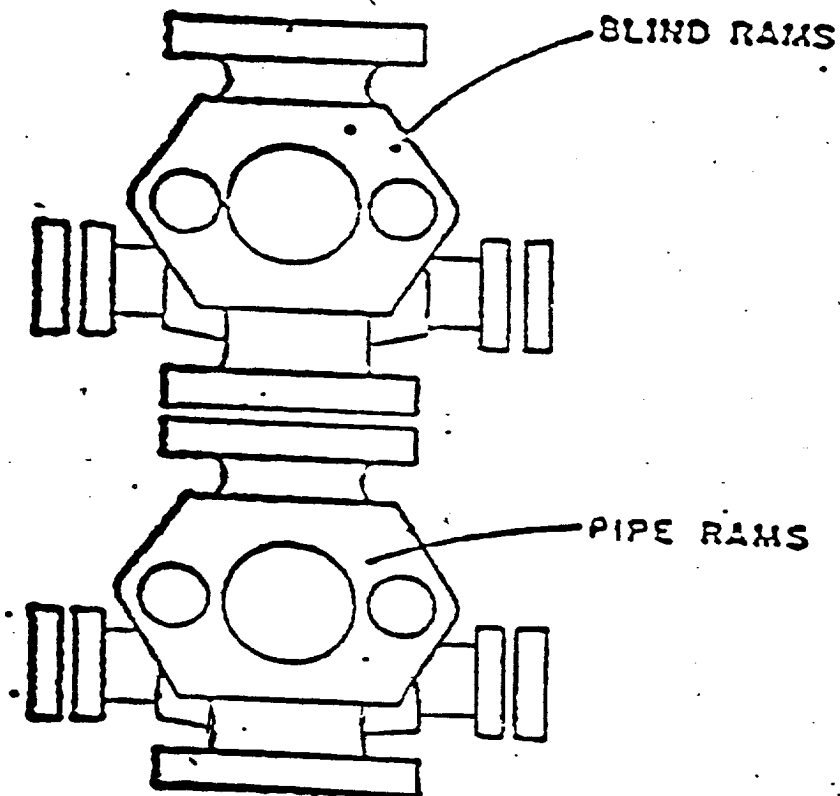

ATLANTIC RICHFIELD COMPANY
Blow Out Preventer Program

Lease Name Empire Abo Unit "H"

Well No. 301

Location 150' FSL & 1650' FWL
Sec 33-17S-28E, Eddy County

BOP to be tested before installed on well and will be maintained in good working condition during drilling. All wellhead fittings to be of sufficient pressure to operate in a safe manner.